

CCS83, ZONE 5 FOUND CONTROL MONUMENT COORDINATES							ELEVATION (NAVD88 AS PUBLISHED BY NGS)
	DESCRIPTION	NORTHING (2017.50 EPOCH)	EASTING (2017.50 EPOCH)	ELEVATION (NAVD88)	NORTHING (1991.35 EPOCH AS PUBLISHED BY NGS)	EASTING (1991.35 EPOCH AS PUBLISHED BY NGS)	
C8	U.S. COAST & GEODETIC SURVEY STD. BRASS DISK SURPRISE	2000580.52	5887147.18	109.69'	2000578.02	5887149.74	109.69'

APPROXIMATE EASTERLY LINE OF PARCEL 104 OF BOOK 9 OF PARCEL MAPS PAGES 9 - 17, SANTA BARBARA COUNTY RECORDS. BASED SOLELY ON RECORD INFORMATION SHOWN ON SAID PARCEL MAP. NO ATTEMPT WAS MADE TO SURVEY THIS LINE.

C8
U.S. COAST & GEODETIC
SURVEY STD. BRASS DISK
STAMPED SUPRISE 1933

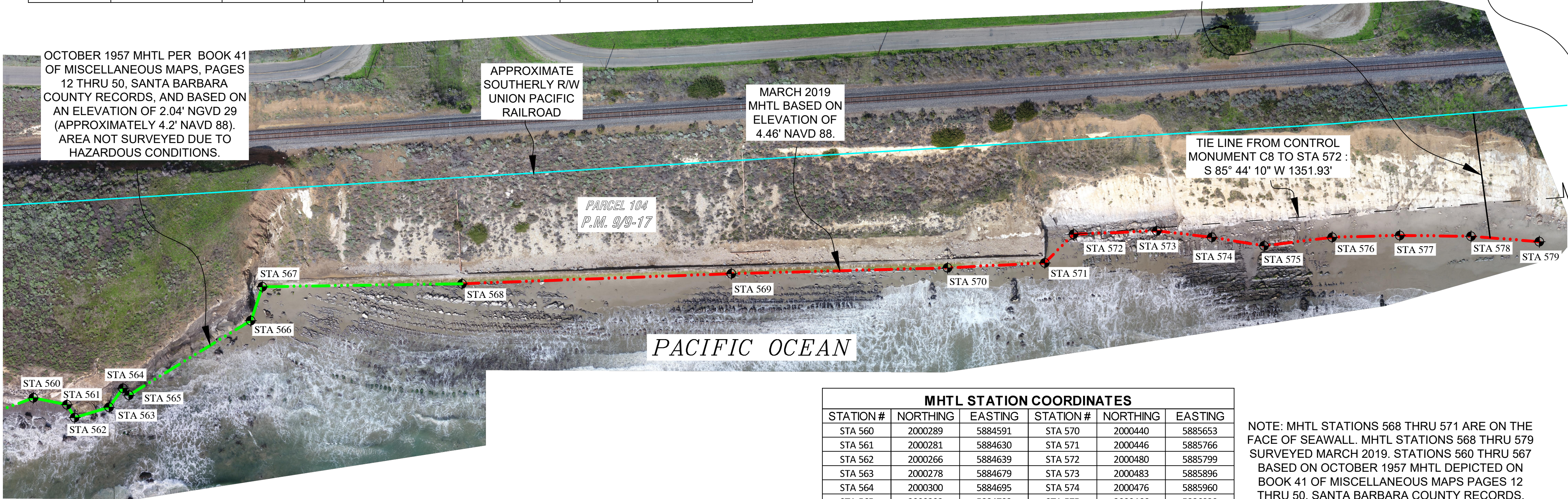

MHTL STATION COORDINATES					
STATION #	NORTHING	EASTING	STATION #	NORTHING	EASTING
STA 560	2000289	5884591	STA 570	2000440	5885653
STA 561	2000281	5884630	STA 571	2000446	5885766
STA 562	2000266	5884639	STA 572	2000480	5885799
STA 563	2000278	5884679	STA 573	2000483	5885896
STA 564	2000300	5884695	STA 574	2000476	5885960
STA 565	2000292	5884702	STA 575	2000466	5886020
STA 566	2000379	5884844	STA 576	2000476	5886099
STA 567	2000418	5884857	STA 577	2000478	5886178
STA 568	2000422	5885089	STA 578	2000477	5886261
STA 569	2000434	5885401	STA 579	2000471	5886340

NOTE: MHTL STATIONS 568 THRU 571 ARE ON THE FACE OF SEAWALL. MHTL STATIONS 568 THRU 579 SURVEYED MARCH 2019. STATIONS 560 THRU 567 BASED ON OCTOBER 1957 MHTL DEPICTED ON BOOK 41 OF MISCELLANEOUS MAPS PAGES 12 THRU 50, SANTA BARBARA COUNTY RECORDS.

LEGEND

- MARCH 2019 MEAN HIGH TIDE LINE (MHTL) PER FIELD SURVEYS PERFORMED BY CSLC STAFF MARCH 18, 2019 AND BASED ON AN ELEVATION OF 4.46' NAVD 88.
- OCTOBER 1957 MHTL PER BOOK 41 OF MISCELLANEOUS MAPS PAGES 12 THRU 50, SANTA BARBARA COUNTY RECORDS, AND BASED ON AN ELEVATION OF 2.04' NGVD 29 (APPROXIMATELY 4.2' NAVD 88).
- APPROXIMATE SOUTHERLY R/W OF UNION PACIFIC RAILROAD. BASED ON RECORD INFORMATION DEPICTED ON SANTA BARBARA COUNTY PARCEL MAPS FILED IN BOOK 8 OF PARCEL MAPS AT PAGES 45 -57 AND BOOK 9 OF PARCEL MAPS AT PAGES 9 - 17.
- MHTL STATION POINT
- FOUND CONTROL MONUMENT

NOTES

- THE UNITS FOR ALL COORDINATES AS SHOWN ARE US SURVEY FEET, UNLESS OTHERWISE NOTED.
- AERIAL PHOTOGRAPHY PER CSLC UAV IMAGERY OBTAINED DECEMBER 18 THRU 20, 2018, AND JANUARY 29 THRU 31, 2019.
- THIS PLAT HAS NOT BEEN APPROVED BY THE STATE LANDS COMMISSION AND DOES NOT CONSTITUTE AN OFFICIAL PLAT OF SUCH COMMISSION. NOR DOES IT ESTABLISH THE BOUNDARY LINES OR LIMITATIONS OF ANY STATE-OWNED LANDS DEPICTED HEREON.

SURVEY OF THE
MEAN HIGH TIDE LINE
DECEMBER 4, 5, 18, 19, & 20, 2018,
JANUARY 29, 30, 31, AND
MARCH 18, 2019
HOLLISTER RANCH
SANTA BARBARA COUNTY

CALIFORNIA STATE
LANDS COMMISSION



DRAWING NAME: SD20180809-SH21-24.DWG
FILE NO.: SD20180809.1
DRAWN BY: JOSEPH PORTER, PLS 8266
CHECKED BY:

DATE: 4/4/19

SCALE: 1"=80'

SHEET

24

24 OF 24