

**STAFF REPORT
C33**

A 3
S 4

02/27/18
PRC 8443.1
D. Simpkin

REVISION OF RENT

LESSEE:

Wild Goose Storage, Inc.

AREA, LAND TYPE, AND LOCATION:

Sovereign land in the Sacramento River, near Delevan, Colusa County.

AUTHORIZED USE:

Use and maintenance of an existing 30-inch-diameter natural gas pipeline and two fiber optic cables.

LEASE TERM:

20 years, beginning February 21, 2003.

CONSIDERATION:

This lease provides that the Commission may modify the rent periodically during the lease term. Pursuant to this provision, staff conducted a review of the rent under this lease and recommends that rent be revised from \$250 per year to \$568 per year, effective February 21, 2018.

OTHER PERTINENT INFORMATION:

1. On February 21, 2003, the Commission authorized a General Lease – Right-of-Way Use to Wild Goose Storage, Inc., for the installation of a horizontal directionally drilled natural gas pipeline and two fiber optic cables ([Item C15, February 21, 2003](#)). That lease expires on February 20, 2023.
2. Staff is in receipt of integrity test results to confirm the condition of the pipeline. Staff is reviewing the reports and based on the results will take any and all actions necessary to ensure the safety of the pipeline consistent with the Commission's jurisdiction and authority.
3. This action is consistent with Strategy 2.2 of the Commission's Strategic Plan to ensure timely receipt of revenues and royalties from the use and development of State lands and minerals.

STAFF REPORT NO. **C33** (CONT'D)

4. Approving the revision of rent is not a project as defined by the California Environmental Quality Act because it is an administrative action that will not result in direct or indirect physical changes in the environment.

Authority: Public Resources Code section 21065 and California Code of Regulations, title 14, section 15378, subdivision (b)(5).

EXHIBIT:

- A. Site and Location Map

RECOMMENDED ACTION:

It is recommended that the Commission:

AUTHORIZATION:

Approve the revision of rent for Lease No. PRC 8443.1 from \$250 per year to \$568 per year, effective February 21, 2018.

NO SCALE

SITE

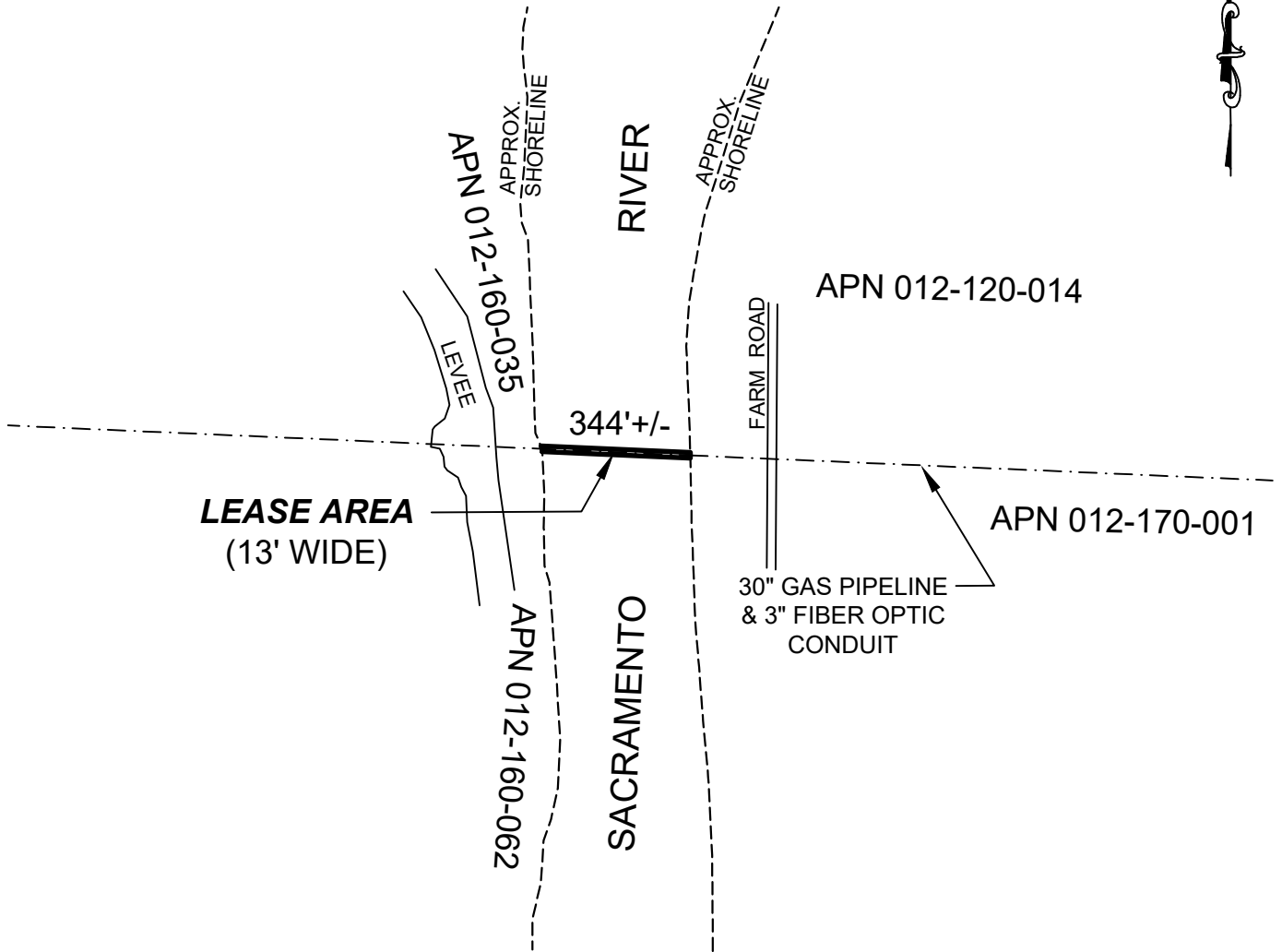

SACRAMENTO RIVER CROSSING, EAST OF DELEVAN, COLUSA COUNTY

NO SCALE

LOCATION

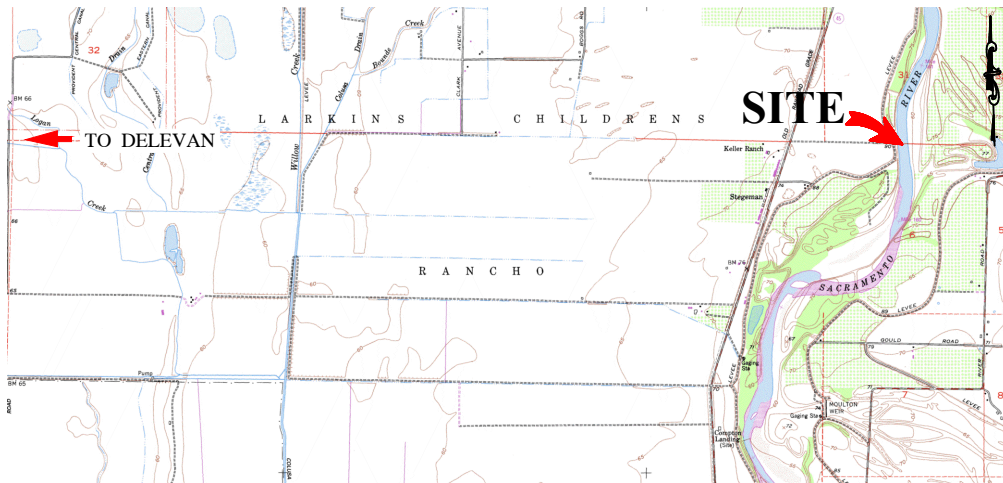

MAP SOURCE: USGS QUAD

Exhibit A

PRC 8443.1

WILD GOOSE STORAGE LLC

APN 012-170-001; 012-120-014

& 012-160-062, -035

GENERAL LEASE-

RIGHT-OF-WAY USE

COLUSA COUNTY



This Exhibit is solely for purposes of generally defining the lease premises, is based on unverified information provided by the Lessee or other parties and is not intended to be, nor shall it be construed as, a waiver or limitation of any State interest in the subject or any other property.