

**STAFF REPORT
C54**

A 72
S 34

08/17/17
PRC 8810.1
S. Avila

REVISION OF RENT

LESSEE:

Wendy Weiss Sawyer, Trustee of the Malden Irrevocable Trust, dated August 16, 2007

AREA, LAND TYPE, AND LOCATION:

Sovereign land in the Main Channel of Huntington Harbour, adjacent to 16462 Malden Circle, Huntington Beach, Orange County.

AUTHORIZED USE:

Continued use and maintenance of an existing boat dock, access ramp, and cantilevered deck.

LEASE TERM:

10 years, beginning December 3, 2008.

CONSIDERATION:

This lease provides that the Commission may modify the rent periodically during the lease term. Pursuant to this provision, staff conducted a review of the rent under this lease and recommends rent be revised from \$1,057 per year to \$1,851 per year, effective December 3, 2017.

OTHER PERTINENT INFORMATION:

1. Lessee owns the upland adjoining the lease premises.
2. On December 3, 2008, the Commission authorized a 10-year General Lease – Recreational Use to Wendy Weiss Sawyer, Trustee of the Malden Irrevocable Trust, dated August 16, 2007, for a term of 10 years beginning December 3, 2008 ([Item C16, December 3, 2008](#)). The lease will expire on December 2, 2018.
3. This action is consistent with Strategy 2.2 of the Commission's Strategic Plan to ensure timely receipt of revenues and royalties from the use and development of State lands and minerals.

STAFF REPORT NO. **C54** (CONT'D)

4. Approving the revision of the rent is not a project as defined by the California Environmental Quality Act because it is an administrative action that will not result in direct or indirect physical changes in the environment.

Authority: Public Resources Code section 21065 and California Code of Regulations, title 14, section 15378, subdivision (b)(5).

EXHIBIT:

- A. Site and Location Map

RECOMMENDED ACTION:

It is recommended that the Commission:

AUTHORIZATION:

Approve the revision of rent for Lease No. PRC 8810.1 from \$1,057 per year to \$1,851 per year, effective December 3, 2017.

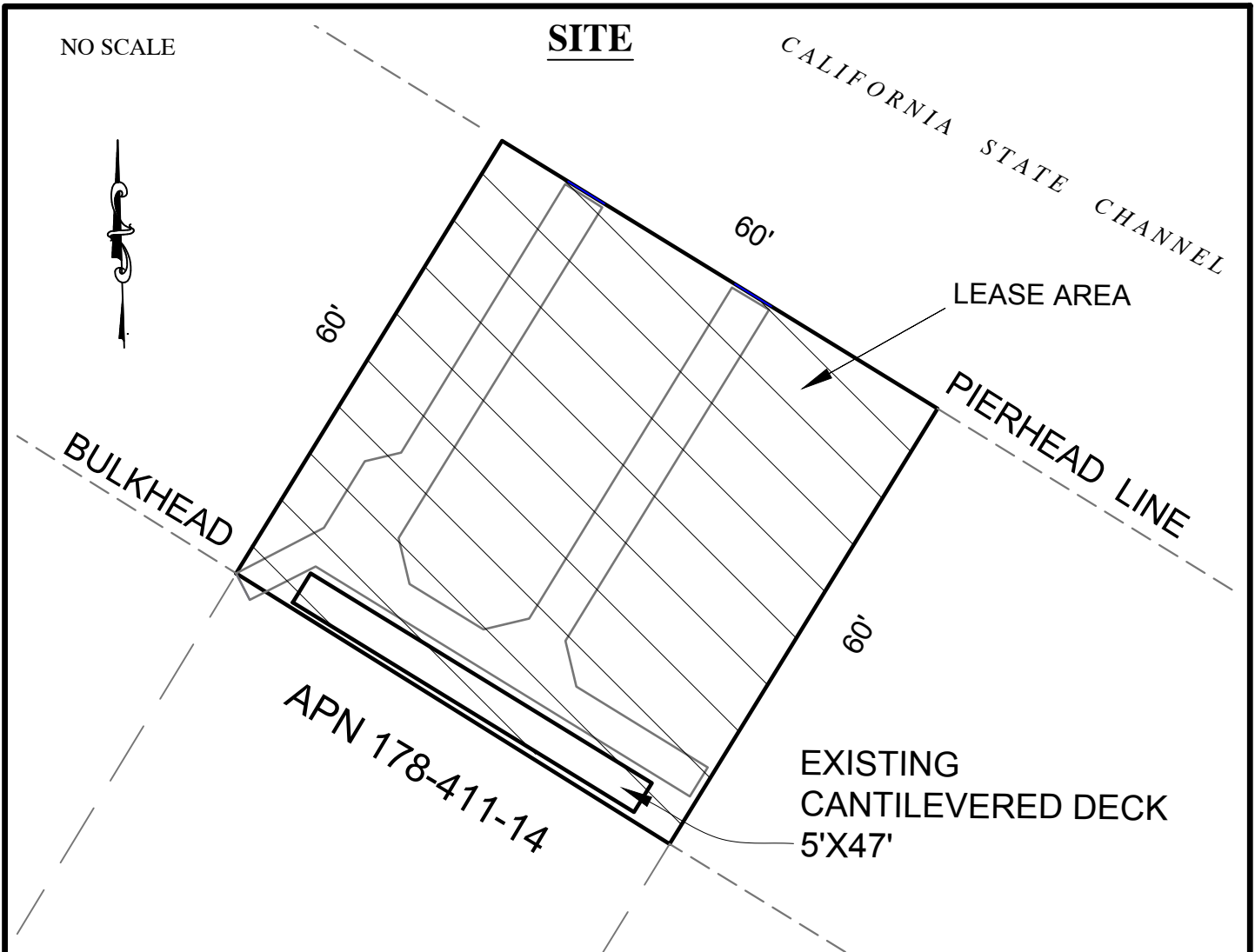

16462 MALDEN CIRCLE, HUNTINGTON HARBOUR

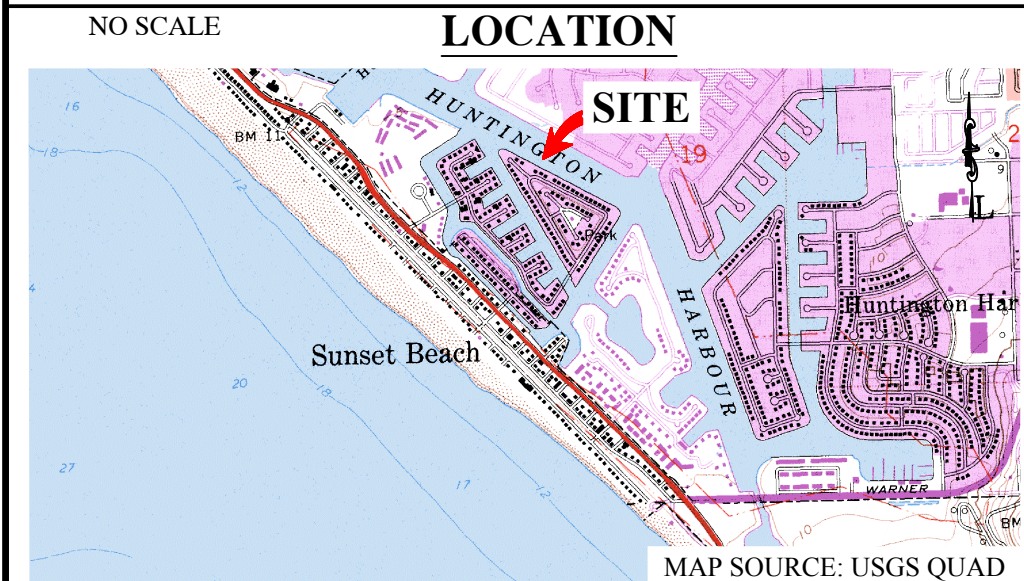

EXHIBIT A
 PRC 8810.1
 WENDY WEISS SAWYER,
 TRUSTEE
 APN 178-411-14
 GENERAL LEASE-
 RECREATIONAL USE
 ORANGE COUNTY



MJJ/07/10/2017

This Exhibit is solely for purposes of generally defining the lease premises, is based on unverified information provided by the Lessee or other parties and is not intended to be, nor shall it be construed as, a waiver or limitation of any State interest in the subject or any other property.