

**CALENDAR ITEM
C17**

A 1
S 1

06/29/15
PRC 7741.1
S. Kreutzburg

GENERAL LEASE – RECREATIONAL USE

APPLICANT:

Susan M. Irwin and Keith D. Irwin

AREA, LAND TYPE, AND LOCATION:

Sovereign land located in Donner Lake, adjacent to 13870 South Shore Drive, near the town of Truckee, Nevada County.

AUTHORIZED USE:

Continued use and maintenance of an existing pier.

LEASE TERM:

10 years, beginning December 1, 2014.

CONSIDERATION:

\$608 per year, with an annual Consumer Price Index adjustment.

SPECIFIC LEASE PROVISIONS:

Insurance:

Liability insurance in an amount no less than \$1,000,000 per occurrence.

OTHER PERTINENT INFORMATION:

1. Applicant owns the upland adjoining the lease premises.
2. On February 17, 2005, the Commission authorized a 10-year Recreational Pier Lease to Susan M. Irwin and Keith D. Irwin. That lease expired on November 30, 2014. The Applicant is applying for a General Lease – Recreational Use.
3. The staff recommends that the Commission find that this activity is exempt from the requirements of the California Environmental Quality Act (CEQA) as a categorically exempt project. The project is exempt under Class 1, Existing Facilities; California Code of Regulations, Title 2, section 2905, subdivision (a)(2).

CALENDAR ITEM NO. **C17** (CONT'D)

Authority: Public Resources Code section 21084 and California Code of Regulations, Title 14, section 15300 and California Code of Regulations, Title 2, section 2905.

4. This activity involves lands identified as possessing significant environmental values pursuant to Public Resources Code section 6370 et seq., but such activity will not affect those significant lands. Based upon the staff's consultation with the persons nominating such lands and through the CEQA review process, it is the staff's opinion that the project, as proposed, is consistent with its use classification.

EXHIBITS:

- A. Land Description
- B. Site and Location Map

RECOMMENDED ACTION:

It is recommended that the Commission:

CEQA FINDING:

Find that the activity is exempt from the requirements of CEQA pursuant to California Code of Regulations, Title 14, section 15061 as a categorically exempt project, Class 1, Existing Facilities; California Code of Regulations, Title 2, section 2905, subdivision (a)(2).

SIGNIFICANT LANDS INVENTORY FINDING:

Find that this activity is consistent with the use classification designated by the Commission for the land pursuant to Public Resources Code section 6370 et seq.

AUTHORIZATION:

Authorize issuance of a General Lease – Recreational Use to Susan M. Irwin and Keith D. Irwin beginning December 1, 2014, for a term of 10 years, for the continued use and maintenance of an existing pier, as described in Exhibit A and shown on Exhibit B (for reference purposes only), attached and by this reference made a part hereof; annual rent in the amount of \$608, with an annual Consumer Price Index adjustment; and liability insurance in the amount of \$1,000,000 per occurrence.

EXHIBIT A

PRC 7741.1

LAND DESCRIPTION

A parcel of submerged land situated in the bed of Donner Lake, lying adjacent to Lot 8 of fractional Section 13, Township 17 North, Range 15 East, M.D.B.&M., as shown on Official Government Township Plat approved April 10, 1867, County of Nevada, State of California, more particularly described as follows:

All those lands underlying an existing pier lying adjacent to that parcel described in Exhibit A of that Grant Deed recorded August 30, 1996 as Document Number 96023843 Official Records of said County.

TOGETHER WITH any applicable Impact Area(s).

EXCEPTING THEREFROM any portion lying landward of the low water mark of said Donner Lake.

Accompanying plat is hereby made part of this description.

END OF DESCRIPTION

Prepared 04/15/2015 by the California State Lands Commission Boundary Unit.



DONNER

LAKE

9' IMPACT
AREA

EXISTING
PIER

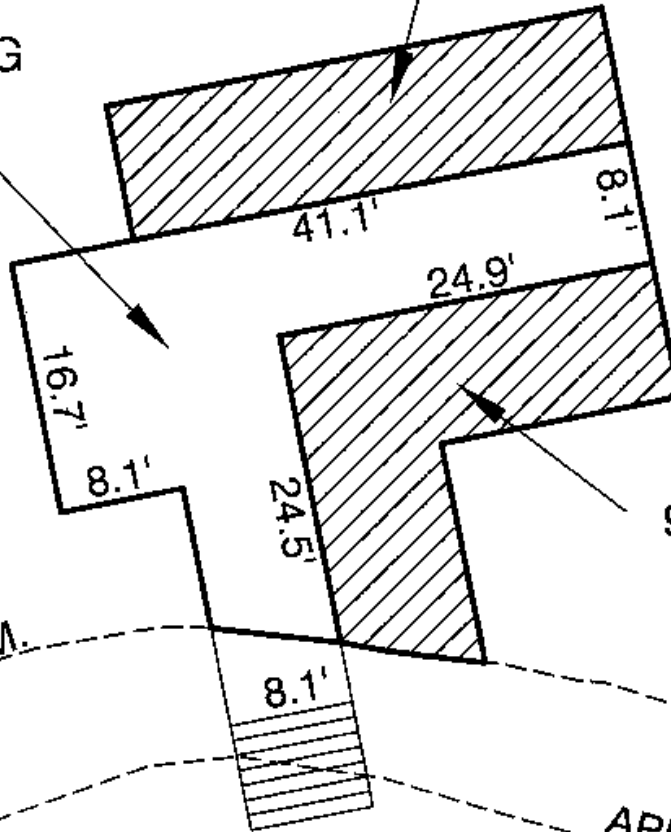

APPROX. L.W.M.
(EL. 5933.8')

9' IMPACT
AREA

APPROX.
SHORELINE

APN 17-400-13

EXHIBIT A

Page 2 of 2

TS 04/15/15

LAND DESCRIPTION PLAT
PRC 7741.1, IRWIN
NEVADA COUNTY

CALIFORNIA STATE
LANDS COMMISSION



NO SCALE

SITE LAKE

DONNER

9' IMPACT AREA

EXISTING PIER

APPROX. L.W.M.
(EL. 5933.8')

APPROX. SHORELINE

APN 17-400-13

13870 SOUTH SHORE DRIVE, NEAR TRUCKEE

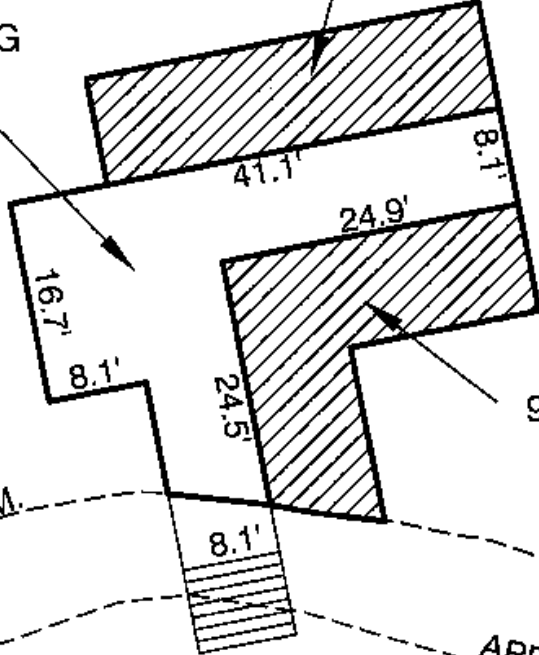

NO SCALE

LOCATION

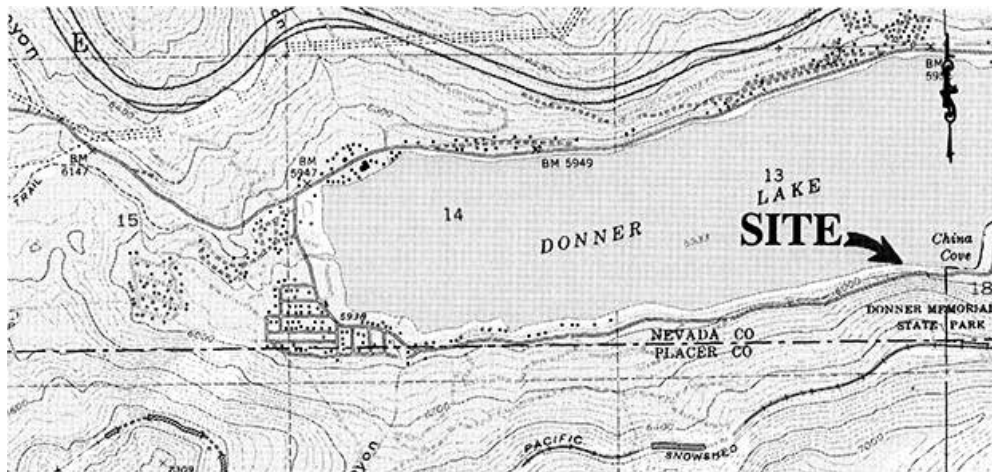

MAP SOURCE: USGS QUAD

Exhibit B

PRC 7741.1

IRWIN

APN 17-400-13

GENERAL LEASE -
RECREATIONAL USE
NEVADA COUNTY



This Exhibit is solely for purposes of generally defining the lease premises, is based on unverified information provided by the Lessee or other parties and is not intended to be, nor shall it be construed as, a waiver or limitation of any State interest in the subject or any other property.

TS 04/15/15