

**CALENDAR ITEM
C25**

A 9
S 5, 6

10/14/14
PRC 7775.9
D. Jones

**CORRECTION OF PRIOR AUTHORIZATION OF A
GENERAL LEASE - DREDGING**

APPLICANT:

City of Sacramento

AREA, LAND TYPE, AND LOCATION:

Sovereign land in the Sacramento River, adjacent to Assessor's Parcel Number 009-0020-003, at the entrance to the Sacramento Marina in Miller Park and at the Miller Park Boat Ramp, in the city of Sacramento, Sacramento County.

AUTHORIZED USE:

Dredge a maximum of 13,000 cubic yards of material annually to maintain a navigable depth: 3,000 cubic yards of material at the Miller Park Boat Ramp and 10,000 cubic yards of material from the entrance to the mouth of the Sacramento Marina located in Miller Park. Dredged materials will initially be disposed of at either one of two city-owned upland parcels, the Broadway Corporation Yard or the city's overflow lot for dewatering, each approximately one-half mile from the dredging site, and then disposed of at the U.S. Army Corps of Engineers' (Corps) approved Kiefer Landfill site.

LEASE TERM:

10 years, beginning August 3, 2014.

CONSIDERATION:

No monetary consideration is due for the lease because there is no commercial benefit from the project and the dredged material may not be sold.

OTHER PERTINENT INFORMATION:

1. Applicant owns the upland adjoining the lease premises.
2. On April 23, 2014, the Commission authorized issuance of Lease No. 7775.9, a General Lease – Dredging, issued to the city of Sacramento. The Calendar Item (C10) authorized a combined maximum of 13,000 cubic yards of material during the lease term: 3,000 cubic yards of

CALENDAR ITEM NO. **C25** (CONT'D)

material annually during the lease term from the entrance to the mouth of Sacramento Marina and to dredge a maximum of 10,000 cubic yards of material annually during the lease term from the Miller Park Boat Ramp. Commission staff is now requesting Commission approval to correct the prior authorization to show the dredging amounts to be as follows: to annually dredge a combined maximum of 13,000 cubic yards of material during the lease term: 3,000 cubic yards of material annually during the lease term from the Miller Park Boat Ramp and 10,000 cubic yards of material annually from the entrance to the mouth of the Sacramento Marina. The dredging amounts are correctly shown in the lease.

Commission staff is also requesting that Exhibit A Land Description be deleted in the April 23, 2014, Calendar Item C10 and replaced with the attached Exhibit A attached and by reference made a part hereof.

3. The staff recommends that the Commission find that this activity is exempt from the requirements of the California Environmental Quality Act (CEQA) as a categorically exempt project. The project is exempt under Class 4, Minor Alterations to Land; California Code of Regulations, Title 14, section 15304, subdivision (g).

Authority: Public Resources Code section 21084 and California Code of Regulations, Title 14, section 15300.

4. This activity involves lands identified as possessing significant environmental values pursuant to Public Resources Code section 6370 et seq., but such activity will not affect those significant lands. Based upon the staff's consultation with the persons nominating such lands and through the CEQA review process, it is the staff's opinion that the project, as proposed, is consistent with its use classification.

EXHIBITS:

- A. Land Description
- B. Site and Location Map

RECOMMENDED ACTION:

It is recommended that the Commission:

CEQA FINDING:

Find that the activity is exempt from the requirements of CEQA pursuant to California Code of Regulations, Title 14, section 15061 as a categorically exempt project, Class 4, Minor Alterations to Land; California Code of Regulations, Title 14, section 15304, subdivision (g).

CALENDAR ITEM NO. **C25** (CONT'D)

SIGNIFICANT LANDS INVENTORY FINDING:

Find that this activity is consistent with the use classification designated by the Commission for the land pursuant to Public Resources Code section 6370 et seq.

AUTHORIZATION:

Authorize correction of the Commission's prior authorization of a General Lease – Dredging Lease No. PRC 7775.9, issued to the City of Sacramento, to correct the amount of cubic yards as follows: to annually dredge a combined maximum of 13,000 cubic yards of material during the lease term: 3,000 cubic yards of material annually during the lease term from the Miller Park Boat Ramp and 10,000 cubic yards of material annually from the entrance to the mouth of the Sacramento Marina; and to delete Exhibit A Land Description in the April 23, 2014, Calendar Item C10 and replace it with the attached Exhibit A attached and by reference made a part hereof; all other terms and conditions of the prior authorization and lease remain unchanged and in effect.

EXHIBIT A

PRC 7775.9

LAND DESCRIPTION

Two (2) parcels of tide and submerged land, situate in the bed of the Sacramento River, lying in and adjacent to those lands granted to the City of Sacramento pursuant to Chapter 1266, Statutes of 1970, and shown on that record of survey map titled "Portion of Projected Section 11 – T.8N., R.4E. M.D.B. & M." dated November 1972 and filed in Book 30 of Surveys, Page 10, County of Sacramento, State of California and more particularly described as follows:

Parcel 1 – Mouth of Sacramento Marina

COMMENCING at the southeast corner of "Parcel 2" as shown on said record of survey; thence along the easterly line of said parcel North 18°37'00" West 375.00 feet; thence leaving said line North 31°06'30" West 423.32 feet to the POINT OF BEGINNING; thence South 69°13'34" West 231.09 feet; thence North 17°40'44" West 118.72 feet; thence North 45°36'26" East 175.35 feet; thence South 39°30'09" East 199.36 feet to the POINT OF BEGINNING.

EXCEPTING THEREFROM any portion lying landward of the ordinary high water mark of the Sacramento River.

ALSO EXCEPTING THEREFROM any portion lying within said lands granted to the City of Sacramento pursuant Chapter 1266, Statutes of 1970.

Parcel 2 – Miller Park Boat Launch Ramp

COMMENCING at the southeast corner of "Parcel 2" as shown on said record of survey; thence along the easterly line of said parcel North 18°37'00" West 375.00 feet; thence leaving said line North 74°27'58" West 287.47 feet to the POINT OF BEGINNING; thence South 50°14'35" West 90.00 feet; thence North 39°45'25" West 150.00 feet; thence North 50°14'35" East 90.00 feet; thence South 39°45'25" East 150.00 feet to the POINT OF BEGINNING.

EXCEPTING THEREFROM any portion lying landward of the ordinary high water mark of the Sacramento River.

ALSO EXCEPTING THEREFROM any portion lying within said lands granted to the City of Sacramento pursuant Chapter 1266, Statutes of 1970.

END OF DESCRIPTION

PREPARED 3/17/14 BY THE CALIFORNIA STATE LANDS COMMISSION BOUNDARY UNIT



NO SCALE

SITE

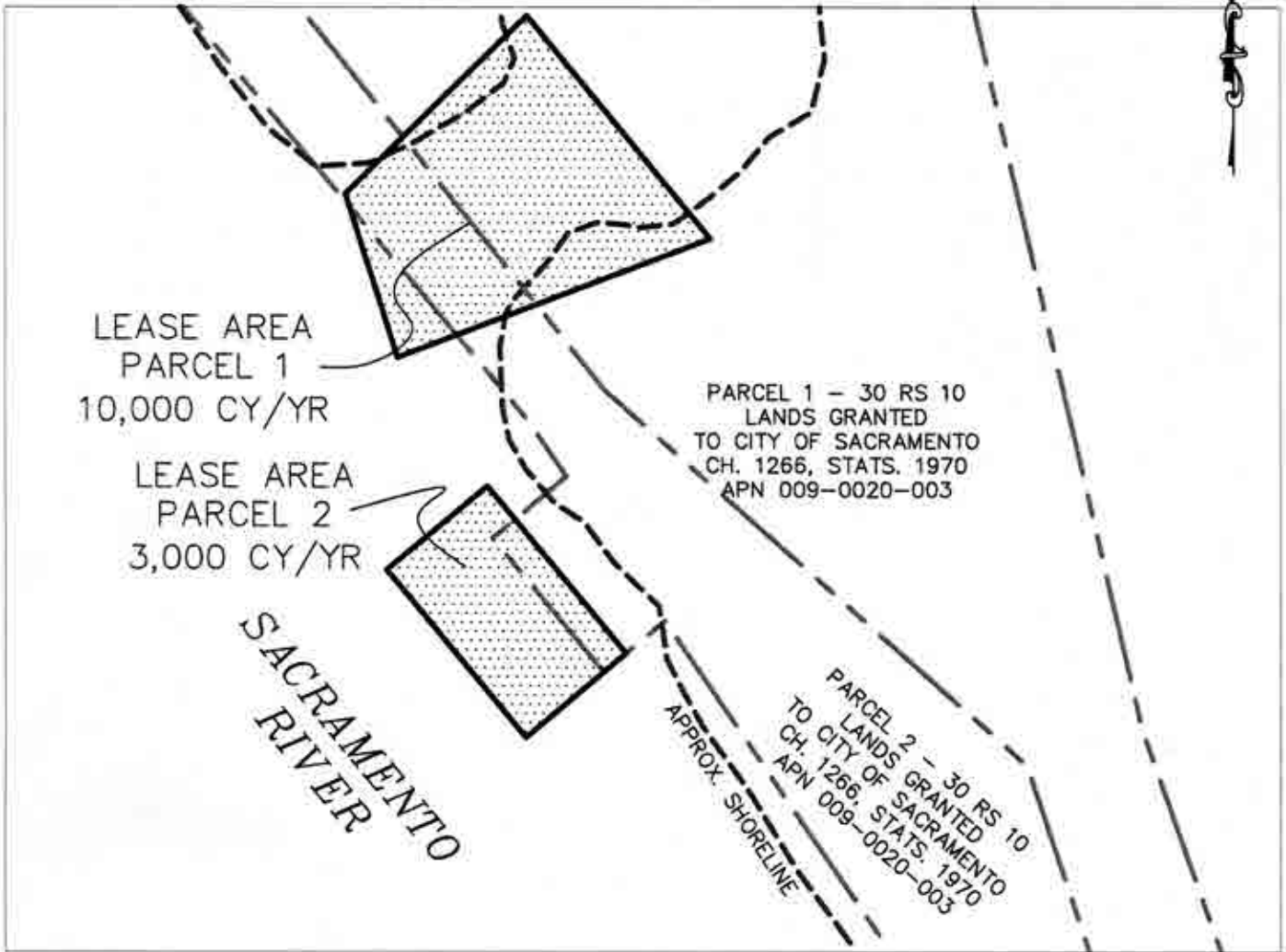

2710 Ramp Way, Sacramento - Sacramento Marina, Miller Park

NO SCALE

LOCATION

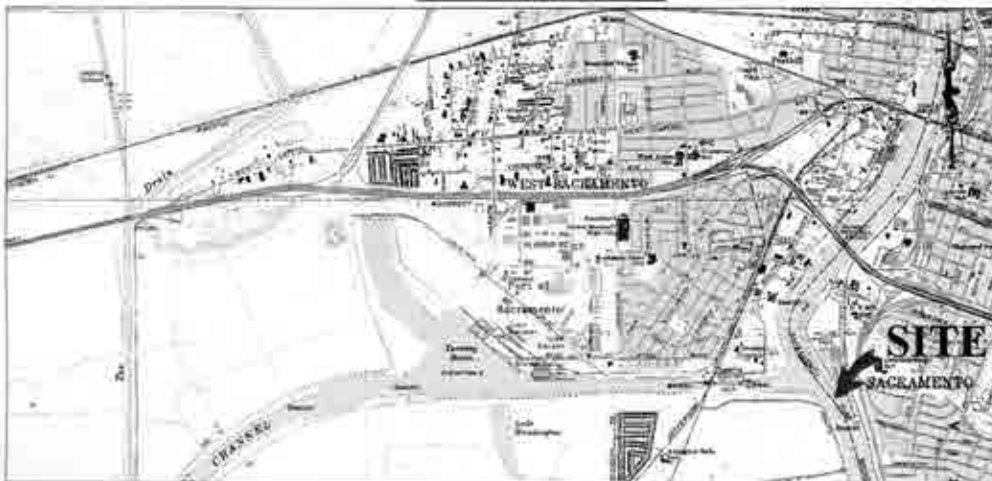

MAP SOURCE: USGS QUAD

Exhibit B

PRC 7775.9
 CITY OF SACRAMENTO
 APN 009-0020-003
 GENERAL LEASE -
 DREDGING
 SACRAMENTO COUNTY



This Exhibit is solely for purposes of generally defining the lease premises, is based on unverified information provided by the Lessee or other parties and is not intended to be, nor shall it be construed as, a waiver or limitation of any State interest in the subject or any other property.