

NO SCALE

### SITE

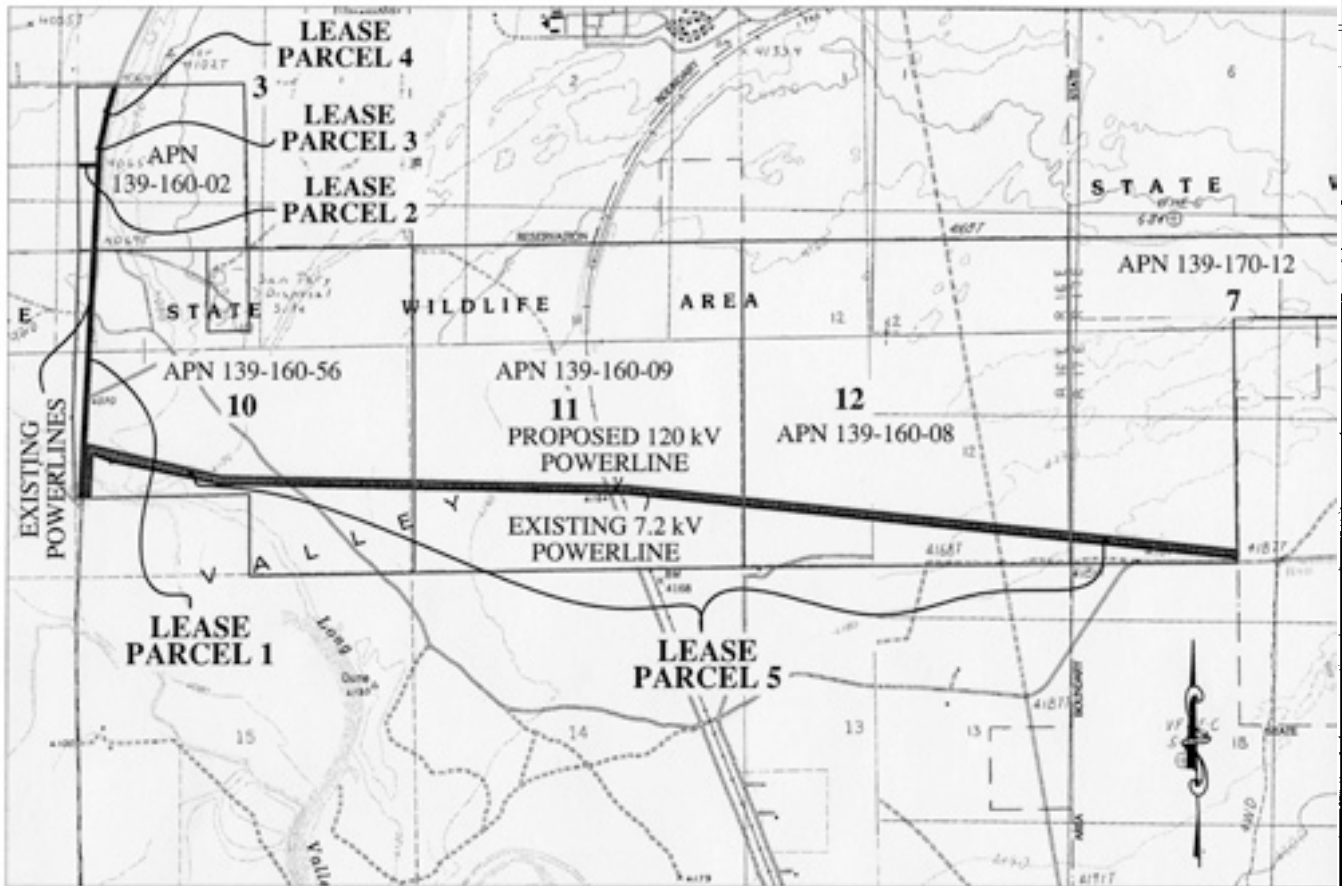

### STATE SCHOOL LANDS

PORTIONS OF SECTIONS 3,10, 11, AND 12 TOWNSHIP 26 NORTH, RANGE 16 EAST AND SECTION 7 TOWNSHIP 26 NORTH, RANGE 17 EAST, MOUNT DIABLO MERIDIAN

NO SCALE

### LOCATION

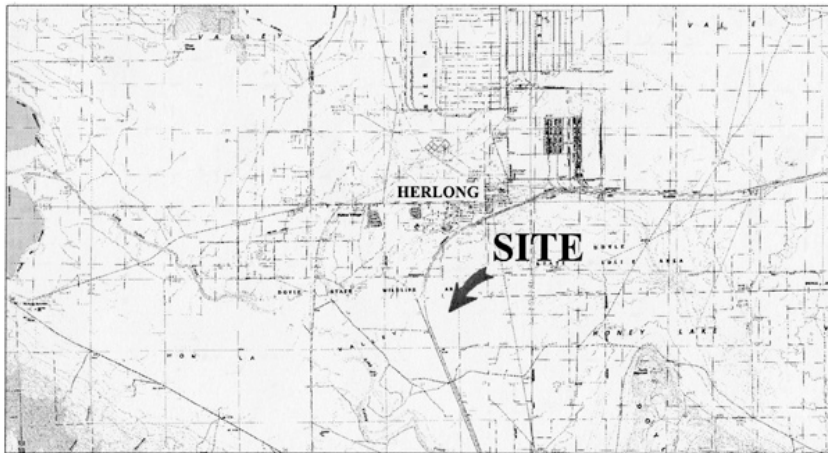

MAP SOURCE: USGS QUAD

### Exhibit A

W 26302  
 PLUMAS-SIERRA RURAL  
 ELECTRIC COOPERATIVE  
 APNs 139-160-02,  
 139-160-08,139-160-09,  
 139-160-56, 139-170-12  
 GENERAL LEASE -  
 RIGHT-OF-WAY USE  
 LASSEN COUNTY



This Exhibit is solely for purposes of generally defining the lease premises, is based on unverified information provided by the Lessee or other parties and is not intended to be, nor shall it be construed as, a waiver or limitation of any State interest in the subject or any other property.