

NO SCALE

### SITE

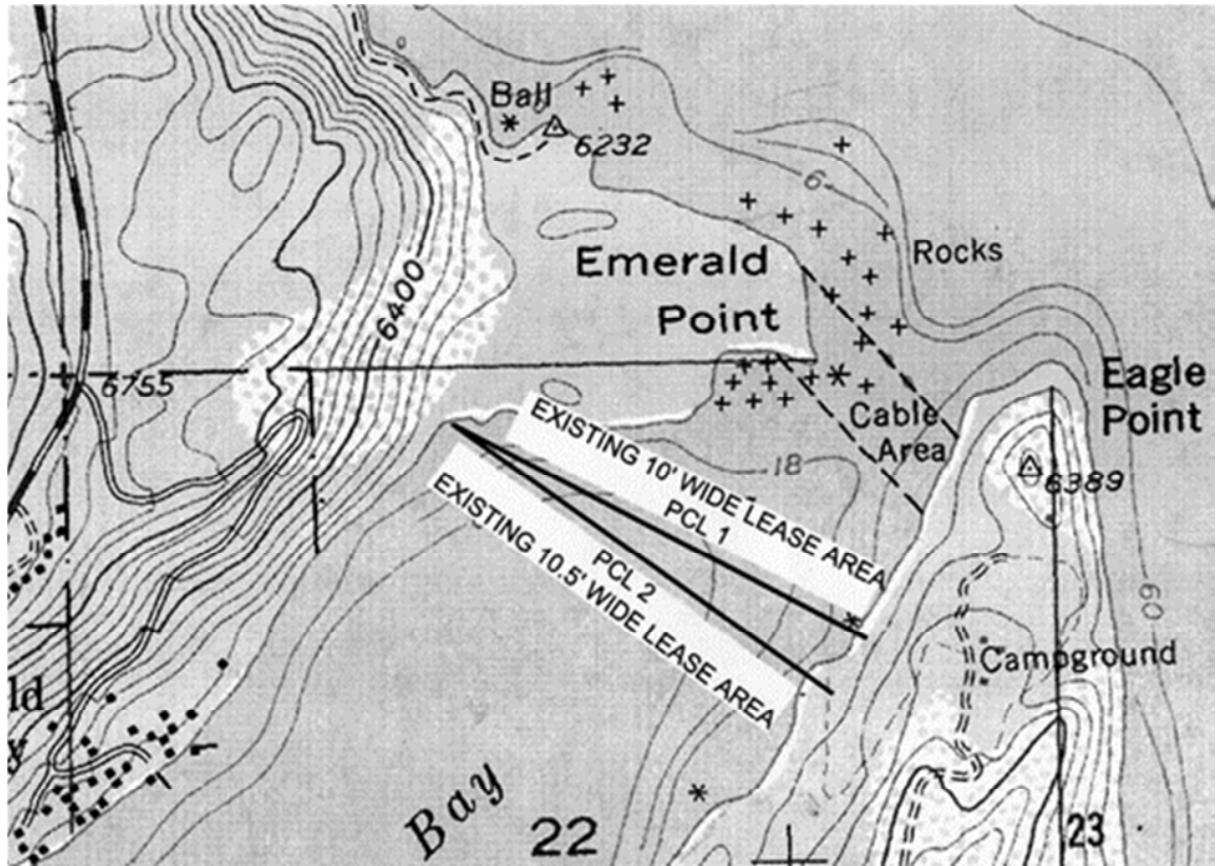

CALIFORNIA PACIFIC ELECTRIC CO., LLC,  
SUBMARINE CABLE CROSSING, EMERALD BAY

NO SCALE

### LOCATION

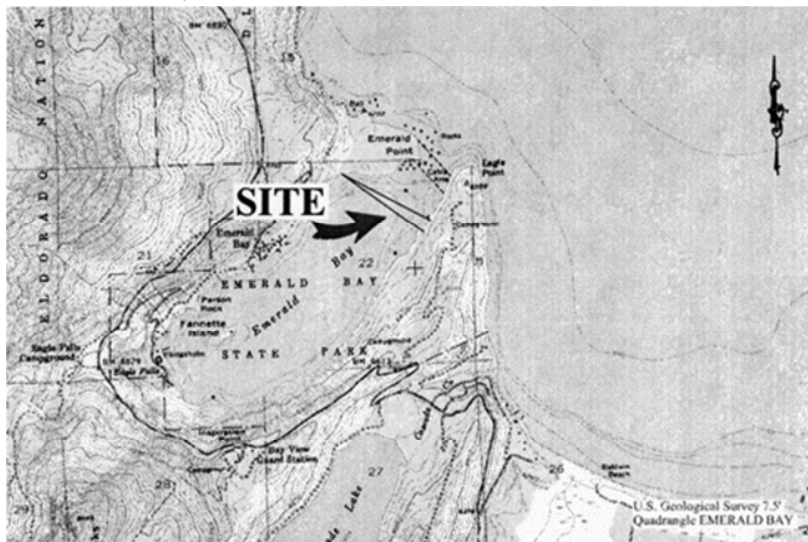

This Exhibit is solely for purposes of generally defining the lease premises, is based on unverified information provided by Lessee or other parties, and is not intended to be, nor shall it be construed as a waiver or limitation of any state interest in the subject or any other property.

### Exhibit A

PRC 944.1  
APN 018-041-04  
& APN 018-060-05  
GENERAL LEASE  
RIGHT OF WAY USE  
EL DORADO COUNTY

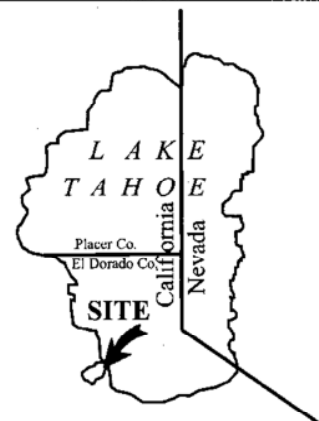

MJJ 12/10