

NO SCALE

SITE

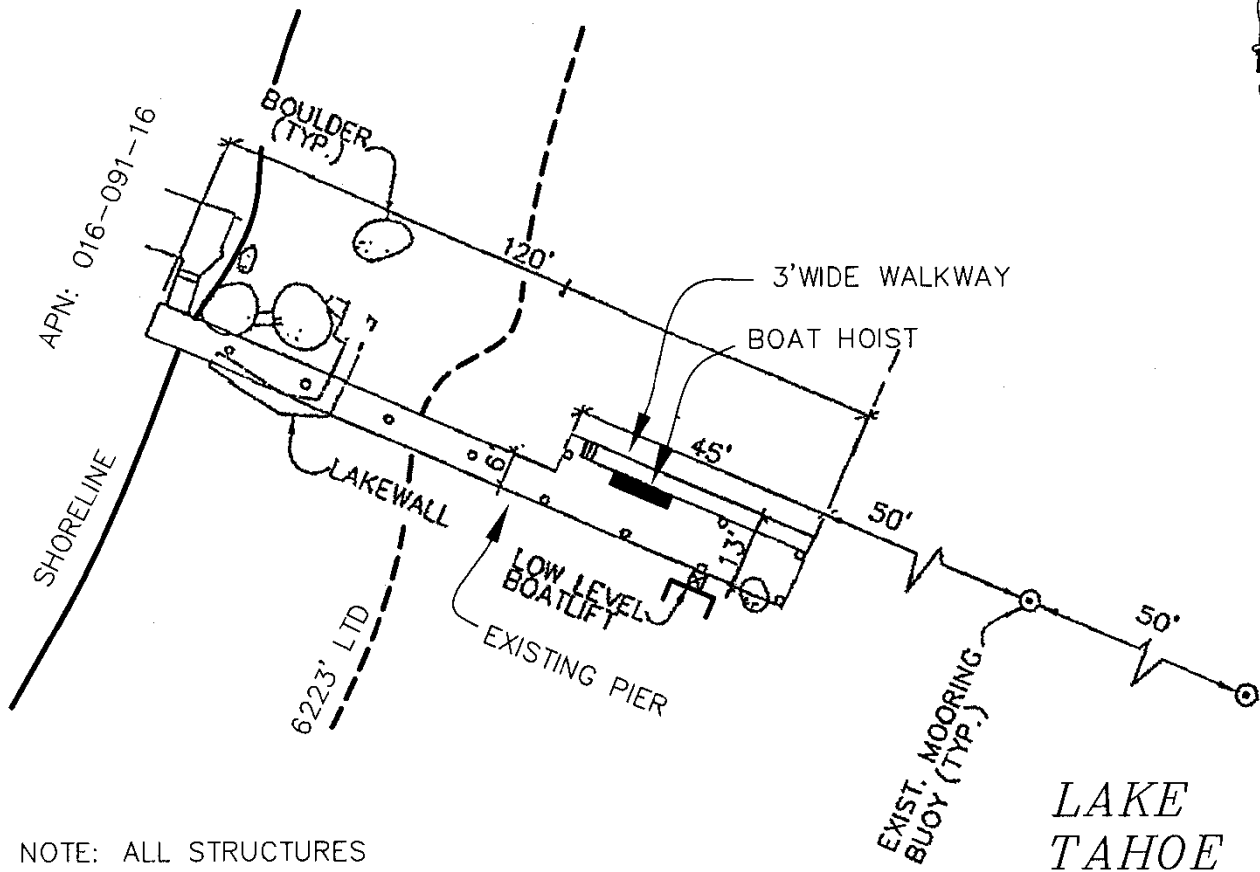

NOTE: ALL STRUCTURES SHOWN ARE EXISTING.

8453 MEEKS BAY AVENUE, MEEKS BAY

NO SCALE

LOCATION

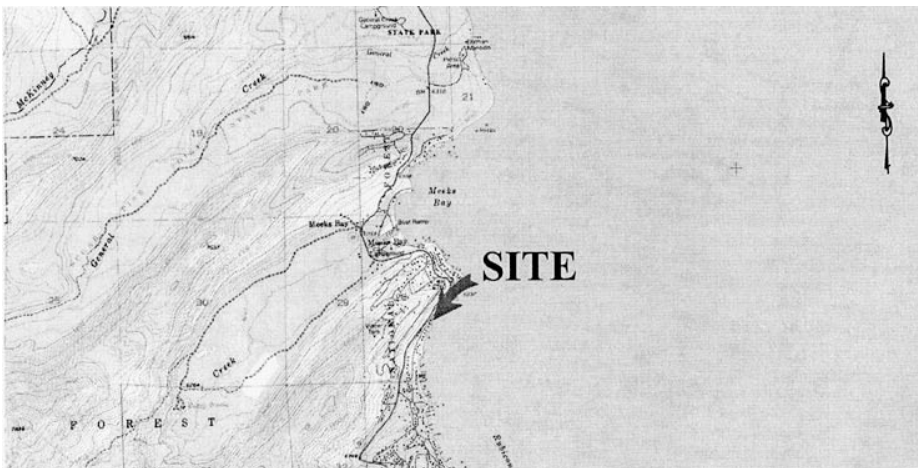

MAP SOURCE: USGS QUAD

This Exhibit is solely for purposes of generally defining the lease premises, is based on unverified information provided by the Lessee or other parties and is not intended to be, nor shall it be construed as, a waiver or limitation of any State interest in the subject or any other property.

Exhibit A

WP 7416.9
 FERRANTE, SOLARI &
 MAZRY, TRUSTEE
 APN 016-091-16
 RECREATIONAL PIER
 LEASE
 EL DORADO COUNTY

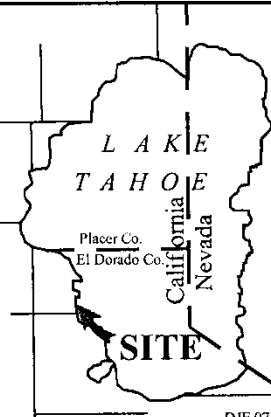

DJF 07/09