

NO SCALE

SITE

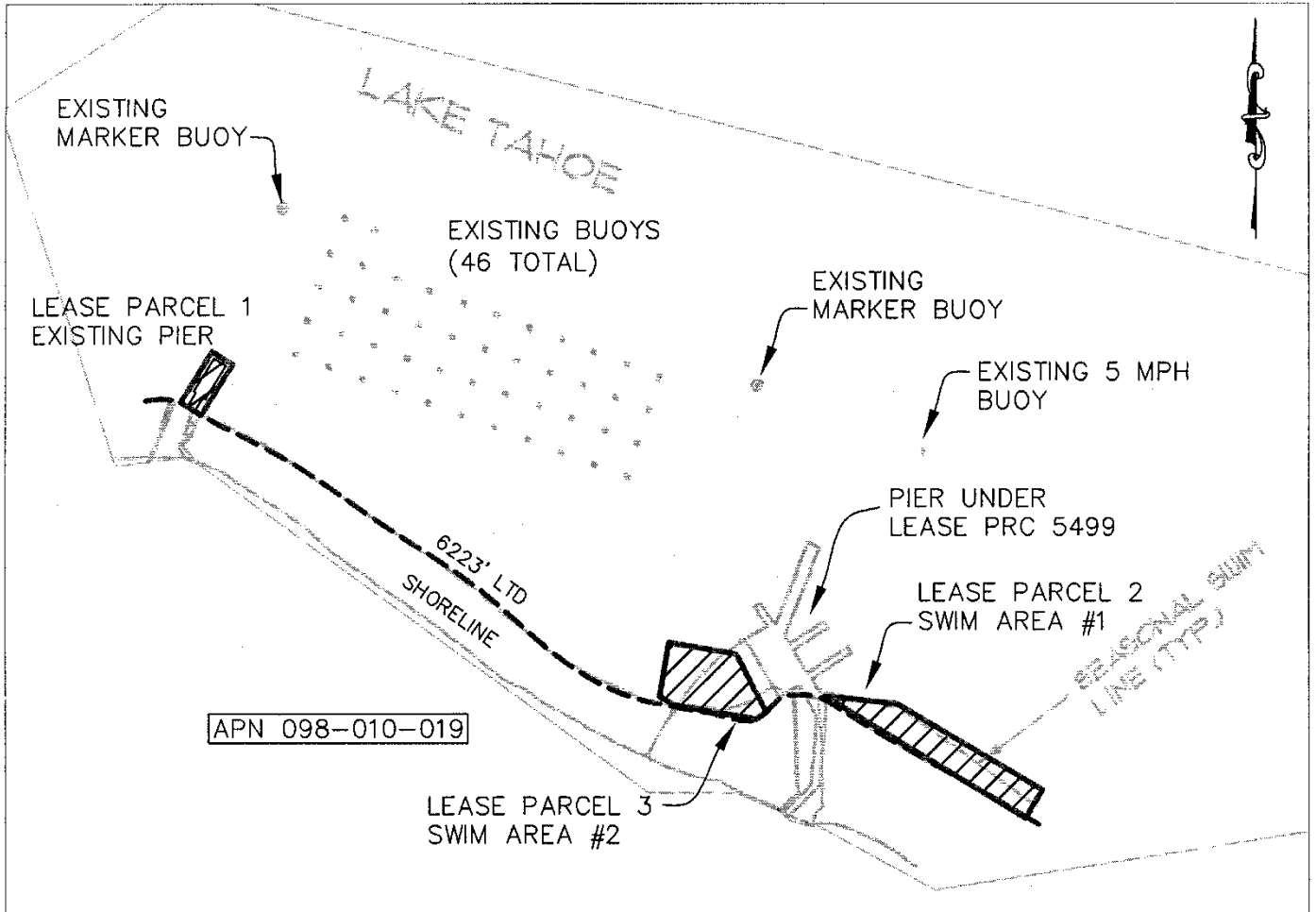

6400 West Lake Blvd., Near Homewood

NO SCALE

LOCATION

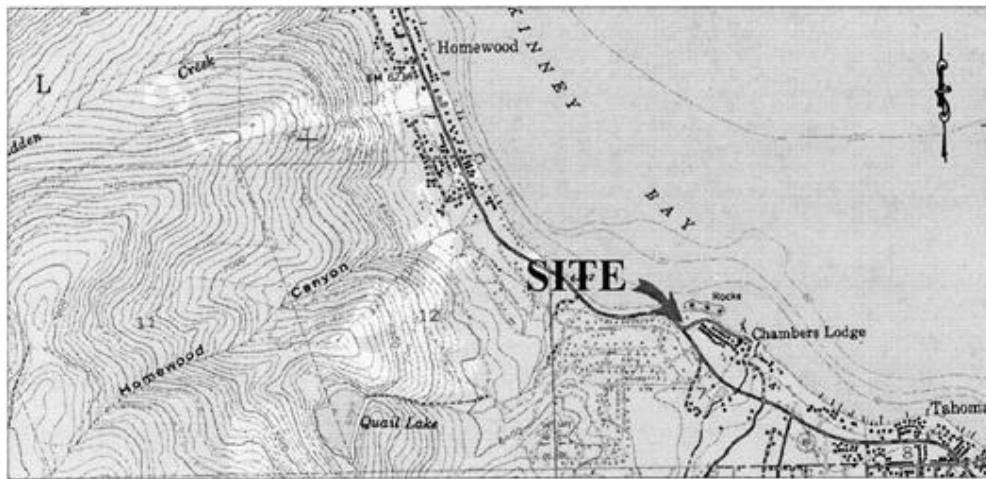

MAP SOURCE: USGS QUAD

This Exhibit is solely for purposes of generally defining the lease premises, is based on unverified information provided by the Lessee or other parties and is not intended to be, nor shall it be construed as, a waiver or limitation of any State interest in the subject or any other property.

Exhibit A

PRC 3044.1
 CHAMBERS LANDING
 HOA
 APN 098-010-019
 GENERAL LEASE
 RECREATIONAL USE
 PLACER COUNTY

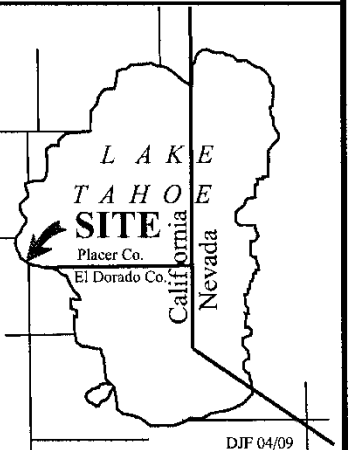

DIF 04/09