

**CALENDAR ITEM  
C50**

A 4  
S 1

06/01/09  
WP 7368.9  
B. Terry

**DREDGING LEASE**

**APPLICANT:**

North Tahoe Public Utility District  
7010 North Lake Boulevard  
Tahoe Vista, CA 96148

**AREA, LAND TYPE, AND LOCATION:**

Sovereign lands in Lake Tahoe, adjacent to 7010 North Lake Boulevard,  
near Tahoe Vista, Placer County.

**AUTHORIZED USE:**

Dredge a maximum of 200 cubic yards of material from the entrance  
channel of the Tahoe Vista Recreation Area marina facility, as shown on  
the attached Exhibit A.

**LEASE TERM:**

One year, beginning June 1, 2009.

**CONSIDERATION:**

No royalty will be charged, as the project will result in a public benefit.  
The dredged material may not be sold.

**OTHER PERTINENT INFORMATION:**

1. Applicant owns the upland property adjoining the lease premises.
2. On April 2, 1991, the Commission authorized issuance of a one-year Maintenance Dredging Permit to Fireman's Fund Insurance Company dba Tahoe Marina Resort. The upland ownership has since transferred to North Tahoe Public Utility District who is now applying for a Dredging Lease.
3. The Applicant owns and operates the Tahoe Vista Recreation Area, a public recreational facility. The facility provides beach and Lake access, picnic and restroom facilities, automobile and boat trailer parking, a boat launch, and marina.

CALENDAR ITEM NO. **C50** (CONT'D)

4. Due to the lower Lake level in 2008 and the onshore movement of sand, gravel and silts driven by wave action, the Applicant reports that it has become necessary to dredge the inner harbor of the marina and the marina's entrance channel to maintain functional and safe ingress and egress to the marina facility. The entrance channel is located on State sovereign land, and the main inner harbor area with ramp and bulkhead is located above elevation 6,223-feet, Lake Tahoe Datum.
5. The Applicant proposes to dredge 200 cubic yards of material from the entrance channel to a previously-approved elevation of 6,221 feet Lake Tahoe Datum. The channel will be dredged using the hydraulic method, which removes sediments using suction, and removes only loose sand and silt. This method can involve a rotary cutting device which dislodges the material and suspends it into the water that is being suctioned. The dredged material will be carried by a hose or pipe to the inner harbor area of the marina and will be removed with the dredging of the marina. Turbidity curtains will be installed around the entrance channel and inside the entrance of the marina during dredging to minimize suspended sediments from entering Lake Tahoe. The curtains will be removed only after sediments have settled and upon approval of the Lahontan Regional Water Quality Control Board. A continuous water quality monitoring program will be undertaken for the duration of the dredging project.
6. All dredged material will be deposited onto a conveyor system and delivered to a dewatering facility located within the parking area adjacent to the marina where there is access to the sanitary sewer system. Once the dredged material has been dewatered, it will be loaded into sealed trucks and transported to the Eastern Regional Landfill in the town of Truckee.
7. Pursuant to the Commission's delegation of authority and the State CEQA Guidelines (Title 14, California Code of Regulations, section 15061), the staff has determined that this activity is exempt from the requirements of the CEQA as a categorically exempt project. The project is exempt under Class 4, Minor Alteration to Land; Title 2, California Code of Regulations, section 2905 (d)(4).

Authority: Public Resources Code section 21084 and Title 14, California Code of Regulations, section 15300 and Title 2, California Code of Regulations, section 2905.

CALENDAR ITEM NO. **C50** (CONT'D)

8. This activity involves lands identified as possessing significant environmental values pursuant to Public Resources Code sections 6370, et seq. Based upon the staff's consultation with the persons nominating such lands and through the CEQA review process, it is the staff's opinion that the project, as proposed, is consistent with its use classification.

**APPROVALS REQUIRED:**

U. S. Army Corps of Engineers, Lahontan Regional Water Quality Control Board, and the California Department of Fish and Game

**EXHIBITS:**

- A. Site and Location Map
- B. Land Description

**PERMIT STREAMLINING ACT DEADLINE:**

August 1, 2009

**RECOMMENDED ACTION:**

IT IS RECOMMENDED THAT THE COMMISSION:

**CEQA FINDING:**

FIND THAT THE ACTIVITY IS EXEMPT FROM THE REQUIREMENTS OF THE CEQA PURSUANT TO TITLE 14, CALIFORNIA CODE OF REGULATIONS, SECTION 15061 AS A CATEGORICALLY EXEMPT PROJECT, CLASS 4, MINOR ALTERATION TO LAND; TITLE 2, CALIFORNIA CODE OF REGULATIONS, SECTION 2905 (d)(4).

**SIGNIFICANT LANDS INVENTORY FINDING:**

FIND THAT THIS ACTIVITY IS CONSISTENT WITH THE USE CLASSIFICATION DESIGNATED BY THE COMMISSION FOR THE LAND PURSUANT TO PUBLIC RESOURCES CODE SECTIONS 6370, ET SEQ.

**AUTHORIZATION:**

AUTHORIZE THE ISSUANCE OF A ONE-YEAR DREDGING LEASE TO NORTH TAHOE PUBLIC UTILITY DISTRICT, BEGINNING JUNE 1, 2009, FOR MAINTENANCE DREDGING OF A MAXIMUM OF 200 CUBIC YARDS OF MATERIAL ON THE LANDS SHOWN ON EXHIBIT A (FOR REFERENCE PURPOSES ONLY) AND AS DESCRIBED IN EXHIBIT B ATTACHED AND BY

CALENDAR ITEM NO. **C50** (CONT'D)

THIS REFERENCE MADE A PART HEREOF; DREDGED MATERIAL WILL BE DISPOSED OF AT THE EASTERN REGIONAL LANDFILL IN TRUCKEE. SUCH PERMITTED ACTIVITY IS CONTINGENT UPON APPLICANT'S COMPLIANCE WITH APPLICABLE PERMITS, RECOMMENDATIONS, OR LIMITATIONS ISSUED BY FEDERAL, STATE AND LOCAL GOVERNMENTS; NO MONETARY CONSIDERATION WILL BE CHARGED AS THE DREDGING PROJECT WILL RESULT IN A PUBLIC BENEFIT. THE DREDGED MATERIAL MAY NOT BE SOLD.

NO SCALE

# SITE

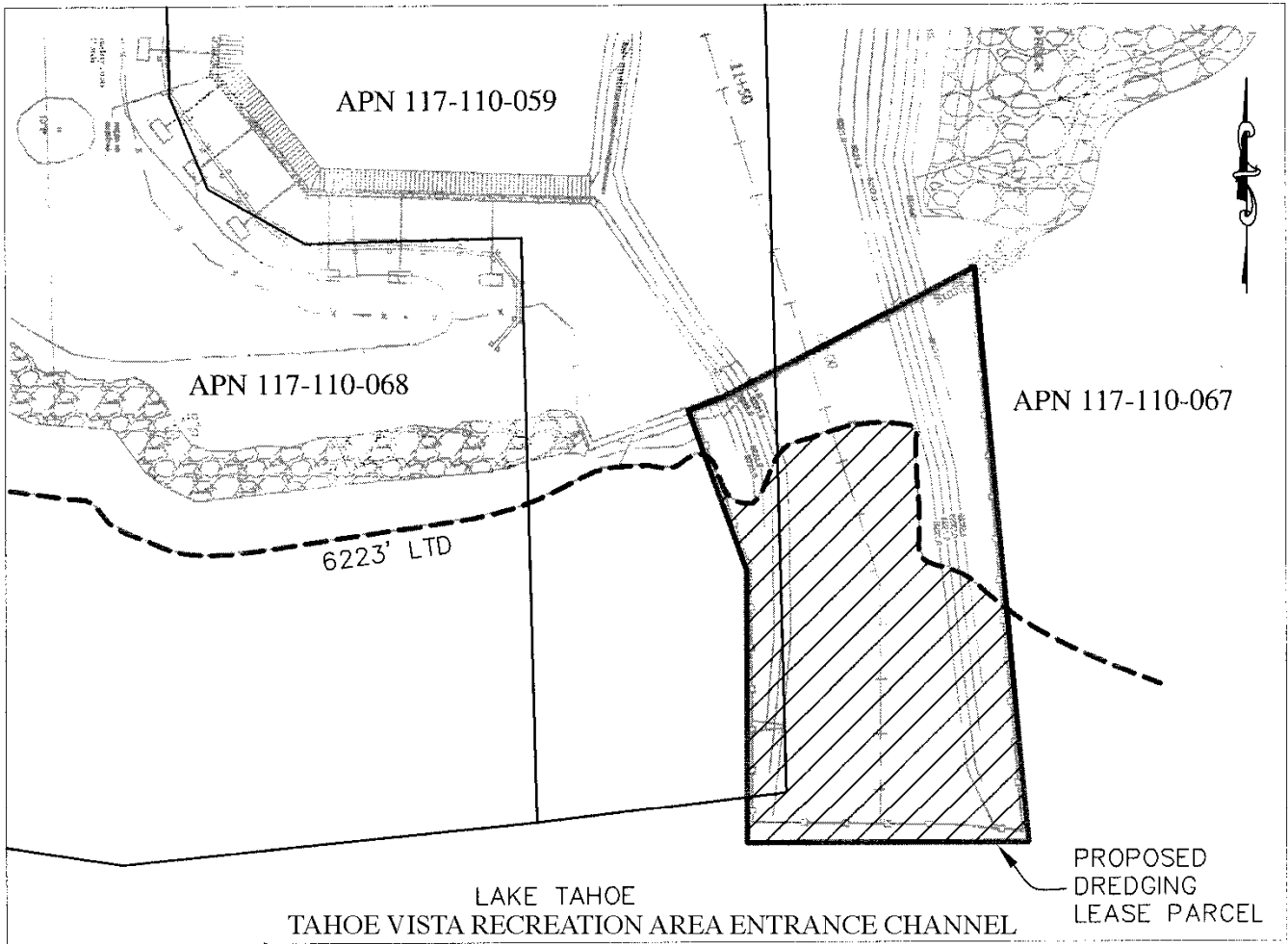

7010 NORTH LAKE BLVD., NEAR TAHOE VISTA

NO SCALE

# LOCATION



MAP SOURCE: USGS QUAD

This Exhibit is solely for purposes of generally defining the lease premises, is based on unverified information provided by the Lessee or other parties and is not intended to be, nor shall it be construed as, a waiver or limitation of any State interest in the subject or any other property.

# Exhibit A

PRC 7368.9  
NORTH TAHOE PUBLIC  
UTILITY DISTRICT  
APN 117-110-056,  
059,067,068  
DREDGING LEASE  
PLACER COUNTY

# SITE

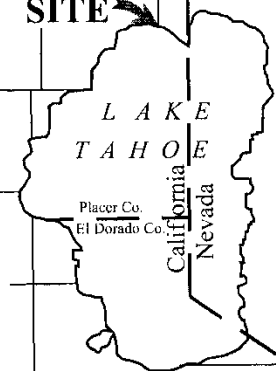

DJF 03/09