

NO SCALE

SITE

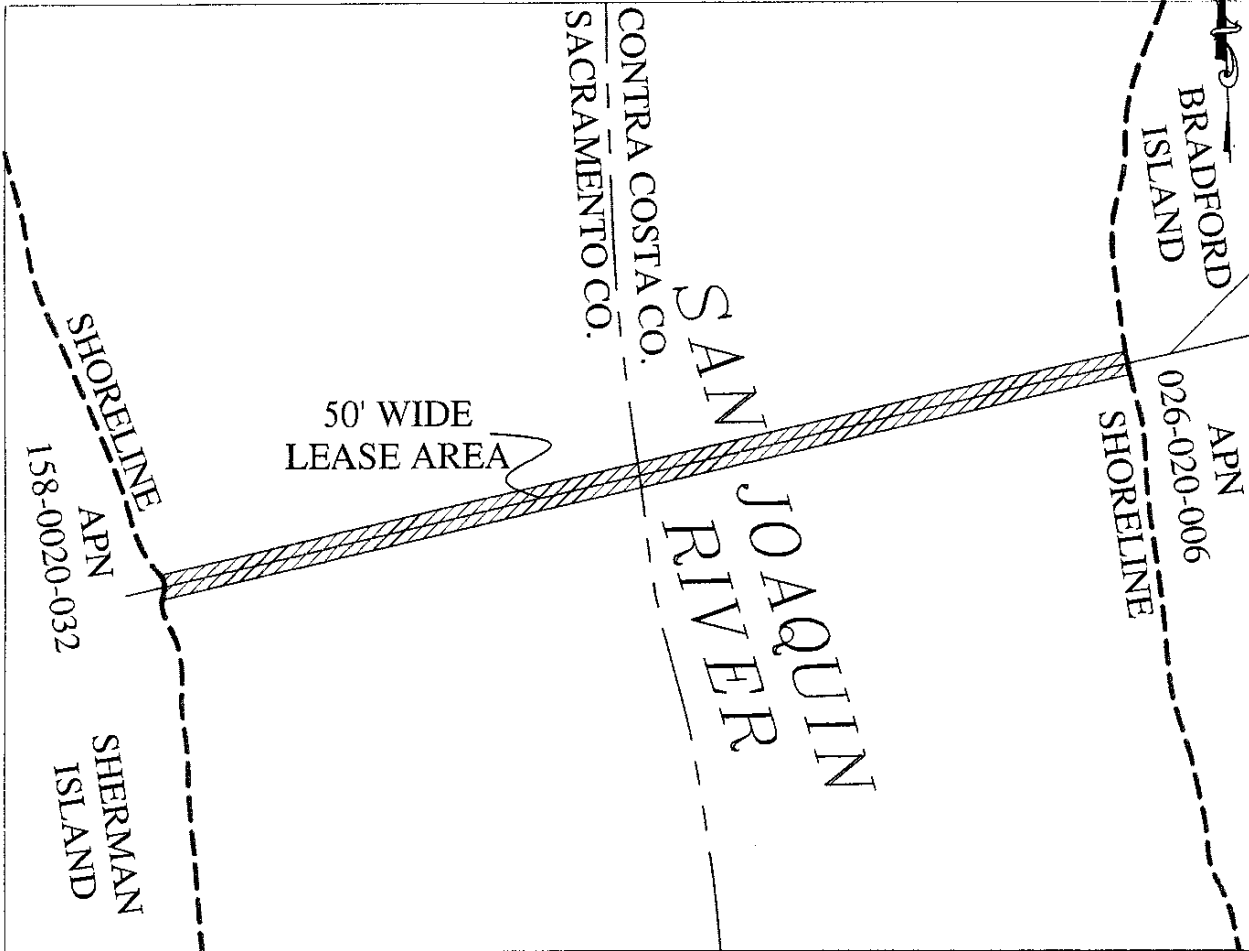

10" Natural Gas Pipeline
San Joaquin River, between Sherman and Bradford Island

NO SCALE

LOCATION



MAP SOURCE: USGS QUAD

Exhibit A

W 26263
 ROSETTA RESOURCES OPERATING LP
 APN 158-0020-032 & APN 026-020-006
 GENERAL LEASE
 RIGHT OF WAY
 SACRAMENTO &
 CONTRA COSTA COUNTY



MJF 3/25/08

This Exhibit is solely for purposes of generally defining the lease premises, is based on unverified information provided by the Lessee or other parties and is not intended to be, nor shall it be construed as, a waiver or limitation of any State interest in the subject or any other property.