

**CALENDAR ITEM
C29**

A 34
S 18

06/24/08
PRC 8462.2
C. Hudson

CONTINUATION OF RENT

LESSEE:

Brubaker-Mann, Inc.
36011 Soap Mine Road
Barstow, CA 92311

AREA, LAND TYPE, AND LOCATION:

1.53 acres, more or less, of State school land located in a portion of Section 30, T10 N, R1E, SBM, and east of Barstow, San Bernardino County.

AUTHORIZED USE:

Continued use and maintenance of an existing unpaved access road.

LEASE TERM:

15 years, beginning July 1, 2003.

CONSIDERATION:

This lease provides that Lessor may modify the rent periodically during the lease term. Pursuant to this provision, staff has conducted a review of the rent under this lease, and recommends that the rent be continued at \$100 per year, effective July 1, 2008.

OTHER PERTINENT INFORMATION:

1. On June 2, 2003, the Commission authorized a General Lease - Right of Way Use with Brubaker-Mann, Inc. That lease will expire on June 30, 2018.
2. The unpaved road is used by Brubaker-Mann, Inc. to access a decorative rock mine that is located on adjacent Federal land under the jurisdiction of the Bureau of Land Management.

CALENDAR ITEM NO. **C29** (CONT'D)

EXHIBIT:

- A. Site and Location Map

RECOMMENDED ACTION:

IT IS RECOMMENDED THAT THE COMMISSION:

CEQA FINDING:

FIND THAT THE ACTIVITY IS NOT SUBJECT TO THE REQUIREMENTS OF THE CEQA PURSUANT TO TITLE 14, CALIFORNIA CODE OF REGULATIONS, SECTION 15060(c)(3) BECAUSE THE ACTIVITY IS NOT A PROJECT AS DEFINED BY PUBLIC RESOURCES CODE SECTION 21065 AND TITLE 14, CALIFORNIA CODE OF REGULATIONS, SECTION 15378.

AUTHORIZATION:

APPROVE THE CONTINUATION OF RENT FOR LEASE NO. PRC 8462.2 AT \$100 PER YEAR, EFFECTIVE July 1, 2008.

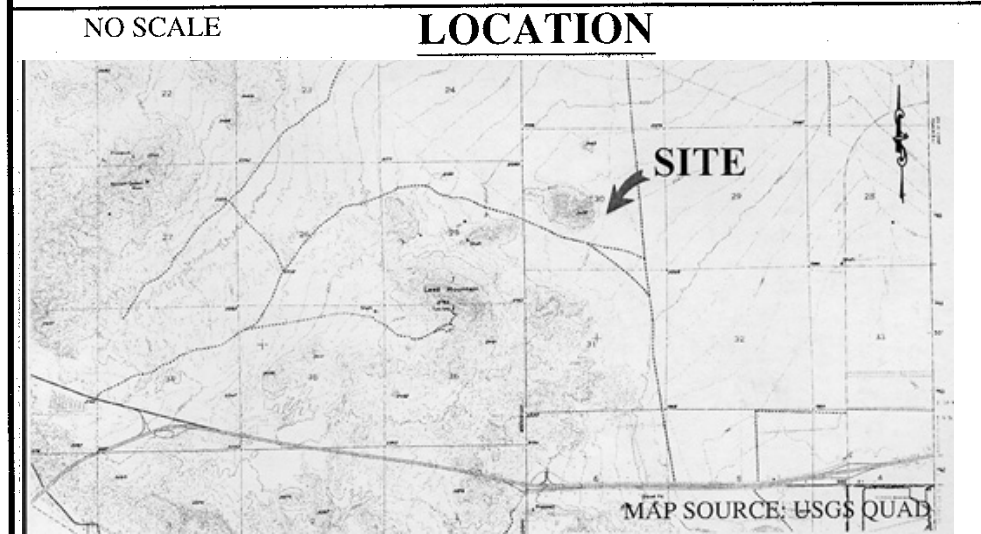
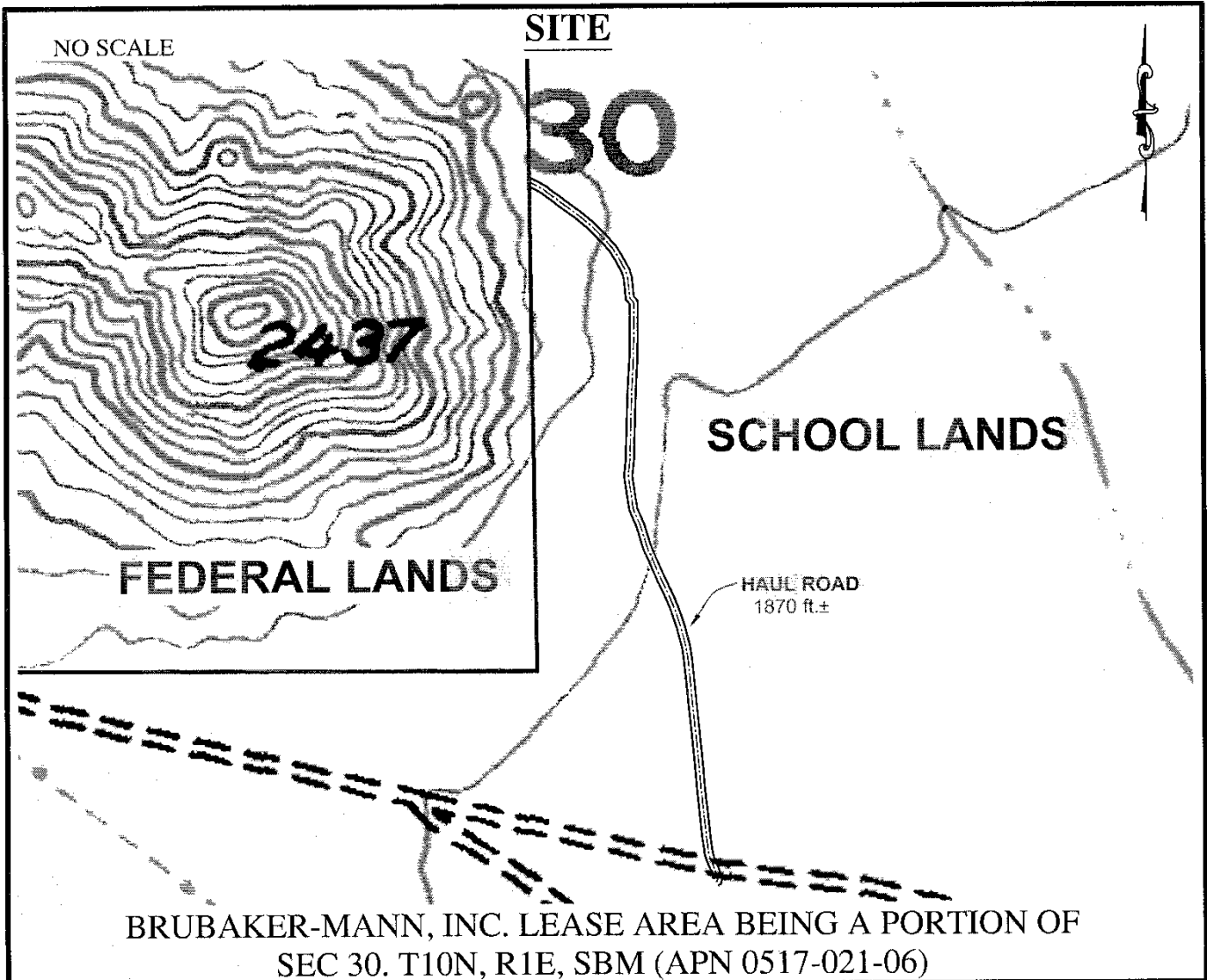

Exhibit A

PRC 8462.2
BRUBAKER-MANN, INC.
SCHOOL LANDS LEASE
SAN BERNARDINO
COUNTY



This Exhibit is solely for purposes of generally defining the lease premises, is based on unverified information provided by the Lessee or other parties and is not intended to be, nor shall it be construed as, a waiver or limitation of any State interest in the subject or any other property.