

MINUTE ITEM

This Calendar Item No. C16 was approved as Minute Item No. 16 by the California State Lands Commission by a vote of 3 to 0 at its 12-03-07 meeting.

CALENDAR ITEM

C16

A 3

12/03/07

S 1

PRC 5531

WP 5531.2

M. Clark

GENERAL LEASE - GRAZING USE

APPLICANT:

John Matley & Son

AREA, LAND TYPE, AND LOCATION:

1,080 acres, more or less, of two state school land parcels located near the town of Doyle, Plumas County.

AUTHORIZED USE:

Cattle grazing.

LEASE TERM:

Ten years, beginning March 20, 2008.

CONSIDERATION:

\$500 per year; with the State reserving the right to fix a different rent periodically during the lease term, as provided in the lease.

SPECIFIC LEASE PROVISIONS:

1. Liability insurance with coverage of no less than \$1,000,000.
2. Number of animals permitted on the Lease Premises is restricted to those that can be supported by the on-site forage and water, taking into consideration forage and water reserved for wildlife.
3. Applicant must exercise good grazing practices to avoid over-grazing.

OTHER PERTINENT INFORMATION:

1. On June 19, 1998, the Commission authorized a ten-year General Lease – Grazing Use with John Matley & Son. That lease will expire March 19, 2008. Applicant is now applying for a new General Lease – Grazing Use.

CALENDAR ITEM NO. C16 (CONT'D)

2. The estimated carrying capacity for Section 16 is 32 Animal Unit Months and for Section 36 it is 14 Animal Unit Months. According to the Applicant, cattle graze and are driven through Section 16 in July and early September and through Section 36 in early August.
3. Pursuant to the Commission's delegation of authority and the State CEQA Guidelines (Title 14, California Code of Regulations, section 15061), the staff has determined that this activity is exempt from the requirements of the CEQA as a categorically exempt project. The project is exempt under Class 4, Minor Alteration to Land; Title 2, California Code of Regulations, section 2905 (d)(1).

Authority: Public Resources Code section 21084 and Title 14, California Code of Regulations, section 15300 and Title 2, California Code of Regulations, section 2905.

4. This activity involves lands identified as possessing significant environmental values pursuant to Public Resources Code sections 6370, et seq. Based upon the staff's consultation with the persons nominating such lands and through the CEQA review process, it is the staff's opinion that the project, as proposed, is consistent with its use classification.

EXHIBITS:

- A. Location Map
- B. Land Description

RECOMMENDED ACTION:

IT IS RECOMMENDED THAT THE COMMISSION:

CEQA FINDING:

FIND THAT THE ACTIVITY IS EXEMPT FROM THE REQUIREMENTS OF THE CEQA PURSUANT TO TITLE 14, CALIFORNIA CODE OF REGULATIONS, SECTION 15061 AS A CATEGORICALLY EXEMPT PROJECT, CLASS 4, MINOR ALTERATION TO LAND; TITLE 2, CALIFORNIA CODE OF REGULATIONS, SECTION 2905 (d)(1).

SIGNIFICANT LANDS INVENTORY FINDING:

FIND THAT THIS ACTIVITY IS CONSISTENT WITH THE USE CLASSIFICATION DESIGNATED BY THE COMMISSION FOR THE

CALENDAR ITEM NO. C16 (CONT'D)

LAND PURSUANT TO PUBLIC RESOURCES CODE SECTIONS 6370,
ET SEQ.

AUTHORIZATION:

AUTHORIZE ISSUANCE TO JOHN MATLEY & SON OF A GENERAL LEASE – GRAZING USE, BEGINNING MARCH 20, 2008, FOR A TERM OF TEN YEARS, FOR CATTLE GRAZING AS SHOWN ON EXHIBIT A ATTACHED AND AS DESCRIBED ON EXHIBIT B ATTACHED AND BY THIS REFERENCE MADE A PART HEREOF; ANNUAL RENT IN THE AMOUNT OF \$500, WITH THE STATE RESERVING THE RIGHT TO FIX A DIFFERENT RENT PERIODICALLY DURING THE LEASE TERM, AS PROVIDED IN THE LEASE; AND LIABILITY INSURANCE FOR COMBINED SINGLE LIMIT COVERAGE OF NO LESS THAN \$1,000,000.

NO SCALE

SITE

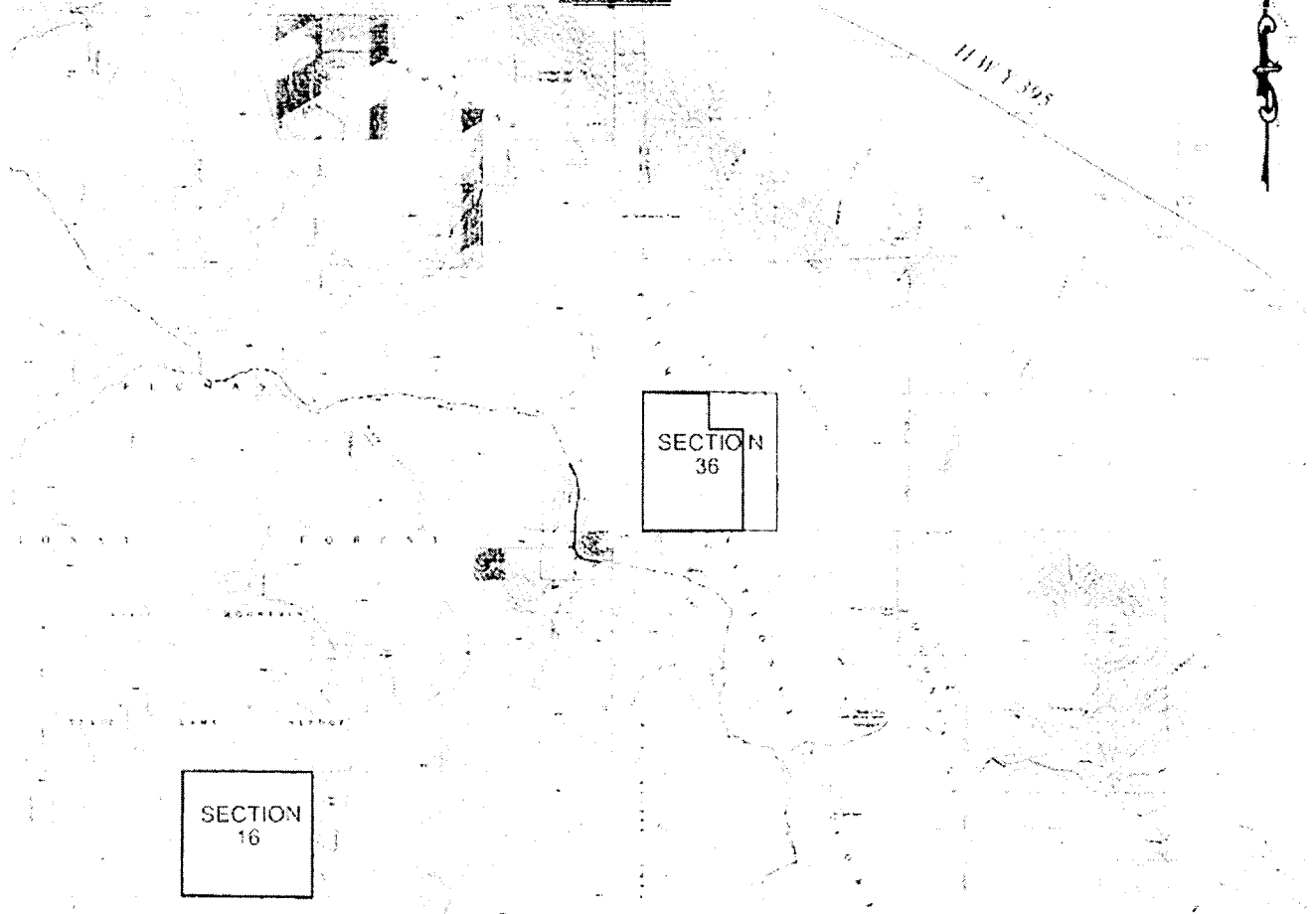

SECTION 16, T25N, R15E, MDM AND W 1/2 & SW 1/4 OF NE 1/4 & W 1/2 OF SE 1/4
OF SECTION 36, T26N, R15E, MDM

NO SCALE

LOCATION

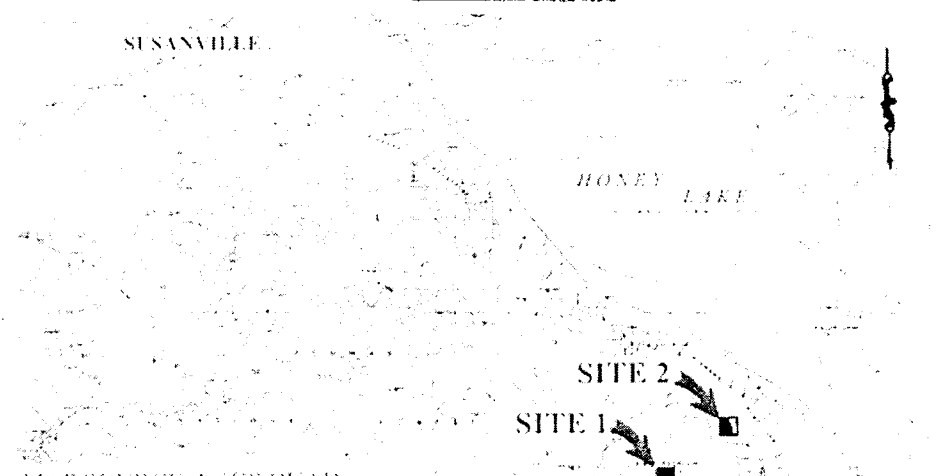

MAP SOURCE: USGS QUAD

This Exhibit is solely for purposes of generally defining the lease premises, is based on unverified information provided by the Lessee or other parties and is not intended to be, nor shall it be construed as, a waiver or limitation of any State interest in the subject or any other property.

Exhibit A

WP 5531.2
MATLEY & SON
SCHOOL LANDS
GENERAL LEASE
GRAZING USE
PLUMAS COUNTY



MJ 0907

000071

CALENDAR PAGE

002905

MINUTE PAGE

Exhibit "B"

LAND DESCRIPTION

PRC 5531

Two parcels of California State School Lands in Plumas County,
California described as follows:

PARCEL 1

Section 16, T25N, R15E, MDM

PARCEL 2

Section 36, T26N, R15E, MDM
W 1/2, SW 1/4 of NE 1/4 and W 1/2 of SE 1/4

END OF DESCRIPTION

000072

CALENDAR PAGE

002937

MINUTE PAGE

4/20/1998