

MINUTE ITEM
This Calendar Item No. C46 was approved as
Minute Item No. 46 by the California State Lands
Commission by a vote of 3 to 0 at its
06/28/07 meeting.

**CALENDAR ITEM
C46**

A 3
S 1

06/28/07
PRC 7241.1
B. Terry

REVISION OF RENT

LESSEE:

123096 Holdings, LLC
C/O Goodlands Management, LLC
250 University Avenue, Suite 300
Palo Alto, CA 94301

AREA, LAND TYPE, AND LOCATION:

0.03 acres, more or less, of sovereign lands in Donner Lake, near Truckee,
Nevada County.

AUTHORIZED USE:

Continued use and maintenance of an existing pier as shown on the attached
Exhibit A.

LEASE TERM:

Ten years, beginning August 14, 2002.

CONSIDERATION:

This lease provides that Lessor may modify the rent periodically during the lease
term. Pursuant to this provision, staff has conducted a review of the rent under
this lease, and recommends that the rent be revised from \$247 per year to
\$1,016 per year, effective August 14, 2007.

OTHER PERTINENT INFORMATION:

1. Lessee owns the upland property adjacent to the Lease Premises.
2. Lessee does not qualify for a rent-free Recreational Pier Lease because
the Lessee is not a natural person and therefore does not meet the
qualifications pursuant to Public Resource Code section 6503.5.

EXHIBIT:

- A. Site and Location Map

CALENDAR ITEM NO. C46 (CONT'D)

RECOMMENDED ACTION:

IT IS RECOMMENDED THAT THE COMMISSION:

CEQA FINDING:

FIND THAT THE ACTIVITY IS NOT SUBJECT TO THE REQUIREMENTS OF THE CEQA PURSUANT TO TITLE 14, CALIFORNIA CODE OF REGULATIONS, SECTION 15060(c)(3) BECAUSE THE ACTIVITY IS NOT A PROJECT AS DEFINED BY PUBLIC RESOURCES CODE SECTION 21065 AND TITLE 14, CALIFORNIA CODE OF REGULATIONS, SECTION 15378.

AUTHORIZATION:

APPROVE THE REVISION OF RENT FOR LEASE NO. PRC 7241.1 FROM \$247 PER YEAR TO \$1,016 PER YEAR, EFFECTIVE AUGUST 14, 2007.

NO SCALE

SITE

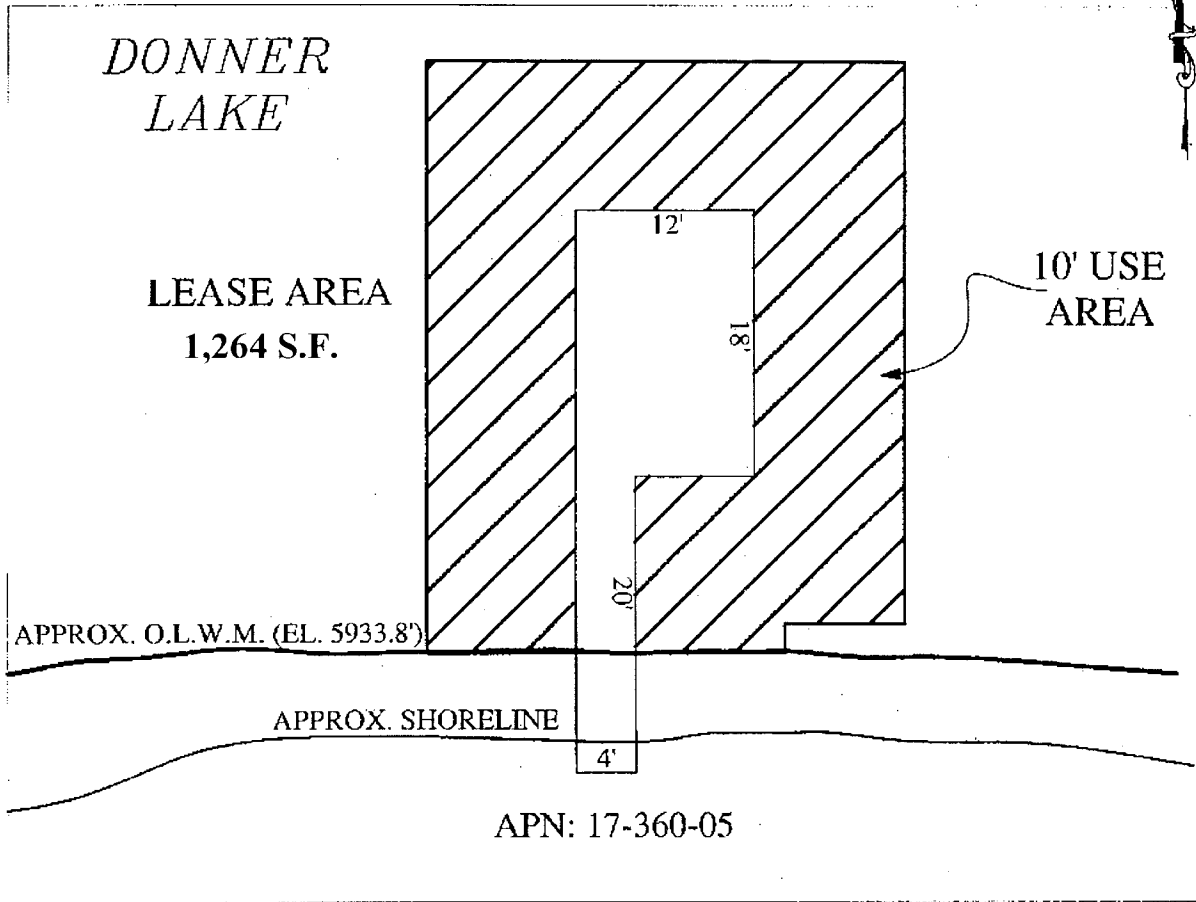

13800 South Shore Drive, Donner Lake

NO SCALE

LOCATION

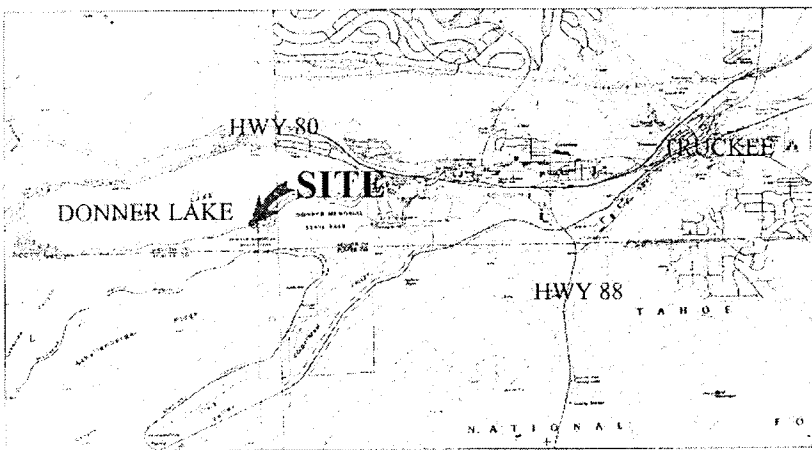

MAP SOURCE: USGS QUAD

Exhibit A

PRC 7241.1
 123096 HOLDINGS, LLC
 APN: 17-360-05
 GENERAL LEASE
 RECREATIONAL USE
 NEVADA COUNTY



MJP 5/10/07

This Exhibit is solely for purposes of generally defining the lease premises, is based on unverified information provided by the Lessee or other parties and is not intended to be, nor shall it be construed as, a waiver or limitation of any State interest in the subject or any other property.

000248

CALENDAR PAGE

001670

MINUTE PAGE