

MINUTE ITEM
This Calendar Item No. C24 was approved as
Minute Item No. 24 by the California State Lands
Commission by a vote of 3 to 0 at its
06/28/07 meeting.

CALENDAR ITEM
C24

A 7
S 2

06/28/07
PRC 8456.1
M. Clark

CONTINUATION OF RENT

LESSEES:

Matthew A. and Pamela T. Young

AREA, LAND TYPE, AND LOCATION:

0.07 acres, more or less, of sovereign lands in the Napa River, near the city of Napa, Napa County.

AUTHORIZED USE:

Continued use and maintenance of an existing walkway and four attached uncovered boat docks creating one dock measuring 150 feet in length.

LEASE TERM:

Ten years, beginning January 5, 2003.

CONSIDERATION:

This lease provides that Lessor may modify the rent periodically during the lease term. Pursuant to this provision, staff has conducted a review of the rent under this lease, and recommends that the rent be continued at \$510 per year, effective January 5, 2008.

OTHER PERTINENT INFORMATION:

1. On April 7, 2003, the Commission authorized a ten year General Lease – Recreational Use beginning January 5, 2003 to Matthew A. and Pamela T. Young, for an existing walkway and four attached uncovered boat docks, thereby creating one dock measuring 150 feet in length. Lessees do not qualify for a rent free Recreational Pier Lease because there is no residence on the upland.

EXHIBIT:

- A. Site and Location Map

CALENDAR ITEM NO. **C24** (CONT'D)

RECOMMENDED ACTION:

IT IS RECOMMENDED THAT THE COMMISSION:

CEQA FINDING:

FIND THAT THE ACTIVITY IS NOT SUBJECT TO THE REQUIREMENTS OF THE CEQA PURSUANT TO TITLE 14, CALIFORNIA CODE OF REGULATIONS, SECTION 15060(c)(3) BECAUSE THE ACTIVITY IS NOT A PROJECT AS DEFINED BY PUBLIC RESOURCES CODE SECTION 21065 AND TITLE 14, CALIFORNIA CODE OF REGULATIONS, SECTION 15378.

AUTHORIZATION:

APPROVE THE CONTINUATION OF RENT FOR LEASE NO. PRC 8456.1 AT \$510 PER YEAR, EFFECTIVE JANUARY 5, 2008.

NO SCALE

SITE MAP

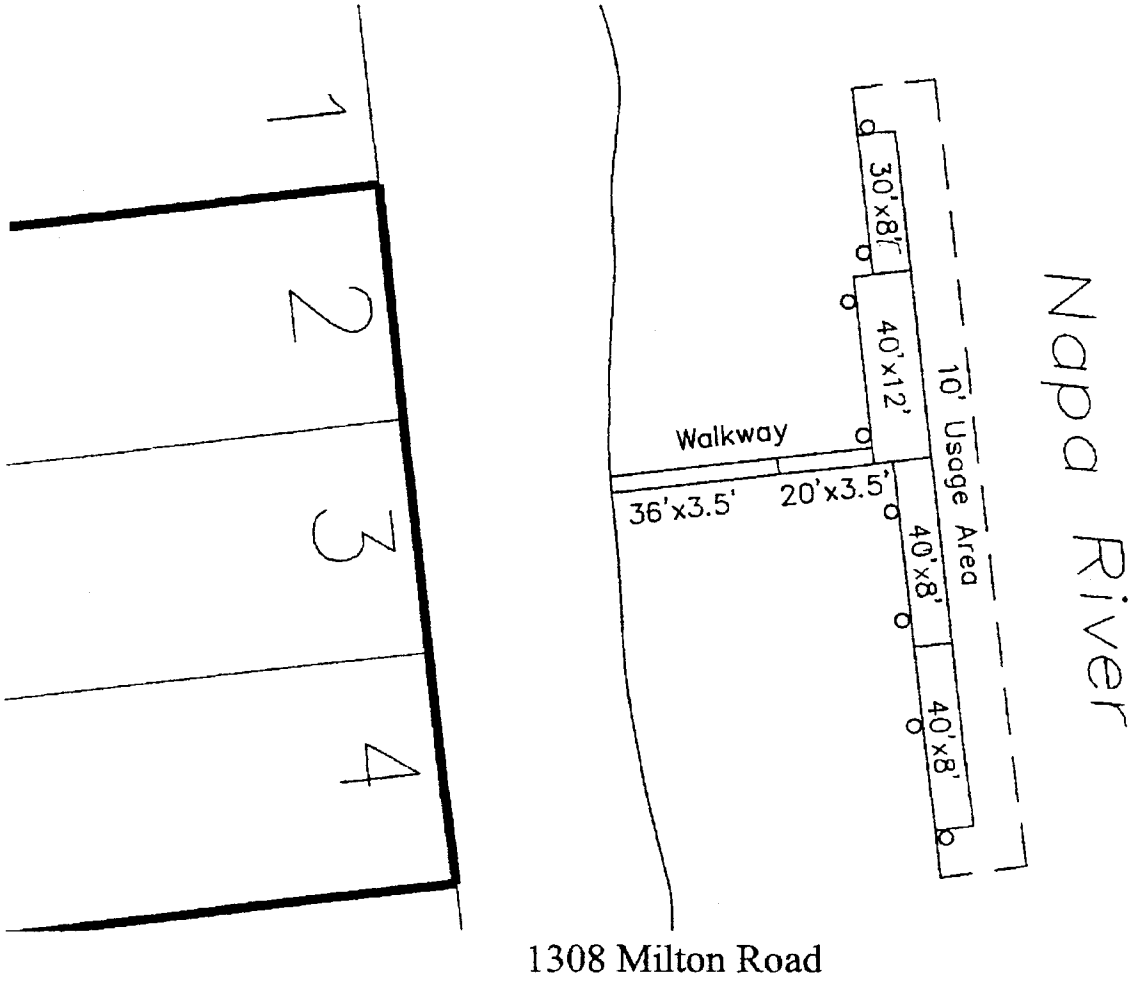

NO SCALE

LOCATION MAP

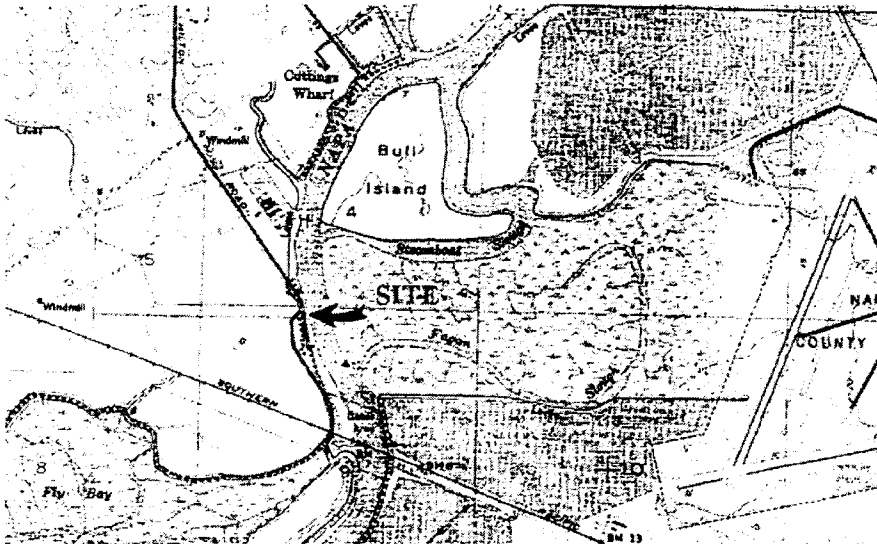
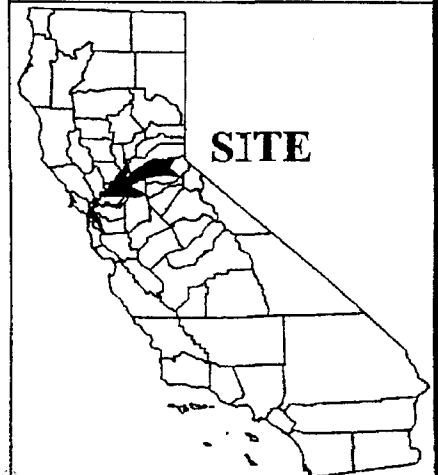

EXHIBIT A PRC 8456.1

APN 047-350-004
 Adrian & Pamela Young
 Walkway & Rec Docks
 Napa County



This Exhibit is solely for purposes of generally defining the lease premises, is based on unverified information provided by Lessee or other parties, and is not intended to be, nor shall it be construed as a waiver or limitation of any state interest in the subject or any other property.

DWC 12-17-01