

CALENDAR ITEM
C21

A 4
S 1

08/08/05
PRC 5267.1
B. Dugal

CONTINUATION OF RENT

LESSEES:

Felton Mark Wyatt and Ann Appleton Wyatt
as Trustees of the Wyatt Trust of 1989.

AREA, LAND TYPE, AND LOCATION:

0.09 acres, more or less, of sovereign lands in Lake Tahoe, near Cedar Flat in
Carnelian Bay, Placer County.

AUTHORIZED USE:

Continued use and maintenance of an existing pier, boathouse, and two mooring
buoys.

LEASE TERM:

Ten years, beginning December 23, 2000.

CONSIDERATION:

This lease provides that Lessor may modify the rent periodically during the lease
term. Pursuant to this provision, staff has conducted a review of the rent under
this lease, and recommends that the rent be continued at \$488 per year, effective
December 23, 2005. Lessees do not qualify for a rent-free recreational pier lease
because they are not owners of the littoral property adjacent to the leased
premises.

EXHIBIT:

A. Site and Location Map

RECOMMENDED ACTION:

IT IS RECOMMENDED THAT THE COMMISSION:

CEQA FINDING:

FIND THAT THE ACTIVITY IS NOT SUBJECT TO THE
REQUIREMENTS OF THE CEQA PURSUANT TO TITLE 14,

CALENDAR ITEM NO. C21 (CONT'D)

CALIFORNIA CODE OF REGULATIONS, SECTION 15060(c)(3)
BECAUSE THE ACTIVITY IS NOT A PROJECT AS DEFINED BY
PUBLIC RESOURCES CODE SECTION 21065 AND TITLE 14,
CALIFORNIA CODE OF REGULATIONS, SECTION 15378.

AUTHORIZATION:

APPROVE THE CONTINUATION OF RENT FOR LEASE NO.
PRC 5267.1 AT \$488 PER YEAR, EFFECTIVE DECEMBER 23, 2005.

Lake Tahoe

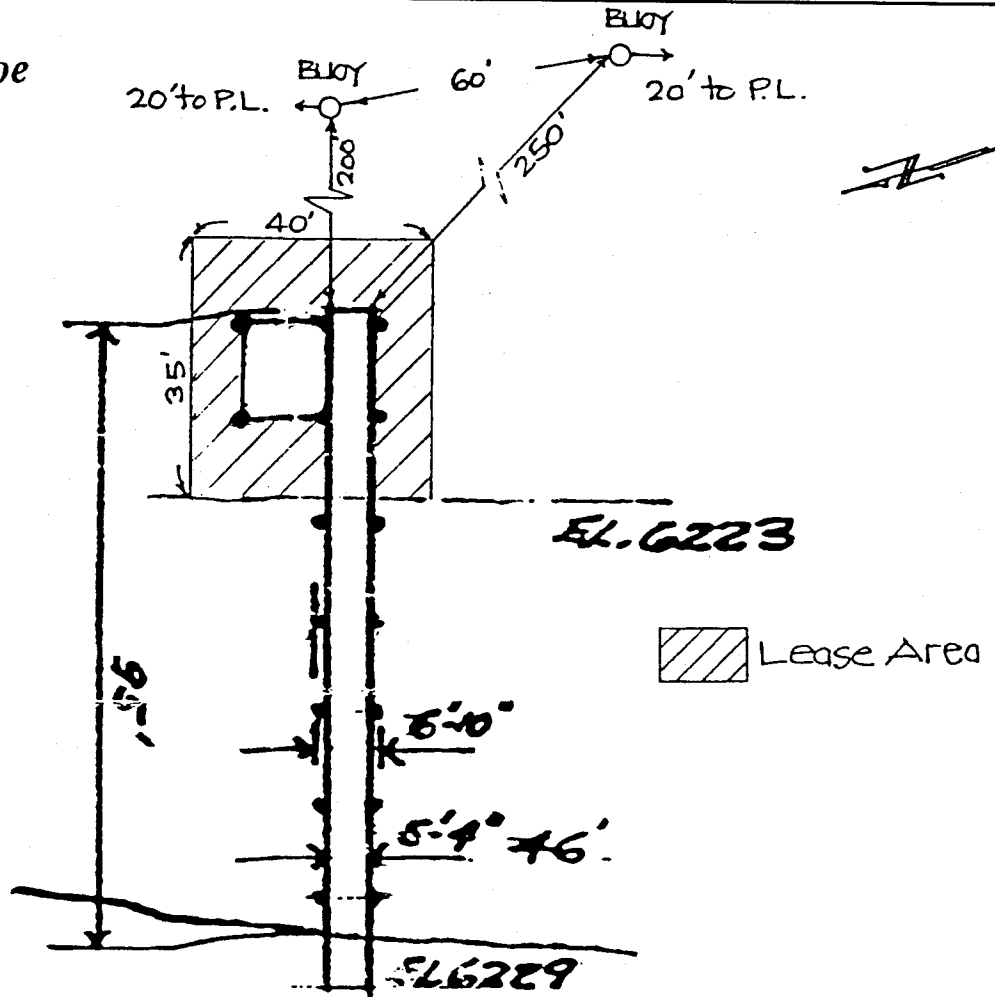

4330 North Lake Blvd., Tahoe City

LOCATION MAP

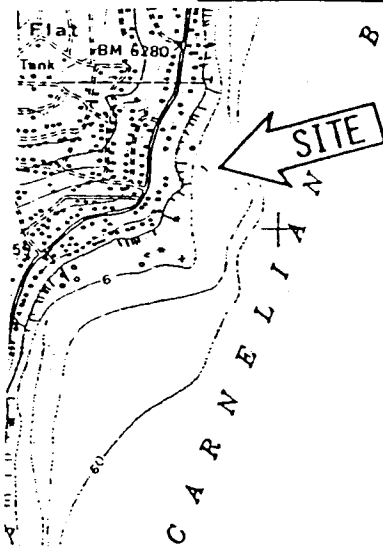

NO SCALE

EXHIBIT A

WP 5267.1
APN 92-180-012
Lake Tahoe
Placer County

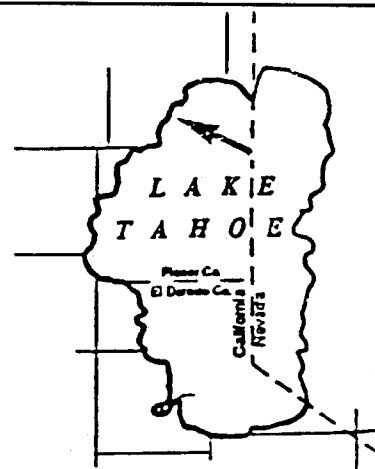

This Exhibit is solely for purposes of generally defining the lease premises, and is not intended to be, nor shall it be construed as, a waiver or limitation of any State interest in the subject or any other property.