

MINUTE ITEM
This Calendar Item No. C06 was approved as
Minute Item No. 06 by the California State Lands
Commission by a vote of 3 to 0 at its
06/20/05 meeting.

**CALENDAR ITEM
C06**

A 2, 5
S 4

06/20/05
PRC 6553 WP 6553.9
T. Lipscomb

RECREATIONAL PIER LEASE

APPLICANTS:

Donald J. Glidewell and Anita K. Glidewell

AREA, LAND TYPE, AND LOCATION:

Sovereign lands in the Sacramento River, adjacent to the Garden Highway (APN: 201-0260-013), near the city of Sacramento, Sacramento County.

AUTHORIZED USE:

The continued use and maintenance of an existing floating boat dock and walkway.

LEASE TERM:

10 years, beginning February 13, 2004.

CONSIDERATION:

No monetary consideration pursuant to Public Resources Code section 6503.5.

SPECIFIC LEASE PROVISIONS:

Liability insurance in the amount of no less than \$300,000.

OTHER PERTINENT INFORMATION:

1. Applicants own the upland adjoining the lease premises.
2. On April 6, 1994, the Commission authorized a Recreational Pier Lease with Louis and Marian Halasz. That lease has expired. The upland property was transferred to Anita K. Glidewell and subsequently transferred to Donald J. Glidewell and Anita K. Glidewell. Donald J. Glidewell and Anita K. Glidewell have applied for a new Recreational Pier Lease. Applicants qualify for a rent-free lease for the floating boat dock and walkway because the applicants are natural persons who have improved the littoral land with, and use the upland for a single-family dwelling.

CALENDAR ITEM NO. C06 (CONT'D)

3. Pursuant to the Commission's delegation of authority and the State CEQA Guidelines (Title 14, California Code of Regulations, section 15061), the staff has determined that this activity is exempt from the requirements of the CEQA as a categorically exempt project. The project is exempt under Class 1, Existing Facilities; Title 2, California Code of Regulations, section 2905 (a)(2).

Authority: Public Resources Code section 21084 and Title 14, California Code of Regulations, section 15300 and Title 2, California Code of Regulations, section 2905.

4. This activity involves lands identified as possessing significant environmental values pursuant to Public Resources Code sections 6370, et seq. Based upon the staff's consultation with the persons nominating such lands and through the CEQA review process, it is the staff's opinion that the project, as proposed, is consistent with its use classification.

EXHIBIT:

- A. Site Plan and Location Map

PERMIT STREAMLINING ACT DEADLINE:

N/A

RECOMMENDED ACTION:

IT IS RECOMMENDED THAT THE COMMISSION:

CEQA FINDING:

FIND THAT THE ACTIVITY IS EXEMPT FROM THE REQUIREMENTS OF THE CEQA PURSUANT TO TITLE 14, CALIFORNIA CODE OF REGULATIONS, SECTION 15061 AS A CATEGORICALLY EXEMPT PROJECT, CLASS 1, EXISTING FACILITIES; TITLE 2, CALIFORNIA CODE OF REGULATIONS, SECTION 2905 (a)(2).

SIGNIFICANT LANDS INVENTORY FINDING:

FIND THAT THIS ACTIVITY IS CONSISTENT WITH THE USE CLASSIFICATION DESIGNATED BY THE COMMISSION FOR THE LAND PURSUANT TO PUBLIC RESOURCES CODE SECTIONS 6370, ET SEQ.

CALENDAR ITEM NO. C06 (CONT'D)

AUTHORIZATION:

AUTHORIZE ISSUANCE TO DONALD J. GLIDEWELL AND ANITA K. GLIDEWELL OF A TEN-YEAR RECREATIONAL PIER LEASE, BEGINNING FEBRUARY 13, 2004, FOR THE CONTINUED USE AND MAINTENANCE OF AN EXISTING FLOATING BOAT DOCK AND WALKWAY AS REPRESENTED ON THE LAND SHOWN ON EXHIBIT A ATTACHED AND BY THIS REFERENCE MADE A PART HEREOF; NO MONETARY CONSIDERATION PURSUANT TO PUBLIC RESOURCES CODE SECTION 6503.5; LIABILITY INSURANCE IN THE AMOUNT OF NO LESS THAN \$300,000.

SITE MAP

SACRAMENTO RIVER
Flow

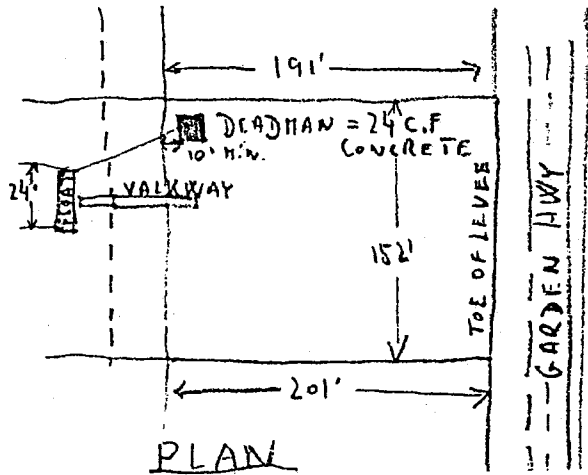

PLAN

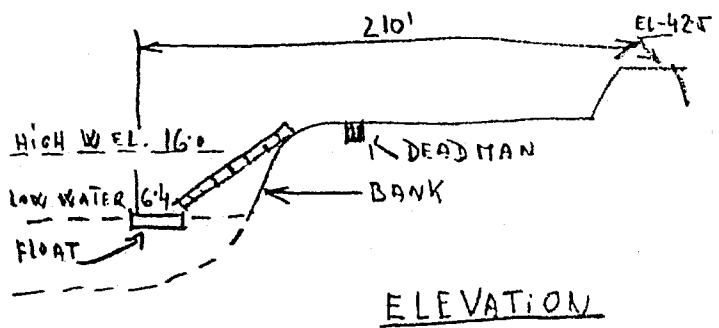

ELEVATION

LOCATION MAP

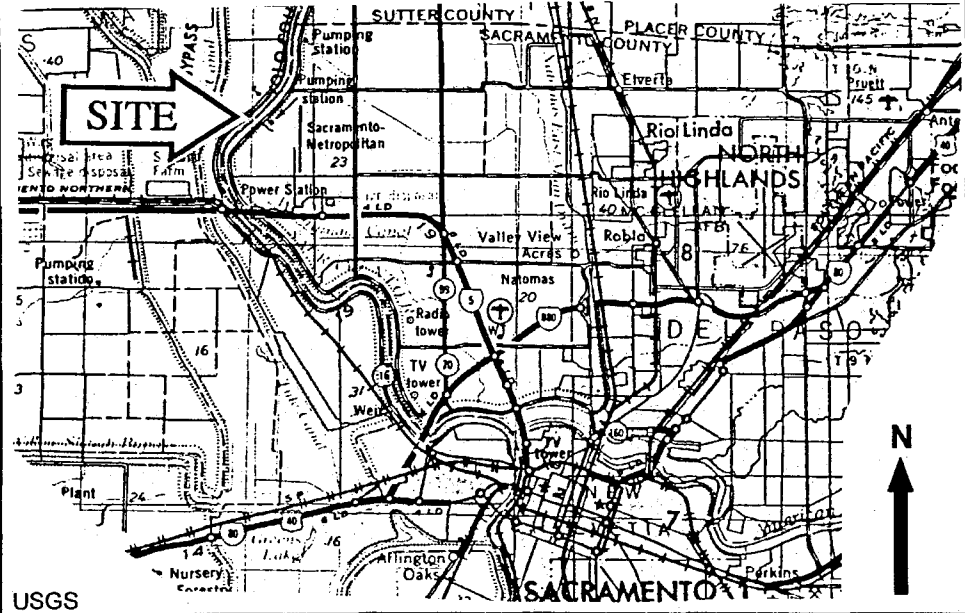

CALIFORNIA MAP



SECTION 3 **Exhibit A**
WP 6553.9
 APN: 201-0260-013 Sacramento County

This exhibit is solely for purposes of generally defining the lease premises, is based on unverified information provided by lessee or other parties, and is not intended to be, nor shall it be construed to as a waiver or limitation of any state interest in the subject or any other property

TKL 04/12/2005

000026
 CALENDAR PAGE

000005
 MINUTE PAGE