

MINUTE ITEM

This Calendar Item No. C29 was approved as
Minute Item No. 29 by the California State Lands
Commission by a vote of 3 to 0 at its
8-17-04 meeting.

CALENDAR ITEM

C29

A 2, 5

PRC 8549

08/17/04

S 4, 6

W 25988

V. Massey

RECREATIONAL PIER LEASE

APPLICANTS:

Steve C. Bohlmann and
Frances J. Bohlmann

AREA, LAND TYPE, AND LOCATION:

Sovereign lands in the Sacramento River, near the city of Sacramento,
Sacramento County.

AUTHORIZED USE:

The construction, use and maintenance of a new floating boat dock, gangway
and pilings.

LEASE TERM:

Ten years, beginning August 1, 2004.

CONSIDERATION:

No monetary consideration pursuant to Public Resources Code section 6503.5.

SPECIFIC LEASE PROVISIONS:

Insurance:

Liability insurance in the amount of no less than \$300,000.

Other:

No activities are authorized and no facilities or improvements shall be
constructed on the lease premises until Lessee provides copies to staff, of
all necessary permits from the California Department of Fish and Game,
California Regional Water Quality Control Board, and the U.S. Army Corps
of Engineers including the U.S. Fish and Wildlife Service and NOAA
Fisheries Final Biological Opinion, if required.

000148

CALENDAR PAGE

001268

MINUTE PAGE

CALENDAR ITEM NO. C29 (CONT'D)

OTHER PERTINENT INFORMATION:

1. Applicants own the upland adjoining the lease premises.
2. Applicants qualify for a Recreational Pier Lease because they are natural persons who have improved the littoral land with, and use the upland for, a single-family dwelling.
3. Pursuant to the Commission's delegation of authority and the State CEQA Guidelines (Title 14, California Code of Regulations, section 15061), the staff has determined that this activity is exempt from the requirements of the CEQA as a categorically exempt project. The project is exempt under Class 3, New Construction of Small Structures; Title 14, California Code of Regulations, section 15303.

Authority: Public Resources Code section 21084 and Title 14, California Code of Regulations, section 15300

4. This activity involves lands identified as possessing significant environmental values pursuant to Public Resources Code sections 6370, et seq. Based upon the staff's consultation with the persons nominating such lands and through the CEQA review process, it is the staff's opinion that the project, as proposed, is consistent with its use classification.

APPROVALS OBTAINED:

NOAA Fisheries, The Reclamation Board.

FURTHER APPROVALS REQUIRED:

U. S. Army Corps of Engineers, U. S. Fish and Wildlife Service, California Department of Fish and Game, County of Sacramento.

EXHIBITS:

- A. Site Map
- B. Location Map

PERMIT STREAMLINING ACT DEADLINE:

November 10, 2004

CALENDAR ITEM NO. C29 (CONT'D)

RECOMMENDED ACTION:

IT IS RECOMMENDED THAT THE COMMISSION:

CEQA FINDING:

FIND THAT THE ACTIVITY IS EXEMPT FROM THE REQUIREMENTS OF THE CEQA PURSUANT TO TITLE 14, CALIFORNIA CODE OF REGULATIONS, SECTION 15061 AS A CATEGORICALLY EXEMPT PROJECT, CLASS 3, NEW CONSTRUCTION OF SMALL STRUCTURES; TITLE 14, CALIFORNIA CODE OF REGULATIONS, SECTION 15303.

SIGNIFICANT LANDS INVENTORY FINDING:

FIND THAT THIS ACTIVITY IS CONSISTENT WITH THE USE CLASSIFICATION DESIGNATED BY THE COMMISSION FOR THE LAND PURSUANT TO PUBLIC RESOURCES CODE SECTIONS 6370, ET SEQ.

AUTHORIZATION:

AUTHORIZE ISSUANCE TO STEVE C. BOHLMANN AND FRANCES J. BOHLMANN OF A TEN-YEAR RECREATIONAL PIER LEASE, AS CONDITIONED, BEGINNING AUGUST 1, 2004, FOR THE CONSTRUCTION, USE AND MAINTENANCE OF A NEW FLOATING BOAT DOCK, GANGWAY AND PILINGS AS REPRESENTED ON THE LAND SHOWN ON EXHIBIT A ATTACHED AND BY THIS REFERENCE MADE A PART HEREOF; NO MONETARY CONSIDERATION PURSUANT TO PUBLIC RESOURCES CODE SECTION 6503.5; LIABILITY INSURANCE IN THE AMOUNT OF NO LESS THAN \$300,000.

FEET
10 30 50
0 100 200

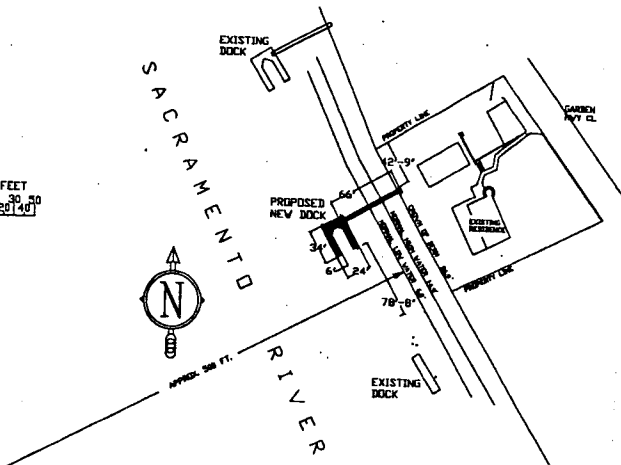

0 0.25 0.5 1 MILE



VICINITY MAP

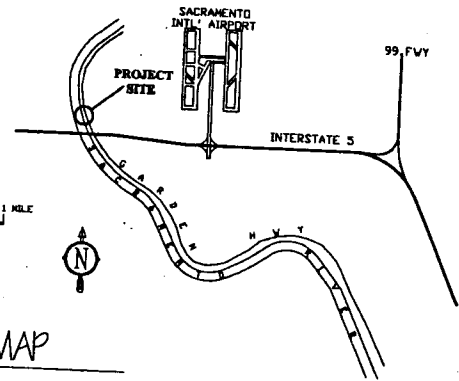

PROPOSED
NEW DOCK

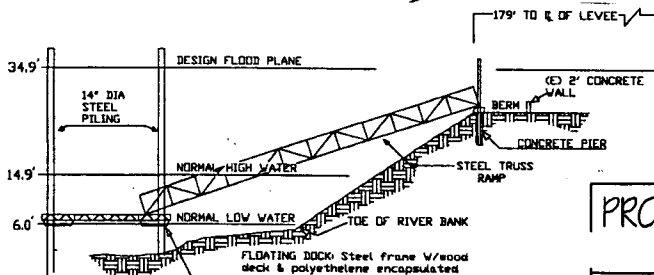
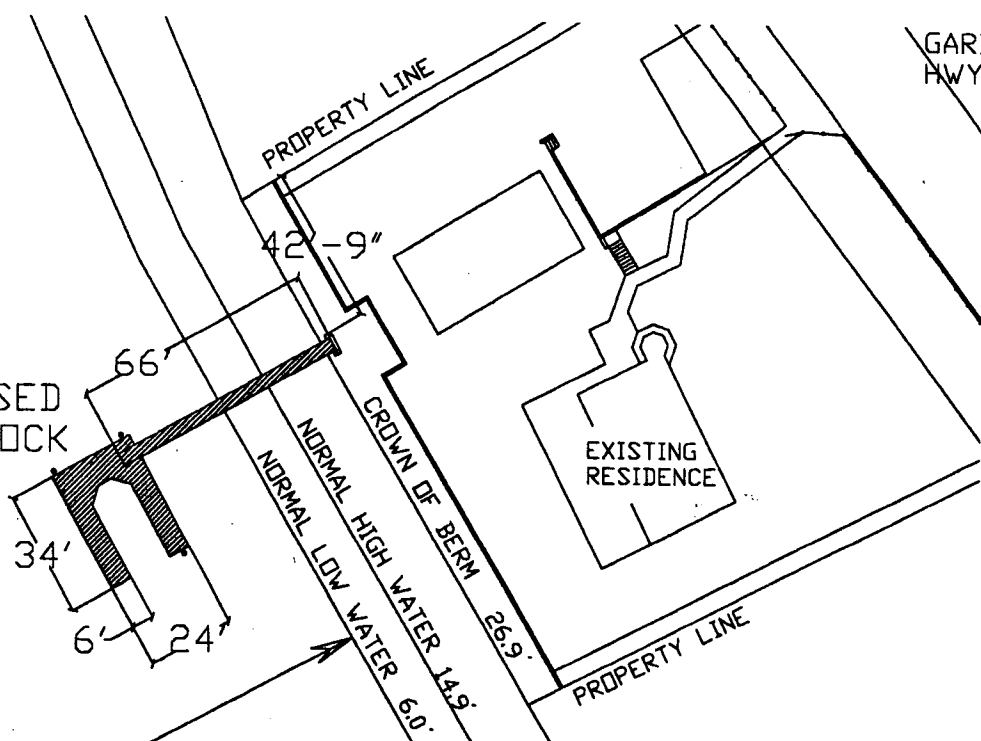

ELEVATION

DATUM - NATIONAL GEODETIC VERTICAL



PROPOSED PRIVATE DOCK on the SACRAMENTO RIVER
SACRAMENTO COUNTY

BOLIN FABRICATING

MR. & MRS. BOHLEMAN
6041 GARDEN HIGHWAY
SACRAMENTO, CA. 95837

Drawn 01-23-2003 C. BOLIN

SHEET 1 OF 1

This exhibit is solely for purposes of generally defining the leased premises, is based on unverified information provided by lessee or other parties, and is not intended to be, nor shall it be construed to as a waiver or limitation of any state interest in the subject or any other property.

Exhibit A
W 25988

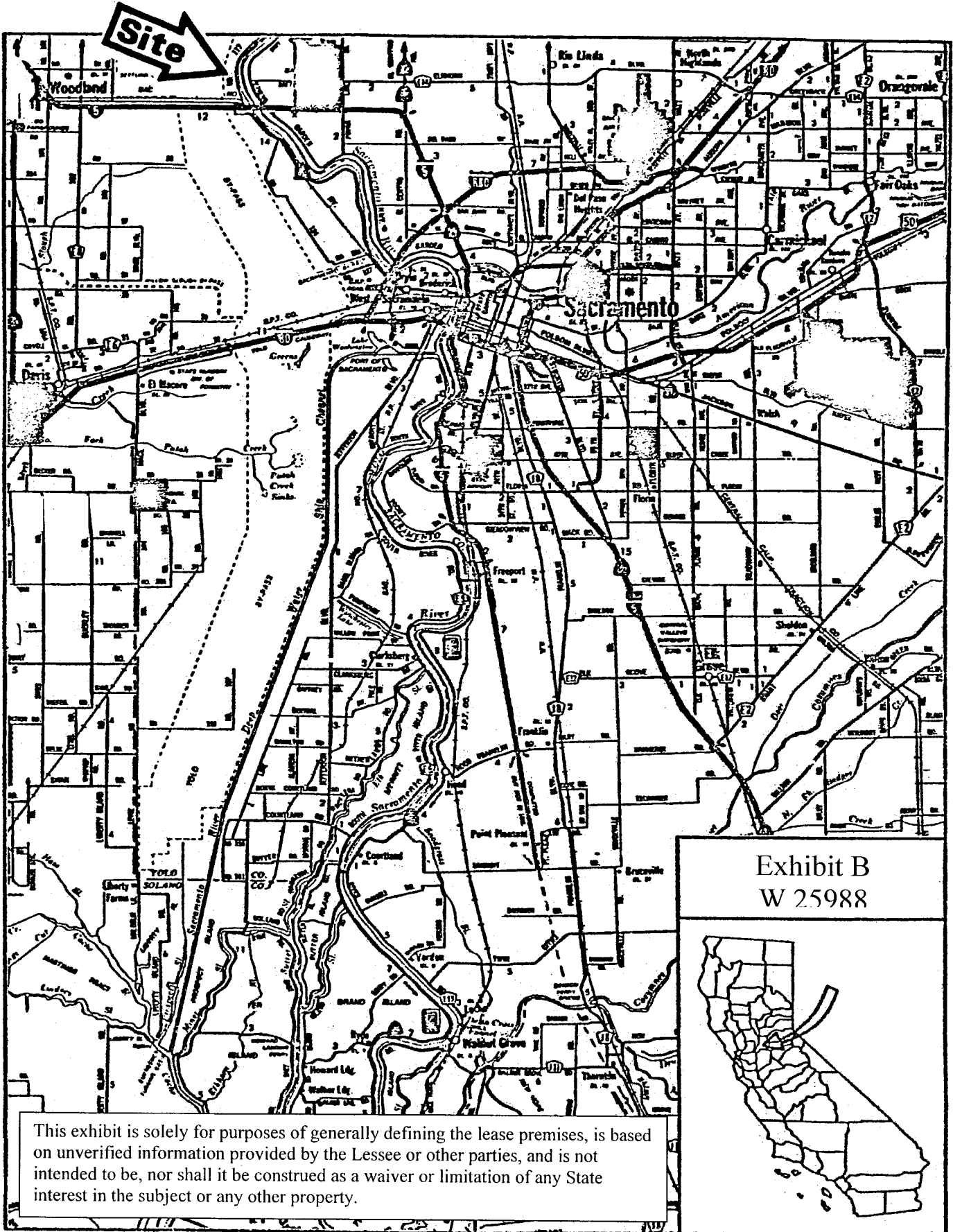

Site

Sacramento

Exhibit B
W 25988

This exhibit is solely for purposes of generally defining the lease premises, is based on unverified information provided by the Lessee or other parties, and is not intended to be, nor shall it be construed as a waiver or limitation of any State interest in the subject or any other property.

