

**MINUTE ITEM**

This Calendar Item No. C15 was approved as Minute Item No. 15 by the California State Lands Commission by a vote of 3 to 0 at its 10-20-03 meeting.

**CALENDAR ITEM  
C15**

A 64  
S 37

10/20/03  
PRC 4465.2  
N. Lee

**REVISION OF RENT**

**LESSEE:**

Southern California Edison  
Attn: Laura Soiorio  
1851 West Valencia, Building F  
Fullerton, CA 92833

**AREA, LAND TYPE, AND LOCATION:**

0.97 acres, more or less, of school lands in Section 36, T6S, R5W, SBM near Elsinore Peak, Riverside County

**AUTHORIZED USE:**

Operation and maintenance of an existing 12kV overhead transmission line.

**LEASE TERM:**

49 years, beginning December 1, 1973.

**CONSIDERATION:**

This lease provides that Lessor may modify the rent periodically during the lease term. Pursuant to this provision, staff has conducted a review of the rent under this lease, and recommends that the rent be revised from \$344 per year to \$392 per year, effective December 1, 2003.

The recommended adjustment of rent is based on adjustment of the prior rent by application of the Consumer Price Index (CPI). The adjustment does not obligate the Commission to use the CPI to adjust future rents other than as specifically set forth herein.

CALENDAR ITEM NO. C15 (CONT'D)

**OTHER PERTINENT INFORMATION:**

1. On February 6, 1974, the Commission authorized a General Lease – Right Of Way Easement to Southern California Edison for a term of 49 years. The easement is for an existing 12kV overhead transmission line across 0.97 acres of State School Land. This lease will expire on November 30, 2022.
  
2. Pursuant to the Commission's delegation of authority and the State CEQA Guidelines [Title 14, California Code of Regulations, section 15060(c)(3)], the staff has determined that this activity is not subject to the provisions of the CEQA because it is not a "project" as defined by the CEQA and the State CEQA Guidelines.

Authority: Public Resources Code section 21065 and Title 14, California Code of Regulations, sections 15060 (c)(3) and 15378.

**EXHIBIT:**

- A. Location and Site Map

**RECOMMENDED ACTION:**

IT IS RECOMMENDED THAT THE COMMISSION:

**CEQA FINDING:**

FIND THAT THE ACTIVITY IS NOT SUBJECT TO THE REQUIREMENTS OF THE CEQA PURSUANT TO TITLE 14, CALIFORNIA CODE OF REGULATIONS, SECTION 15060(c)(3) BECAUSE THE ACTIVITY IS NOT A PROJECT AS DEFINED BY PUBLIC RESOURCES CODE SECTION 21065 AND TITLE 14, CALIFORNIA CODE OF REGULATIONS, SECTION 15378.

**AUTHORIZATION:**

APPROVE THE REVISION OF RENT FOR LEASE NO. PRC 4465.2 FROM \$344 PER YEAR TO \$392 PER YEAR, EFFECTIVE DECEMBER 1, 2003.

NO SCALE

# SITE MAP

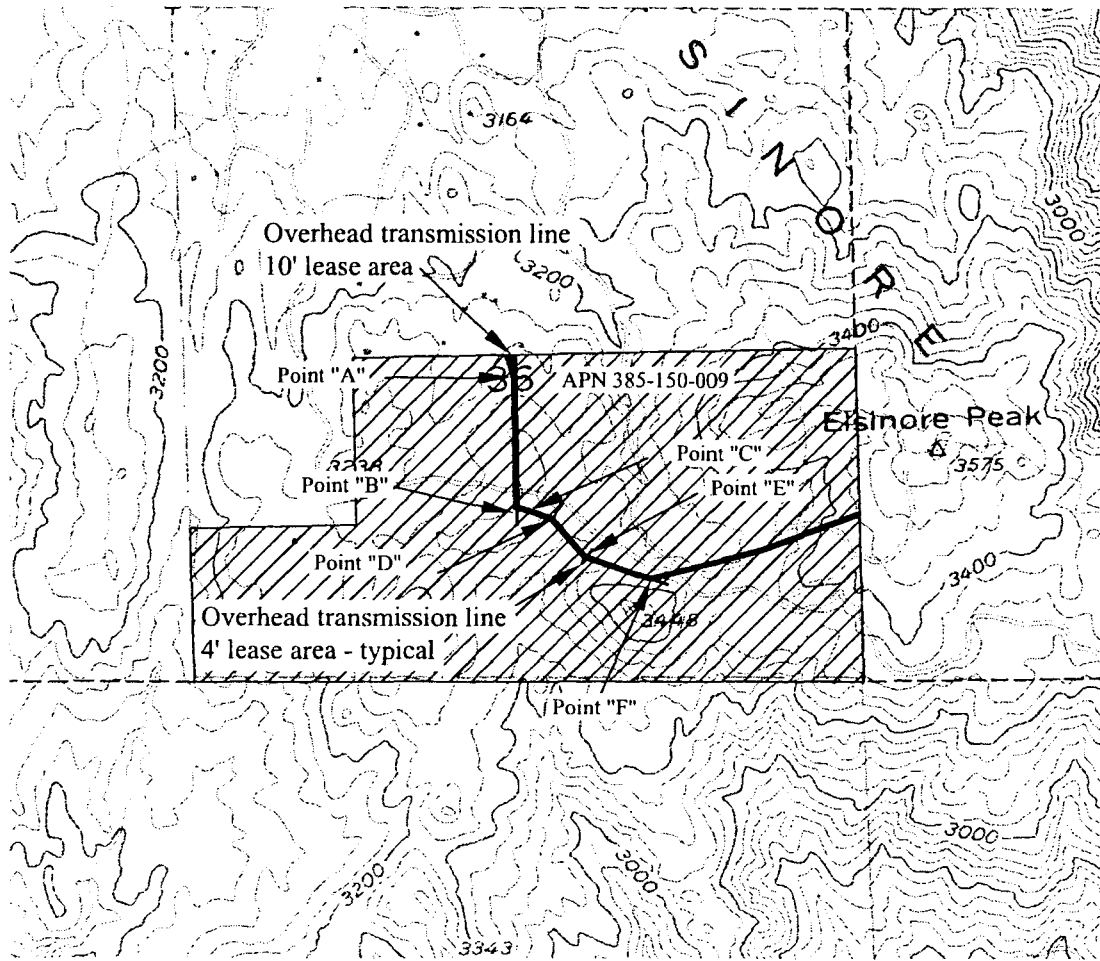

State Owned School Lands  
 Portion of Section 36, T6S, R5W, SBM, Riverside County

# LOCATION MAP

NO SCALE

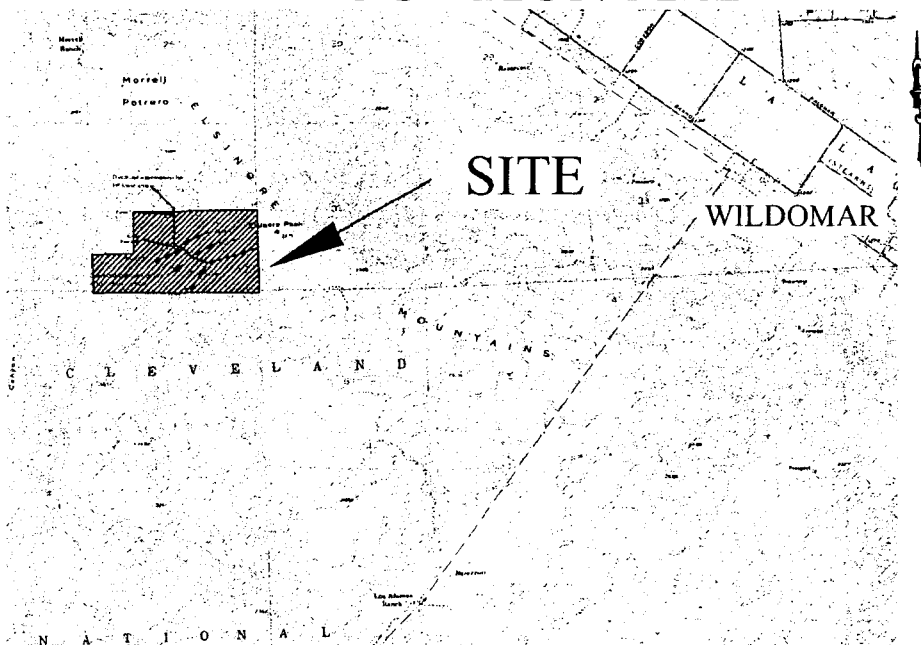

Exhibit A  
 PRC 4465.2  
 APN 385-150-009  
 Southern California Edison  
 near Elsinore Peak  
 Riverside County



This Exhibit is solely for purposes of generally defining the lease premises, is based on unverified information provided by the lessee or other parties and is not intended to be, nor shall it be construed as, a waiver or limitation of any state interest in the subject or any other property. CALENDAR PAGE MAP SOURCE: USGS QUAD

RAH 09-03