

MINUTE ITEM

This Calendar Item No. C18 was approved as Minute Item No. 18 by the California State Lands Commission by a vote of 3 to 0 at its 2-21-03 meeting.

**CALENDAR ITEM
C18**

A 4
S 1

02/21/03
PRC 8444.9 W 25865
M. Hays

RECREATIONAL PIER LEASE

APPLICANTS:

Walter W. Frese and Wendy T. Frese

AREA, LAND TYPE, AND LOCATION:

Sovereign lands in Lake Tahoe, near Tahoe City, Placer County.

AUTHORIZED USE:

Retention of two existing mooring buoys.

LEASE TERM:

Ten years, beginning March 1, 2003.

CONSIDERATION:

No monetary consideration pursuant to Public Resources Code section 6503.5.

SPECIFIC LEASE PROVISIONS:

Insurance:

Liability insurance in the amount of no less than \$300,000.

Other:

This lease is conditioned on the Applicants obtaining authorization from the Tahoe Regional Planning Agency (TRPA) for the mooring buoys within two years after the adoption of the Lake Tahoe Shorezone Amendments-Draft Environmental Impact Statement (EIS) and approval of the ordinances based on the EIS.

OTHER PERTINENT INFORMATION:

1. Applicants qualify for a Recreational Pier Lease because they are natural persons who have improved the littoral land with, and use the upland for, a single-family dwelling. Applicants are now applying for a new

CALENDAR ITEM NO. C18 (CONT'D)

Recreational Pier Lease for two existing mooring buoys not previously authorized by the Commission.

2. Pursuant to the Commission's delegation of authority and the State CEQA Guidelines (Title 14, California Code of Regulations, section 15061), the staff has determined that this activity is exempt from the requirements of the CEQA as a categorically exempt project. The project is exempt under Class 3, New Construction of Small Structures; Title 2, California Code of Regulations, section 2905 (c)(3).

Authority: Public Resources Code section 21084 and Title 14, California Code of Regulations, section 15300 and Title 2, California Code of Regulations, section 2905.

3. This activity involves lands identified as possessing significant environmental values pursuant to Public Resources Code sections 6370, et seq. Based upon the staff's consultation with the persons nominating such lands and through the CEQA review process, it is the staff's opinion that the project, as proposed, is consistent with its use classification.

APPROVALS OBTAINED:

N/A.

FURTHER APPROVALS REQUIRED:

Tahoe Regional Planning Agency

EXHIBIT:

- A. Site and Location Map

PERMIT STREAMLINING ACT DEADLINE:

April 15, 2003

RECOMMENDED ACTION:

IT IS RECOMMENDED THAT THE COMMISSION:

CEQA FINDING:

FIND THAT THE ACTIVITY IS EXEMPT FROM THE REQUIREMENTS OF THE CEQA PURSUANT TO TITLE 14, CALIFORNIA CODE OF REGULATIONS, SECTION 15061 AS A CATEGORICALLY EXEMPT PROJECT, CLASS 3, NEW CONSTRUCTION OF SMALL

CALENDAR ITEM NO. C18 (CONT'D)

STRUCTURES; TITLE 2, CALIFORNIA CODE OF REGULATIONS,
SECTION 2905 (c)(3).

SIGNIFICANT LANDS INVENTORY FINDING:

FIND THAT THIS ACTIVITY IS CONSISTENT WITH THE USE
CLASSIFICATION DESIGNATED BY THE COMMISSION FOR THE
LAND PURSUANT TO PUBLIC RESOURCES CODE SECTIONS 6370,
ET SEQ.

AUTHORIZATION:

AUTHORIZE ISSUANCE TO WALTER W. FRESE AND WENDY T.
FRESE OF A TEN-YEAR RECREATIONAL PIER LEASE, BEGINNING
MARCH 1, 2003, FOR THE RETENTION OF TWO EXISTING MOORING
BUOYS ON THE LAND SHOWN ON EXHIBIT A ATTACHED AND BY
THIS REFERENCE MADE A PART HEREOF; NO MONETARY
CONSIDERATION PURSUANT TO PUBLIC RESOURCES CODE
SECTION 6503.5; LIABILITY INSURANCE IN THE AMOUNT OF NO
LESS THAN \$300,000.

NO SCALE

SITE

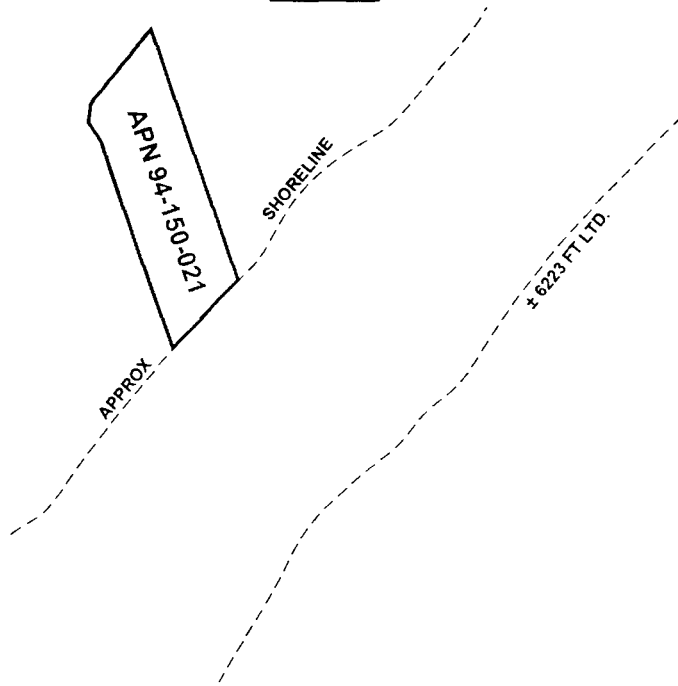

L A K E
T A H O E

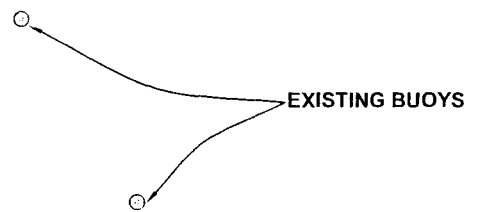

130 SIERRA TERRACE RD, TAHOE CITY

NO SCALE

LOCATION

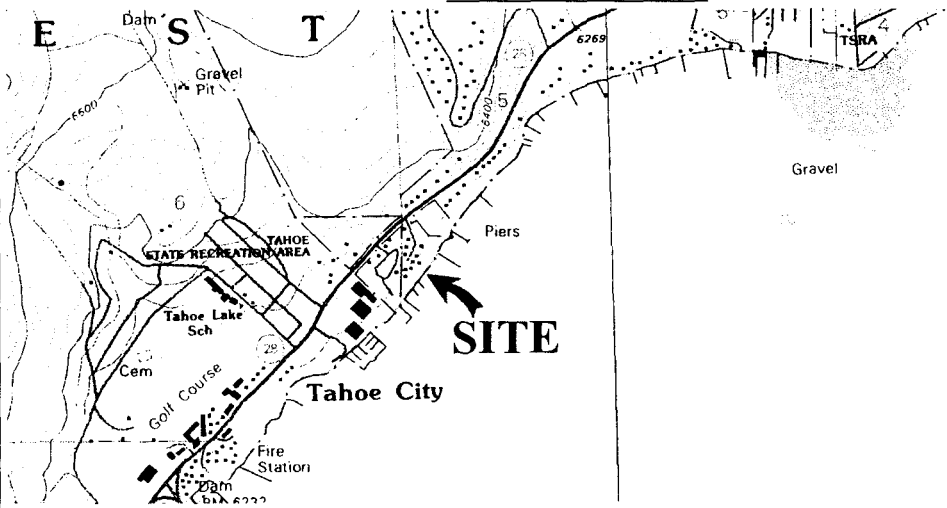

MAP SOURCE: USGS QUAD

Exhibit A

W 25865
 W & W FRESE
 RECREATIONAL PIER
 LEASE
 LAKE TAHOE
 PLACER COUNTY

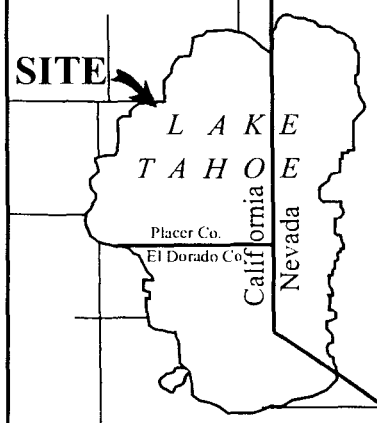

This Exhibit is solely for purposes of generally defining the lease premises, is based on unverified information provided by the Lessee or other parties and is not intended to be, nor shall it be construed as, a waiver or limitation of any State interest in the subject or any other property.

CALENDAR PAGE

MINUTE PAGE