

**MINUTE ITEM**  
This Calendar Item No. C16 was approved as  
Minute Item No. 16 by the California State Lands  
Commission by a vote of 3 to 0 at its  
12-16-02 meeting.

**CALENDAR ITEM  
C16**

A 8  
S 4

12/16/02  
PRC 7630 WP 7630.9  
T. Lipscomb

**RECREATIONAL PIER LEASE**

**APPLICANT:**

Armand J. Fonseca, Jr.  
P.O. Box 1151  
Walnut Grove, CA 95690

**AREA, LAND TYPE, AND LOCATION:**

Sovereign lands in the Sacramento River adjacent to (APN's 142-0097-024 and 142-0098-011), near Walnut Grove, Sacramento County.

**AUTHORIZED USE:**

Continued use and maintenance of an existing 8 foot by 40 foot floating boat dock and ramp.

**LEASE TERM:**

Ten years, beginning March 5, 2002.

**CONSIDERATION:**

No monetary consideration pursuant to Public Resources Code section 6503.5.

**SPECIFIC LEASE PROVISIONS:**

Liability insurance in the amount of no less than \$300,000.

**OTHER PERTINENT INFORMATION:**

1. On December 3, 1999, the Commission authorized a Recreational Pier Permit with Douglas Chan. On March 5, 2002, Douglas Chan deeded the littoral land to Armand J. Fonseca, Jr.. Applicant qualifies for a Recreational Pier Lease because the Applicant is a natural person who has improved the littoral land with, and uses the upland for, a single-family dwelling.
2. Pursuant to the Commission's delegation of authority and the State CEQA Guidelines (Title 14, California Code of Regulations, section 15061), the

CALENDAR ITEM NO. C16 (CONT'D)

staff has determined that this activity is exempt from the requirements of the CEQA as a categorically exempt project. The project is exempt under Class 1, Existing Facilities; Title 2, California Code of Regulations, section 2905 (a)(2).

Authority: Public Resources Code section 21084 and Title 14, California Code of Regulations, section 15300 and Title 2, California Code of Regulations, section 2905.

3. This activity involves lands identified as possessing significant environmental values pursuant to Public Resources Code sections 6370, et seq. Based upon the staff's consultation with the persons nominating such lands and through the CEQA review process, it is the staff's opinion that the project, as proposed, is consistent with its use classification.

**EXHIBITS:**

- A. Lease Description
- B. Location Map

**PERMIT STREAMLINING ACT DEADLINE:**

N/A

**RECOMMENDED ACTION:**

IT IS RECOMMENDED THAT THE COMMISSION:

**CEQA FINDING:**

FIND THAT THE ACTIVITY IS EXEMPT FROM THE REQUIREMENTS OF THE CEQA PURSUANT TO TITLE 14, CALIFORNIA CODE OF REGULATIONS, SECTION 15061 AS A CATEGORICALLY EXEMPT PROJECT, CLASS 1, EXISTING FACILITIES; TITLE 2, CALIFORNIA CODE OF REGULATIONS, SECTION 2905 (a)(2).

**SIGNIFICANT LANDS INVENTORY FINDING:**

FIND THAT THIS ACTIVITY IS CONSISTENT WITH THE USE CLASSIFICATION DESIGNATED BY THE COMMISSION FOR THE LAND PURSUANT TO PUBLIC RESOURCES CODE SECTIONS 6370, ET SEQ.

CALENDAR ITEM NO. C16 (CONT'D)

**AUTHORIZATION:**

AUTHORIZE ISSUANCE TO ARMAND J. FONSECA, JR. OF A TEN-YEAR RECREATIONAL PIER LEASE, BEGINNING MARCH 5, 2002, FOR CONTINUED USE AND MAINTENANCE OF AN EXISTING FLOATING BOAT DOCK AND RAMP ON THE LAND SHOWN ON EXHIBIT A ATTACHED AND BY THIS REFERENCE MADE A PART HEREOF; NO MONETARY CONSIDERATION PURSUANT TO PUBLIC RESOURCES CODE SECTION 6503.5; LIABILITY INSURANCE IN THE AMOUNT OF NO LESS THAN \$300,000.

# SITE PLAN

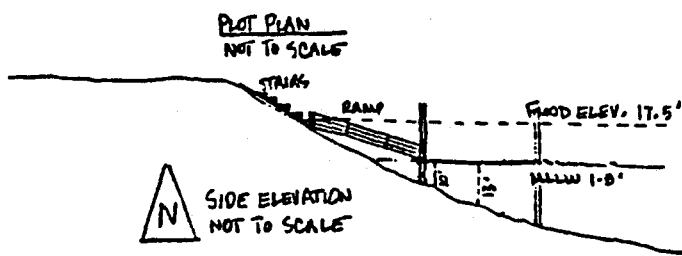
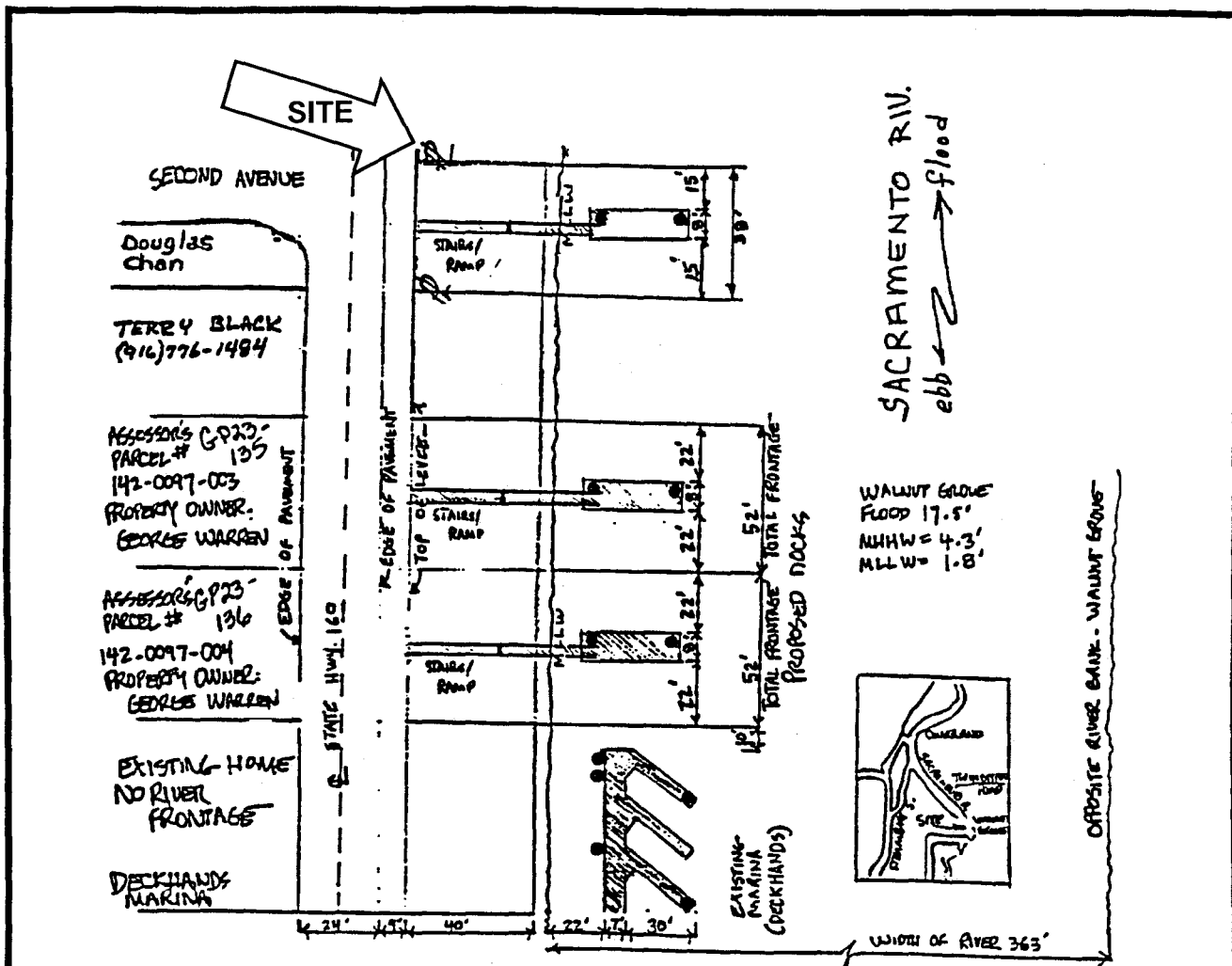

**Proposed**  
**3'x40' dock**  
 w/piling

14850 Hwy 160  
 WALNUT GROVE, CA  
 95690

PARCEL NUMBERS  
 142-0097-002

DATE: 2/20/91  
 REV: 9/19/91

This exhibit is solely for purposes of generally defining the area to be leased, and is not intended to be, nor shall it be construed as, a waiver or limitation of any State interest in the subject or other property.

**Exhibit A**  
**WP 7630**

TKL 10/04/2002

# Location Map

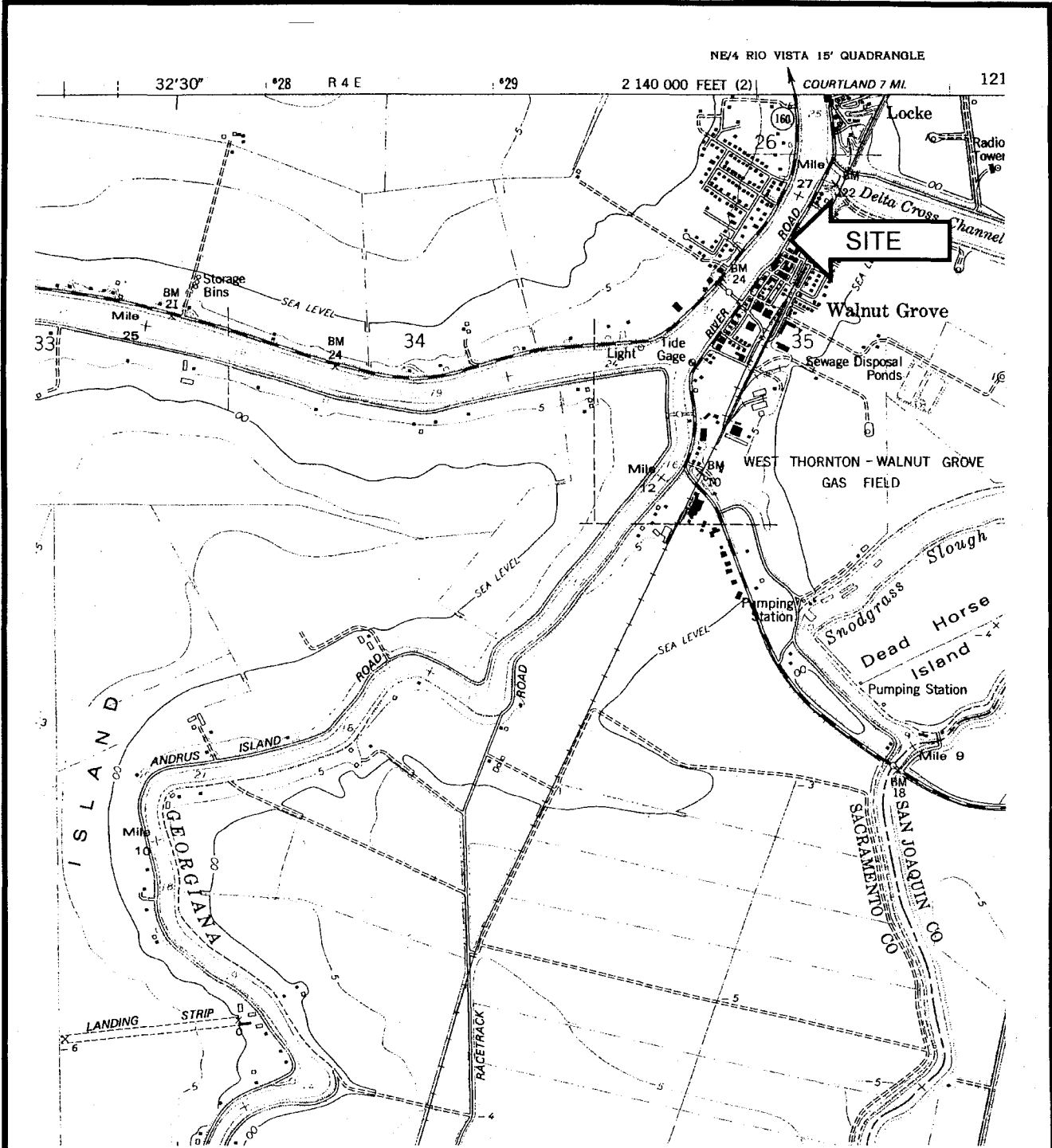

EXHIBIT CONSTRUCTED FROM USGS QUAD: ISLETON, CA. 1:24 000

This exhibit is solely for purposes of generally defining the lease premises, is based on unverified information provided by Lessee or other parties, and is not intended to be, nor shall it be construed as, a waiver or limitation of any state interest in the subject or other property.

**Exhibit B**  
**WP 7630**

TKL 10/30/2002

000075  
CALENDAR PAGE

002250  
MINUTE PAGE