

**MINUTE ITEM**  
This Calendar Item No. C53 was approved as  
Minute Item No. 53 by the California State Lands  
Commission by a vote of 3 to 0 at its  
10-01-02 meeting.

**CALENDAR ITEM  
C53**

A	34		10/01/02
		PRC 4629	WP 4629
S	17		S.Young

**GENERAL LEASE - RIGHT OF WAY USE**

**LESSEE:**

Southern California Edison Company  
1851 W. Valencia Blvd., Bldg. F  
Fullerton, California 92833

**AREA, LAND TYPE, AND LOCATION:**

4.67 acres, more or less, of school lands in Section 36, T20N, R8E and Section 36, T20N, R9E, SBM, near the town of Tecopa, Inyo and San Bernardino counties.

**AUTHORIZED USE:** Continued use and maintenance of an existing 33 Kv electrical facility.

**LEASE TERM:**

15 years, beginning August 25, 2001.

**CONSIDERATION:**

\$200 per year, with the State reserving the right to fix a different rent periodically during the lease term, as provided in the lease.

**SPECIFIC LEASE PROVISIONS:**

Combined single limit coverage of no less than \$2,000,000.

**OTHER PERTINENT INFORMATION:**

1. Applicant has a right to use the lands adjoining the lease premises.
2. On October 28, 1971, the Commission authorized a 15-year General Lease-Right of Way Use with Southern California Edison Company, beginning August 25, 1971. On August 28, 1986, the Commission approved a new 15-year lease with Southern California Edison Company effective August 25, 1985. Southern California Edison Company is now

CALENDAR ITEM NO. C53 (CONT'D)

applying for a new lease. Staff is recommending that the Commission approve a 15-year General Lease – Right of Way Use with Southern California Edison Company.

3. Pursuant to the Commission's delegation of authority and the State CEQA Guidelines (Title 14, California Code of Regulations, section 15061), the staff has determined that this activity is exempt from the requirements of the CEQA as a categorically exempt project. The project is exempt under Class 1, Existing Facilities: Title 2, California Code of Regulations, section 2905 (a)(2).

Authority: Public Resources Code section 21084 and Title 14, California Code of Regulations, section 15300 and Title 2, California Code of Regulations, section 2905.

4. This activity involves lands which have NOT been identified as possessing significant environmental values pursuant to Public Resources Code sections 6370, et seq. However, the Commission has declared that all lands are "significant" by nature of their public ownership (as opposed to "environmentally significant"). Since such declaration of significance is not based upon the requirements and criteria of Public Resources Code sections 6370, et seq., use classifications for such lands have not been designated. Therefore, the finding of the project's consistency with the use classification as required by Title 2, California Code of Regulations, and section 2954 is not applicable.

**EXHIBITS:**

- A. Land Description
- B. Location Map

**PERMIT STREAMLINING ACT DEADLINE:**

N/A

**RECOMMENDED ACTION:**

IT IS RECOMMENDED THAT THE COMMISSION:

**CEQA FINDING:**

FIND THAT THE ACTIVITY IS EXEMPT FROM THE REQUIREMENTS OF THE CEQA PURSUANT TO TITLE 14, CALIFORNIA CODE OF REGULATIONS, SECTION 15061 AS A CATEGORICALLY EXEMPT

CALENDAR ITEM NO. C53 (CONT'D)

PROJECT, CLASS 1, EXISTING FACILITIES; TITLE 2, CALIFORNIA CODE OF REGULATIONS, SECTION 2905 (a)(2).

**AUTHORIZATION:**

AUTHORIZE ISSUANCE TO SOUTHERN CALIFORNIA EDISON COMPANY OF A GENERAL LEASE - RIGHT OF WAY USE, BEGINNING AUGUST 25, 2001, FOR A TERM OF 15 YEARS FOR CONTINUED USE AND MAINTENANCE OF AN EXISTING 33 KV ELECTRICAL FACILITY ON THE LAND DESCRIBED ON EXHIBIT A ATTACHED AND BY THIS REFERENCE MADE A PART HEREOF; ANNUAL RENT IN THE AMOUNT OF \$200, WITH THE STATE RESERVING THE RIGHT TO FIX A DIFFERENT RENT PERIODICALLY DURING THE LEASE TERM AS PROVIDED IN THE LEASE; LIABILITY INSURANCE FOR COMBINED SINGLE LIMIT COVERAGE OF \$2,000,000.

EXHIBIT "A"

LAND DESCRIPTION

WP 4629

Two parcels of California State school lands in San Bernardino County and Inyo County, California, said parcels being described as follows:

PARCEL 1

A strip of land 25 feet wide lying within the N1/2 of Section 36, T20N, R8E, SBM, San Bernardino County and Inyo County, California, the centerline of said strip being described as follows:

BEGINNING at a point on the north line of said Section 36 from which the northwest corner thereof bears S 89°58'00" W 301.25 feet; thence S 0°00'05" W, 21.38 feet to a point hereinafter referred to as Point "A"; thence S 73°38' 55" E, 5188.97 feet, more or less, to a point on the east line of said Section 36, from which the northeast corner thereof bears North, 1485.63 feet.

TOGETHER WITH the following two strip of land 4 feet in width, the centerlines of which are described as follows:

Strip 1; BEGINNING at Point "A"; thence N 73°38'55" W, 40 feet:

Strip 2; BEGINNING at Point "A", thence S 0°00'05" W, 40 feet.

PARCEL 2

A strip of land 25 feet wide lying within the N1/2 of Section 36, T20N, R9E, SBM, San Bernardino County, California, the centerline of said strip being described as follows:

BEGINNING at a point on the north line of said Section 36 from which the northeast corner thereof bears East, 2864.57 feet; thence S 87°03'10" E, 936.87 feet to a point hereinafter referred to as Point "B"; thence S 80°06'10" E, 1395.58 feet to a point hereinafter referred to as Point "C"; thence S 75°51'40" E, 571.44 feet to a point on the east line of said Section 36 from which the northeast corner thereof bears North, 427.63 feet.

TOGETHER WITH the following two strips of land 4 feet in width, the centerlines of which are described as follows:

Strip 3; beginning at Point "B"; thence N 6°10'00" E, 40 feet:

Strip 4; BEGINNING at Point "C"; thence N 12°01'00" E, 40 feet.

END OF DESCRIPTION

REVISED MARCH 24, 1986 BY BOUNDARY SERVICES UNIT, M. L. SHAFER, SUPERVISOR.

000249

CALENDAR PAGE

001988

MINUTE PAGE

NO SCALE

# SITE MAP

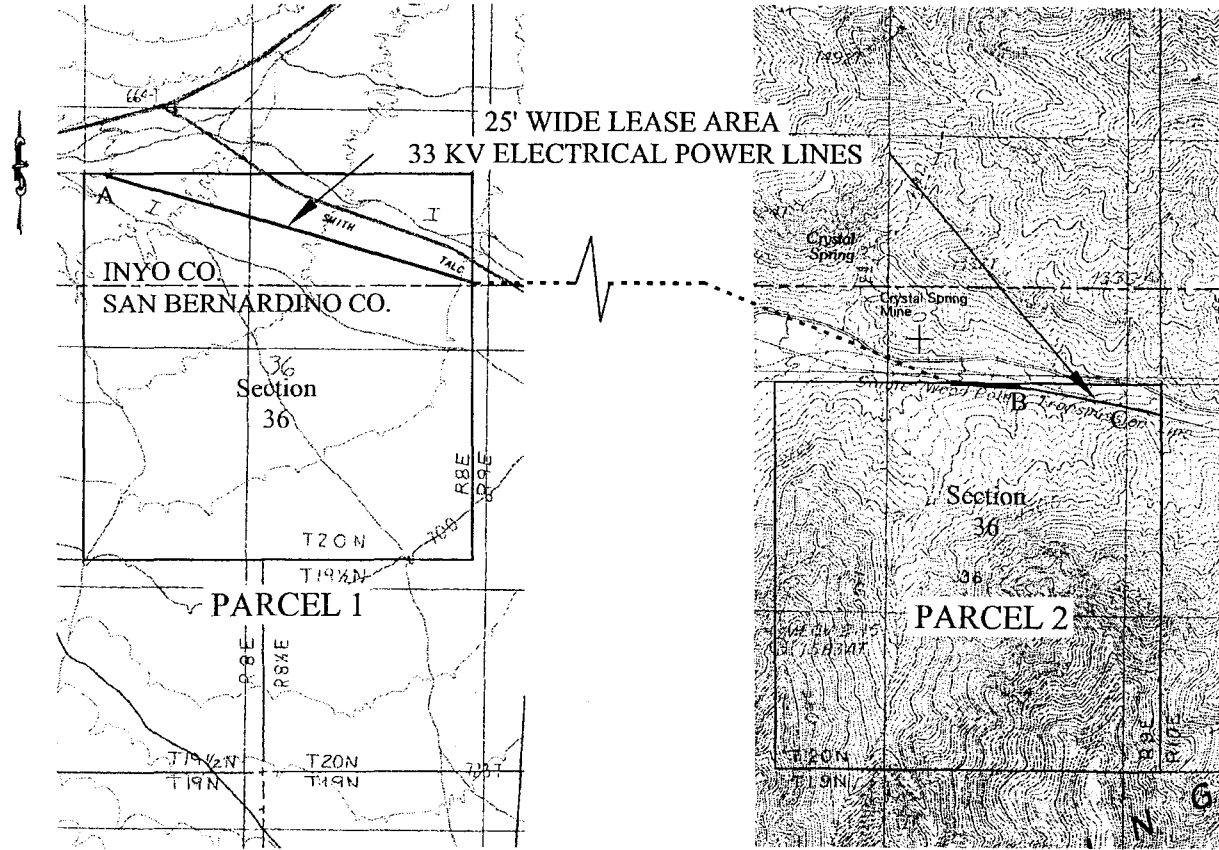

Inyo and San Bernardino County-School Lands

# LOCATION MAP NO SCALE

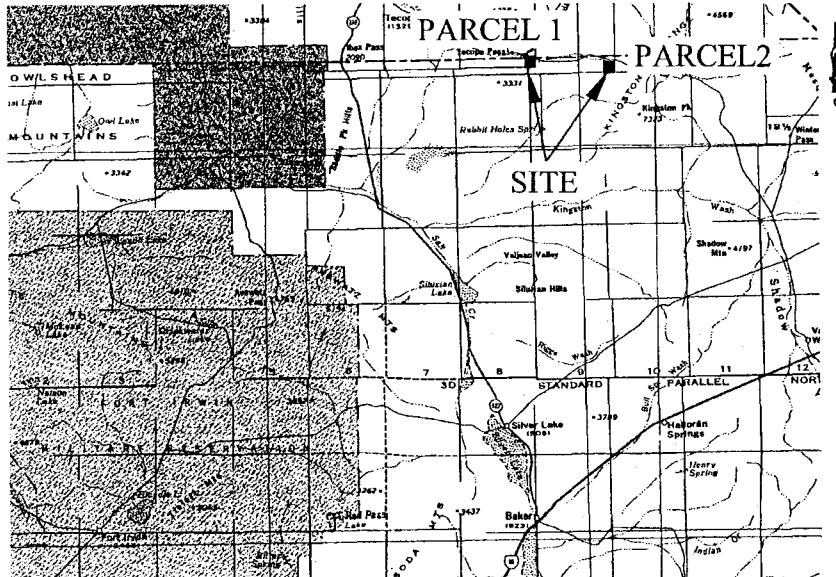

Exhibit B  
WP 4629  
Southern California  
Edison Company  
San Bernardino & Inyo  
Counties



This Exhibit is solely for purposes of generally defining the lease premises, is based on unverified information provided by the lessee or other parties and is not intended to be, nor shall it be construed as, a waiver or limitation of any state interest in the subject or any other property.

Source: U.S. Dept. of Interior Geological Survey

RAB 08-02

000250  
CALENDAR PAGE

001949  
MINUTE PAGE