

MINUTE ITEM  
This Calendar Item No. C67  
was approved as Minute Item  
No. 67 by the State Lands  
Commission by a vote of 3  
to 0 at its 11-26-01  
meeting.

**CALENDAR ITEM  
C67**

A 4

S 1

11/26/01  
PRC 5101.1  
B. Young

**CONTINUATION OF RENT**

**LESSEE:**

Henry E. Bolton  
99 Skyline Circle  
Reno, NV 89509

**AREA, LAND TYPE, AND LOCATION:**

0.08 acre, more or less, of sovereign lands in Lake Tahoe, Cedar Flat, Placer County.

**AUTHORIZED USE:**

Continued use and maintenance of an existing pier, as shown on the attached Exhibit A.

**LEASE TERM:**

Ten years, beginning December 21, 1996.

**CONSIDERATION:**

This lease provides that Lessor may modify the rent periodically during the lease term. Pursuant to this provision, staff has conducted a review of the rent under this lease, and recommends that the rent be continued at \$799 per year, effective December 21, 2001.

**EXHIBIT:**

A. Site and Location Map

**RECOMMENDED ACTION:**

IT IS RECOMMENDED THAT THE COMMISSION:

CALENDAR ITEM NO. C67 (CONT'D)

**CEQA FINDING:**

FIND THAT THE ACTIVITY IS NOT SUBJECT TO THE REQUIREMENTS OF THE CEQA PURSUANT TO TITLE 14, CALIFORNIA CODE OF REGULATIONS, SECTION 15060 (c)(3) BECAUSE THE ACTIVITY IS NOT A PROJECT AS DEFINED BY PUBLIC RESOURCES CODE SECTION 21065 AND TITLE 14, CALIFORNIA CODE OF REGULATIONS, SECTION 15378.

**AUTHORIZATION:**

APPROVE THE CONTINUATION OF RENT FOR LEASE NO. PRC 5101.1 AT \$799 PER YEAR, EFFECTIVE DECEMBER 21, 2001.

CALENDAR PAGE	<b>00329</b>
MINUTE PAGE	<b>0032743</b>

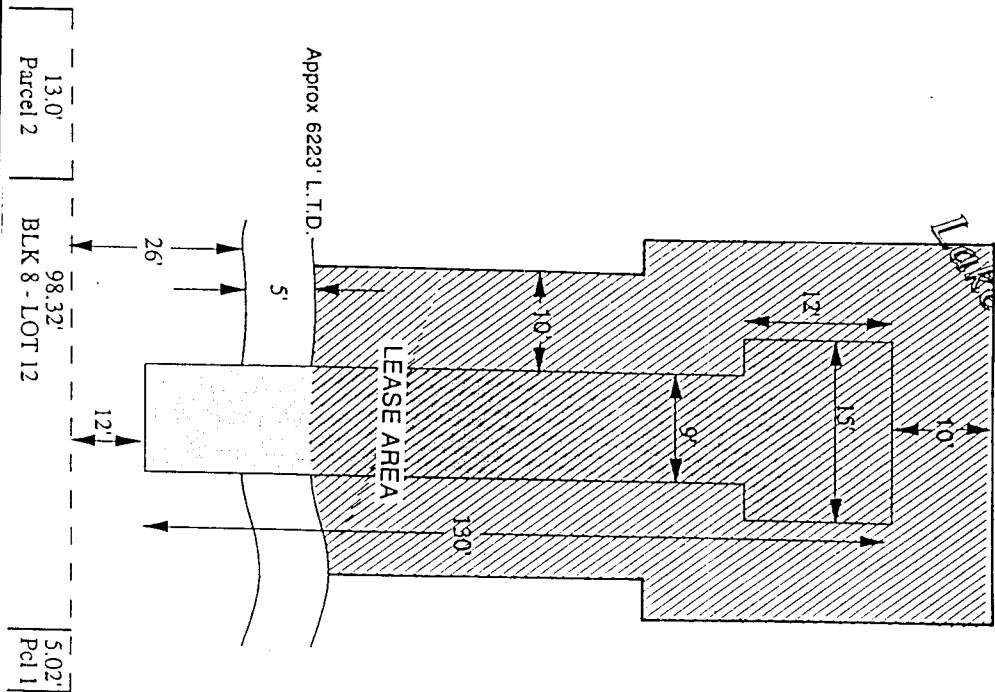

Tahoe

4250 North Lake Blvd.

NO SCALE

### LOCATION MAP

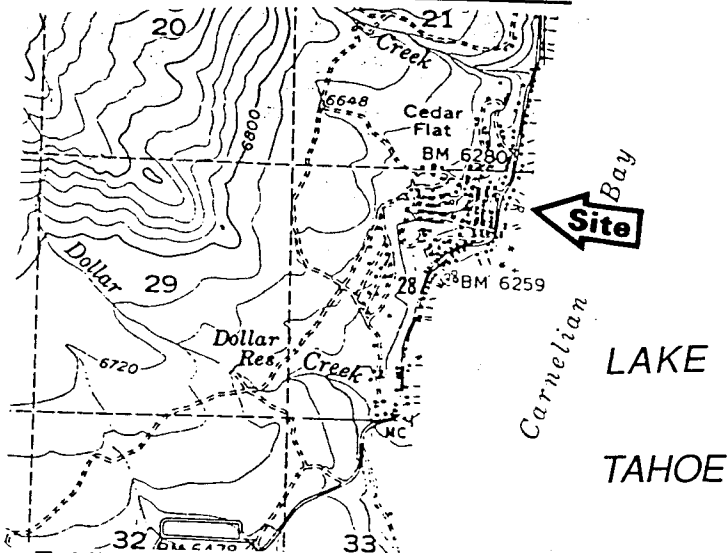

SECTION 3

PRC 5101.1

APN 92 - 190 - 10 & 52

Lake Tahoe

PLACER COUNTY

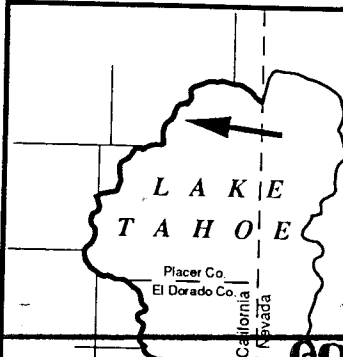

This Exhibit is solely for purposes of generally defining the lease premises, and is not intended to be, nor shall it be construed as, a waiver or limitation of any State interest in the subject or any other property.

NO SCALE

CALENDAR PAGE  
MINUTE PAGE

00330