

MINUTE ITEM  
This Calendar Item No. C54  
was approved as Minute Item  
No. 54 by the State Lands  
Commission by a vote of 3  
to 0 at its 11-26-01  
meeting

## CALENDAR ITEM C54

A 20

11/26/01

S 10

PRC 8174.9

N. Smith

### REVISION OF CONSTRUCTION DATES

#### LESSEES:

City of Fremont  
39550 Liberty Street  
Fremont, California 94537-5006

Alameda County Flood Control and Water Conservation District  
951 Turner Court  
Hayward, California 94544

#### AREA, LAND TYPE, AND LOCATION:

.80 acres, more or less, of sovereign lands in the Alameda County Flood Control and Water Conservation District channel at Cushing Road, near the city of Fremont, Alameda County.

#### AUTHORIZED USE:

Extension of existing culvert and widening of Cushing Road.

#### LEASE TERM:

25 years, beginning March 2, 2000.

#### CONSTRUCTION DATES:

The lease provided for construction of the culvert extension to begin March 2, 2000 and be completed by December 31, 2000. Acquisition of the permits necessary for the project has not been completed; therefore, the Lessee would like to extend the date for construction to begin to January 1, 2002 and to be completed by December 31, 2002.

#### EXHIBITS:

- A. Land Description
- B. Location Map

CALENDAR ITEM NO. **C54** (CONT'D)

**RECOMMENDED ACTION:**

IT IS RECOMMENDED THAT THE COMMISSION:

**CEQA FINDINGS:**

FIND THAT THE ACTIVITY IS NOT SUBJECT TO THE REQUIREMENTS OF THE CEQA PURSUANT TO TITLE 14, CALIFORNIA CODE OF REGULATIONS, SECTION 15060 (c)(3) BECAUSE THE ACTIVITY IS NOT A PROJECT AS DEFINED BY PUBLIC RESOURCES CODE SECTION 21065 AND TITLE 14, CALIFORNIA CODE OF REGULATIONS, SECTION 15378.

**AUTHORIZATION:**

APPROVE THE REVISION OF CONSTRUCTION DATES FOR LEASE NO. PRC 8174.9 FROM BEGINNING MARCH 2, 2000 AND ENDING DECEMBER 31, 2000 TO BEGINNING CONSTRUCTION JANUARY 1, 2002 AND BE COMPLETED BY DECEMBER 31, 2002, EFFECTIVE DECEMBER 10, 2001.

## EXHIBIT A LAND DESCRIPTION

PRC 8174.9

A parcel of unsold State owned land in the City of Fremont, Alameda County, California, said parcel more particularly described as follows:

That portion of Section 23, T5S, R1W, MDM lying within a strip of land 300.00 feet in width lying 150.00 feet on each side of the following described line: COMMENCING at Station 30 + 41.13 on Cushing Road in the City of Fremont, Alameda County as shown on the plans entitled *Box Culvert Extention Cushing Parkway 8285 (PWC)*, dated 1999; thence N 72°00'04" E, 100.00 feet to the POINT OF BEGINNIG of the herein described line; thence S 72°00'04" W, 100.00 feet to the point of commencement; thence continuing S 72°00'04" W, 278.54 feet to the end of said line, said parcel is bounded on the east by Rancho de Auga Caliente, and is bounded on the west by Swamp and Overflowed Lands Survey Number 284.

END DESCRIPTION

Prepared January, 2000 by CSLC boundary staff.

|               |       |
|---------------|-------|
| CALENDAR PAGE | 00275 |
| MINUTE PAGE   | 00650 |

NO SCALE

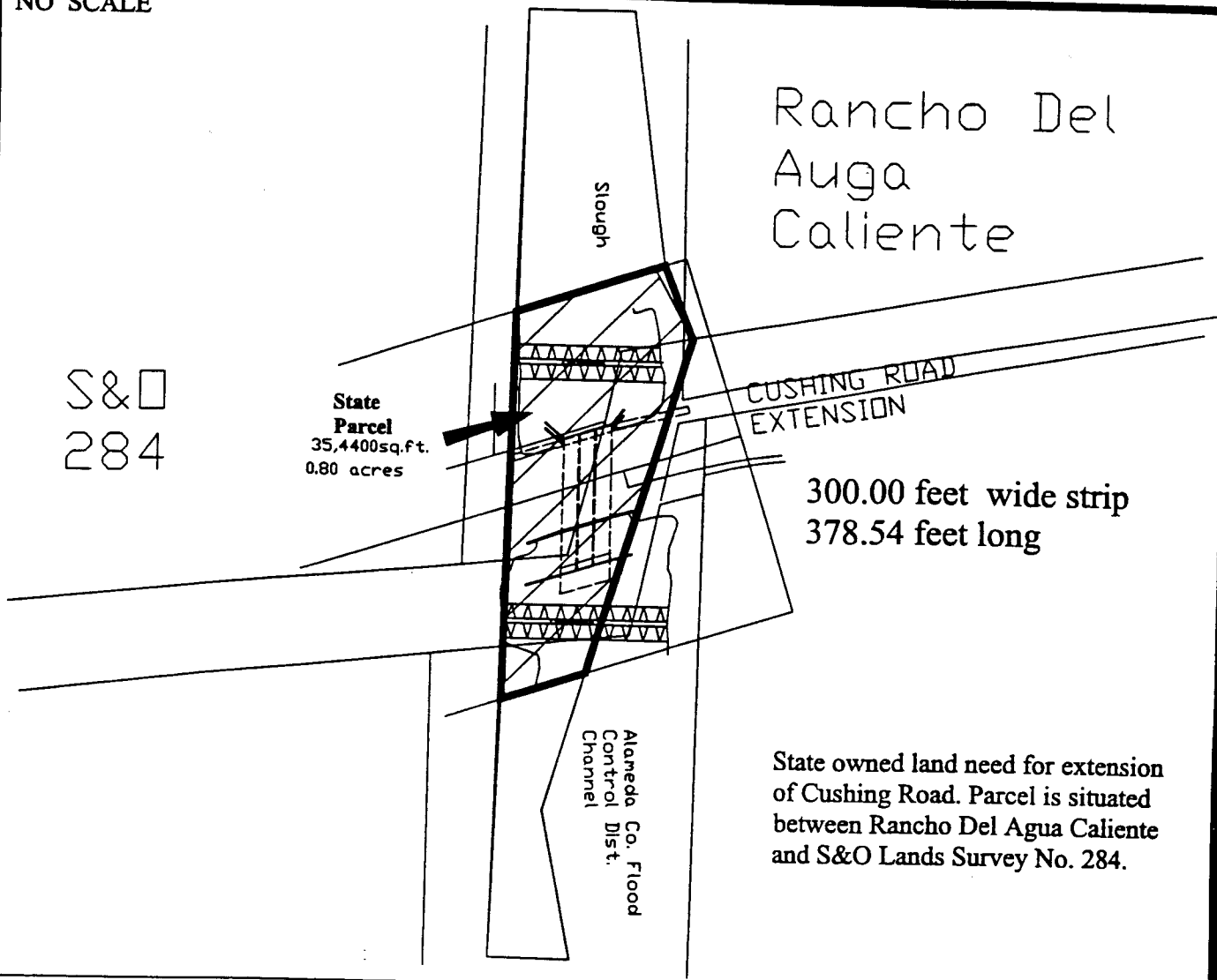

State owned land need for extension of Cushing Road. Parcel is situated between Rancho Del Agua Caliente and S&O Lands Survey No. 284.

NO SCALE

## LOCATION MAP

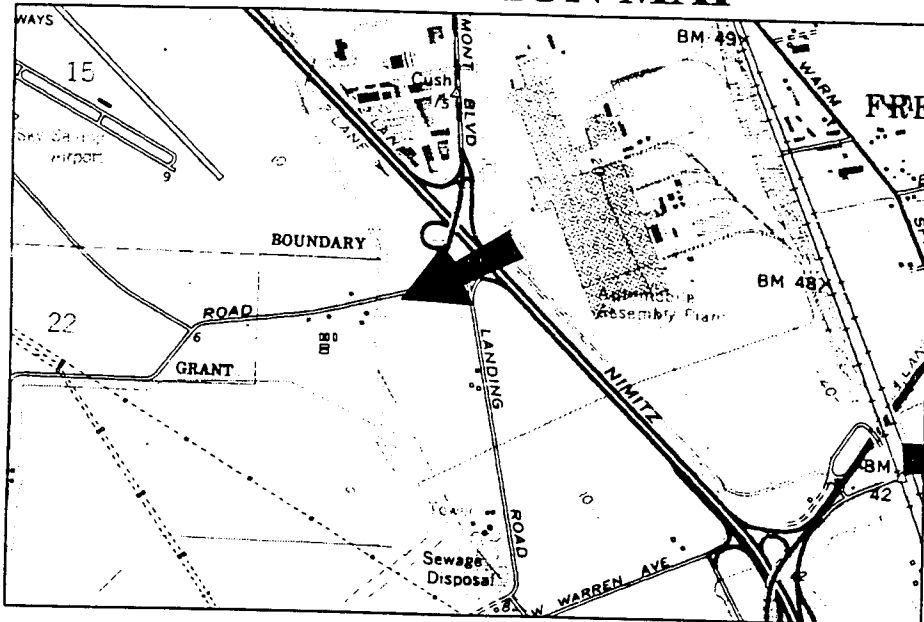

This Exhibit is solely for purposes of generally defining the lease premises, and is not intended to be, nor shall it be construed as, a waiver of limitation of any state interest in the subject or any other property.

## EXHIBIT B

PRC 8174.9

GL -PAU

City of Fremont

Alameda County

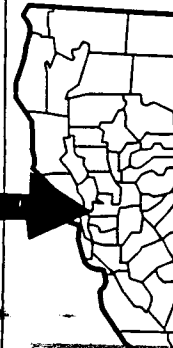

CALENDAR PAGE  
MINUTE PAGE

00276