

MINUTE ITEM

This Calendar Item No. C85 was approved as Minute Item No. 85 by the California State Lands Commission by a vote of 3 to 0 at its 4-24-01 meeting.

**CALENDAR ITEM
C85**

A 3
S 1

04/24/01
PRC 8321 W 8670.37
B. Young

GENERAL LEASE-RECREATIONAL USE

APPLICANTS:

Robert E. Melen and Sheila R. Melen
15224 South Shore Drive
Truckee, CA 96161

AREA, LAND TYPE, AND LOCATION:

0.01 acre, more or less, of sovereign lands in Donner Lake, near Truckee, Nevada County.

AUTHORIZED USE:

Use and maintenance of an existing pier, deck, and boathouse as shown on the attached Exhibit A.

LEASE TERM:

Ten years, beginning March 1, 2001.

CONSIDERATION:

\$86 per annum for the boathouse; the pier is rent free pursuant to Public Resources Code Section 6503.5

SPECIFIC LEASE PROVISIONS:

Insurance:

Liability insurance with coverage of no less than \$500,00.

OTHER PERTINENT INFORMATION:

1. Applicants are natural persons who have improved the littoral lands with, and use the upland for, a single family dwelling. The boathouse does not qualify for a rent-free status because it includes facilities not constructed for the docking or mooring of boats. The pier is exempt from consideration pursuant to Public Resources Code Section 6503.5. Robert E. Melen and Sheila R. Melen are now applying for a General Lease-Recreational Use.

CALENDAR PAGE	000578
MINUTE PAGE	0001118

CALENDAR ITEM NO. C85 (CONT'D)

2. Pursuant to the Commission's delegation of authority and the State CEQA Guidelines (Title 14, California Code of Regulations, section 15061), the staff has determined that this activity is exempt from the requirements of the CEQA under the general rule that the CEQA applies only to projects which have the potential for causing a significant effect on the environment. The staff believes, based on the information available to it, that there is no possibility that this project may have a significant effect on the environment.

Authority: Title 14, California Code of Regulations, section 15061 (b)(3).

3. This activity involves lands identified as possessing significant environmental values pursuant to Public Resources Code sections 6370, et seq.

EXHIBIT:

- A. Location and site map

PERMIT STREAMLINING ACT DEADLINE:

N/A

RECOMMENDED ACTION:

IT IS RECOMMENDED THAT THE COMMISSION:

CEQA FINDING:

FIND THAT THE ACTIVITY IS EXEMPT FROM THE REQUIREMENTS OF THE CEQA PURSUANT TO TITLE 14, CALIFORNIA CODE OF REGULATIONS, SECTION 15061 BECAUSE THERE IS NO POSSIBILITY THAT THE ACTIVITY MAY HAVE A SIGNIFICANT EFFECT ON THE ENVIRONMENT; TITLE 14, CALIFORNIA CODE OF REGULATIONS, SECTION 15061 (b)(3).

SIGNIFICANT LANDS INVENTORY FINDING:

FIND THAT THIS ACTIVITY IS CONSISTENT WITH THE USE CLASSIFICATION DESIGNATED BY THE COMMISSION FOR THE LAND PURSUANT TO PUBLIC RESOURCES CODE SECTIONS 6370, ET SEQ.

CALENDAR ITEM NO. C85 (CONT'D)

AUTHORIZATION:

AUTHORIZE ISSUANCE TO ROBERT E. MELEN AND SHEILA R. MELEN OF A GENERAL LEASE-RECREATIONAL USE, BEGINNING MARCH 1, 2001, FOR A TERM OF TEN YEARS, FOR USE AND MAINTENANCE OF AN EXISTING PIER, DECK, AND BOATHOUSE ON THE LAND SHOWN ON EXHIBIT A ATTACHED AND BY THIS REFERENCE MADE A PART HEREOF; CONSIDERATION OF \$86 PER ANNUM FOR THE BOAT HOUSE; NO MONETARY CONSIDERATION FOR THE PIER PURSUANT TO PUBLIC RESOURCES CODE SECTION 6503.5; LIABILITY INSURANCE WITH COVERAGE OF NO LESS THAN \$500,000.

Donner Lake

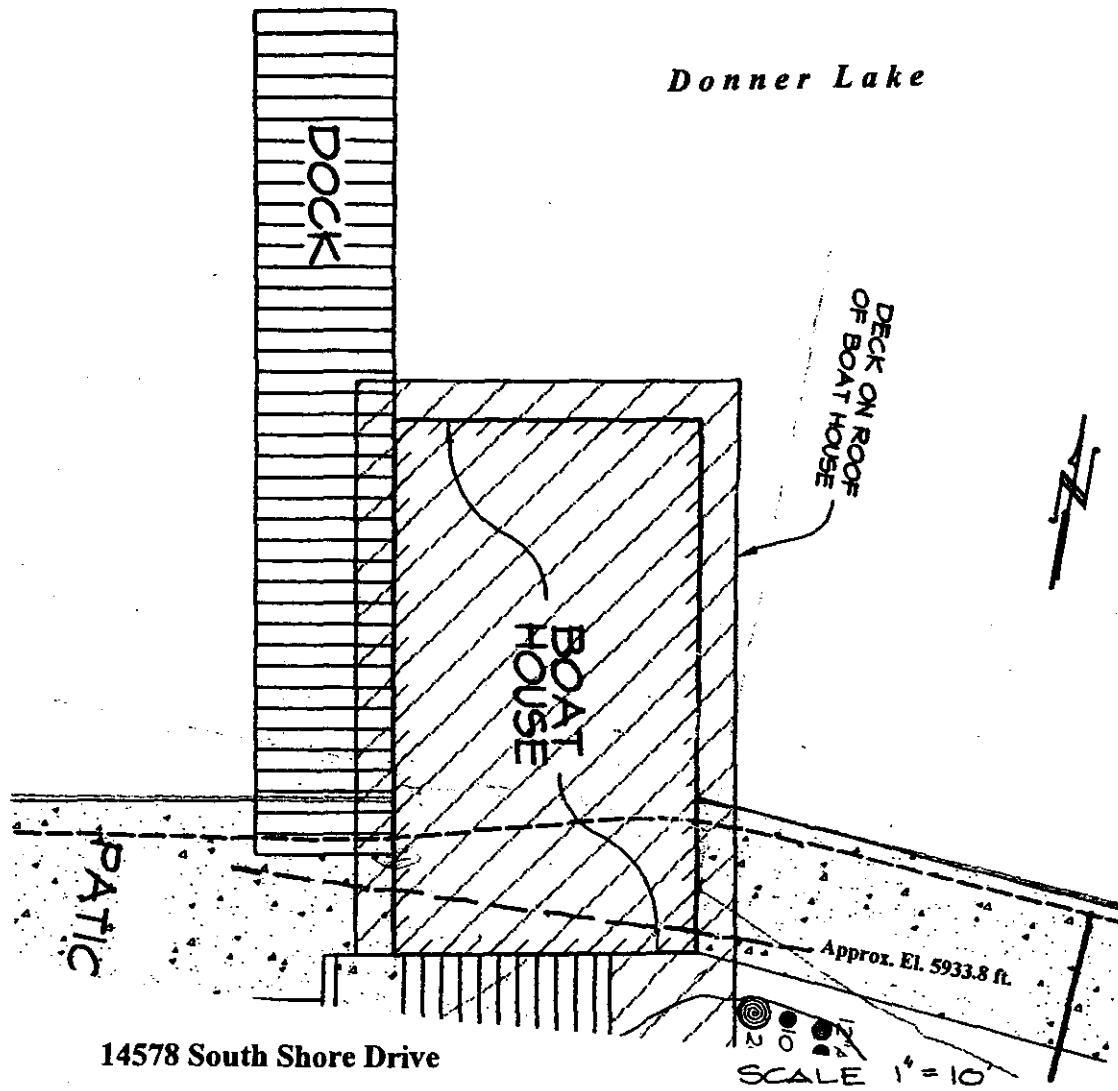

LOCATION MAP

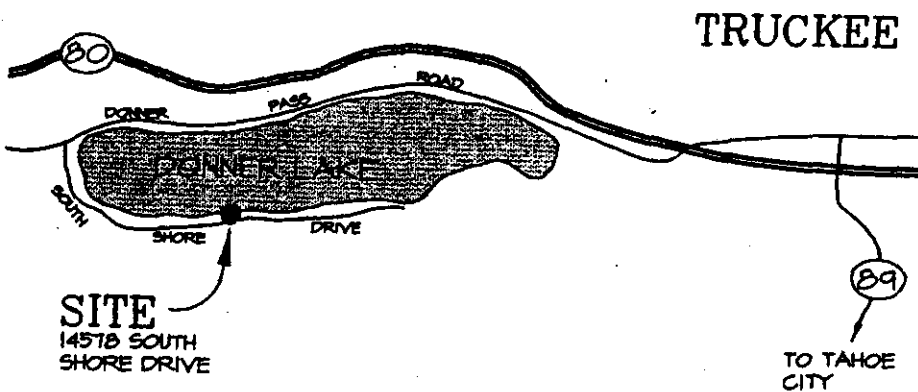

EXHIBIT A

W 8670.37
 APN 17-371-20
 Donner Lake
 Nevada County



This Exhibit is solely for purposes of generally defining the lease premises, and is not intended to be, nor shall it be construed as, a waiver or limitation of any State interest in the subject or any other property.

CALENDAR PAGE 000584
 MINUTE PAGE 0001321