

**MINUTE ITEM**

This Calendar Item No. C03 was approved as Minute Item No. 03 by the California State Lands Commission by a vote of 3 to 0 at its 4-24-01 meeting.

**CALENDAR ITEM  
C03**

A 5  
S 6

April 24, 2001  
PRC 6101.1  
L. Burks

**CONTINUATION OF RENT**

**LESSEES:**

Gary N. Knight and Dorothy L. Knight  
1420 Jonas Avenue  
Sacramento, California 95864

**AREA, LAND TYPE, AND LOCATION:**

0.02 acres, more or less, of sovereign lands in the Sacramento River, near Verona, Sutter County.

**AUTHORIZED USE:**

Continued use and maintenance of an existing 8 foot by 18 foot floating dock and a 4 foot by 36 foot walkway, with a cable anchoring device, and approximately 120 cubic yards of bank protection. The floating dock is to be used for private recreational purposes only.

**LEASE TERM:**

15 years, beginning October 1, 1991.

**CONSIDERATION:**

This lease provides that Lessor may modify the rent periodically during the lease term. Pursuant to this provision, staff has conducted a review of the rent under this lease, and recommends that the rent be continued at \$124 per year, effective October 1, 2001.

**EXHIBITS:**

- A. Site Plan
- B. Location Map

CALENDAR ITEM NO. C03 (CONT'D)

**RECOMMENDED ACTION:**

IT IS RECOMMENDED THAT THE COMMISSION:

**CEQA FINDING:**

FIND THAT THE ACTIVITY IS EXEMPT FROM THE REQUIREMENTS OF THE CEQA PURSUANT TO TITLE 14, CALIFORNIA CODE OF REGULATIONS, SECTION 15061 BECAUSE THE ACTIVITY IS NOT A PROJECT AS DEFINED BY PUBLIC RESOURCES CODE SECTION 21065 AND TITLE 14, CALIFORNIA CODE OF REGULATIONS, SECTION 15378.

**AUTHORIZATION:**

APPROVE THE CONTINUATION OF RENT FOR LEASE NO. PRC 6101.1 AT \$124 PER YEAR, EFFECTIVE OCTOBER 1, 2001.

CALENDAR PAGE	<b>00011</b>
MINUTE PAGE	<b>0000549</b>

Area to be leased lies directly beneath dock and walkway, plus a necessary use area 10 feet in width around the entire dock and walkway. Excepting therefrom any portion lying above the ordinary high water mark.

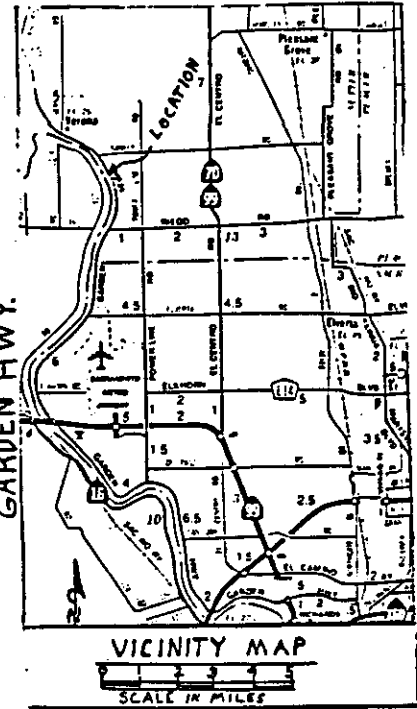
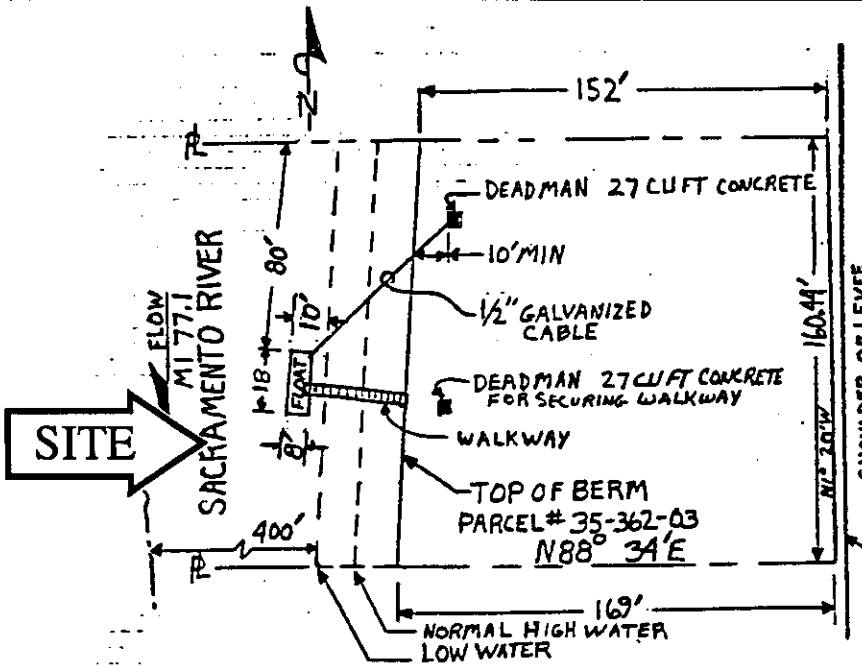

NOTE: TOTAL AMOUNT OF CONCRETE TO BE NO LESS THAN ONE CUBIC FT. PER LINEAR FT. OF FLOAT. ANCHOR TO BE LOCATED ABOVE HIGH WATER LINE.

PLAN  
SCALE 1"=60'

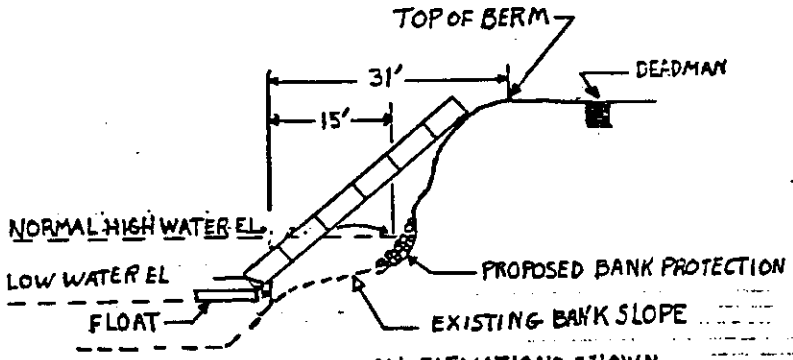

ALL ELEVATIONS SHOWN REFER TO U.S.G.S. M.S.L. DATUM

ELEVATION  
SCALE 1"=20'

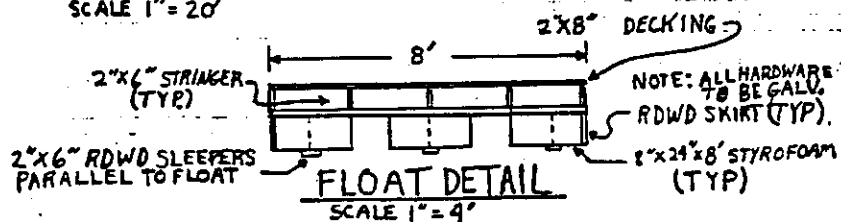

FLOAT DETAIL  
SCALE 1"=4'

**PROPOSED FLOAT**  
 LOCATION:  
 ASSESSORS PARCEL NO  
 35-362-03  
 SLITTER CO., CAL.  
 APPLICATION BY:  
 GARY KNIGHT  
 1420 JONAS AVE  
 SAC, CAL 95825  
 DATE: 4 AUG 1981  
 SHEET: 2 OF 2.

This exhibit is solely for purposes of generally defining the lease premises, and is not intended to be, nor shall it be construed as, a waiver or limitation of any State interest in the subject or any other property.

CALENDAR PAGE  
 MINUTE PAGE  
 Exhibit 013  
 0000.50  
 PRC 6101.1

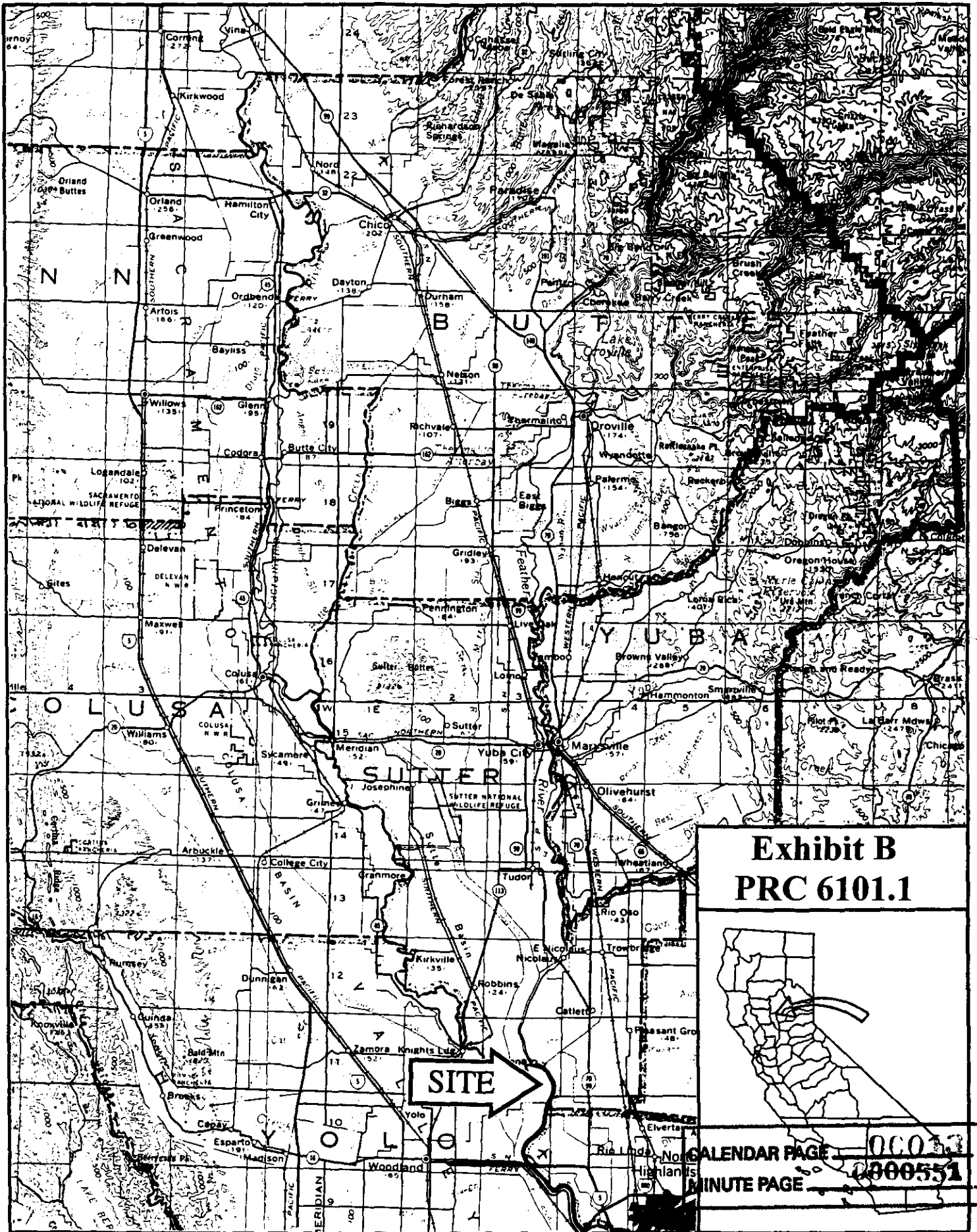

**Exhibit B  
PRC 6101.1**

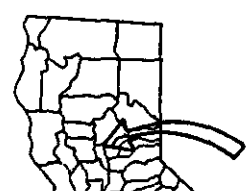

CALENDAR PAGE 00033  
MINUTE PAGE 000551