

MINUTE ITEM
This Calendar Item No. C43 was approved as
Minute Item No. 43 by the California State Lands
Commission by a vote of 3 to 0 at its
6-27-00 meeting.

**CALENDAR ITEM
C43**

A 6
S 3

June 27, 2000
PRC 3714.9 WP 3714.9
F. Singer

RECREATIONAL PIER LEASE

APPLICANTS:

Jeffrey Ehlers and Linda Ehlers
140 Beattie Lane
Novato, California 94945

AREA, LAND TYPE, AND LOCATION:

Sovereign lands in the Petaluma River, near Novato, Marin County.

AUTHORIZED USE:

Continued use and maintenance of an existing floating dock, gangway, and
boathouse.

LEASE TERM:

Ten years, beginning January 17, 2000.

CONSIDERATION:

No monetary consideration pursuant to Public Resources Code section 6503.5.

SPECIFIC LEASE PROVISIONS:

Insurance:

Liability insurance in the amount of no less than \$300,000.

OTHER PERTINENT INFORMATION:

1. Pursuant to the Commission's delegation of authority and the State CEQA Guidelines (Title 14, California Code of Regulations, section 15061), the staff has determined that this activity is exempt from the requirements of the CEQA as a categorically exempt project. The project is exempt under Class 1, Existing Facilities; Title 2, California Code of Regulations, section 2905 (a)(2).

CALENDAR PAGE	0237
MINUTE PAGE	8610

CALENDAR ITEM NO. C43 (CONT'D)

Authority: Public Resources Code section 21084 and Title 14, California Code of Regulations, section 15300 and Title 2, California Code of Regulations, section 2905.

2. This activity involves lands identified as possessing significant environmental values pursuant to Public Resources Code sections 6370, et seq. Based upon the staff's consultation with the persons nominating such lands and through the CEQA review process, it is the staff's opinion that the project, as proposed, is consistent with its use classification.

EXHIBIT:

- A. Site Map and Location Map

RECOMMENDED ACTION:

IT IS RECOMMENDED THAT THE COMMISSION:

CEQA FINDING:

FIND THAT THE ACTIVITY IS EXEMPT FROM THE REQUIREMENTS OF THE CEQA PURSUANT TO TITLE 14, CALIFORNIA CODE OF REGULATIONS, SECTION 15061 AS A CATEGORICALLY EXEMPT PROJECT, CLASS 1, EXISTING FACILITIES; TITLE 2, CALIFORNIA CODE OF REGULATIONS, SECTION 2905 (a)(2).

SIGNIFICANT LANDS INVENTORY FINDING:

FIND THAT THIS ACTIVITY IS CONSISTENT WITH THE USE CLASSIFICATION DESIGNATED BY THE COMMISSION FOR THE LAND PURSUANT TO PUBLIC RESOURCES CODE SECTIONS 6370, ET SEQ.

AUTHORIZATION:

AUTHORIZE ISSUANCE TO JEFFREY EHLERS AND LINDA EHLERS OF A TEN-YEAR RECREATIONAL PIER LEASE, BEGINNING JANUARY 17, 2000, FOR CONTINUED USE AND MAINTENANCE OF AN EXISTING FLOATING DOCK, GANGWAY, AND BOATHOUSE ON THE LAND SHOWN ON EXHIBIT A ATTACHED AND BY THIS REFERENCE MADE A PART HEREOF; NO MONETARY CONSIDERATION PURSUANT TO PUBLIC RESOURCES CODE SECTION 6503.5; LIABILITY INSURANCE IN THE AMOUNT OF NO LESS THAN \$300,000.

CALENDAR PAGE	0238
MINUTE PAGE	8611

NO SCALE

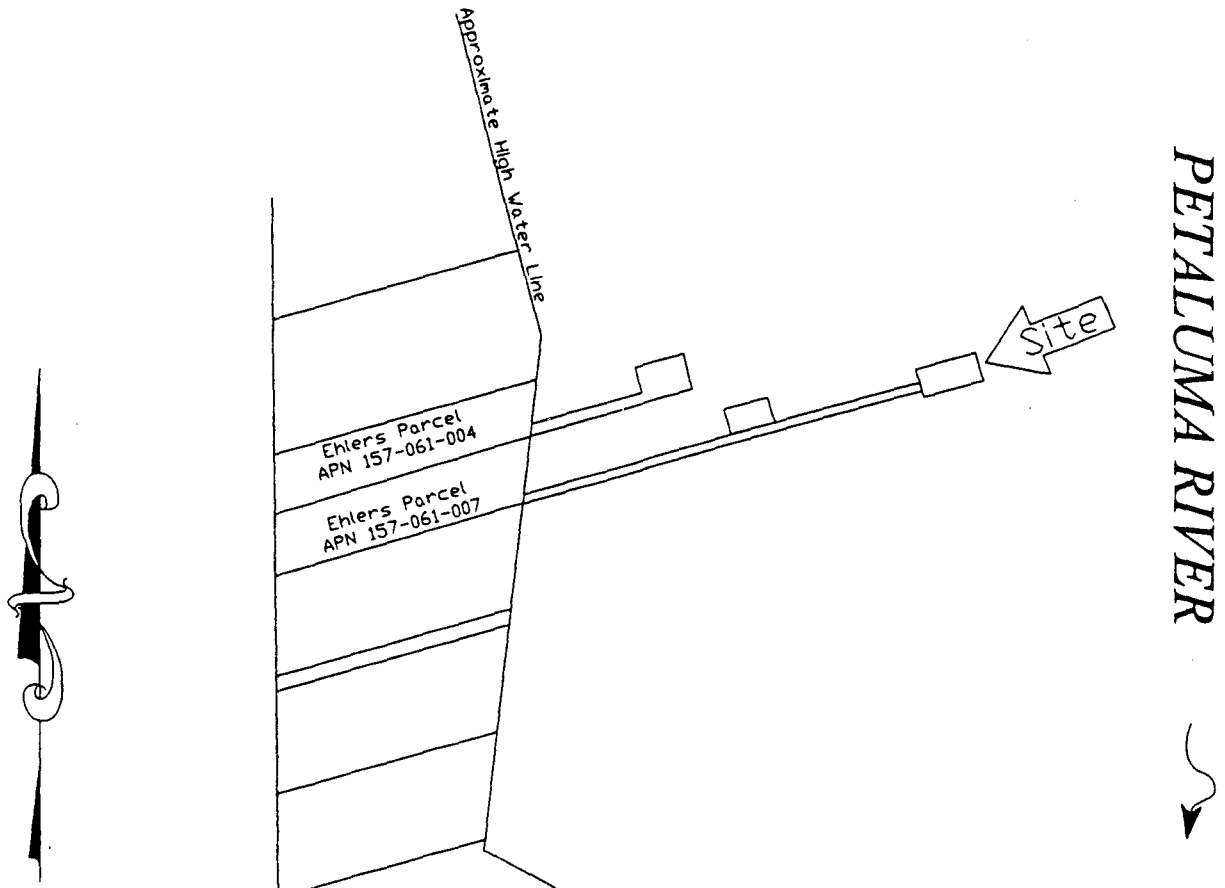

LOCATION MAP

150 Beattie Lane, Novato

NO SCALE

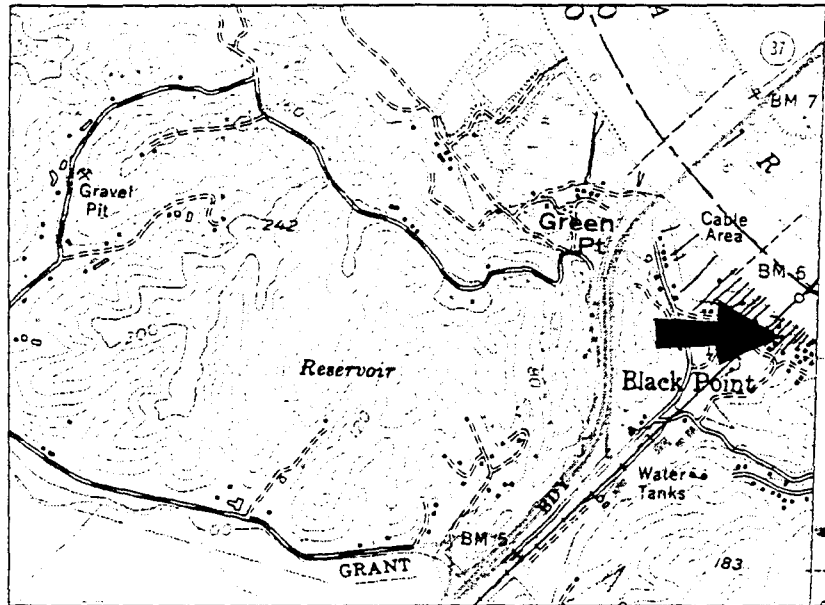

EXHIBIT A

PRC 3714

RPL

J. & L. Ehlers

Marin County

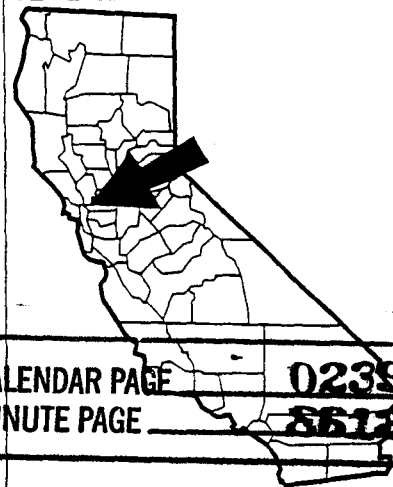

CALENDAR PAGE
MINUTE PAGE

0239
8612

This Exhibit is solely for purposes of generally defining the lease premises, and is not intended to be, nor shall it be construed as, a waiver of limitation of any state interest in the subject or any other property.