

**CALENDAR ITEM
C28**

A 4
S 1

04/20/00
PRC 5491.9
N. Lee

ASSIGNMENT OF LEASE

LESSEE/ASSIGNOR:

Georgie Jean Lane
P. O. Box 136
Homewood, CA 96141-0136

ASSIGNEE:

Dale Marcellini
2019 San Miquel Drive
Walnut Creek, CA 94596

AREA, LAND TYPE, AND LOCATION:

Sovereign lands located in Lake Tahoe, near Tahoe Pines, Placer County.

AUTHORIZED USE:

Continued use and maintenance of a joint-use pier and three mooring buoys as shown on the attached Exhibit A.

LEASE TERM:

Ten years, beginning December 1, 1996.

CONSIDERATION:

No monetary consideration pursuant to Public Resources code section 6503.5.

OTHER PERTINENT INFORMATION:

1. Pursuant to the Commission's delegation of authority and the State CEQA Guidelines (Title 14, California Code of Regulations, section 15061), the staff has determined that this activity is exempt from the requirements of the CEQA because the activity is not a "project" as defined by the CEQA and the State CEQA Guidelines.

Authority: Public Resources Code section 21065 and Title 14, California Code of Regulations, section 15378.

CALENDAR ITEM NO. C 28(CONT'D)

2. This activity involves lands identified as possessing significant environmental values pursuant to Public Resources Code sections 6370, et seq. Based upon the staff's consultation with the persons nominating such lands and through the CEQA review process, it is the staff's opinion that the project, as proposed, is consistent with its use classification.

EXHIBIT:

- A. Location map

PERMIT STREAMLINING ACT DEADLINE:

N/A

RECOMMENDED ACTION:

IT IS RECOMMENDED THAT THE COMMISSION:

CEQA FINDING:

FIND THAT THE ACTIVITY IS EXEMPT FROM THE REQUIREMENTS OF THE CEQA PURSUANT TO TITLE 14, CALIFORNIA CODE OF REGULATIONS, SECTION 15061 BECAUSE THE ACTIVITY IS NOT A PROJECT AS DEFINED BY PUBLIC RESOURCES CODE SECTION 21065 AND TITLE 14, CALIFORNIA CODE OF REGULATIONS, SECTION 15378.

AUTHORIZATION:

AUTHORIZE THE ASSIGNMENT OF 100% OF THE INTEREST OF GEORGIE JEAN LANE IN LEASE NO. PRC 5491.9, RECREATIONAL PIER LEASE, ON SOVEREIGN LANDS SHOWN ON EXHIBIT A ATTACHED AND BY THIS REFERENCE MADE A PART HEREOF; TO DALE MARCELLINI; EFFECTIVE APRIL 20, 2000.

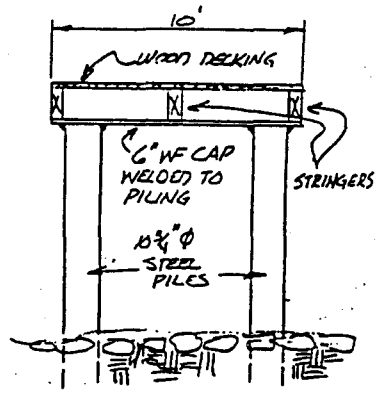
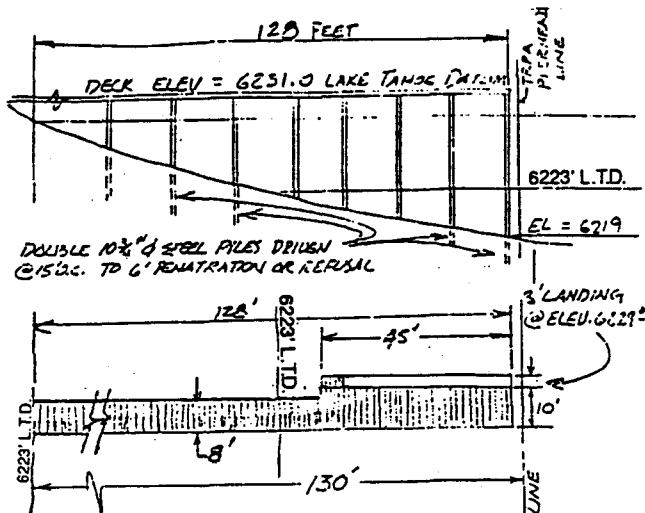

PROFILE & PLAN VIEWS

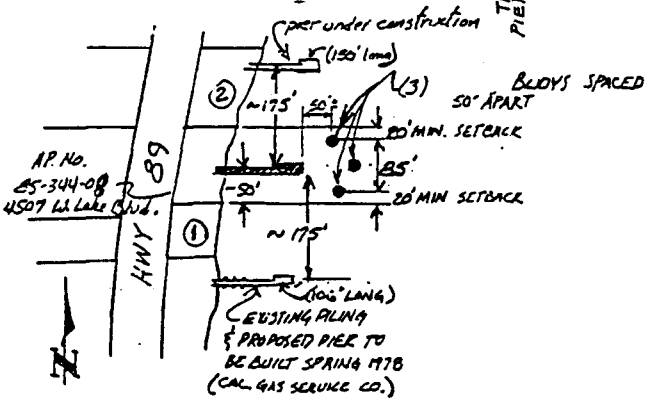

4510 & 4515 Lucerne

NO SCALE

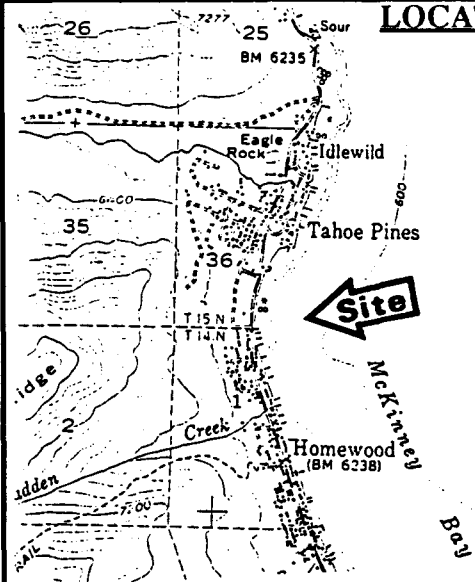

LOCATION MAP

Lake Tahoe

EXHIBIT "A"
 PRC 5491.9
 APN 85 - 344 - 08
 Lake Tahoe
 PLACER COUNTY

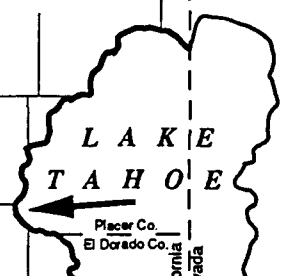

NO SCALE

This Exhibit is solely for purposes of generally defining the lease premises, and is not intended to be, nor shall it be construed as, a waiver or limitation of any State interest in the subject or any other property.

CALENDAR PAGE 0000265
 MINUTE PAGE 0000956