

MINUTE ITEM

This Calendar Item No. C50 was approved as
Minute Item No. 50 by the California State Lands
Commission by a vote of 3 to 0 at its
12/16/98 meeting.

CALENDAR ITEM

C50

A 8

12/16/98

S 4

PRC 6108.1

D. Jones

ASSIGNMENT OF LEASE

LESSEE/ASSIGNOR:

Allan Martin and Peggy Martin
1100 W. Brannan Island
Isleton, California 95641

ASSIGNEE:

River Islands Land Company
33 N. Front Street
Rio Vista, California 94571

AREA, LAND TYPE, AND LOCATION:

3.063 acres, more or less, of sovereign lands in Mayberry Slough, near the city
of Antioch, Sacramento County.

AUTHORIZED USE:

A commercial marina.

LEASE TERM:

25 years, beginning April 1, 1995.

CONSIDERATION:

\$1,620 minimum annual rental, or a percentage of gross income from operations
on State land, whichever is greater, with the State reserving the right to fix a
different rental periodically during the lease term as provided in the lease;
1.5 cents per gallon for fuel sales up to 100,000 gallons and 2 cents per gallon
for fuel sales over 100,000 gallons.

OTHER PERTINENT INFORMATION:

1. Applicant owns the uplands adjoining the lease premises.

CALENDAR PAGE	218
MINUTE PAGE	004289

CALENDAR ITEM NO. C50 (CONT'D)

2. Pursuant to the Commission's delegation of authority and the State CEQA Guidelines (Title 14, California Code of Regulations, section 15061), the staff has determined that this activity is exempt from the requirements of the CEQA because the activity is not a "project" as defined by the CEQA and the State CEQA Guidelines.

Authority: Public Resources Code section 21065 and Title 14, California Code of Regulations, section 15378.

EXHIBITS:

- A. Site Map
- B. Location Map

PERMIT STREAMLINING ACT DEADLINE:

N/A

RECOMMENDED ACTION:

IT IS RECOMMENDED THAT THE COMMISSION:

CEQA FINDING:

FIND THAT THE ACTIVITY IS EXEMPT FROM THE REQUIREMENTS OF THE CEQA PURSUANT TO TITLE 14, CALIFORNIA CODE OF REGULATIONS, SECTION 15061 BECAUSE THE ACTIVITY IS NOT A PROJECT AS DEFINED BY PUBLIC RESOURCES CODE SECTION 21065 AND TITLE 14, CALIFORNIA CODE OF REGULATIONS, SECTION 15378.

AUTHORIZATION:

AUTHORIZE THE ASSIGNMENT OF LEASE NO. PRC 6108.1, A GENERAL LEASE - COMMERCIAL USE, OF SOVEREIGN LANDS SHOWN ON EXHIBIT A ATTACHED AND BY THIS REFERENCE MADE A PART HEREOF; FROM ALLAN MARTIN AND PEGGY MARTIN TO RIVER ISLANDS LAND COMPANY, EFFECTIVE JANUARY 1, 1998.

This Land description is solely for purposes of generally defining the lease premises, and is not intended to be, nor shall it be construed as, a waiver or limitation of any State interest in the subject or any other property.

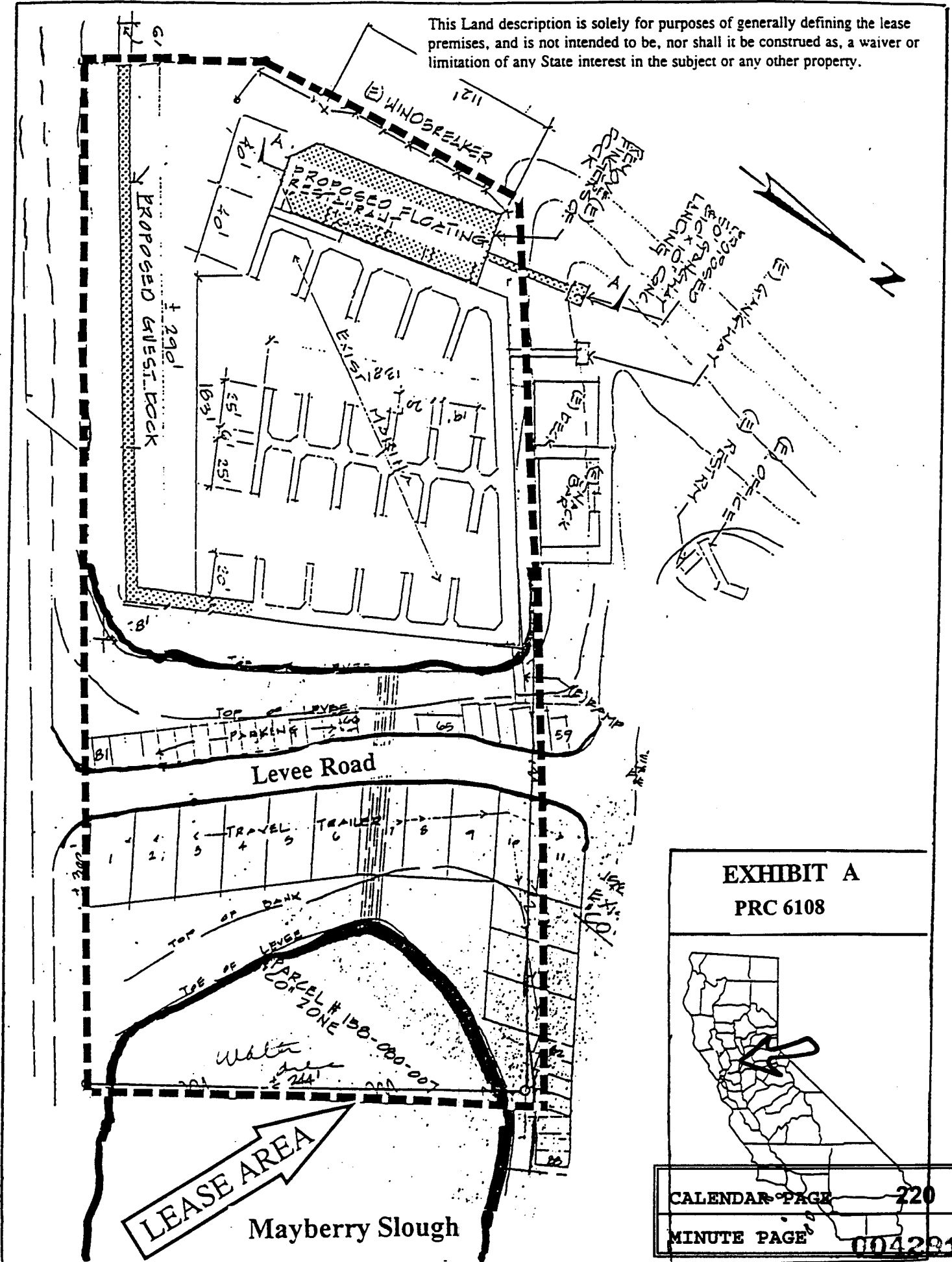

EXHIBIT A
PRC 6108



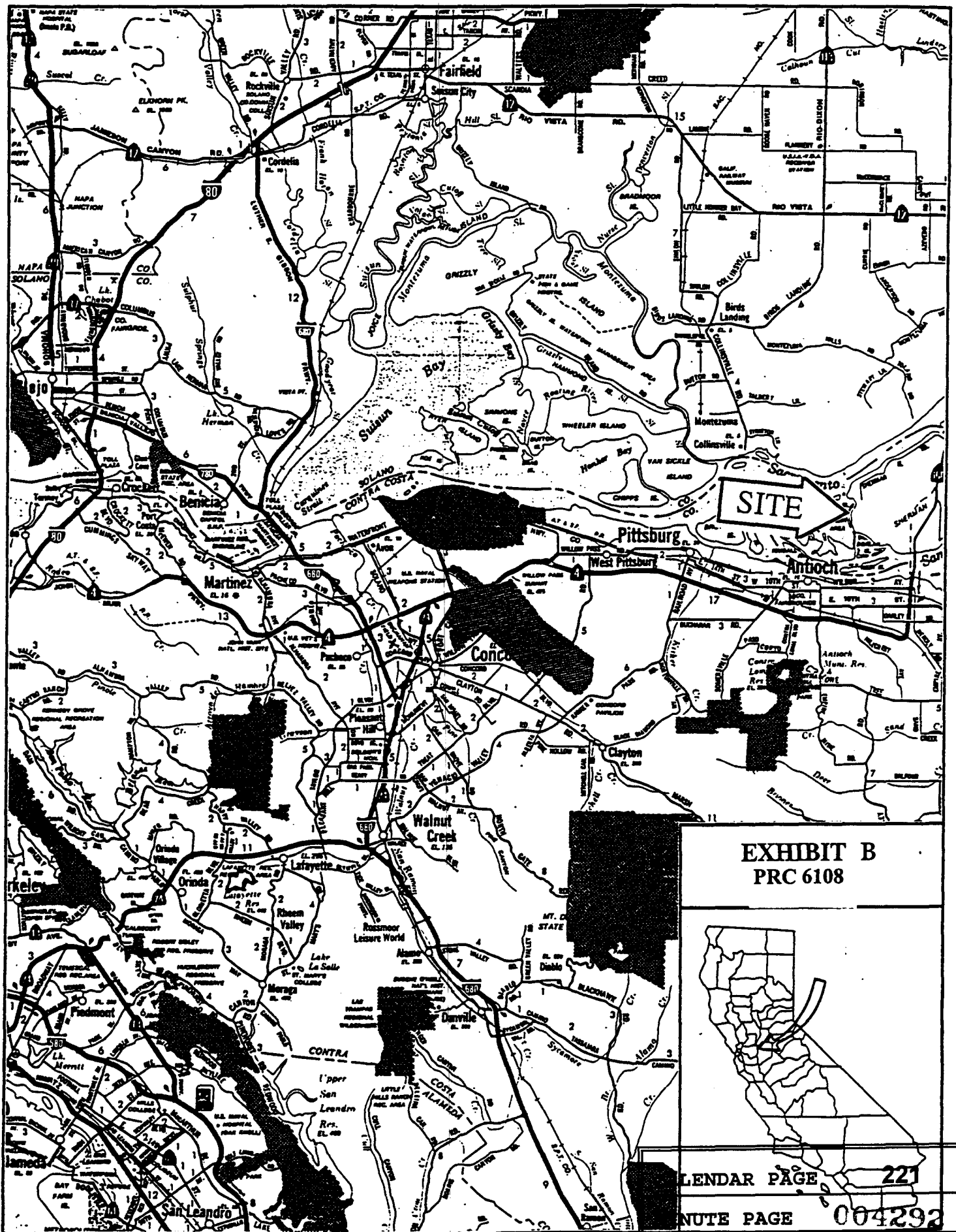
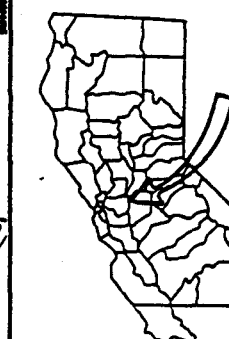

EXHIBIT B
PRC 6108



CALENDAR PAGE 221
MINUTE PAGE 004292