

MINUTE ITEM

This Calendar Item No. C08 was approved as Minute Item No. 08 by the California State Lands Commission by a vote of 3 to 0 at its 12-16-98 meeting.

**CALENDAR ITEM
C08**

A 2
S 4

PRC 7249 12/16/98
WP 7249.9
L. Burks

RECREATIONAL PIER LEASE

APPLICANTS:

James E. Westberg and Julie E. Westberg
3405 Riverview Drive
Redding, California 96001

AREA, LAND TYPE, AND LOCATION:

Sovereign lands in the Sacramento River, near Redding, Shasta County.

AUTHORIZED USE:

A 6 foot x 21 foot fixed concrete dock platform with attached 4 foot x 21 foot floating dock.

LEASE TERM:

Ten years, beginning October 7, 1998.

CONSIDERATION:

No monetary consideration pursuant to Public Resources Code section 6503.5.

SPECIFIC LEASE PROVISIONS:

Liability insurance with coverage of no less than \$300,000.

OTHER PERTINENT INFORMATION:

1. Pursuant to the Commission's delegation of authority and the State CEQA Guidelines (Title 14, California Code of Regulations, section 15061), the staff has determined that this activity is exempt from the requirements of the CEQA as a categorically exempt project. The project is exempt under Class 1, Existing Facilities; Title 2, California Code of Regulations, section 2905 (a)(2).

Authority: Public Resources Code section 21084 and Title 14, California Code of Regulations, section 15300 and Title 2, California Code of Regulations, section 2905.

CALENDAR PAGE	30
MINUTE PAGE	004100

CALENDAR ITEM NO. C08 (CONT'D)

2. This activity involves lands identified as possessing significant environmental values pursuant to Public Resources Code sections 6370, et seq. Based upon the staff's consultation with the persons nominating such lands and through the CEQA review process, it is the staff's opinion that the project, as proposed, is consistent with its use classification.

EXHIBITS:

- A. Site Plan
B. Location Map

PERMIT STREAMLINING ACT DEADLINE:

N/A

RECOMMENDED ACTION:

IT IS RECOMMENDED THAT THE COMMISSION:

CEQA FINDING:

FIND THAT THE ACTIVITY IS EXEMPT FROM THE REQUIREMENTS OF THE CEQA PURSUANT TO TITLE 14, CALIFORNIA CODE OF REGULATIONS, SECTION 15061 AS A CATEGORICALLY EXEMPT PROJECT, CLASS 1, EXISTING FACILITIES; TITLE 2, CALIFORNIA CODE OF REGULATIONS, SECTION 2905 (a)(2).

SIGNIFICANT LANDS INVENTORY FINDING:

FIND THAT THIS ACTIVITY IS CONSISTENT WITH THE USE CLASSIFICATION DESIGNATED BY THE COMMISSION FOR THE LAND PURSUANT TO PUBLIC RESOURCES CODE SECTIONS 6370, ET SEQ.

AUTHORIZATION:

AUTHORIZE ISSUANCE TO JAMES E. WESTBERG AND JULIE E. WESTBERG OF A TEN-YEAR RECREATIONAL PIER LEASE, BEGINNING OCTOBER 7, 1998, FOR A FIXED CONCRETE DOCK PLATFORM WITH ATTACHED FLOATING DOCK ON THE LAND SHOWN ON EXHIBIT A ATTACHED AND BY THIS REFERENCE MADE A PART HEREOF; NO MONETARY CONSIDERATION PURSUANT TO PUBLIC RESOURCES CODE SECTION 6503.5; LIABILITY INSURANCE WITH COVERAGE OF NO LESS THAN \$300,000.

NO. 9747

LOCATION

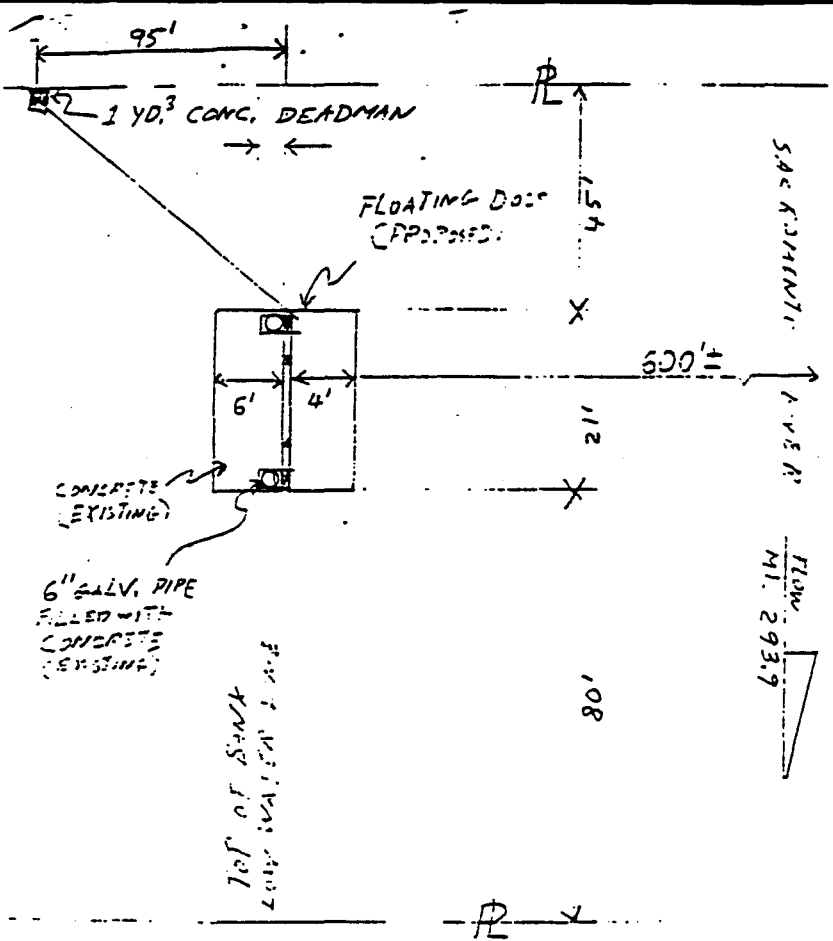
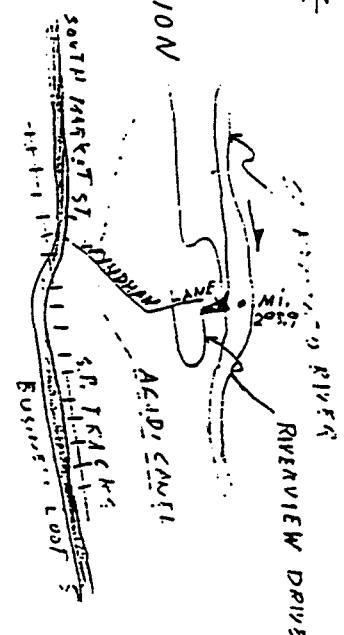

VICINITY MAP NOT TO SCALE

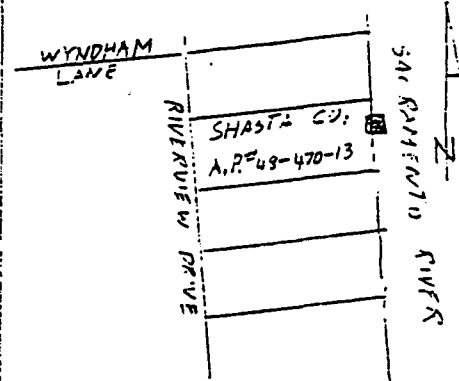

LOCATION MAP NOT TO SCALE PROPOSED DOCK

LOCATION: ASSESSOR'S PARCEL # 48-470-13 SHASTA CO., CALIF.

PLAN NOT TO SCALE

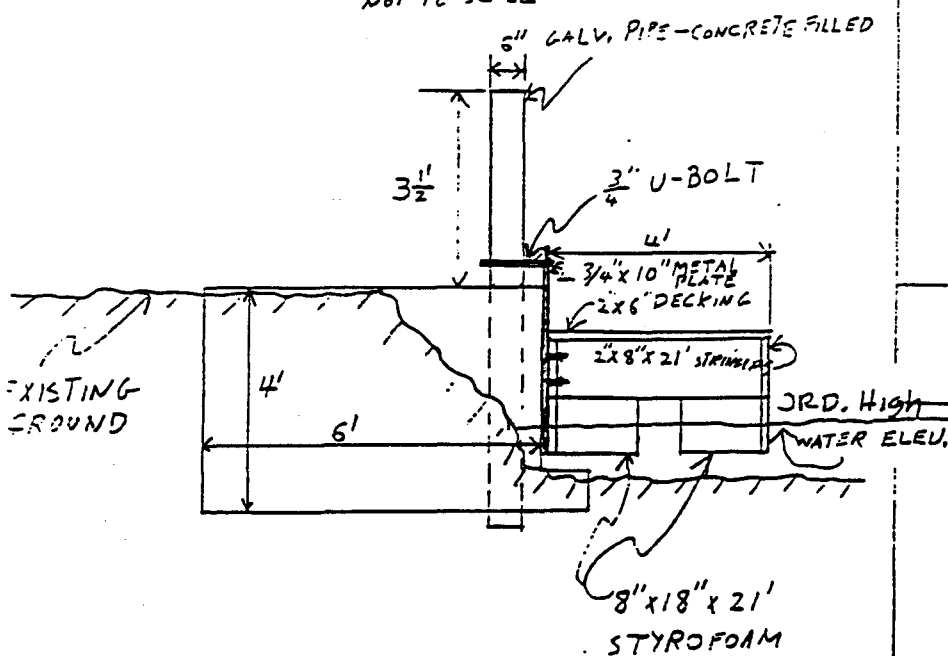

This exhibit is solely for purposes of generally defining the area to be leased, and is not intended to be, nor shall it be construed as, a waiver or limitation of any State interest in the subject or other property.

Exhibit A
 CALENDAR PAGE 32
 WP 9747
 MINUTE PAGE 004102

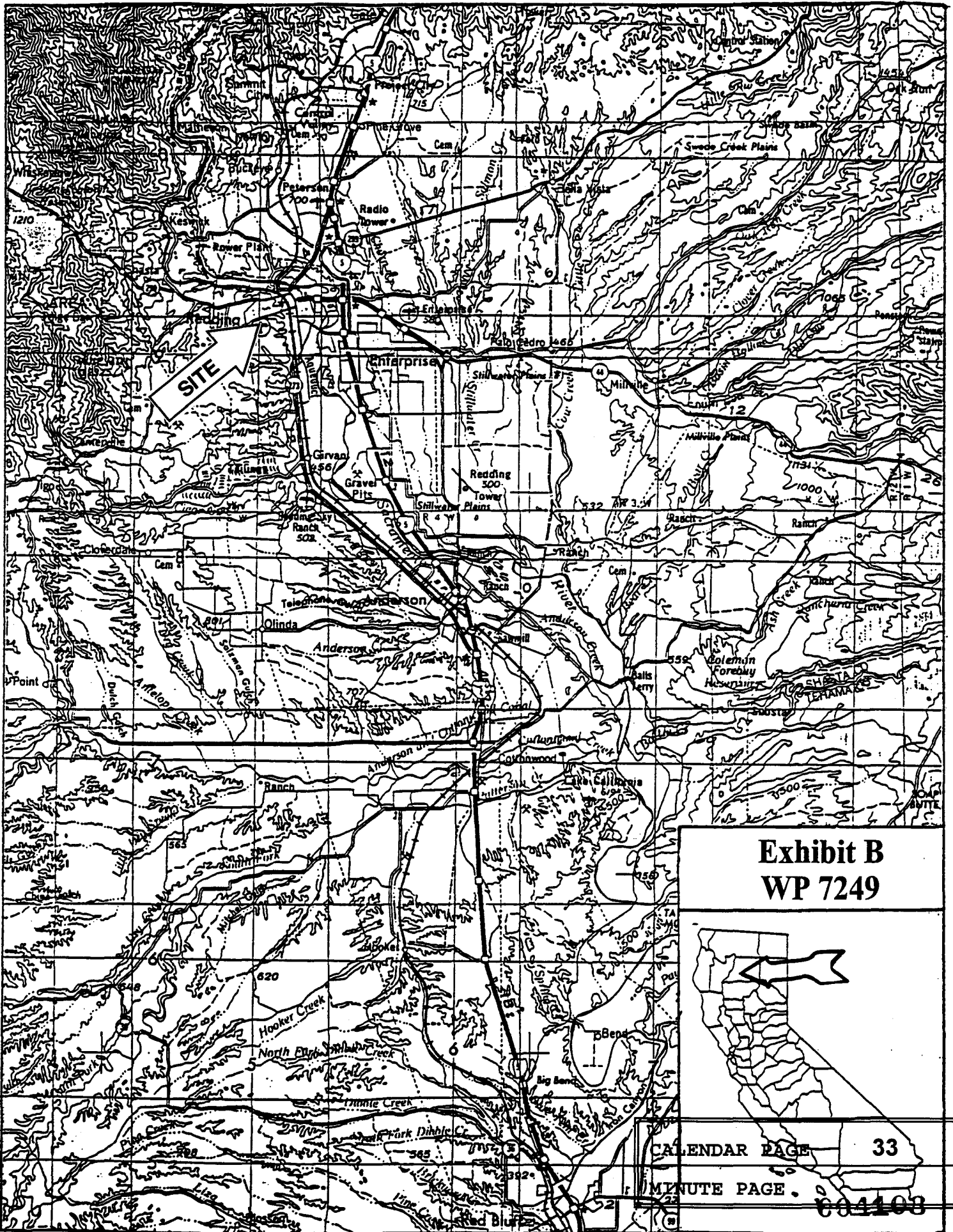

SITE

**Exhibit B
WP 7249**



CALENDAR PAGE	33
MINUTE PAGE	604103