

**MINUTE ITEM**

This Calendar Item No. C17 was approved as Minute Item No. 12 by the California State Lands Commission by a vote of 3 to 0 at its 11/07/97 meeting.

**CALENDAR ITEM  
C17**

A 4  
S 1

11/07/97  
PRC 7556.9  
L. Fiack

**RECREATIONAL PIER LEASE**

**APPLICANT:**

Thomas B. Hughes and Martha R. Hughes,  
Husband and Wife as Joint Tenants  
1046 46th Street  
Sacramento, California 95819

**AREA, LAND TYPE, AND LOCATION:**

Sovereign lands in Lake Tahoe, near Tahoe City, Placer County.

**AUTHORIZED USE:**

Continued use and maintenance of two mooring buoys, as shown on the attached Exhibit A.

**LEASE TERM:**

Ten years, beginning August 12, 1996.

**CONSIDERATION:**

No monetary consideration pursuant to Public Resources Code section 6503.5.

**SPECIFIC LEASE PROVISIONS:**

Insurance:

Liability insurance in the amount of no less than \$300,000.

Other:

This lease is conditioned on Lessee's obtaining authorization from the Tahoe Regional Planning Agency (TRPA) for the mooring buoys within two years from the effective date of the authorization of the buoys by the Commission.

**OTHER PERTINENT INFORMATION:**

1. Pursuant to the Commission's delegation of authority and the State CEQA Guidelines (Title 14, California Code of Regulations, section 15061), the staff has determined that this activity is exempt from the requirements of the CEQA as a categorically exempt project. The project is exempt under

CALENDAR PAGE	57
MINUTE PAGE	002244

CALENDAR ITEM NO. C17 (CONT'D)

Class 1, Existing Facilities; Title 2, California Code of Regulations, section 2905 (a) (2).

2. This activity involves lands identified as possessing significant environmental values pursuant to Public Resources Code sections 6370, et seq. Based upon the staff's consultation with the persons nominating such lands and through the CEQA review process, it is the staff's opinion that the project, as proposed, is consistent with its use classification.

**FURTHER APPROVALS REQUIRED:**

Tahoe Regional Planning Agency, California State Lands Commission

**EXHIBIT:**

- A. Site and Location Map

**PERMIT STREAMLINING ACT DEADLINE:**

N/A

**RECOMMENDED ACTION:**

IT IS RECOMMENDED THAT THE COMMISSION:

**CEQA FINDING:**

FIND THAT THE ACTIVITY IS EXEMPT FROM THE REQUIREMENTS OF THE CEQA PURSUANT TO TITLE 14, CALIFORNIA CODE OF REGULATIONS, SECTION 15061, AS A CATEGORICALLY EXEMPT PROJECT, CLASS 1, EXISTING FACILITIES; TITLE 2, CALIFORNIA CODE OF REGULATIONS, SECTION 2905 (a) (2).

**SIGNIFICANT LANDS INVENTORY FINDING:**

FIND THAT THIS ACTIVITY IS CONSISTENT WITH THE USE CLASSIFICATION DESIGNATED BY THE COMMISSION FOR THE LAND PURSUANT TO PUBLIC RESOURCES CODE SECTIONS 6370, ET SEQ.

CALENDAR ITEM NO. C17 (CONT'D)

**AUTHORIZATION:**

AUTHORIZE ISSUANCE TO THOMAS B. HUGHES AND MARTHA R. HUGHES, HUSBAND AND WIFE AS JOINT TENANTS OF A TEN-YEAR RECREATIONAL PIER LEASE, BEGINNING AUGUST 12, 1996, FOR CONTINUED USE AND MAINTENANCE OF TWO MOORING BUOYS ON THE LAND SHOWN ON EXHIBIT A ATTACHED AND BY THIS REFERENCE MADE A PART HEREOF; NO MONETARY CONSIDERATION PURSUANT TO PUBLIC RESOURCES CODE SECTION 6503.5; LIABILITY INSURANCE IN THE AMOUNT OF NO LESS THAN \$300,000.

NO SCALE

# SITE MAP

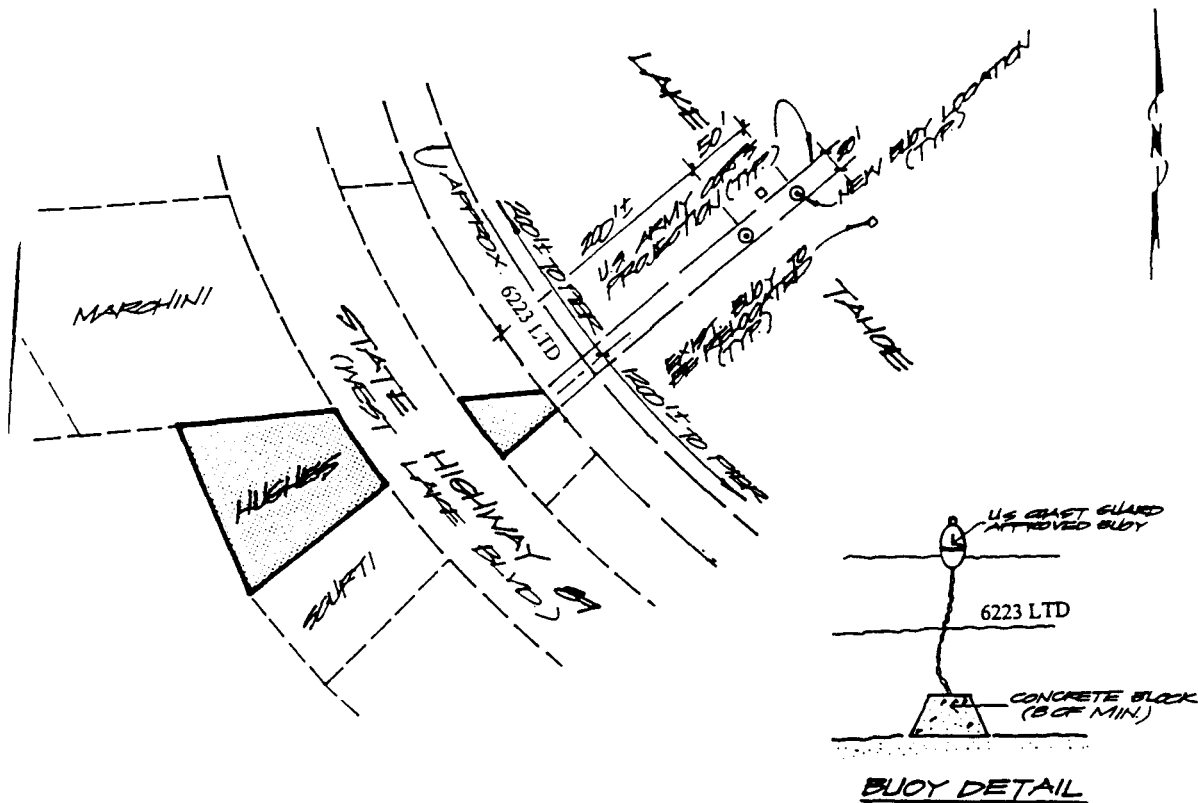

3105 W. Lake Blvd, Tahoe City

NO SCALE

## LOCATION MAP

### Lake Tahoe

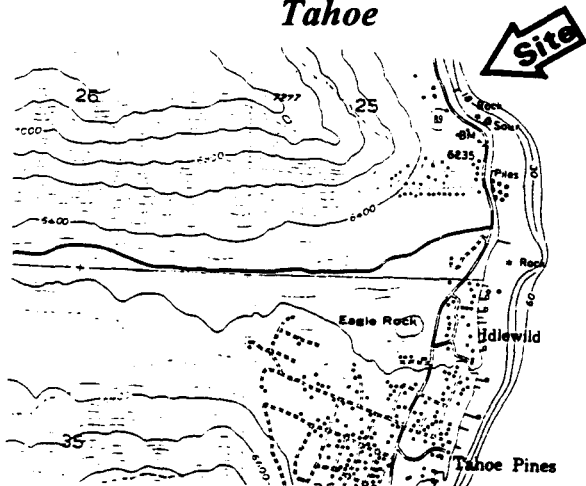

This Exhibit is solely for purposes of generally defining the lease premises, and is not intended to be, nor shall it be construed as, a waiver or limitation of any State interest in the subject or any other property.

Exhibit A  
 PRC 7556.9  
 APN 085-280-042  
 Lake Tahoe  
 PLACER COUNTY

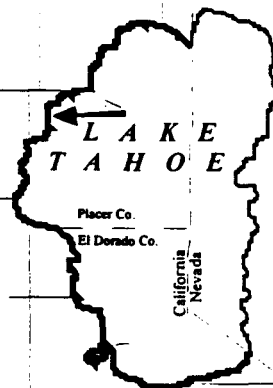

CALENDAR PAGE 60

MINUTE PAGE 002247