

MINUTE ITEM

This Calendar Item No. C15 was approved as Minute Item No. 15 by the California State Lands Commission by a vote of 3 to 0 at its 11/07/97 meeting.

CALENDAR ITEM

C15

A 1
S 2

11/07/97
PRC7993 W 24990
L. Fiack

GENERAL LEASE - RIGHT OF WAY USE

APPLICANT:

Charles F. Hansen, Sr.
2404 Sandy Prairie Road
Fortuna, California 95540

AREA, LAND TYPE, AND LOCATION:

0.01 acre, more or less, of sovereign lands in the Eel River, Fortuna, Humboldt County.

AUTHORIZED USE:

Placement of a seasonal bridge crossing over the Eel River, as shown on the attached Exhibit A. The exact location of the bridge may vary from year to year within the lease premises because of river conditions.

LEASE TERM:

Four years, five months and 23 days, beginning July 8, 1997.

CONSIDERATION:

\$100 per year.

SPECIFIC LEASE PROVISIONS:

Liability insurance coverage of no less than \$1,000,000.

OTHER PERTINENT INFORMATION:

1. This lease authorizes the use of sufficient lands for the placement of a temporary crossing within the area depicted in Exhibit A to this lease. The crossing shall be placed and removed in accordance with criteria established in permits issued by the County of Humboldt, California Department of Fish and Game, U.S. Army Corps of Engineers and the California Coastal Commission.
2. The lease requires the lessee to have ownership or a leasehold interest in all parcels connected by the crossing(s).

CALENDAR PAGE	49
MINUTE PAGE	002236

CALENDAR ITEM NO. C15 (CONT'D)

3. On July 8, 1997, the California Coastal Commission (CCC) granted Permit # 1-97-17 for this project under its certified regulatory program (Title 14, California Code of Regulations, section 15251 (c)).
4. Staff has reviewed the document and determined that the conditions, as specified in Title 14, California Code of Regulations, section 15253 (b), have been met for the Commission to use the environmental analysis document certified by the CCC as a Negative Declaration equivalent in order to comply with the requirements of the CEQA.
5. This activity involves lands identified as possessing significant environmental values pursuant to Public Resources Code sections 6370, et seq. Based on the staff's consultation with the persons nominating such lands and through the CEQA review process, it is the staff's opinion that the project, as proposed, is consistent with its use classification.

APPROVALS OBTAINED:

California Coastal Commission, United States Army Corps of Engineers,
California Department of Fish and Game, County of Humboldt

EXHIBIT:

A. Site and Location Map

PERMIT STREAMLINING ACT DEADLINE:

April 19, 1998

RECOMMENDED ACTION:

IT IS RECOMMENDED THAT THE COMMISSION:

CEQA FINDING:

FIND THAT AN ENVIRONMENTAL ANALYSIS DOCUMENT, CALIFORNIA COASTAL COMMISSION (CCC) PERMIT # 1-97-17, WAS ADOPTED FOR THIS PROJECT BY THE CCC UNDER ITS CERTIFIED PROGRAM (TITLE 14, CALIFORNIA CODE OF REGULATIONS, SECTION 15251 (c)), AND THAT THE CALIFORNIA STATE LANDS COMMISSION HAS REVIEWED AND CONSIDERED THE INFORMATION THEREIN AND CONCURS IN THE CCC'S DETERMINATION.

CALENDAR ITEM NO. C15 (CONT'D)

SIGNIFICANT LANDS INVENTORY FINDING:

FIND THAT THIS ACTIVITY IS CONSISTENT WITH THE USE CLASSIFICATION DESIGNATED BY THE COMMISSION FOR THE LAND PURSUANT TO PUBLIC RESOURCES CODE SECTIONS 6370, ET SEQ.

AUTHORIZATION:

AUTHORIZE ISSUANCE TO CHARLES F. HANSEN, SR. OF A GENERAL LEASE - RIGHT OF WAY USE, BEGINNING JULY 8, 1997, FOR A TERM OF FOUR YEARS, FIVE MONTHS AND 23 DAYS, FOR PLACEMENT OF A SEASONAL BRIDGE CROSSING OVER THE EEL RIVER ON THE LAND SHOWN ON EXHIBIT A ATTACHED AND BY THIS REFERENCE MADE A PART HEREOF; CONSIDERATION: \$100 PER YEAR; LIABILITY INSURANCE WITH COVERAGE OF NO LESS THAN \$1,000,000.

NO SCALE

SITE MAP

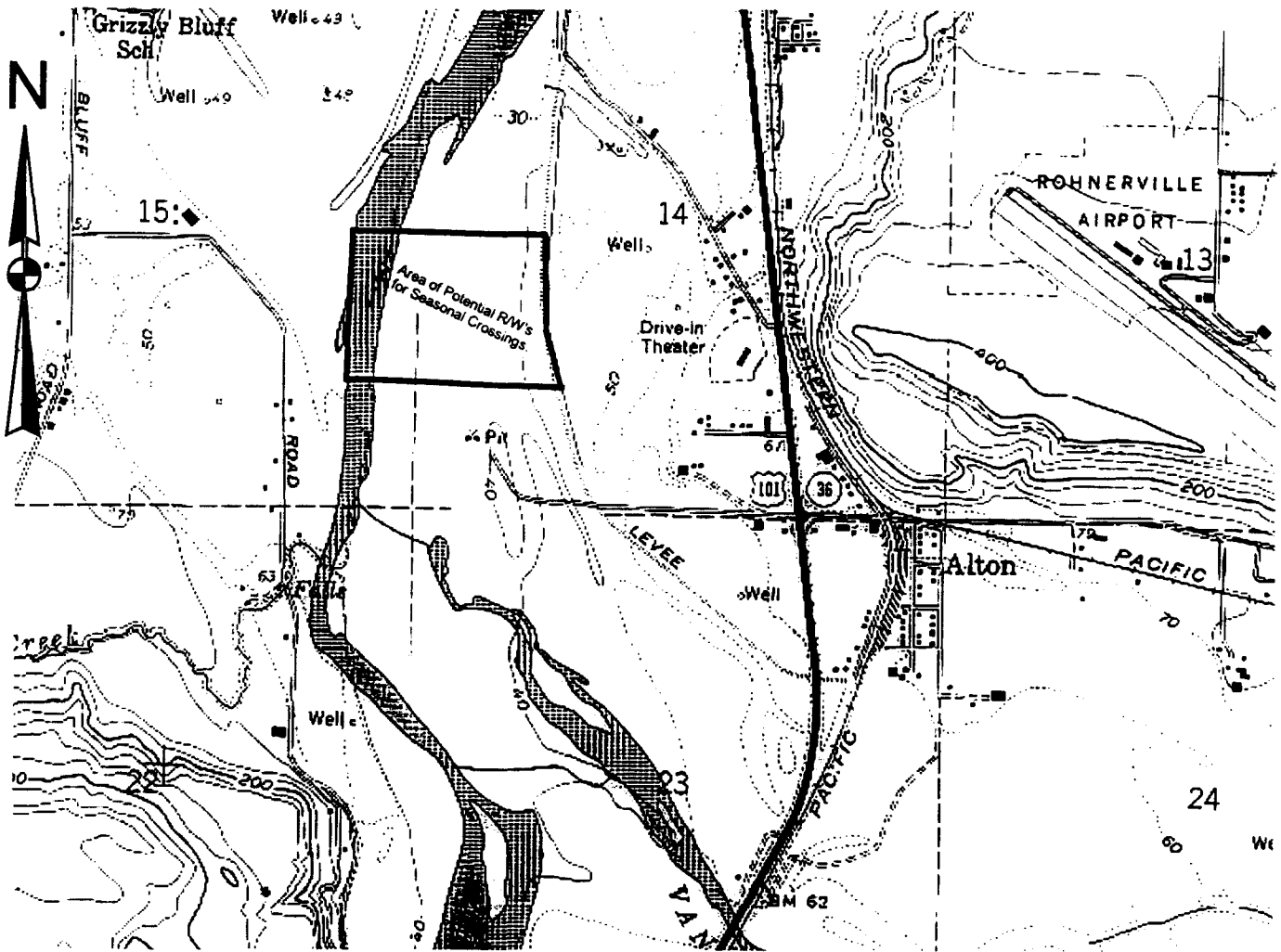

NO SCALE

LOCATION

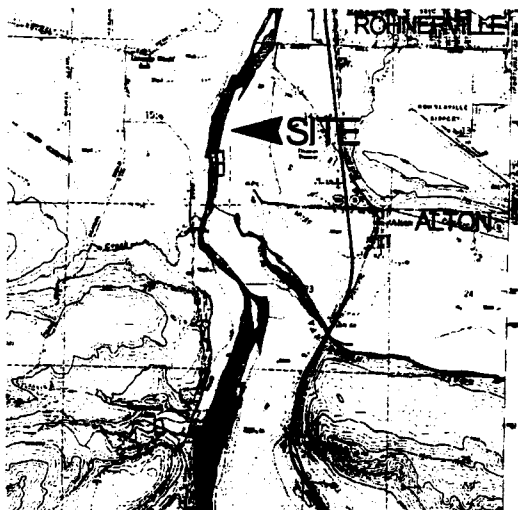

Exhibit A

W24990

APN 201-211-03

Eel River at Alton

HUMBOLDT COUNTY



This Exhibit is solely for purposes of generally defining the lease premises, and is not intended to be, nor shall it be construed as, a waiver or limitation of any State interest in the subject or any other property.

CALENDAR PAGE

52

MINUTE PAGE

002239

10/8/97