

MINUTE ITEM

This Calendar Item No. C14 was approved as Minute Item No. 14 by the California State Lands Commission by a vote of 3 to 0 at its 11/07/97 meeting.

**CALENDAR ITEM
C14**

A 4
S 1

11/07/97
PRC 5074.9
L. Fiack

RECREATIONAL PIER LEASE

APPLICANTS:

Bill Eastman and Lisa M. Eastman, Trustees of the Eastman Family Revocable Living Trust Declaration dated October 5, 1993
6097 Shiloh Ridge
Santa Rosa, California 95403

AREA, LAND TYPE, AND LOCATION:

Sovereign lands in Lake Tahoe, near Carnelian Bay, Placer County.

AUTHORIZED USE:

Continued use and maintenance of a mooring buoy, as shown on the attached Exhibit A.

LEASE TERM:

Ten years, beginning November 29, 1994.

CONSIDERATION:

No monetary consideration pursuant to Public Resources Code section 6503.5.

SPECIFIC LEASE PROVISIONS:

Insurance:

Liability insurance in the amount of no less than \$300,000.

Other:

This lease is conditioned on Lessee's obtaining authorization from the Tahoe Regional Planning Agency (TRPA) for the mooring buoy within two years from the effective date of the authorization of the buoy by the Commission.

OTHER PERTINENT INFORMATION:

1. Pursuant to the Commission's delegation of authority and the State CEQA Guidelines (Title 14, California Code of Regulations, section 15061), the staff has determined that this activity is exempt from the requirements of the CEQA as a categorically exempt project. The project is exempt under

CALENDAR PAGE	45
MINUTE PAGE	002232

CALENDAR ITEM NO. C14 (CONT'D)

Class 1, Existing Facilities; Title 2, California Code of Regulations, section 2905 (a) (2).

2. This activity involves lands identified as possessing significant environmental values pursuant to Public Resources Code sections 6370, et seq. Based upon the staff's consultation with the persons nominating such lands and through the CEQA review process, it is the staff's opinion that the project, as proposed, is consistent with its use classification.

FURTHER APPROVALS REQUIRED:

Tahoe Regional Planning Agency, California State Lands Commission

EXHIBIT:

- A. Site and Location Map

PERMIT STREAMLINING ACT DEADLINE:

N/A

RECOMMENDED ACTION:

IT IS RECOMMENDED THAT THE COMMISSION:

CEQA FINDING:

FIND THAT THE ACTIVITY IS EXEMPT FROM THE REQUIREMENTS OF THE CEQA PURSUANT TO TITLE 14, CALIFORNIA CODE OF REGULATIONS, SECTION 15061, AS A CATEGORICALLY EXEMPT PROJECT, CLASS 1, EXISTING FACILITIES; TITLE 2, CALIFORNIA CODE OF REGULATIONS, SECTION 2905 (a) (2).

SIGNIFICANT LANDS INVENTORY FINDING:

FIND THAT THIS ACTIVITY IS CONSISTENT WITH THE USE CLASSIFICATION DESIGNATED BY THE COMMISSION FOR THE LAND PURSUANT TO PUBLIC RESOURCES CODE SECTIONS 6370, ET SEQ.

CALENDAR ITEM NO. **C14** (CONT'D)

AUTHORIZATION:

AUTHORIZE ISSUANCE TO BILL EASTMAN AND LISA M. EASTMAN, TRUSTEES OF THE EASTMAN FAMILY REVOCABLE LIVING TRUST DECLARATION DATED OCTOBER 5, 1993 OF A TEN-YEAR RECREATIONAL PIER LEASE, BEGINNING NOVEMBER 29, 1994, FOR A BUOY ON THE LAND SHOWN ON EXHIBIT A, ATTACHED AND BY THIS REFERENCE MADE A PART HEREOF; NO MONETARY CONSIDERATION PURSUANT TO PUBLIC RESOURCES CODE SECTION 6503.5; LIABILITY INSURANCE IN THE AMOUNT OF NO LESS THAN \$300,000.

CALENDAR PAGE	47
MINUTE PAGE	002234

NO SCALE

SITE MAP

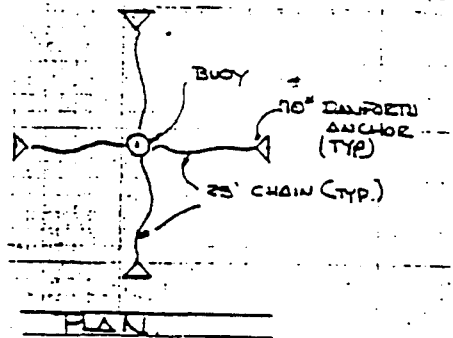
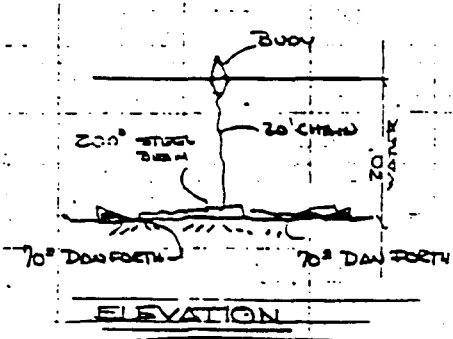

TYPICAL BUOY ANCHORAGE

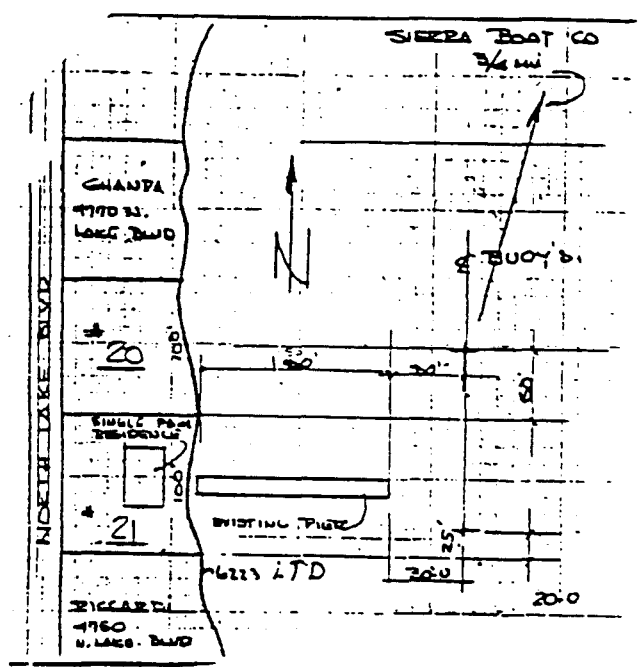

4762 N. Lake Blvd Carnelian Bay

NO SCALE

LOCATION MAP

Lake Tahoe

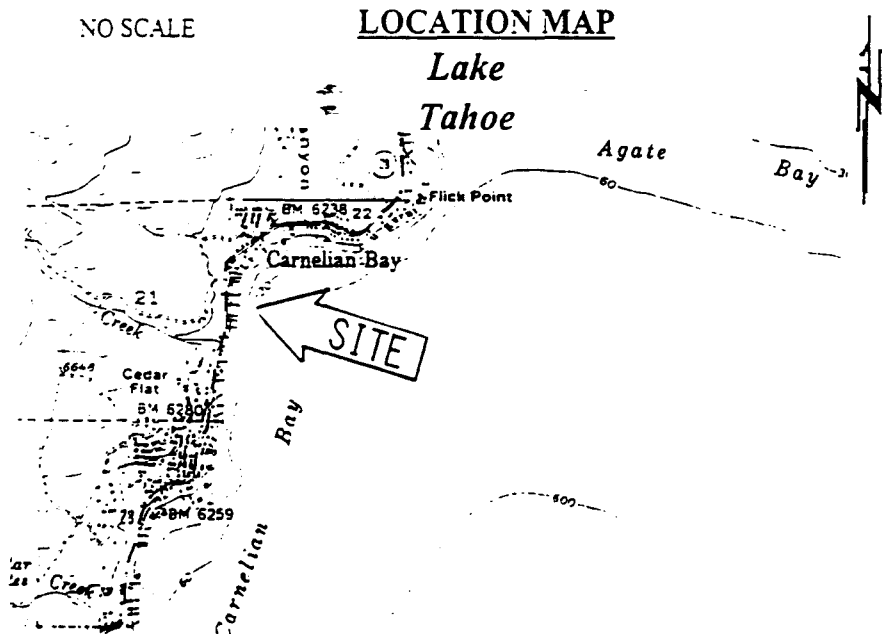

This Exhibit is solely for purposes of generally defining the lease premises, and is not intended to be, nor shall it be construed as, a waiver or limitation of any State interest in the subject or any other property.

Exhibit A

PRC 5074.9

APN 115-070-001

Lake Tahoe

PLACER COUNTY

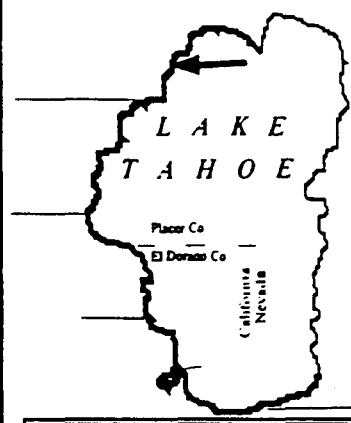

CALENDAR PAGE

48

MINUTE PAGE

002235