

MINUTE ITEM

This Calendar Item No. C17 was approved as Minute Item No. 17 by the California State Lands Commission by a vote of 3 to 0 at its 8/26/97 meeting.

**CALENDAR ITEM
C17**

A 54
S 27

08/26/97
PRC 6439.1
B. Dugal

GENERAL LEASE - RECREATIONAL USE

LESSEE:

Young Men's Christian Association of Glendale
140 North Louise Street
Glendale, California 91206-4226

AREA, LAND TYPE, AND LOCATION:

3.8 acres, more or less, of sovereign lands in White Cove near White's Landing on the northeast shore of Santa Catalina Island, Los Angeles County.

AUTHORIZED USE:

Continued use and maintenance of existing recreational facilities that consist of one standing pier, one ramp attached to the pier, one landing float, one swim float, one swim area with swim line marker, two rowboat mooring string lines, four full size moorings, and one ski boat platform.

LEASE TERM:

Ten years, beginning January 1, 1991.

CONSIDERATION:

\$50 per year; plus the public use and benefit; with the State reserving the right at any time to set a monetary rent if the Commission finds such action to be in the State's best interest.

SPECIFIC LEASE PROVISIONS:

Combined single limit liability insurance coverage of \$3,000,000.

OTHER PERTINENT INFORMATION:

1. The Applicant has submitted an application to replace an existing General Lease - Recreational Use, that expired December 31, 1991. The replacement lease provides for the continued use of sovereign lands for the use and maintenance of existing recreational facilities in White Cove which are used in conjunction with the Applicant's upland camp facility. Back rent in the amount of \$350 has been paid by the Applicant.

CALENDAR PAGE	60
MINUTE PAGE	001704

CALENDAR ITEM NO. C17 (CONT'D)

2. Applicant has the right to use the uplands adjoining the lease premises.
3. Pursuant to the Commission's delegation of authority and the State CEQA Guidelines (Title 14, California Code of Regulations, section 15061), the staff has determined that this activity is exempt from the requirements of the CEQA as a categorically exempt project. The project is exempt under Class 1, Existing Facilities; Title 2, California Code of Regulations, section 2905 (a)(2).

Authority: Public Resources Code section 21084 and Title 14, California Code of Regulations, section 15300 and Title 2, California Code of Regulations, section 2905.

4. This activity involves lands identified as possessing significant environmental values pursuant to Public Resources Code sections 6370, et seq. Based upon the staff's consultation with the persons nominating such lands and through the CEQA review process, it is the staff's opinion that the project, as proposed, is consistent with its use classification.

EXHIBITS:

- A. Location Map
- B. Land Description

PERMIT STREAMLINING ACT DEADLINE:

N/A

RECOMMENDED ACTION:

IT IS RECOMMENDED THAT THE COMMISSION:

CEQA FINDING:

FIND THAT THE ACTIVITY IS EXEMPT FROM THE REQUIREMENTS OF THE CEQA PURSUANT TO TITLE 14, CALIFORNIA CODE OF REGULATIONS, SECTION 15061 AS A CATEGORICALLY EXEMPT PROJECT, CLASS 1, EXISTING FACILITIES; TITLE 2, CALIFORNIA CODE OF REGULATIONS, SECTION 2905 (a) (2).

SIGNIFICANT LANDS INVENTORY FINDING:

FIND THAT THIS ACTIVITY IS CONSISTENT WITH THE USE CLASSIFICATION DESIGNATED BY THE COMMISSION FOR THE

CALENDAR ITEM NO. C17 (CONT'D)

LAND PURSUANT TO PUBLIC RESOURCES CODE SECTIONS 6370,
ET SEQ.

AUTHORIZATION:

WAIVE PENALTY AND INTEREST ON BACK RENT FOR THE PERIOD
JANUARY 1, 1991 THROUGH DECEMBER 31, 1997, AND ACCEPT
\$350 AS FULL PAYMENT OF BACK RENT.

AUTHORIZE ISSUANCE TO YOUNG MEN'S CHRISTIAN ASSOCIATION
OF GLENDALE OF A GENERAL LEASE - RECREATIONAL USE,
BEGINNING JANUARY 1, 1991, FOR A TERM OF TEN YEARS, FOR
CONTINUED USE AND MAINTENANCE OF RECREATIONAL
FACILITIES USED IN CONJUNCTION WITH THE APPLICANT'S
UPLAND CAMP PROGRAM ON THE LAND DESCRIBED ON EXHIBIT B
ATTACHED AND BY THIS REFERENCE MADE A PART HEREOF;
ANNUAL RENT IN THE AMOUNT OF \$50; PLUS THE PUBLIC USE AND
BENEFIT; WITH THE STATE RESERVING THE RIGHT AT ANY TIME
TO SET A MONETARY RENT IF THE COMMISSION FINDS SUCH
ACTION TO BE IN THE STATE'S BEST INTEREST; LIABILITY
INSURANCE FOR COMBINED SINGLE LIMIT COVERAGE OF
\$3,000,000.

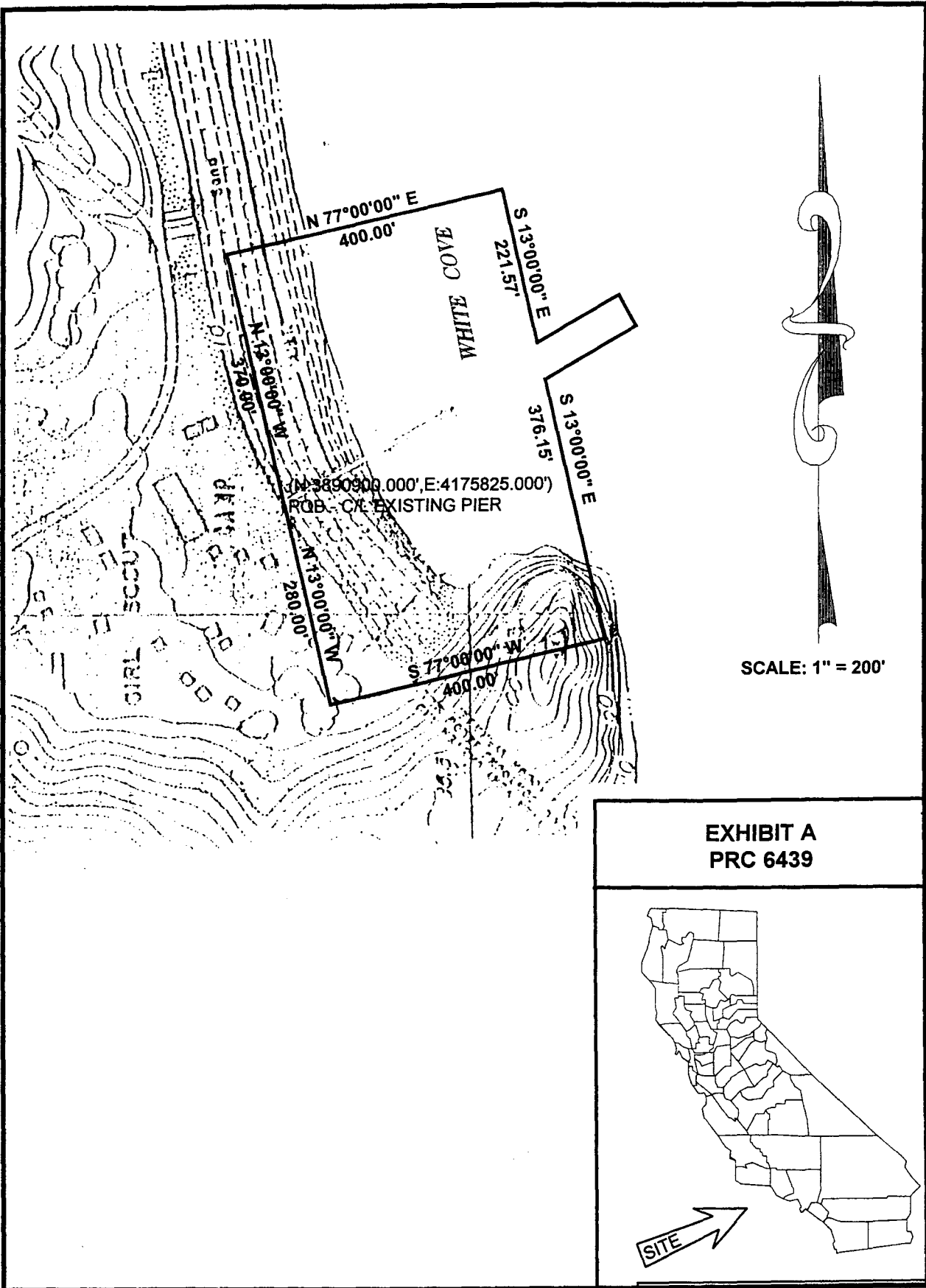

SCALE: 1" = 200'

EXHIBIT A
PRC 6439

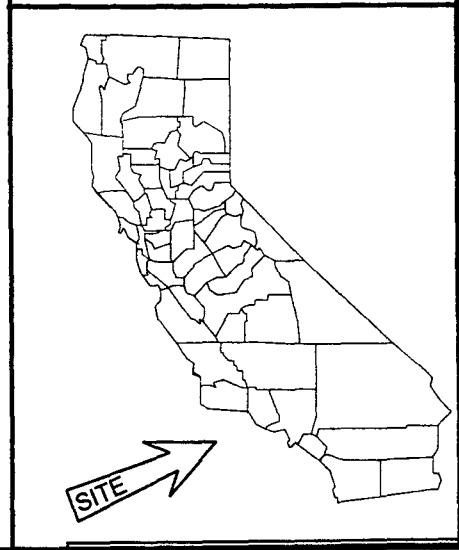

EXHIBIT B

PRC 6439.1

LAND DESCRIPTION

A parcel of tide and submerged land in the Pacific Ocean at White Cove on the northeasterly shore of Santa Catalina Island, Los Angeles County, California, described as follows:

BEGINNING at a point on the landward centerline of the existing pier at White Cove, said point having California Coordinate System, Zone 7 (NAD 27) coordinates of N = 3,890,900 feet and E = 4,175,825 feet; thence N 13°00'00" W, a distance of 370.00'; thence N 77°00'00" E, a distance of 400.00'; thence S 13°00'00" E, a distance of 221.57'; thence N 60°00'00" E, a distance of 134.08'; thence S 30°00'00" E, a distance of 50.00'; thence S 60°00'00" W, a distance of 149.36'; thence S 13°00'00" E, a distance of 376.15'; thence S 77°00'00" W, a distance of 400.00'; thence N 13°00'00" W, a distance of 280.00' to the POINT OF BEGINNING.

EXCEPTING THEREFROM any portion lying landward of the Ordinary High Water Mark of the Pacific Ocean.

This description is Based on the California Coordinate System, Zone 7 (NAD 27).

END OF DESCRIPTION

REVISED AUGUST 12, 1997 BY THE SOUTHERN CALIFORNIA TEAM.

CALENDAR PAGE	64
MINUTE PAGE	001738