

MINUTE ITEM

This Calendar Item No. 018 was approved as Minute Item No. 18 by the California State Lands Commission by a vote of 2 to 0 at its 7-11-97 meeting.

**CALENDAR ITEM
C18**

A 54
S 27

07/11/97
PRC 7966 W 25348
B. Dugal

GENERAL LEASE - PROTECTIVE STRUCTURE USE

LESSEE:

Santa Catalina Island Company
P. O. Box 737
Avalon, California 90704

AREA, LAND TYPE, AND LOCATION:

2.8 acres, more or less, of sovereign lands at Pebbly Beach, near the city of Avalon, Los Angeles County.

AUTHORIZED USE:

The placement of new rock revetment and the continued use and maintenance of existing rock revetment for shoreline protection.

LEASE TERM:

Ten years, beginning July 1, 1997.

CONSIDERATION:

The public health and safety; with the State reserving the right at any time to set a monetary rent if the Commission finds such action to be in the State's best interest.

SPECIFIC LEASE PROVISIONS:

Insurance:

Liability insurance: Combined single limit coverage of \$1,000,000.

OTHER PERTINENT INFORMATION:

1. Applicant owns the uplands adjoining the lease premises.
2. The Applicant contacted the California State Lands Commission (CSLC) regarding the proposed installation of an approximate 300 foot by 50 foot section of rock revetment along the Pebbly Beach shoreline for the protection of property structures from tidal action. During staff's review of the proposed project, staff determined that approximately 1,600 feet of

CALENDAR PAGE	192
MINUTE PAGE	001215

CALENDAR ITEM NO. C18 (CONT'D)

rock revetment had already been placed on either side of the proposed rock revetment project. Staff subsequently advised the Applicant of the need to obtain a lease from the California State Lands Commission for the existing and proposed revetment.

2. Pursuant to the Commission's delegation of authority and the State CEQA Guidelines (Title 14, California Code of Regulations, section 15061), the staff has determined that this activity is exempt from the requirements of the CEQA under the general rule that the CEQA applies only to projects which have the potential for causing a significant effect on the environment. The staff believes, based on the information available to it, that there is no possibility that this project may have a significant effect on the environment.

Authority: Title 14, California Code of Regulations, section 15061 (b) (3).

3. This activity involves lands identified as possessing significant environmental values pursuant to Public Resources Code sections 6370, et seq. Based upon the staff's consultation with the persons nominating such lands and through the CEQA review process, it is the staff's opinion that the project, as proposed, is consistent with its use classification.

APPROVALS OBTAINED:

Los Angeles County, Department of Regional Planning;
United States Army Corps of Engineers

FURTHER APPROVALS REQUIRED:

California State Lands Commission
California Coastal Commission
California Regional Water Quality Control Board

EXHIBITS:

- A. Location Map
- B. Land Description

PERMIT STREAMLINING ACT DEADLINE:

September 12, 1997.

CALENDAR PAGE	193
MINUTE PAGE	001216

CALENDAR ITEM NO. C18 (CONT'D)

RECOMMENDED ACTION:

IT IS RECOMMENDED THAT THE COMMISSION:

CEQA FINDING:

FIND THAT THE ACTIVITY IS EXEMPT FROM THE REQUIREMENTS OF THE CEQA PURSUANT TO TITLE 14, CALIFORNIA CODE OF REGULATIONS, SECTION 15061 BECAUSE THERE IS NO POSSIBILITY THAT THE ACTIVITY MAY HAVE A SIGNIFICANT EFFECT ON THE ENVIRONMENT; TITLE 14, CALIFORNIA CODE OF REGULATIONS, SECTION 15061 (b) (3).

SIGNIFICANT LANDS INVENTORY FINDING:

FIND THAT THIS ACTIVITY IS CONSISTENT WITH THE USE CLASSIFICATION DESIGNATED BY THE COMMISSION FOR THE LAND PURSUANT TO PUBLIC RESOURCES CODE SECTIONS 6370, ET SEQ.

AUTHORIZATION:

AUTHORIZE ISSUANCE TO SANTA CATALINA ISLAND COMPANY OF A GENERAL LEASE - PROTECTIVE STRUCTURE USE, BEGINNING JULY 1, 1997, FOR A TERM OF TEN YEARS, FOR THE PLACEMENT OF NEW ROCK REVETMENT AND THE CONTINUED USE AND MAINTENANCE OF EXISTING ROCK REVETMENT ON THE LAND DESCRIBED ON EXHIBIT B ATTACHED AND BY THIS REFERENCE MADE A PART HEREOF; CONSIDERATION BEING THE PUBLIC HEALTH AND SAFETY WITH THE STATE RESERVING THE RIGHT AT ANY TIME TO SET A MONETARY RENT IF THE COMMISSION FINDS SUCH ACTION TO BE IN THE STATE'S BEST INTEREST; LIABILITY INSURANCE TO BE PROVIDED FOR COMBINED SINGLE LIMIT COVERAGE OF \$1,000,000.

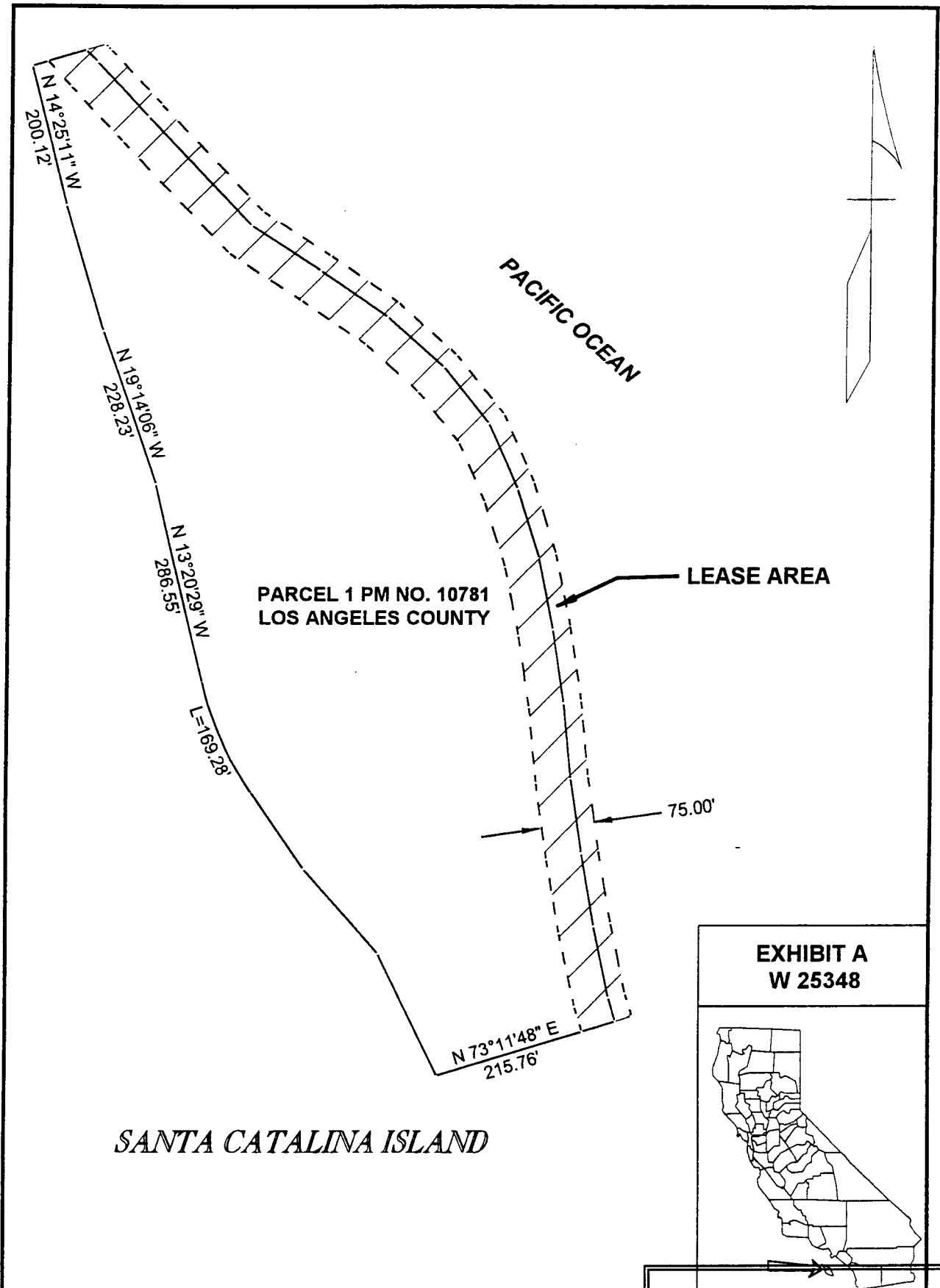

EXHIBIT A
W 25348

EXHIBIT B

LEGAL DESCRIPTION

A parcel of Tide and Submerged Land in the Pacific Ocean, along the easterly shore of Santa Catalina Island, County of Los Angeles, State of California, described as follows:

A strip of land 75.00 feet in width, the easterly boundary being 25.00 feet easterly and the westerly boundary being 50.00 feet westerly of the easterly boundary of Parcel 1 as said Parcel is shown on Parcel Map No. 10781, Filed in Book 136 of Parcel Maps at page 3 and 4, Los Angeles County Records.

The side lines of said strip shall be prolonged or shortened so as to terminate on the northerly boundary and its easterly prolongation of said Parcel 1 and on the southerly boundary and its easterly prolongation of said Parcel 1.

EXCEPTING THEREFROM any portion lying landward of the Ordinary High Water Mark of the Pacific Ocean on the Easterly shore of Santa Catalina Island.

END OF DESCRIPTION

Prepared, June 1997 by J. M. Mc Kown, PLS 4443

CALENDAR PAGE	196
MINUTE PAGE	001219