

**MINUTE ITEM**

This Calendar Item No. C65 was approved as Minute Item No. 65 by the California State Lands Commission by a vote of 3 to 0 at its 5/12/97 meeting.

**CALENDAR ITEM**

**C65**

A 4  
S 1

05/12/97  
WP 5101.1  
B. Young

**General Lease - Recreational Use**

**APPLICANT:**

Henry E. Bolton  
99 Skyline Circle  
Reno, Nevada 89509

**AREA, LAND TYPE, AND LOCATION:**

0.08 acres, more or less, of submerged lands in Lake Tahoe, Cedar Flat, Placer County.

**AUTHORIZED USE:**

Continued use and maintenance of a pier, as shown on the attached Exhibit A.

**LEASE TERM:**

Ten years, beginning December 21, 1996.

**CONSIDERATION:**

\$799 per year; with the State reserving the right to fix a different rent periodically during the lease term, as provided in the lease.

**SPECIFIC LEASE PROVISIONS:**

Insurance:

\$300,000 combined single limit coverage.

Bond:

N/A

**OTHER PERTINENT INFORMATION:**

1. Applicant owns the uplands adjoining the lease premises.
2. Pursuant to the Commission's delegation of authority and the State CEQA Guidelines (Title 14, California Code of Regulations, section 15061), the staff has determined that this activity is exempt from the requirements of the CEQA as a categorically exempt project.

CALENDAR PAGE	325
MINUTE PAGE	000820

**CALENDAR ITEM NO. C65 (CONT'D)**

The project is exempt under Class 1, Existing Facilities; Title 2, California Code of Regulations, section 2905 (a) (2). Authority: Public Resources Code section 21084 and Title 14, California Code of Regulations, section 15300 and Title 2, California Code of Regulations, section 2905.

3. This activity involves lands identified as possessing significant environmental values pursuant to Public Resources Code sections 6370, et seq. Based upon the staff's consultation with the persons nominating such lands and through the CEQA review process, it is the staff's opinion that the project, as proposed, is consistent with its use classification.

**EXHIBIT:**

- A. Site and Location Map

**PERMIT STREAMLINING ACT DEADLINE:**

N/A

**RECOMMENDED ACTION:**

IT IS RECOMMENDED THAT THE COMMISSION:

**CEQA FINDING:**

FIND THAT THE ACTIVITY IS EXEMPT FROM THE REQUIREMENTS OF THE CEQA PURSUANT TO TITLE 14, CALIFORNIA CODE OF REGULATIONS, SECTION 15061 AS A CATEGORICALLY EXEMPT PROJECT, CLASS 1, EXISTING FACILITIES; TITLE 2, CALIFORNIA CODE OF REGULATIONS, SECTION 2905 (a) (2).

**SIGNIFICANT LANDS INVENTORY FINDING:**

FIND THAT THIS ACTIVITY IS CONSISTENT WITH THE USE CLASSIFICATION DESIGNATED FOR THE LAND PURSUANT TO PUBLIC RESOURCES CODE SECTIONS 6370, ET SEQ.

**AUTHORIZATION:**

AUTHORIZE ISSUANCE TO HENRY E. BOLTON, OF A 10 YEAR GENERAL LEASE - RECREATIONAL USE, BEGINNING DECEMBER 21, 1996; FOR A PIER ON THE LANDS SHOWN ON EXHIBIT A ATTACHED AND BY THIS REFERENCE MADE A PART HEREOF;

**CALENDAR ITEM NO. C65 (CONT'D)**

ANNUAL RENT OF: \$799 PER YEAR WITH THE STATE RESERVING THE RIGHT TO FIX A DIFFERENT RENT PERIODICALLY DURING THE LEASE TERM; INSURANCE: LIABILITY INSURANCE FOR COMBINED SINGLE LIMIT COVERAGE OF \$300,000.

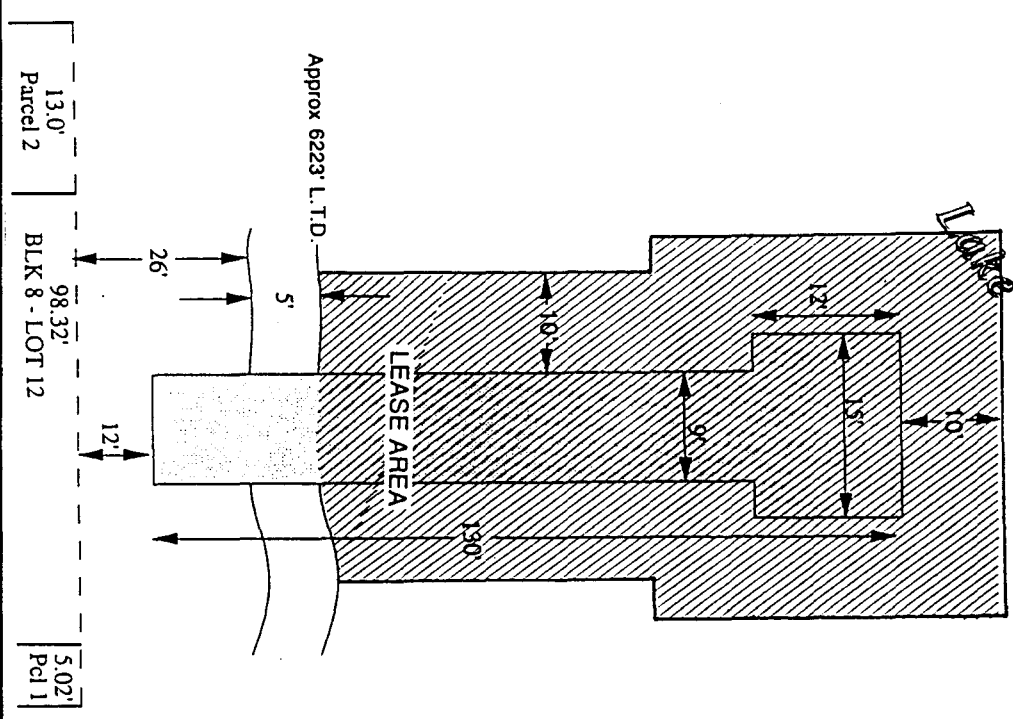

Tahoe

4250 North Lake Blvd.

NO SCALE

**LOCATION MAP**

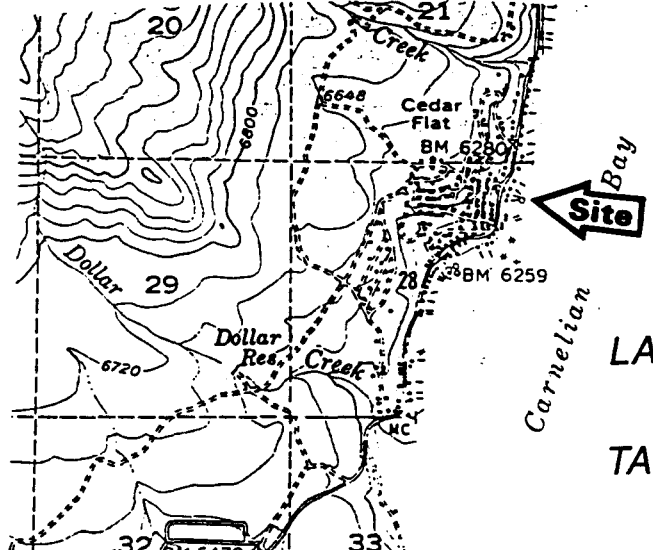

LAKE  
TAHOE

NO SCALE

Exhibit A  
 PRC 5101.1  
 APN 92 - 190 - 10 & 52  
 Lake Tahoe  
 PLACER COUNTY

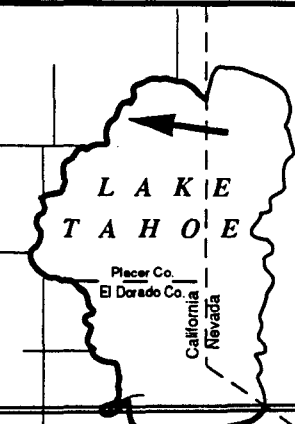

This Exhibit is solely for purposes of generally defining the lease premises, and is not intended to be, nor shall it be construed as, a waiver or limitation of any State interest in the subject or any other property.