

CALENDAR ITEM
C66

MINUTE ITEM
This Calendar Item No. C66
was approved as Minute Item
No. 666 by the State Lands
Commission by a vote of 3
to 0 at its 2-12-97
meeting.

A 4
S 1

02/12/97
PRC7910 WP 7910.9
B. Young

RECREATIONAL PIER LEASE

LESSEE:

John Thomas Rosch and Carolyn Jane Rosch
105 Crane Terrace
Orinda, California 94563

AREA, LAND TYPE, AND LOCATION:

A parcel of sovereign lands at Lake Tahoe near Lake Forest, Placer County.

AUTHORIZED USE:

Continued use and maintenance of two existing mooring buoys, as shown on the attached Exhibit "A".

LEASE TERM:

Ten years, beginning August 23, 1996.

CONSIDERATION:

No monetary consideration pursuant to Public Resources Code section 6503.5.

SPECIFIC LEASE PROVISIONS:

Insurance:

Liability insurance in the amount of no less than \$300,000.

OTHER PERTINENT INFORMATION:

1. Applicant is owner of the uplands adjoining the lease premises.
2. The lease is conditioned on lessee obtaining authorization from the Tahoe Regional Planning Agency for the existing mooring buoys within two years of the authorization of the buoys by the Commission.

FURTHER APPROVALS REQUIRED:

Tahoe Regional Planning Agency, California State Lands Commission.

CALENDAR PAGE	292
MINUTE PAGE	000316

CALENDAR ITEM NO. C66 (CONT'D)

EXHIBIT:

A. Site and Location Map.

PERMIT STREAMLINING ACT DEADLINE:

N/A

RECOMMENDED ACTION:

IT IS RECOMMENDED THAT THE COMMISSION:

CEQA FINDING:

FIND THAT THE ACTIVITY IS EXEMPT FROM THE REQUIREMENTS OF THE CEQA PURSUANT TO TITLE 14, CALIFORNIA CODE OF REGULATIONS, SECTION 15061, AS A CATEGORICALLY EXEMPT PROJECT, CLASS 1, EXISTING FACILITIES; TITLE 2, CALIFORNIA CODE OF REGULATIONS, SECTION 2905 (a) (2).

SIGNIFICANT LANDS INVENTORY FINDING:

FIND THAT THIS ACTIVITY IS CONSISTENT WITH THE USE CLASSIFICATION DESIGNATED BY THE COMMISSION FOR THE LAND PURSUANT TO PUBLIC RESOURCES CODE SECTIONS 6370, ET SEQ.

AUTHORIZATION:

AUTHORIZE ISSUANCE TO JOHN THOMAS ROSCH AND CAROLYN JANE ROSCH OF A TEN-YEAR RECREATIONAL PIER LEASE, BEGINNING AUGUST 24, 1996, ON FILE IN THE COMMISSION'S OFFICES FOR THE STATE'S SOVEREIGN LANDS BELOW ELEVATION 6223 FEET, LAKE TAHOE DATUM, UNDER APPLICANT'S PIER AND TWO MOORING BUOYS AS DEPICTED ON EXHIBIT "A" ATTACHED AND BY REFERENCE MADE A PART HEREOF. NO MONETARY CONSIDERATION PURSUANT TO PUBLIC RESOURCES CODE SECTION 6503.5.

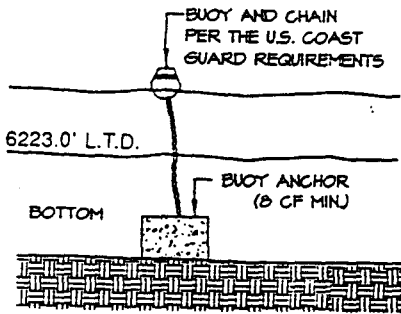
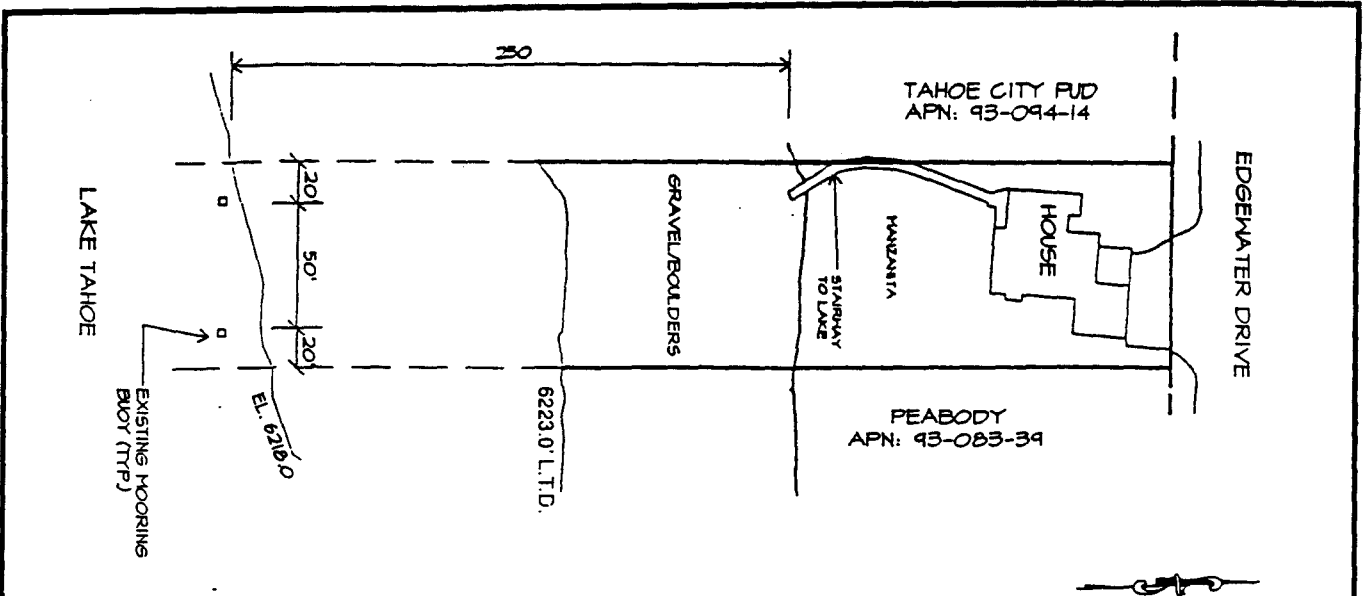

BUOY DETAIL

NO SCALE

NOTES

- 1) THE PROJECT INVOLVES THE RETAINMENT OF TWO MOORING BUOYS.
- 2) THE EXISTING BUOYS WILL BE CONVERTED TO SEASONAL USE. SEASONAL USE IS IDENTIFIED AS REMOVING THE BUOY FLOATS BETWEEN OCTOBER 15 AND MAY 15 OF EACH YEAR.

3340 Edgewater Drive

NO SCALE

LOCATION MAP

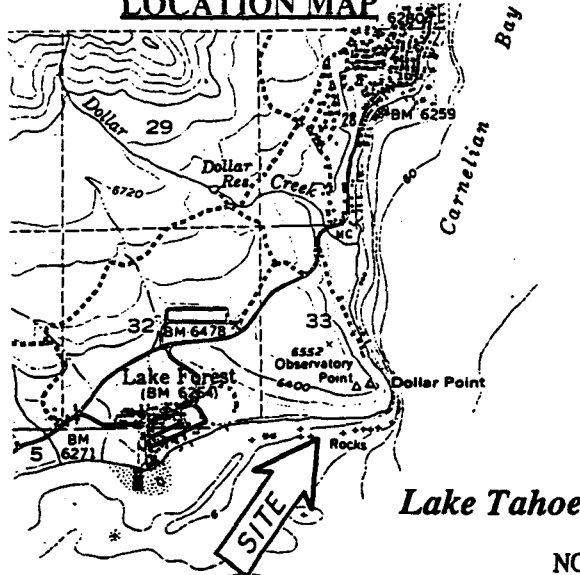

NO SCALE

This Exhibit is solely for purposes of generally defining the lease premises, and is not intended to be, nor shall it be construed as, a waiver or limitation of any State interest in the subject or any other property.

EXHIBIT "A"

PRC 7910.9

APN 93 - 094 - 39

Lake Tahoe

PLACER COUNTY

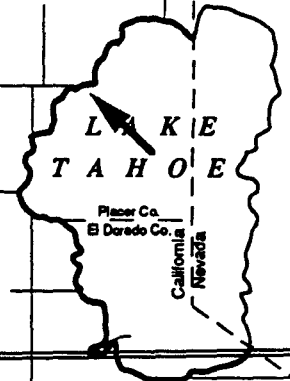

CALENDAR PAGE

294

MINUTE PAGE

000318