

MINUTE ITEM  
This Calendar Item No. C63  
was approved as Minute Item  
No. 603 by the State Lands  
Commission by a vote of 3  
to 0 at its 02/12/97  
meeting.

CALENDAR ITEM  
**C63**

A 4  
S 1

02/12/97  
PRC7451 WP 7451.9  
B. Young

**RECREATIONAL PIER LEASE**

**LESSEE:**

Burton Hancock  
1660 Hamilton Avenue, #201  
San Jose, California 95125

**AREA, LAND TYPE, AND LOCATION:**

A parcel of sovereign lands located in Lake Tahoe near Rubicon Bay, El Dorado County.

**AUTHORIZED USE:**

Continued use and maintenance of an existing pier and boat lift, as shown on the attached Exhibit "A".

**LEASE TERM:**

Ten years, beginning September 27, 1995.

**CONSIDERATION:**

No monetary consideration pursuant to Public Resources Code section 6503.5.

**SPECIFIC LEASE PROVISIONS:**

Insurance:

Liability insurance in the amount of no less than \$300,000.

**EXHIBIT:**

A. Site and Location Map

**PERMIT STREAMLINING ACT DEADLINE:**

N/A

CALENDAR PAGE	281
MINUTE PAGE	000305

CALENDAR ITEM NO. C63 (CONT'D)

**RECOMMENDED ACTION:**

IT IS RECOMMENDED THAT THE COMMISSION:

**CEQA FINDING:**

FIND THAT THE ACTIVITY IS EXEMPT FROM THE REQUIREMENTS OF THE CEQA PURSUANT TO TITLE 14, CALIFORNIA CODE OF REGULATIONS, SECTION 15061, AS A CATEGORICALLY EXEMPT PROJECT, CLASS 1, EXISTING FACILITIES; TITLE 2, CALIFORNIA CODE OF REGULATIONS, SECTION 2905 (a) (2).

**SIGNIFICANT LANDS INVENTORY FINDING:**

FIND THAT THIS ACTIVITY IS CONSISTENT WITH THE USE CLASSIFICATION DESIGNATED BY THE COMMISSION FOR THE LAND PURSUANT TO PUBLIC RESOURCES CODE SECTIONS 6370, ET SEQ.

**AUTHORIZATION:**

AUTHORIZE ISSUANCE TO BURTON HANCOCK OF A TEN-YEAR RECREATIONAL PIER LEASE ON FILE IN THE COMMISSION'S OFFICES FOR ALL THE STATE'S SOVEREIGN LANDS BELOW ELEVATION 6223 FEET, LAKE TAHOE DATUM, UNDER THE APPLICANT'S PIER AND BOAT LIFT, AS DEPICTED ON EXHIBIT "A" ATTACHED AND BY REFERENCE MADE A PART HEREOF, BEGINNING SEPTEMBER 27, 1995; NO MONETARY CONSIDERATION PURSUANT TO PUBLIC RESOURCES CODE SECTION 6503.5.

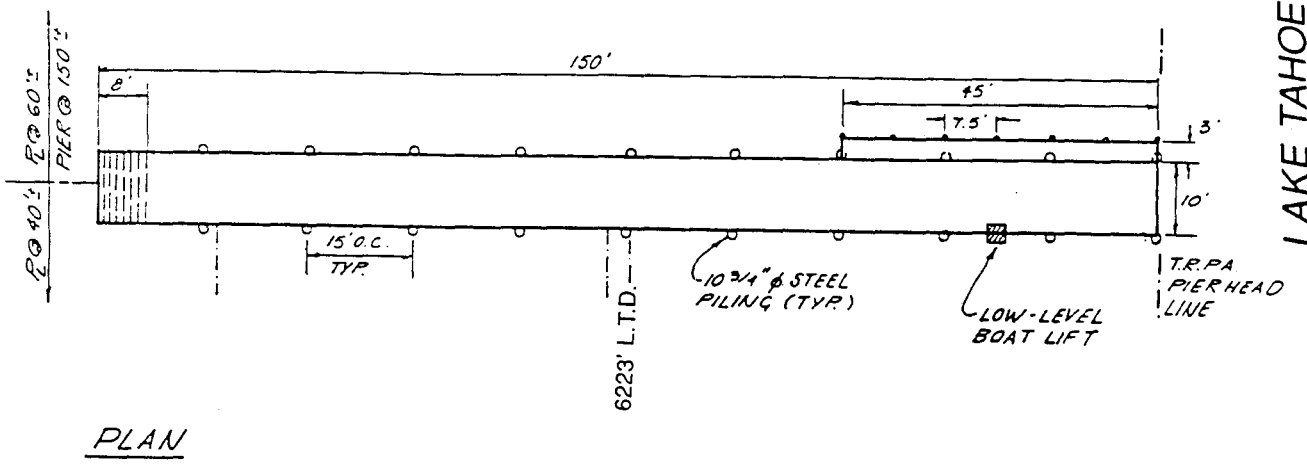
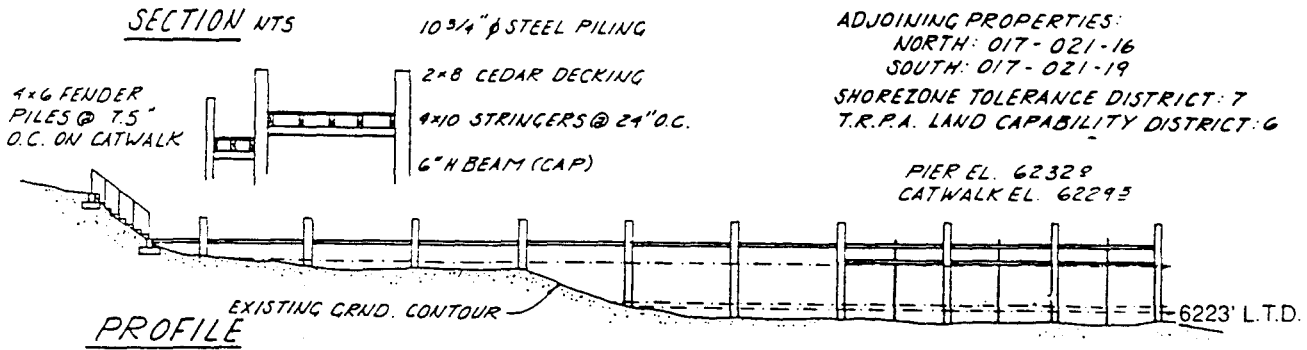

234 Four Ring Road.

NO SCALE

**LOCATION MAP**

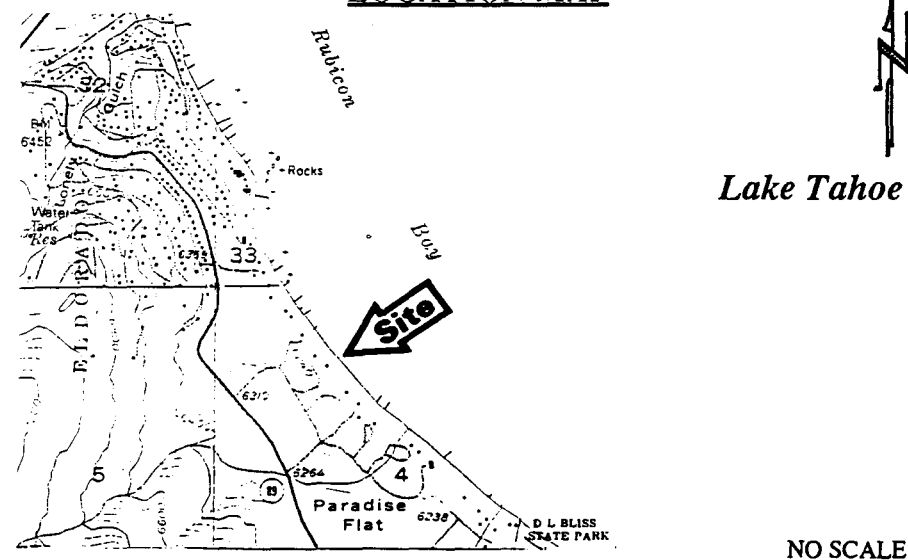

NO SCALE

This Exhibit is solely for purposes of generally defining the lease premises, and is not intended to be, nor shall it be construed as, a waiver or limitation of any State interest in the subject or any other property.

**EXHIBIT "A"**

PRC 7451.9  
 APN 017-021-181  
 Lake Tahoe  
 EL DORADO COUNTY

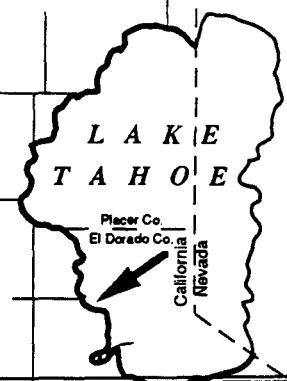

CALENDAR PAGE 283

MINUTE PAGE CG 12/96 OCC 307