

MINUTE ITEM  
This Calendar Item No. C45  
was approved as Minute Item  
No. 75 by the State Lands  
Commission by a vote of 3  
to 0 at its 02/12/97  
meeting.

CALENDAR ITEM  
**C45**

A 4

02/12/97

S 1

PRC 7353.9

J. Ludlow

**RECREATIONAL PIER LEASE**

**LESSEE:**

Joseph William May and Betty L. May Trustees or their successors in trust under the Joseph William May and Betty L. May Declaration of Trust dated May 28, 1993  
7882 Lakeshore Drive  
Granite Bay, California 95746

**AREA, LAND TYPE, AND LOCATION:**

Sovereign lands in Lake Tahoe at Meeks Bay, El Dorado County.

**AUTHORIZED USE:**

Continued use and maintenance of an existing pier, boat lift and two mooring buoys, as shown on the attached Exhibit "A".

**LEASE TERM:**

Ten years, beginning February 1, 1997.

**CONSIDERATION:**

No monetary consideration pursuant to Public Resources Code section 6503.5.

**SPECIFIC LEASE PROVISIONS:**

Insurance:

Liability insurance in the amount of no less than \$300,000.

**EXHIBIT:**

A. Site and Location Map

**PERMIT STREAMLINING ACT DEADLINE:**

N/A

CALENDAR ITEM NO. **C45** (CONT'D)

**RECOMMENDED ACTION:**

IT IS RECOMMENDED THAT THE COMMISSION:

**CEQA FINDING:**

FIND THAT THE ACTIVITY IS EXEMPT FROM THE REQUIREMENTS OF THE CEQA PURSUANT TO TITLE 14, CALIFORNIA CODE OF REGULATIONS, SECTION 15061 AS A CATEGORICALLY EXEMPT PROJECT, CLASS 1 EXISTING FACILITY. TITLE 2, CALIFORNIA CODE OF REGULATIONS, SECTION 2905 (a) (2).

**SIGNIFICANT LANDS INVENTORY FINDING:**

FIND THAT THIS ACTIVITY IS CONSISTENT WITH THE USE CLASSIFICATION DESIGNATED BY THE COMMISSION FOR THE LAND PURSUANT TO PUBLIC RESOURCES CODE SECTIONS 6370, ET SEQ.

**AUTHORIZATION:**

AUTHORIZE ISSUANCE TO JOSEPH WILLIAM MAY AND BETTY L. MAY TRUSTEES OR THEIR SUCCESSORS IN TRUST UNDER THE JOSEPH WILLIAM MAY AND BETTY L. MAY DECLARATION OF TRUST DATED MAY 28, 1993, OF A TEN-YEAR RECREATIONAL PIER LEASE BEGINNING FEBRUARY 1, 1997; FOR ALL OF THE STATE'S SOVEREIGN LANDS BELOW THE ELEVATION OF 6223 FEET, LAKE TAHOE DATUM, UNDER APPLICANT'S PIER, BOAT LIFT AND TWO MOORING BUOYS AS DEPICTED ON EXHIBIT "A" ATTACHED AND BY REFERENCE MADE A PART HEREOF; NO MONETARY CONSIDERATION PURSUANT TO PUBLIC RESOURCES CODE SECTION 6503.

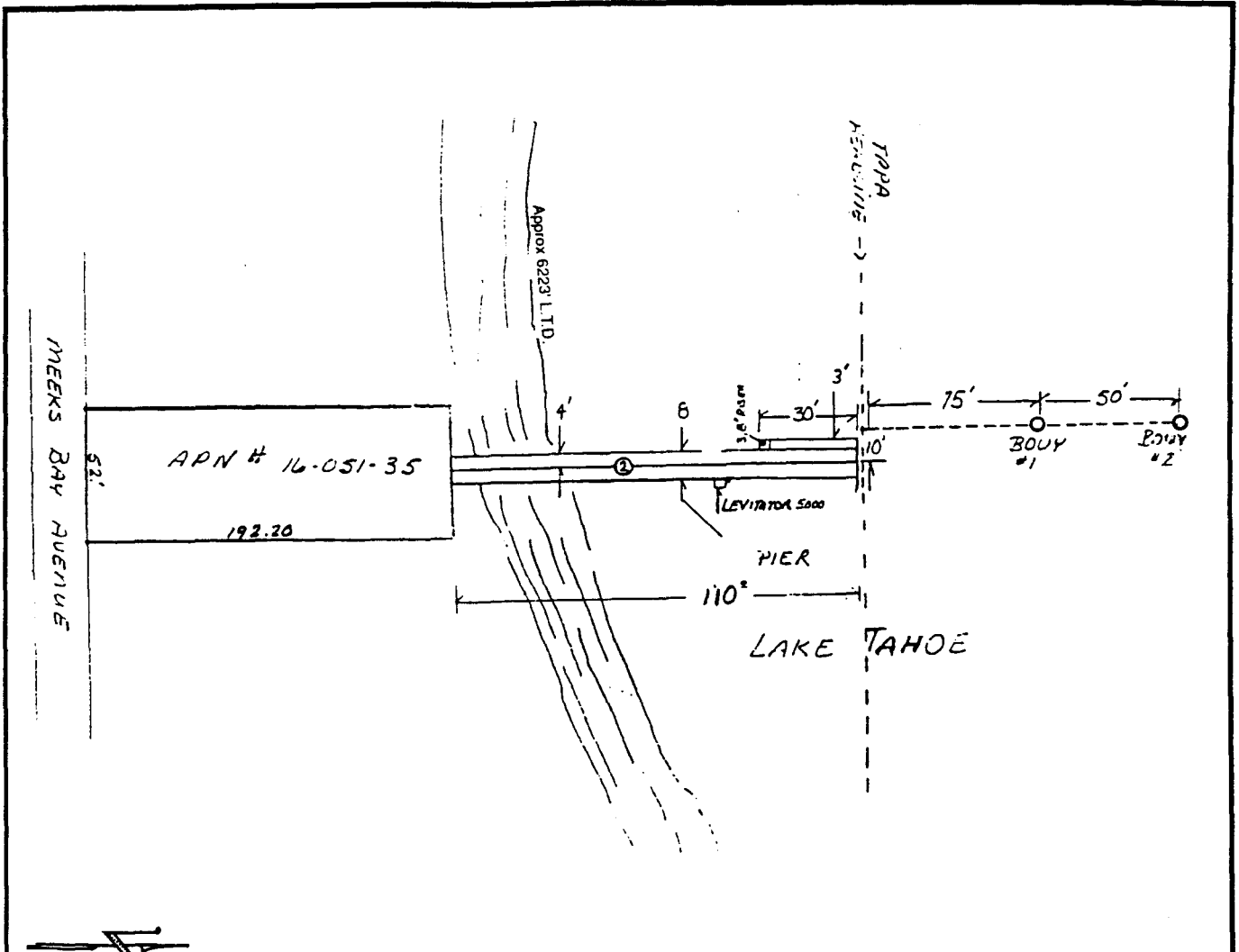

8209 Meeks Bay Ave.

NO SCALE

**LOCATION MAP**

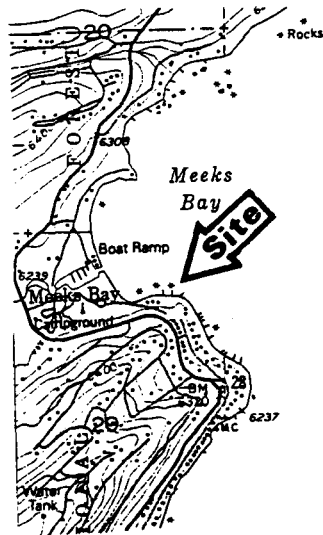

Lake Tahoe

**EXHIBIT "A"**

PRC 7353.9

APN 16 - 051 - 351

Lake Tahoe

EL DORADO COUNTY

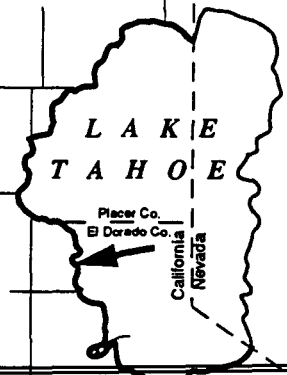

NO SCALE

This Exhibit is solely for purposes of generally defining the lease premises, and is not intended to be, nor shall it be construed as, a waiver or limitation of any State interest in the subject or any other property.

CALENDAR PAGE

211

MINUTE PAGE

CG 12/96  
OCC230