

MINUTE ITEM
This Calendar Item No. C44
was approved as Minute Item
No. 44 by the State Lands
Commission by a vote of 3
to 0 at its 02/12/97
meeting.

CALENDAR ITEM
C44

A 4
S 1

02/12/97
PRC 4994.1
J. Ludlow

GENERAL LEASE - RECREATIONAL USE

LESSEE:

Dennis C. Pulos and Julie J. Pulos, Trustees
of the Dennis and Julie 1988 Pulos
Family Revocable Trust dated May 6, 1988
1345 Easy Lane
El Dorado Hills, California 95762

AREA, LAND TYPE, AND LOCATION:

0.28 acres, more or less, of submerged lands in Lake Tahoe at Carnelian Bay,
Placer County.

AUTHORIZED USE:

Reconstruction and a 45-foot extension to an existing pier, relocation of a marine
rail, installation of a boat lift, and the continued use and maintenance of an
existing mooring buoy, as shown on Exhibit "A", attached.

LEASE TERM:

Ten years, beginning December 15, 1996.

CONSIDERATION:

Pier, boat lift and buoy: No monetary consideration pursuant to Public
Resources Code section 6503.5.

Marine Rail: \$260 per annum; modification of rent periodically during the lease
term.

SPECIFIC LEASE PROVISIONS:

Insurance:

Liability insurance in the amount of no less than \$300,000.

Bond:

N/A

CALENDAR ITEM NO. C44 (CONT'D)

OTHER PERTINENT INFORMATION:

1. Applicant is owner of the uplands adjoining the lease premises.
2. The lease is conditioned on lessee's obtaining authorization from the Tahoe Regional Planning Agency for the existing buoy within two years of the authorization of the buoy by the Commission.

APPROVALS OBTAINED:

Tahoe Regional Planning Agency
United States Army Corps of Engineers

FURTHER APPROVALS REQUIRED:

California Department of Fish and Game

EXHIBIT:

A. Site and Location Map

PERMIT STREAMLINING ACT DEADLINE:

February 14, 1997

RECOMMENDED ACTION:

IT IS RECOMMENDED THAT THE COMMISSION:

CEQA FINDING:

FIND THAT THE ACTIVITY IS EXEMPT FROM THE REQUIREMENTS OF THE CEQA PURSUANT TO TITLE 14, CALIFORNIA CODE OF REGULATIONS, SECTION 15061, AS A CATEGORICALLY EXEMPT PROJECT, CLASS 1, EXISTING FACILITIES; TITLE 2, CALIFORNIA CODE OF REGULATIONS, SECTION 2905 (a) (2).

SIGNIFICANT LANDS INVENTORY FINDING:

FIND THAT THIS ACTIVITY IS CONSISTENT WITH THE USE CLASSIFICATION DESIGNATED FOR THE LAND PURSUANT TO PUBLIC RESOURCES CODE SECTIONS 6370, ET SEQ.

CALENDAR ITEM NO. C44 (CONT'D)

AUTHORIZATION:

AUTHORIZE ISSUANCE TO DENNIS C. PULOS AND JULIE J. PULOS, TRUSTEES OF THE DENNIS AND JULIE 1988 PULOS FAMILY REVOCABLE TRUST DATED MAY 6, 1988, OF A TEN-YEAR GENERAL LEASE - RECREATIONAL USE EFFECTIVE DECEMBER 15, 1996; ANNUAL RENT FOR THE MARINE RAIL IN THE AMOUNT OF \$260 WITH THE STATE RESERVING THE RIGHT TO FIX A DIFFERENT RENT PERIODICALLY DURING THE TERM OF THE LEASE; NO MONETARY CONSIDERATION FOR THE PIER, BOAT LIFT AND BUOY PURSUANT TO PUBLIC RESOURCES CODE SECTION 6503.5. PROVISION OF LIABILITY INSURANCE IN THE AMOUNT OF NO LESS THAN \$300,000 FOR THE RECONSTRUCTION AND 45-FOOT EXTENSION OF AN EXISTING PIER, RELOCATION OF AN EXISTING MARINE RAIL, INSTALLATION OF A BOAT LIFT, AND CONTINUED USE AND MAINTENANCE OF AN EXISTING MOORING BUOY ON THE LAND DESCRIBED ON EXHIBIT "A" ATTACHED AND BY REFERENCE MADE A PART HEREOF.

CALENDAR PAGE	206
MINUTE PAGE	0C0225

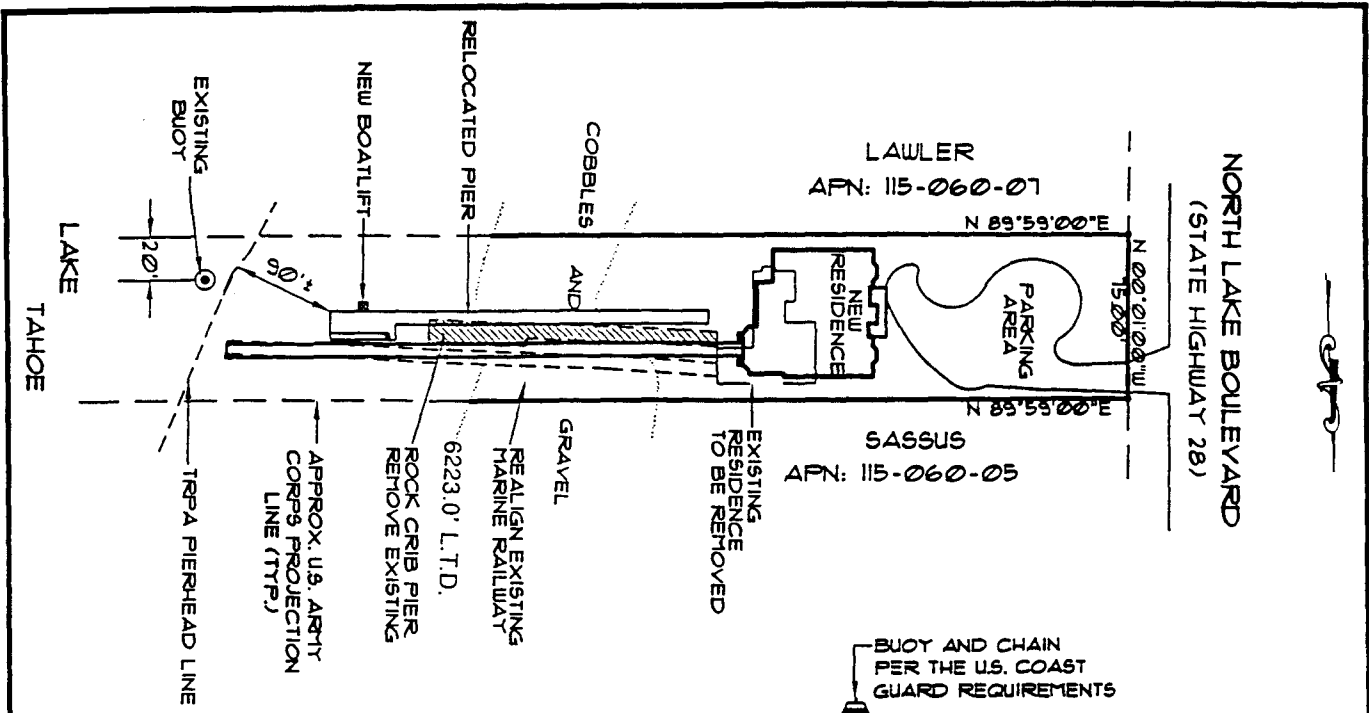

NOTES

- 1) THE PROJECT CONSISTS OF MODIFYING AN EXISTING PIER AND MARINE RAILWAY TO BRING THESE STRUCTURES TOWARDS CONFORMANCE WITH THE APPLICABLE AGENCY REQUIREMENTS.
- 2) THE EXISTING MOORING BUOY IS CURRENTLY UNDER PERMIT WITH THE U.S. ARMY CORPS OF ENGINEERS AND THE CALIFORNIA STATE LANDS COMMISSION.

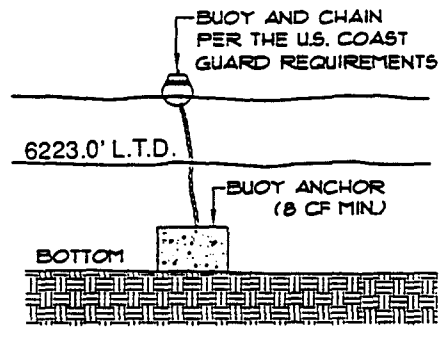

BUOY DETAIL
NO SCALE

4850 North Lake Blvd.

NO SCALE

LOCATION MAP

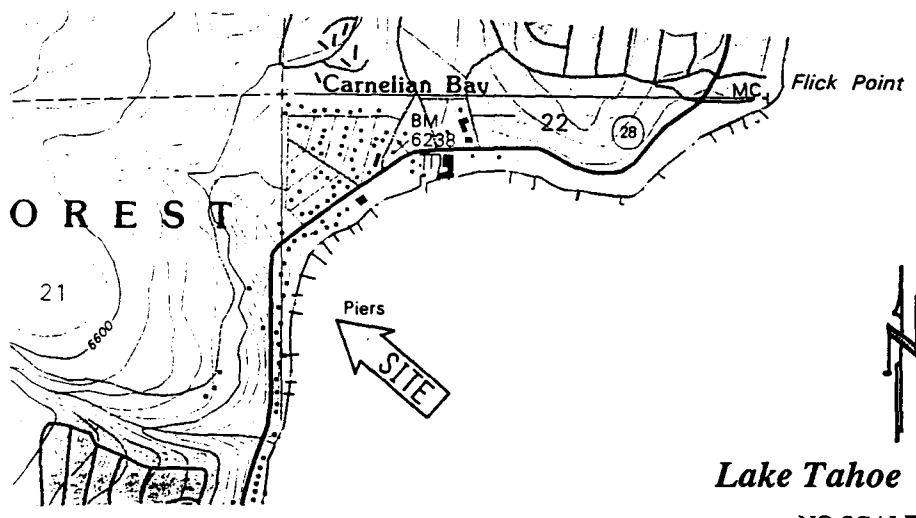

Lake Tahoe
NO SCALE

This Exhibit is solely for purposes of generally defining the lease premises, and is not intended to be, nor shall it be construed as, a waiver or limitation of any State interest in the subject or any other property.

EXHIBIT "A"

PRC 4994.9
APN 115 - 060 - 06
Lake Tahoe
PLACER COUNTY
Sheet 1 of 2 Sheets

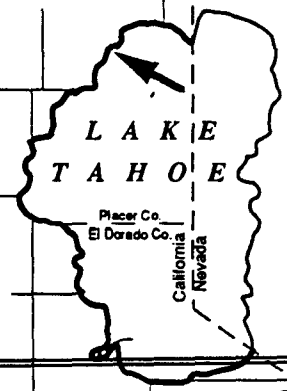

CALENDAR PAGE 207

MINUTE PAGE 006506 25

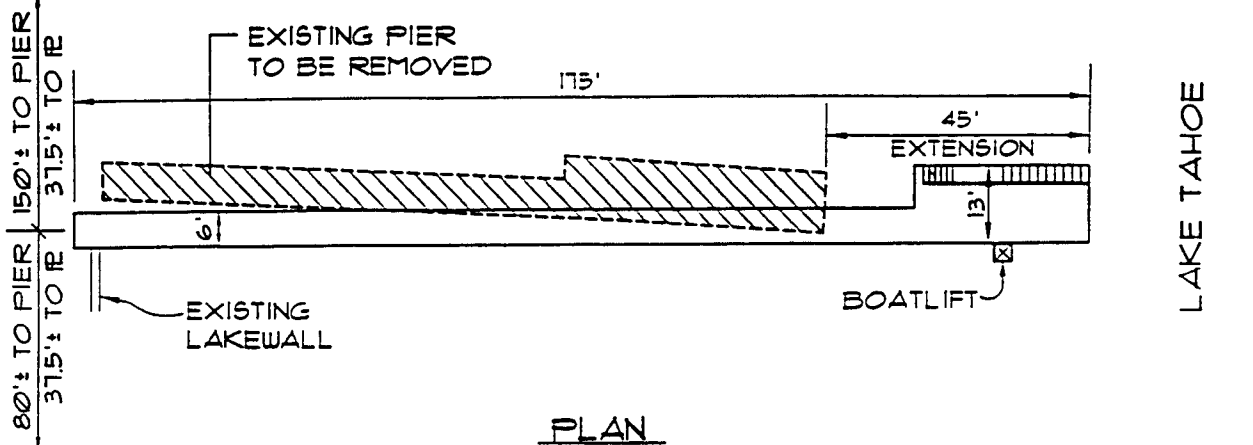

PLAN

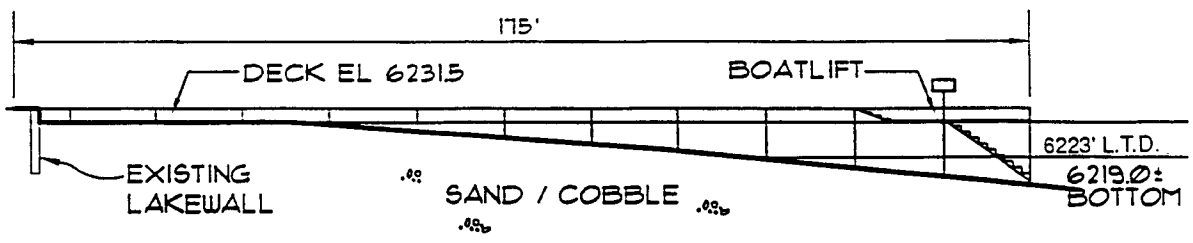

PROFILE

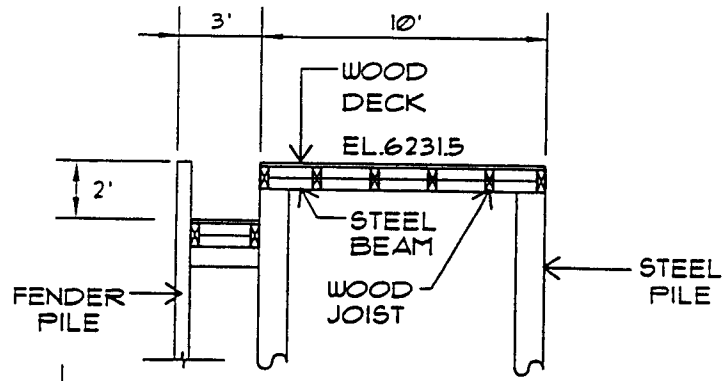

PIERHEAD SECTION
NO SCALE

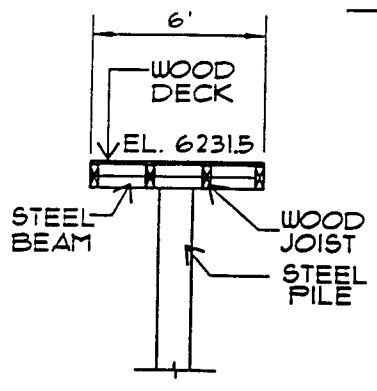

WALKWAY SECTION
NO SCALE

NO SCALE
EXHIBIT "A"
 PRC 4994.9
 APN 115 - 060 - 06
 Lake Tahoe
 PLACER COUNTY
 Sheet 2 of 2 Sheets

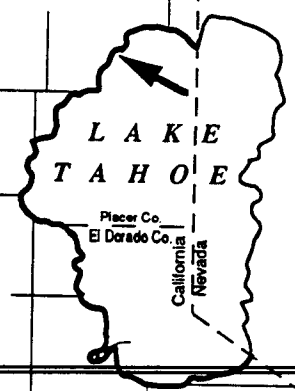

This Exhibit is solely for purposes of generally defining the lease premises, and is not intended to be, nor shall it be construed as, a waiver or limitation of any State interest in the subject or any other property.