

CALENDAR ITEM
C07

MINUTE ITEM
This Calendar Item No. C07
was approved as Minute Item
No. 07 by the State Lands
Commission by a vote of 3
to 0 at its 02/12/97
meeting.

A 8

S 4

02/12/97
PRC 5273 WP 5273.9
L. Burks

RECREATIONAL PIER LEASE

LESSEE:

Jeff Martin, et al.
101 Green Valley Road
Gilroy, California 95020

AREA, LAND TYPE, AND LOCATION:

0.20 acres, more or less, of tide and submerged lands in Georgiana Slough near
Isleton (APN 156-0080-048), Sacramento County.

AUTHORIZED USE:

Floating boathouse with dock and walkway.

LEASE TERM:

Ten years, beginning March 1, 1997.

CONSIDERATION:

No monetary consideration pursuant to Public Resources Code section 6503.5.

SPECIFIC LEASE PROVISIONS:

Insurance:

Liability Insurance: Combined single limit coverage of \$300,000.

EXHIBITS:

- A. Site Map
- B. Location Map

PERMIT STREAMLINING ACT DEADLINE:

N/A

RECOMMENDED ACTION:

IT IS RECOMMENDED THAT THE COMMISSION:

CALENDAR ITEM NO. C07 (CONT'D)

CEQA FINDING:

FIND THAT THE ACTIVITY IS EXEMPT FROM THE REQUIREMENTS OF THE CEQA PURSUANT TO TITLE 14, CALIFORNIA CODE OF REGULATIONS, SECTION 15061, AS A CATEGORICALLY EXEMPT PROJECT, CLASS 1, EXISTING FACILITIES; TITLE 2, CALIFORNIA CODE OF REGULATIONS, SECTION 2905(a)(2).

SIGNIFICANT LANDS INVENTORY FINDING:

FIND THAT THIS ACTIVITY IS CONSISTENT WITH THE USE CLASSIFICATION DESIGNATED BY THE COMMISSION FOR THE LAND PURSUANT TO PUBLIC RESOURCES CODE SECTIONS 6370, ET SEQ.

AUTHORIZATION:

AUTHORIZE ISSUANCE TO JEFF MARTIN, ET AL., OF A TEN-YEAR RECREATIONAL PIER LEASE, BEGINNING MARCH 1, 1997; NO MONETARY CONSIDERATION PURSUANT TO PUBLIC RESOURCES CODE SECTION 6503.5; PROVISION OF LIABILITY INSURANCE FOR COMBINED SINGLE LIMIT COVERAGE OF \$300,000; FOR A 30 FT. X 60 FT. FLOATING BOATHOUSE WITH DOCK AND WALKWAY, ON THE LAND DESCRIBED ON EXHIBIT "A" ATTACHED AND BY REFERENCE MADE A PART HEREOF.

PARCEL 30
 WALTER LANGHART
 RT. 1 BOX 10
 ISLETON, CALIF.

PARCEL 58
 RECL. DIST. 317

PARCEL 54
 MARY NOERGA
 PO. BOX 23
 RIO VISTA, CALIF.

CENTERLINE OF LEVEE
 EDGE OF LEVEE

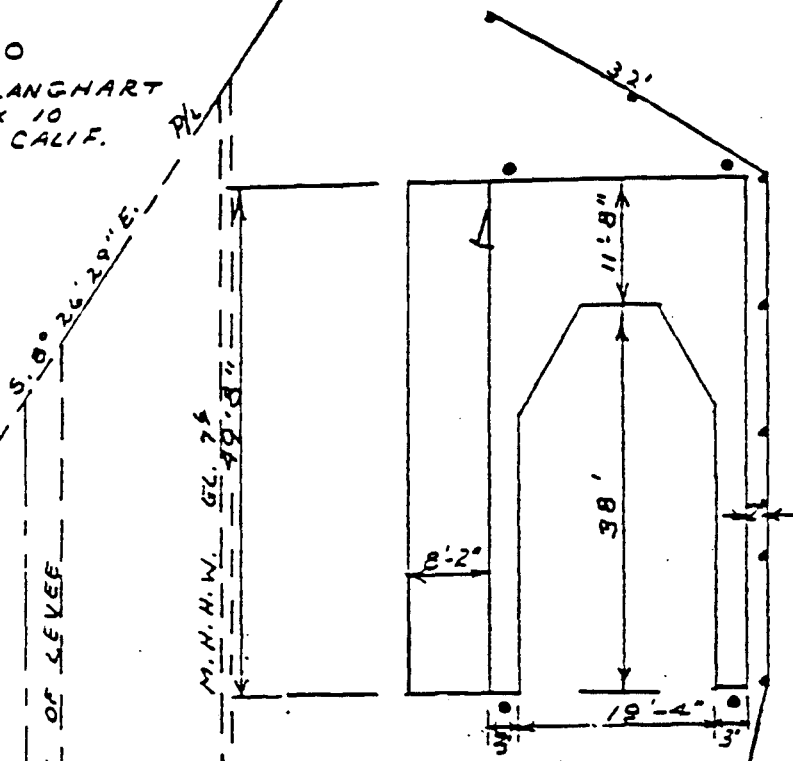

DETAIL
 1" = 20'-0"

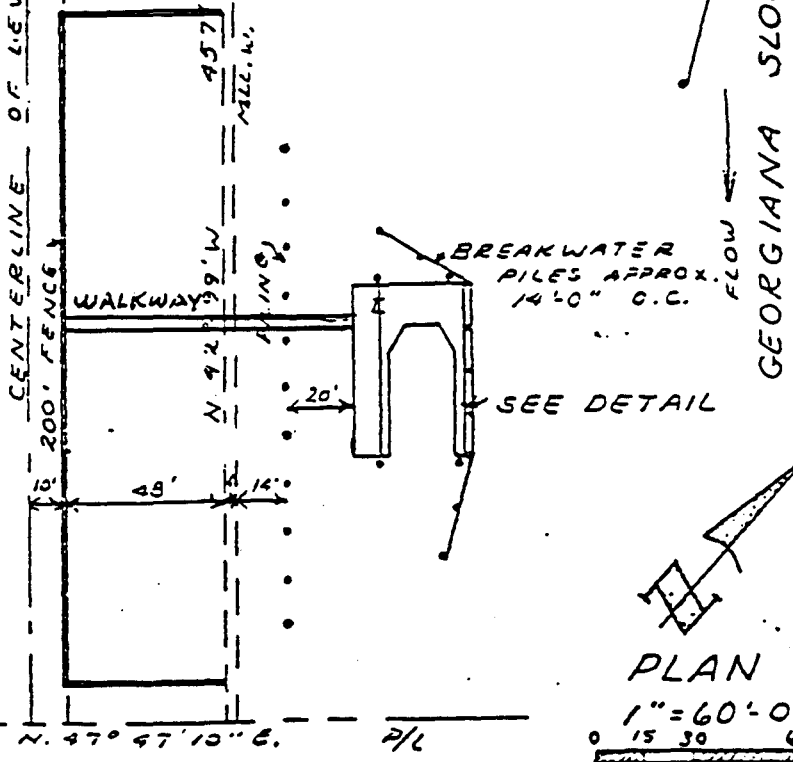

PLAN
 1" = 60'-0"

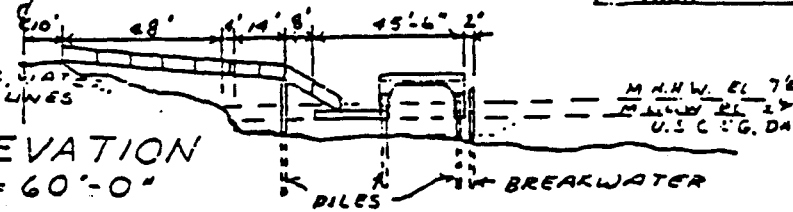

SIDE ELEVATION
 1" = 60'-0"

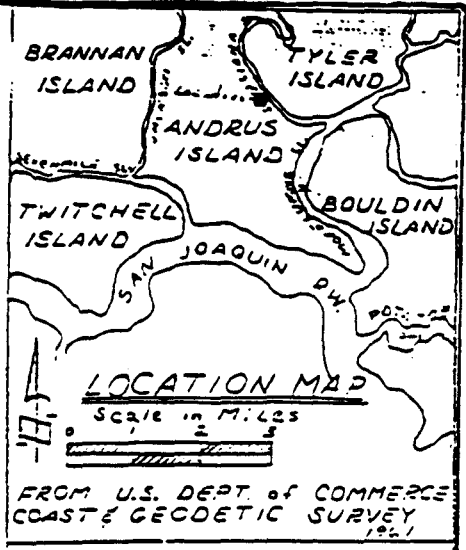

SOUNDINGS ARE IN FEET AND REFER TO M.L.L.W. ELEV. 24 U.S.C. 25 DATUM. NO HARBOR LINES ESTABLISHED FROM U.S.C. 26 SURVEY CHART 5527 - 1961

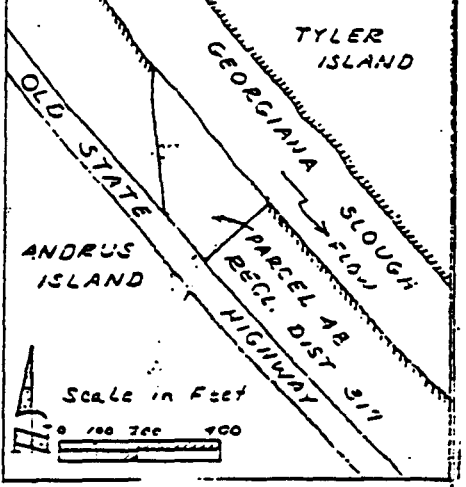

This Land description is solely for purposes of generally defining the lease premises, and is not intended to be, nor shall it be construed as, a waiver or limitation of any State interest in the subject or any other property.

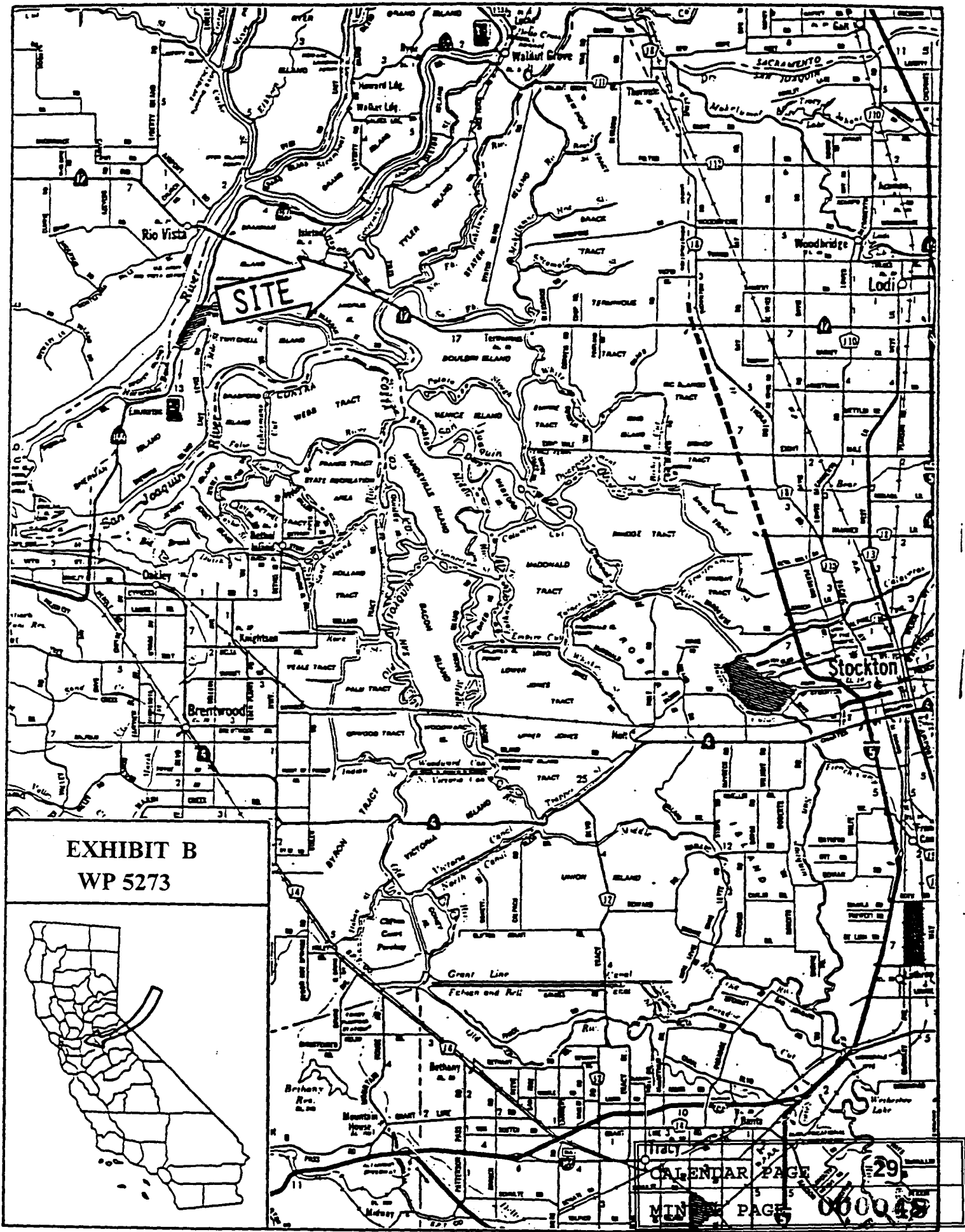

EXHIBIT B
WP 5273



CALENDAR PAGE 29
MINUTE PAGE 060048