

CALENDAR ITEM  
C06

MINUTE ITEM  
This Calendar Item No. C06  
was approved as Minute Item  
No. 06 by the State Lands  
Commission by a vote of 3  
to 0 at its 02/12/97  
meeting.

A 8

S 4

02/12/97  
PRC5280 WP 5280.9  
L. Burks

RECREATIONAL PIER LEASE

LESSEE:

Henry and Patricia Sosso  
14323 River Road  
Walnut Grove, California 95690

AREA, LAND TYPE, AND LOCATION:

0.05 acres, more or less, of tide and submerged lands in Georgiana Slough near  
Walnut Grove (APN 146-0180-012), Sacramento County.

AUTHORIZED USE:

Two floating docks with interconnecting walkway.

LEASE TERM:

Ten years, beginning April 1, 1997, as shown on attached Exhibit "A".

CONSIDERATION:

No monetary consideration pursuant to Public Resources Code section 6503.5.

SPECIFIC LEASE PROVISIONS:

Insurance:

Liability insurance: Combined single limit coverage of \$300,000.

EXHIBITS:

- A. Site Map
- B. Location Map

PERMIT STREAMLINING ACT DEADLINE:

N/A

CALENDAR ITEM NO. C06 (CONT'D)

**RECOMMENDED ACTION:**

IT IS RECOMMENDED THAT THE COMMISSION:

**CEQA FINDING:**

FIND THAT THE ACTIVITY IS EXEMPT FROM THE REQUIREMENTS OF THE CEQA PURSUANT TO TITLE 14, CALIFORNIA CODE OF REGULATIONS, SECTION 15061 AS A CATEGORICALLY EXEMPT PROJECT, CLASS 1, EXISTING FACILITIES, TITLE 2, CALIFORNIA CODE OF REGULATIONS, SECTION 2905(a)(2).

**SIGNIFICANT LANDS INVENTORY FINDING:**

FIND THAT THIS ACTIVITY IS CONSISTENT WITH THE USE CLASSIFICATION DESIGNATED FOR THE LAND PURSUANT TO PUBLIC RESOURCES CODE SECTIONS 6370, ET SEQ.

**AUTHORIZATION:**

AUTHORIZE ISSUANCE TO HENRY AND PATRICIA SOSSO OF A 10-YEAR RECREATIONAL PIER LEASE, BEGINNING APRIL 1, 1997; NO MONETARY CONSIDERATION PURSUANT TO PUBLIC RESOURCES CODE SECTION 6503.5; PROVISION OF LIABILITY INSURANCE FOR COMBINED SINGLE LIMIT COVERAGE OF \$300,000; FOR TWO 8 FT. X 20 FT. FLOATING DOCKS WITH 12 FT. INTERCONNECTING WALKWAY ON THE LAND DESCRIBED ON EXHIBIT "A" ATTACHED AND BY REFERENCE MADE A PART HEREOF.

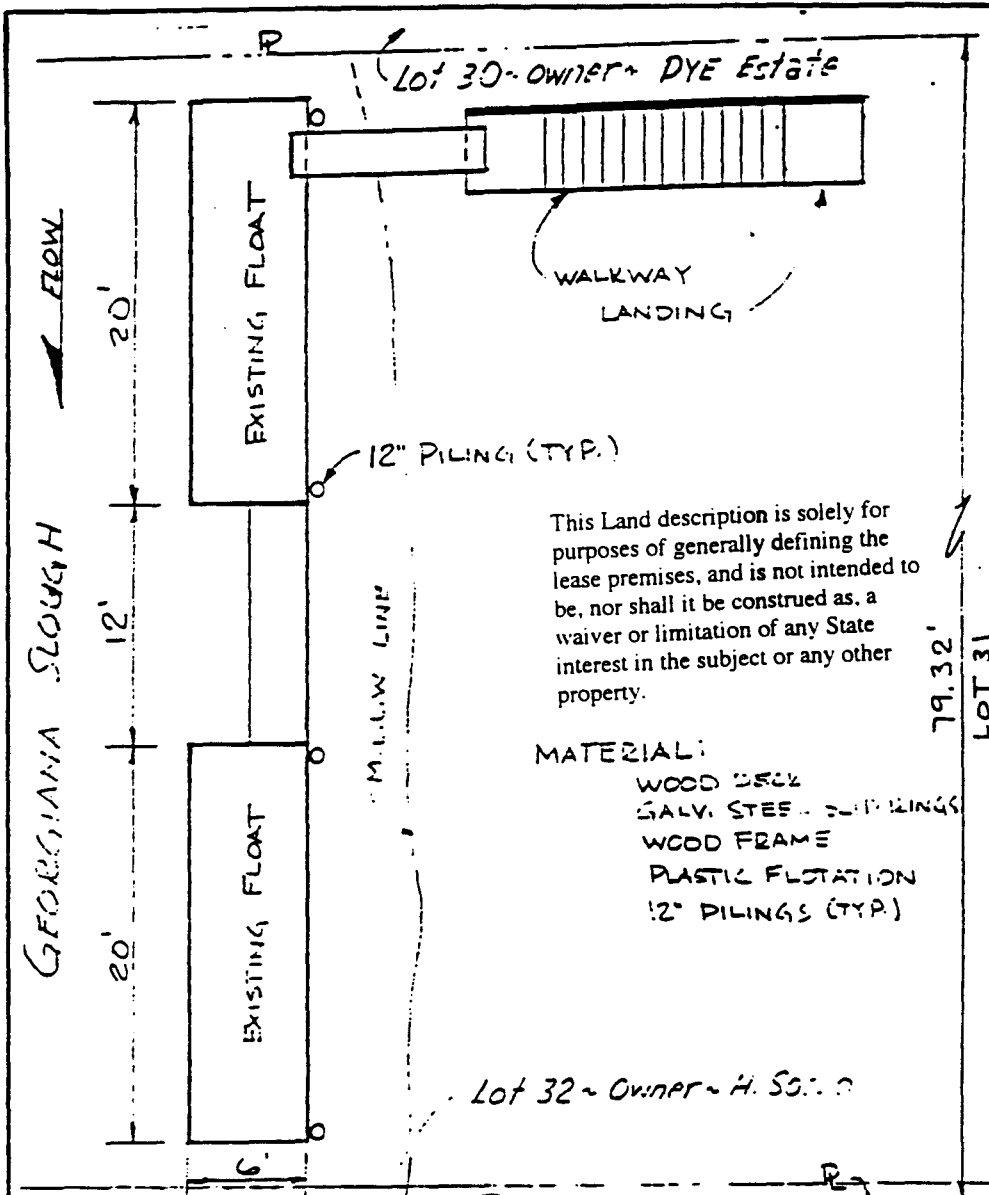

This Land description is solely for purposes of generally defining the lease premises, and is not intended to be, nor shall it be construed as, a waiver or limitation of any State interest in the subject or any other property.

- MATERIAL:**
- WOOD DECK
  - GALV. STEEL SLIPRINGS
  - WOOD FRAME
  - PLASTIC FLOTATION
  - 12" PILING (TYP.)

Lot 32 - Owner - H. S. ...

**PLAN VIEW**

1" = 10'  
35' MAXIMUM

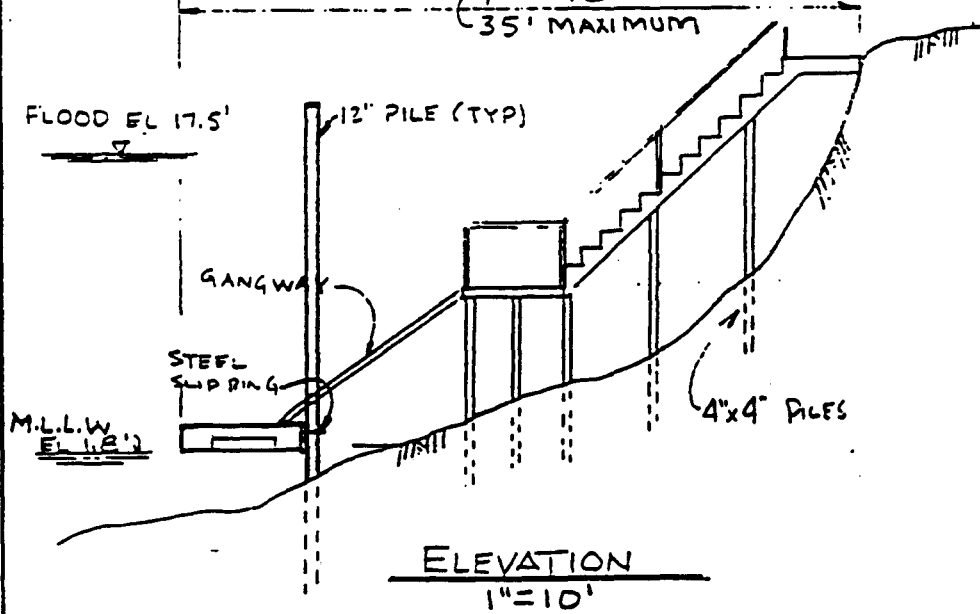

**ELEVATION**  
1" = 10'

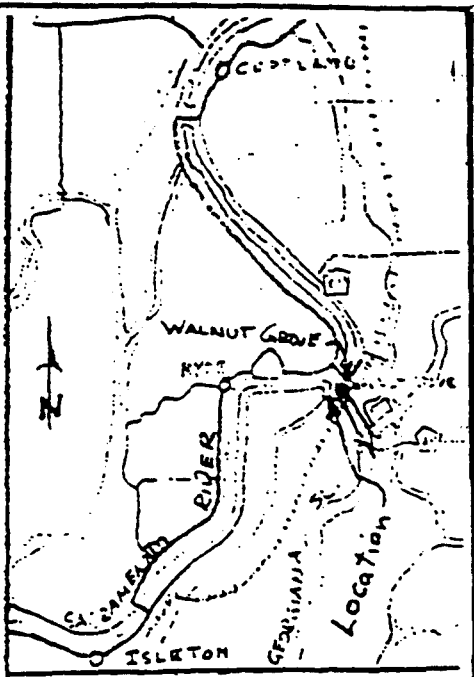

**VICINITY MAP**

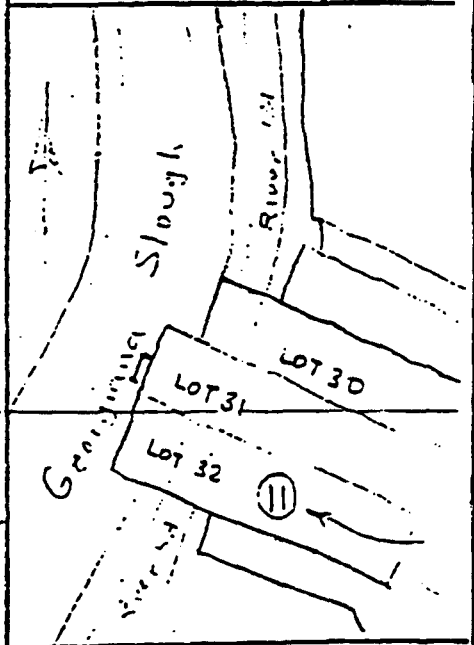
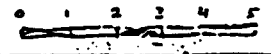

Existing Dock

**EXHIBIT A**

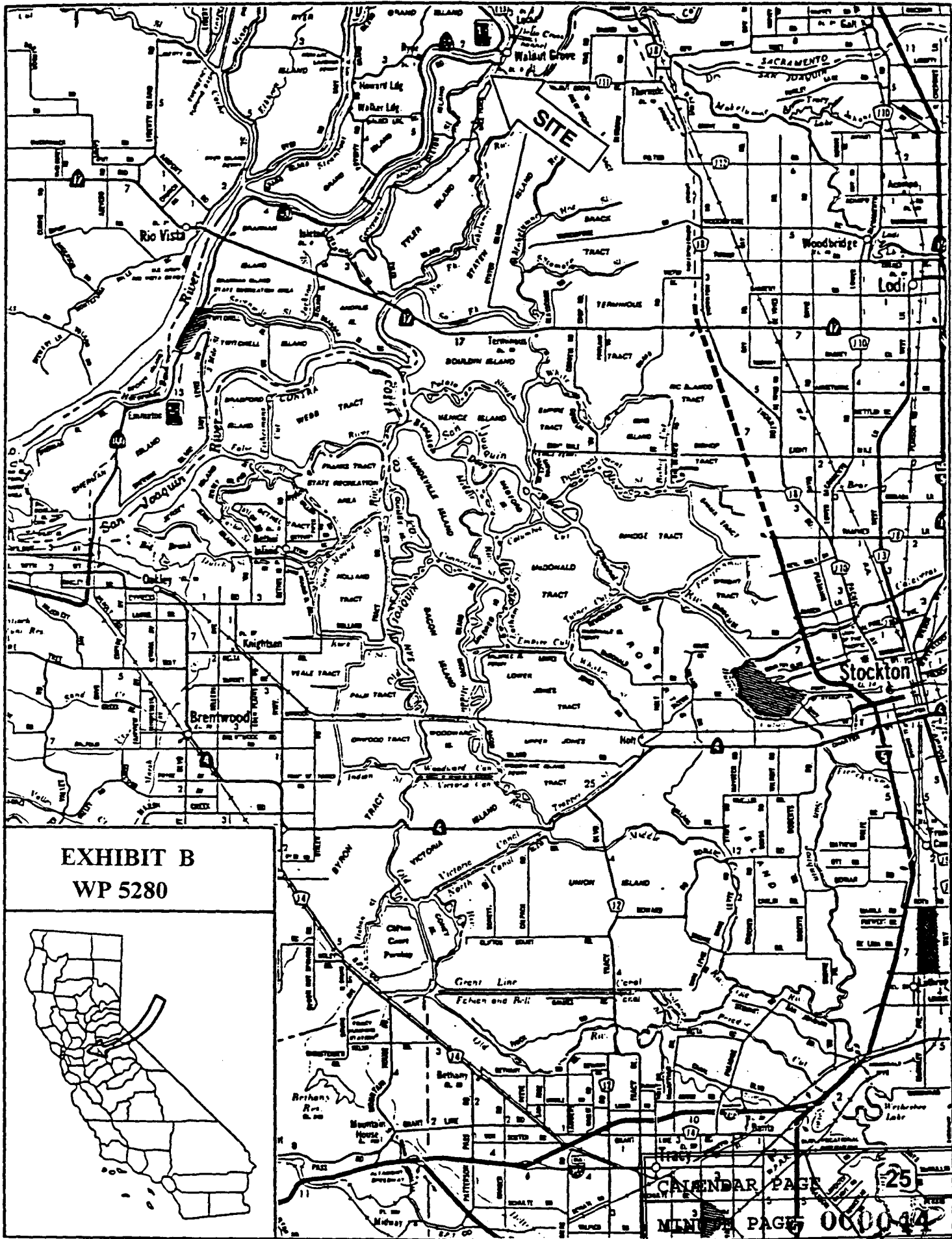

EXHIBIT B  
WP 5280



CALENDAR PAGE 25  
MINUTE PAGE 000044