

**MINUTE ITEM**

This Calendar Item No. C28  
was approved as Minute Item  
No. 28 by the State Land  
Commission by a vote of 3  
to 0 at its 10/28/96  
meeting.

**CALENDAR ITEM  
C28**

A 1  
S 2

10/28/96  
PRC 7919 W 25337  
J. Ludlow

**GENERAL LEASE-PUBLIC AGENCY USE AND  
APPROVAL OF RIGHT-OF-WAY MAP**

**APPLICANT:**

California Department of Transportation  
District 1  
P.O. Box 3700  
Eureka, California 95502-3700

**LOCATION:**

A 0.79-acre parcel, more or less, of sovereign land located in the bed of the Mad River near Arcata, Humboldt County.

**AUTHORIZED USE:**

Seismic retrofit and maintenance of the east and west Mad River bridges on Highway 299.

**TERM:**

An indefinite period beginning October 28, 1996.

**CONSIDERATION:**

The public use, benefit, health and safety; with the State reserving the right at any time to set a monetary rental if the Commission finds such action to be in the State's best interest.

**EXHIBIT:**

A. Site Map

**AB 884:**

Application incomplete.

**RECOMMENDED**

**ACTION:**

IT IS RECOMMENDED THAT THE COMMISSION:

**CALENDAR ITEM NO. C28 (CONT'D)**

**CEQA  
FINDING:**

FIND THAT THE ACTIVITY IS EXEMPT FROM THE REQUIREMENTS OF THE CEQA PURSUANT TO 14 CAL. CODE REGS. 15061 BECAUSE THERE IS NO POSSIBILITY THAT THE ACTIVITY MAY HAVE A SIGNIFICANT EFFECT ON THE ENVIRONMENT (14 CAL. CODE REGS: 15061 (b)(3)).

**SIGNIFICANT LANDS  
INVENTORY FINDING:**

FIND THAT THIS ACTIVITY IS CONSISTENT WITH THE USE CLASSIFICATION DESIGNATED FOR THE LAND PURSUANT TO PUBLIC RESOURCES CODE SECTIONS 6370, ET SEQ.

**AUTHORIZATION:**

1. APPROVE THE MAP FILED BY THE CALIFORNIA DEPARTMENT OF TRANSPORTATION PURSUANT TO SECTION 101.5 OF THE STREETS AND HIGHWAYS CODE, AS SHOWN ON EXHIBIT "A" ATTACHED AND BY REFERENCE MADE A PART HEREOF.
2. AUTHORIZE THE ISSUANCE OF A GENERAL LEASE - PUBLIC AGENCY USE TO THE CALIFORNIA DEPARTMENT OF TRANSPORTATION, DISTRICT 1, FOR AN INDEFINITE PERIOD BEGINNING OCTOBER 28, 1996, FOR HIGHWAY PURPOSES ON THE LAND DESCRIBED ON EXHIBIT "A" ATTACHED AND BY REFERENCE MADE A PART HEREOF.

# EXHIBIT "A" LAND DESCRIPTION

W 25337

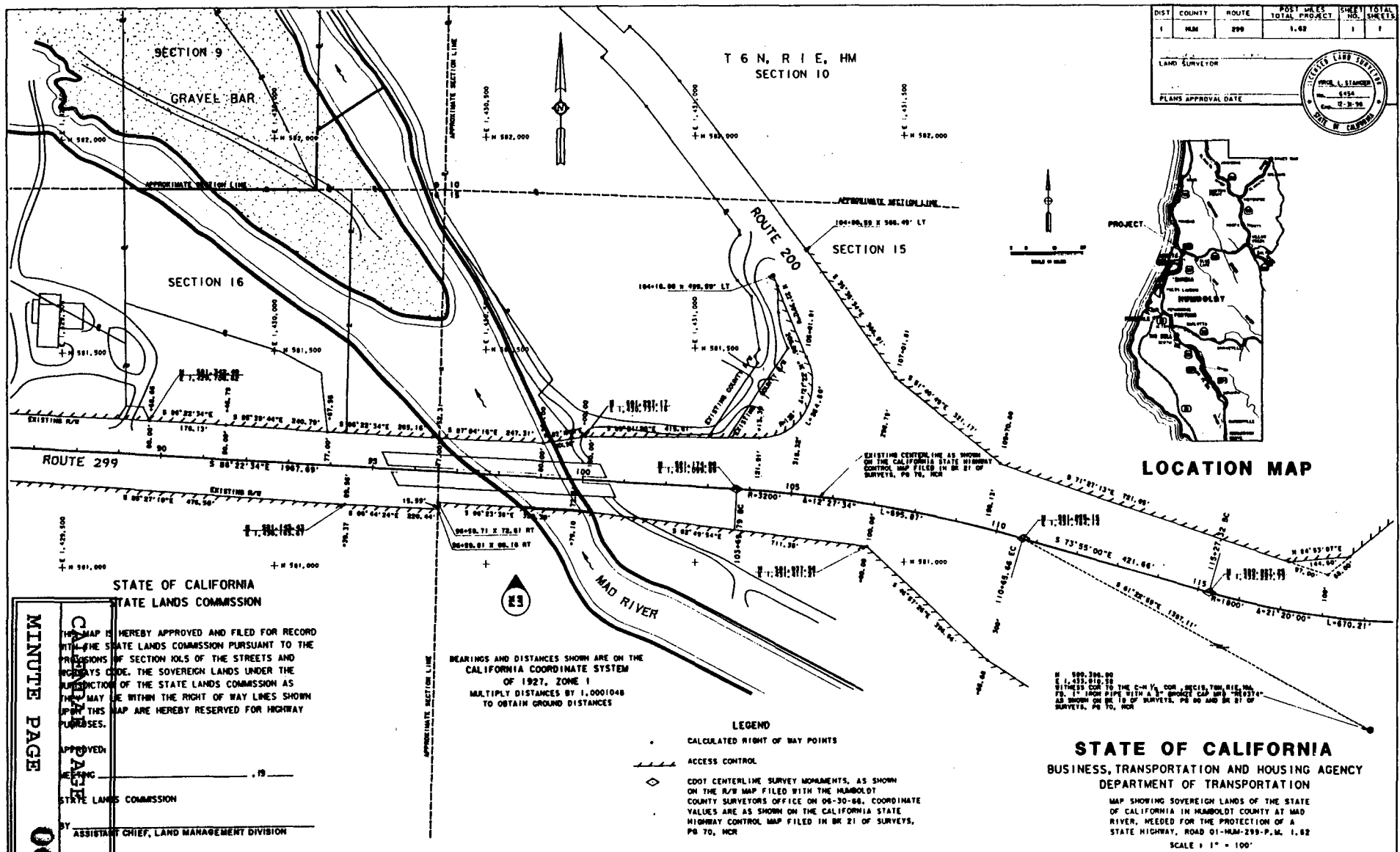

CG 9/96