

**MINUTE ITEM**

This Calendar Item No. ~~37~~ was approved as Minute Item No. ~~37~~ by the California State Lands Commission by a vote of 3 to 0 at its 08/21/96 meeting.

**CALENDAR ITEM  
C37**

A 4  
S 1

08/21/96  
PRC 6714.9  
J. Ludlow

**RECREATIONAL PIER LEASE**

**APPLICANT:**

T. Gary Rogers and Kathleen Tuck Rogers,  
Co-Trustees of the Rogers Revocable Trust  
6301 Bullard Drive  
Oakland, California 94618

**LOCATION:**

A parcel of submerged land located in the bed of Lake Tahoe near Sunnyside, Placer County.

**AUTHORIZED USE:**

Continued use and maintenance of an existing pier and two mooring buoys.

**TERM:**

Ten years effective September 27, 1995.

**CONSIDERATION:**

No monetary consideration pursuant to Public Resources Code Section 6503.5.

**EXHIBITS:**

A. Site Map

**AB 884:**

N/A

**OTHER PERTINENT INFORMATION:**

The lease is conditioned on lessee obtaining authorization from the Tahoe Regional Planning Agency for the existing buoys within two years of the effective date of the authorization of the buoys by the Commission.

**CALENDAR ITEM NO. C37 (Cont'd)**

**RECOMMENDED**

**ACTION:**

IT IS RECOMMENDED THAT THE COMMISSION:

**CEQA**

**FINDING:**

FIND THAT THE ACTIVITY IS EXEMPT FROM THE REQUIREMENTS OF THE CEQA PURSUANT TO 14 CAL. CODE REGS. 15061 AS A CATEGORICALLY EXEMPT PROJECT, CLASS 1, EXISTING FACILITIES, 2 CAL. CODE REGS. 2905(a)(2).

**SIGNIFICANT LANDS**

**INVENTORY FINDING:**

FIND THAT THIS ACTIVITY IS CONSISTENT WITH THE USE CLASSIFICATION DESIGNATED FOR THE LAND PURSUANT TO PUBLIC RESOURCES CODE SECTIONS 6370, ET SEQ.

**AUTHORIZATION:**

AUTHORIZE ISSUANCE TO T. GARY ROGERS AND KATHLEEN TUCK ROGERS, CO-TRUSTEES OF THE ROGERS REVOCABLE TRUST OF A TEN-YEAR RECREATIONAL PIER LEASE, BEGINNING SEPTEMBER 27, 1995, FOR ALL OF THE STATE'S SOVEREIGN LANDS BELOW THE ELEVATION OF 6223 FEET, LAKE TAHOE DATUM, UNDER APPLICANTS PIER AND TWO MOORING BUOYS AS DEPICTED ON EXHIBIT "A" ATTACHED AND BY REFERENCE MADE A PART HEREOF; NO MONETARY CONSIDERATION PURSUANT TO PUBLIC RESOURCES CODE SECTION 6503.5

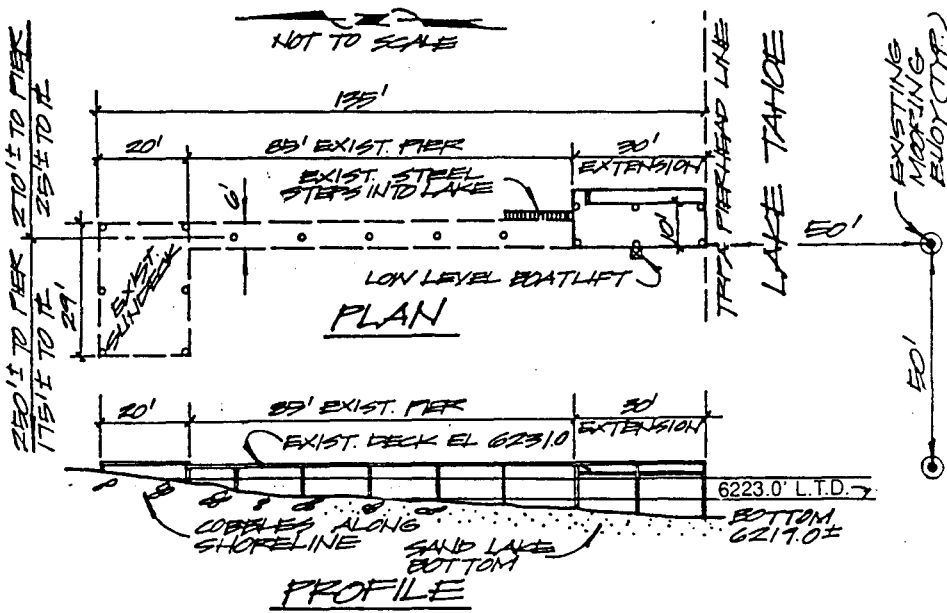
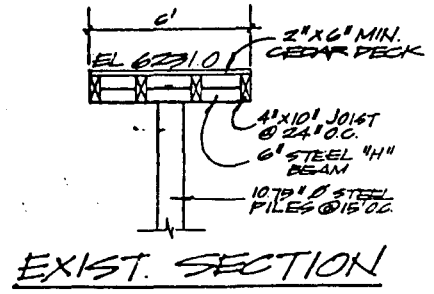
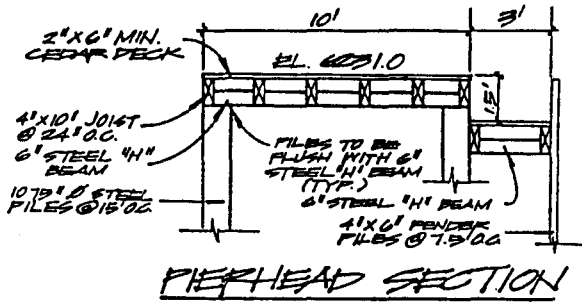

1390 West Lake Blvd.

NO SCALE

**LOCATION MAP**

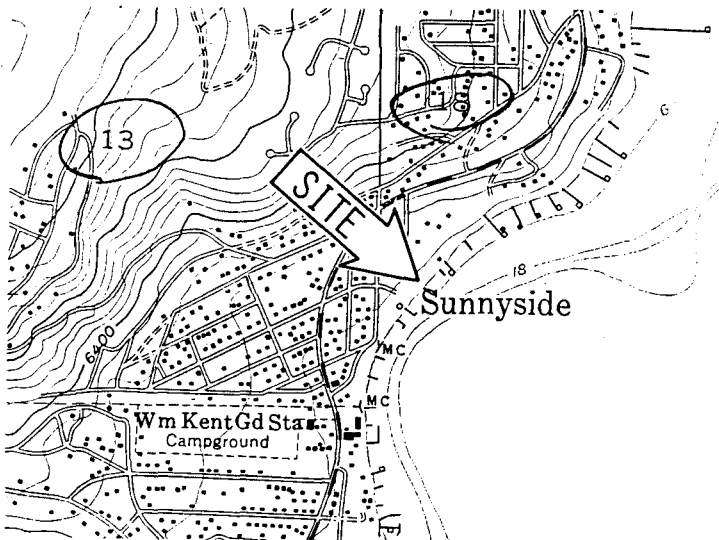

Lake Tahoe

NO SCALE

**EXHIBIT "A"**  
 PRC 6714  
 APN 83 - 162 - 36  
 Lake Tahoe  
 PLACER COUNTY

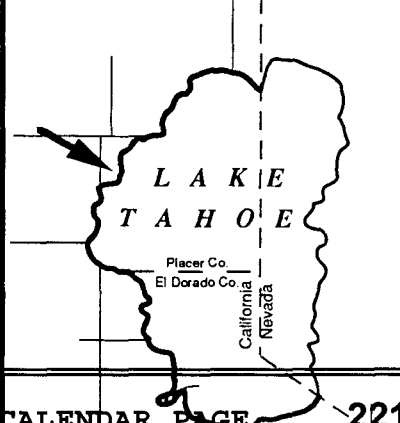

This Exhibit is solely for purposes of generally defining the lease premises, and is not intended to be, nor shall it be construed as, a waiver or limitation of any State interest in the subject or any other property.