

**MINUTE ITEM**

This Calendar Item No. ~~C34~~ 34 was approved as Minute Item No. 34 by the California State Lands Commission by a vote of 3 to 0 at its 08/21/96 meeting.

**CALENDAR ITEM  
C34**

A 4  
S 1

08/21/96  
PRC 4360.9  
J. Ludlow

**RECREATIONAL PIER LEASE**

**APPLICANT:**

Mary K. Osborn  
3604 La Costa Street  
Bakersfield, California 93306

**LOCATION:**

Submerged land in Lake Tahoe at Agate Bay, Placer County.

**AUTHORIZED USE:**

Continued use and maintenance of an existing pier, boathoist and two buoys.

**TERM:**

Ten years beginning June 1, 1996.

**CONSIDERATION:**

No monetary consideration pursuant to Public Resources Code Section 6503.5.

**EXHIBITS:**

A. Site Map

**AB 884:**

N/A

**OTHER PERTINENT INFORMATION:**

The lease is conditioned on Lessee obtaining authorization from the Tahoe Regional Planning Agency for the existing buoys within two years from the effective date of the authorization of the buoys by the Commission.

CALENDAR PAGE	210
MINUTE PAGE	001556

**CALENDAR ITEM C34 (CONT'D)**

**RECOMMENDED**

**ACTION:**

IT IS RECOMMENDED THAT THE COMMISSION:

**CEQA**

**FINDING:**

FIND THAT THE ACTIVITY IS EXEMPT FROM THE REQUIREMENTS OF THE CEQA PURSUANT TO 14 CAL. CODE REGS. 15061 AS A CATEGORICALLY EXEMPT PROJECT, CLASS 1, EXISTING FACILITIES, 2 CAL. CODE REGS. 2905(a)(2).

**SIGNIFICANT LANDS**

**INVENTORY FINDING:**

FIND THAT THIS ACTIVITY IS CONSISTENT WITH THE USE CLASSIFICATION DESIGNATED FOR THE LAND PURSUANT TO PUBLIC RESOURCES CODE SECTIONS 6370, ET SEQ.

**AUTHORIZATION:**

AUTHORIZE ISSUANCE TO MARY K. OSBORN OF A TEN-YEAR RECREATIONAL PIER LEASE, BEGINNING JUNE 1, 1996, FOR ALL OF THE STATE'S SOVEREIGN LANDS BELOW THE ELEVATION OF 6223 FEET, LAKE TAHOE DATUM, UNDER APPLICANT'S PIER, BOATHOIST AND TWO MOORING BUOYS AS DEPICTED ON EXHIBIT "A" ATTACHED AND BY REFERENCE MADE A PART HEREOF; NO MONETARY CONSIDERATION PURSUANT TO PUBLIC RESOURCES CODE SECTION 6503.5.

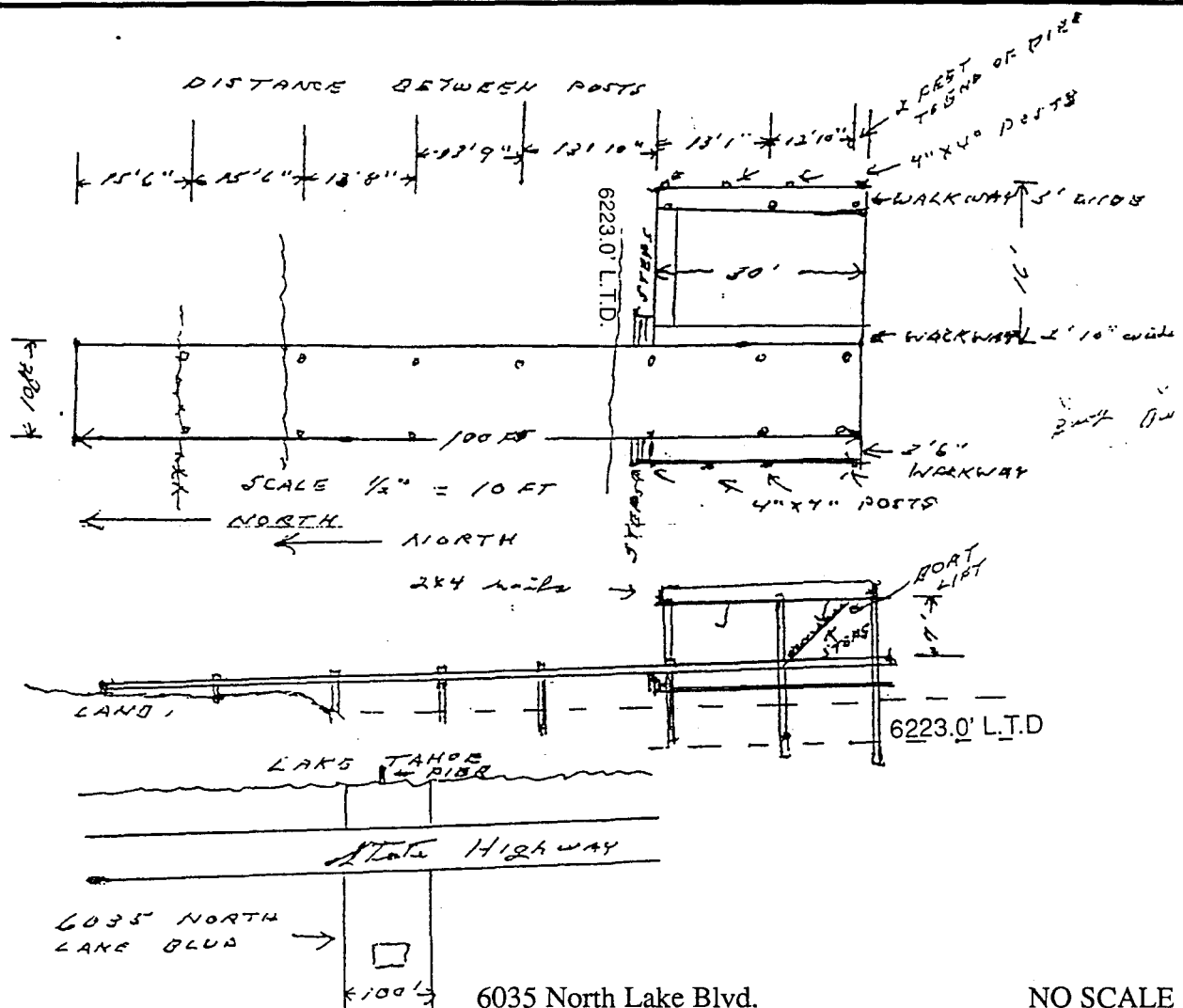

NO SCALE

**LOCATION MAP**

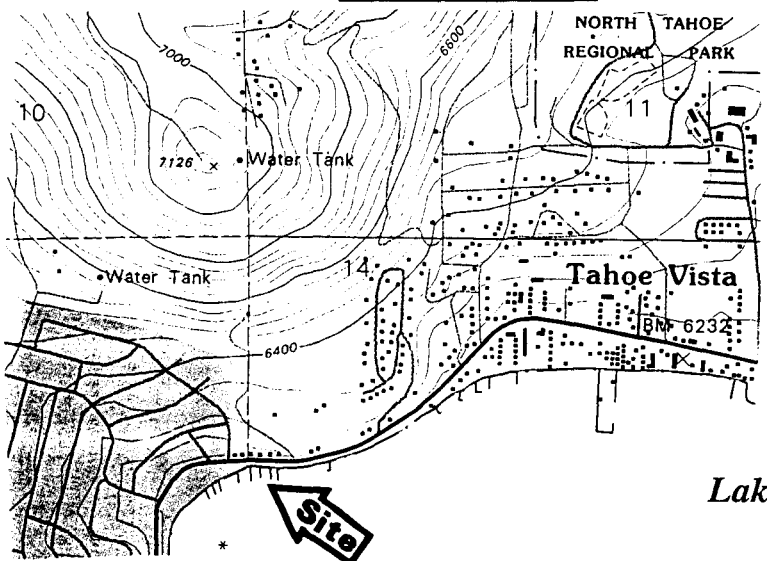

Lake Tahoe

NO SCALE

**EXHIBIT "A"**  
 PRC 4360.9  
 APN 117 - 020 - 04  
 Lake Tahoe  
 PLACER COUNTY

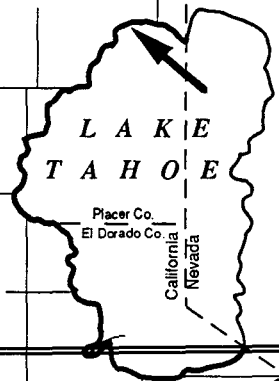

This Exhibit is solely for purposes of generally defining the lease premises, and is not intended to be, nor shall it be construed as, a waiver or limitation of any State interest in the subject or any other property.