

MINUTE ITEM

This Calendar Item No. C29 was approved as Minute Item No. 29 by the California State Lands Commission by a vote of 3 to 0 at its 08/21/96 meeting.

**CALENDAR ITEM
C29**

A 1
S 2

PRC 7896

08/21/96
W 24683
J. Ludlow

**GENERAL LEASE - PUBLIC AGENCY USE AND
APPROVAL OF RIGHT-OF-WAY MAP**

APPLICANT:

California Department of Transportation
District 1
P.O. Box 3700
Eureka, California 95502-3700

LOCATION:

A 1.31- acre parcel, more or less, of sovereign land located in the bed of the Smith River near Crescent City, Del Norte County

AUTHORIZED USE:

An existing bridge crossing and seismic retrofitting of the Dr. Fine Bridge on Highway 101.

TERM:

An indefinite period beginning on the date of Commission approval.

EXHIBITS:

A. Site Map

AB 884:

December 28, 1996

RECOMMENDED

ACTION:

IT IS RECOMMENDED THAT THE COMMISSION:

CALENDAR ITEM NO. C29 (Cont'd)

CEQA

FINDING:

FIND THAT THE ACTIVITY IS EXEMPT FROM THE REQUIREMENTS OF THE CEQA PURSUANT TO 14 CAL. CODE REGS. 15061 BECAUSE THERE IS NO POSSIBILITY THAT THE ACTIVITY MAY HAVE A SIGNIFICANT EFFECT ON THE ENVIRONMENT (14 CAL. CODE REGS. 15061 (b)(3)).

SIGNIFICANT LANDS

INVENTORY FINDING:

FIND THAT THIS ACTIVITY IS CONSISTENT WITH THE USE CLASSIFICATION DESIGNATED FOR THE LAND PURSUANT TO PUBLIC RESOURCES CODE SECTIONS 6370, ET SEQ.

AUTHORIZATION:

1. APPROVE THE MAP FILED BY THE CALIFORNIA DEPARTMENT OF TRANSPORTATION PURSUANT TO SECTION 101.5 OF THE STREETS AND HIGHWAYS CODE, AS SHOWN ON EXHIBIT "A" ATTACHED AND BY REFERENCE MADE A PART HEREOF.
2. AUTHORIZE THE ISSUANCE OF A PUBLIC AGENCY LEASE TO THE CALIFORNIA DEPARTMENT OF TRANSPORTATION, DISTRICT 1, FOR AN INDEFINITE PERIOD FROM THE DATE THE LEASE IS APPROVED BY THE STATE LANDS COMMISSION FOR HIGHWAY PURPOSES ON THE LAND DESCRIBED ON EXHIBIT "A" ATTACHED AND BY REFERENCE MADE A PART HEREOF.

EXHIBIT "A"
LAND DESCRIPTION

W 24683

DIST	COUNTY	ROUTE	POST MILES TOTAL PROJECT	SHEET NO.	TOTAL SHEETS
01	DN	101	36.12/36.23	1	1

James R. Adams
 LAND SURVEYOR
 No. 2756
 Exp. 06-30-45
 PLANS APPROVAL DATE _____
 REGISTERED LAND SURVEYOR
 James R. Adams
 No. 2756
 Exp. 06-30-45
 STATE OF CALIFORNIA

BASIS OF BEARING

IDENTICAL WITH VOL. 58 OF DEEDS,
PAGE 394 & 395, DEL NORTE CO.
RECORDS, DATED OCTOBER 7, 1940.
DISTANCES ARE GROUND DISTANCES.
THIS PROJECT IS NOT ON THE
CALIFORNIA COORDINATE SYSTEM.

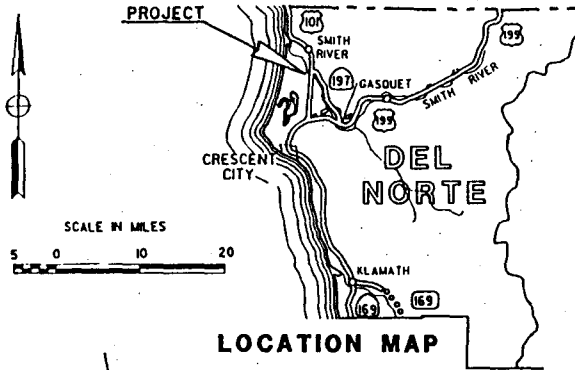

T.17 N., R.1 W., H.M.

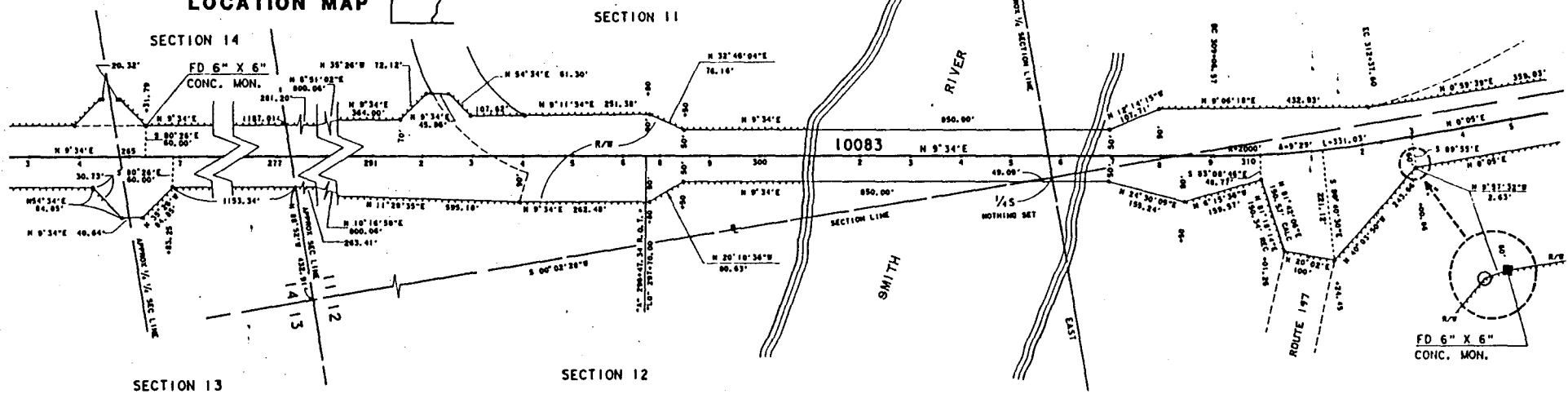

**STATE OF CALIFORNIA
STATE LANDS COMMISSION**

THIS MAP IS HEREBY APPROVED AND FILED FOR RECORD WITH THE STATE LANDS COMMISSION PURSUANT TO THE PROVISIONS OF SECTION 101.5 OF THE STREETS AND HIGHWAYS CODE. THE SOVEREIGN LANDS UNDER THE JURISDICTION OF THE STATE LANDS COMMISSION AS THEY MAY LIE WITHIN THE RIGHT OF WAY LINES SHOWN UPON THIS MAP ARE HEREBY RESERVED FOR HIGHWAY PURPOSES.

APPROVED: MEETING _____ 19____
STATE LANDS COMMISSION

BY _____
CHIEF, DIVISION OF LAND MANAGEMENT

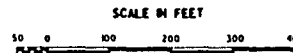

LEGEND

- CALCULATED RIGHT OF WAY POINTS
- ▬ ACCESS CONTROL

**STATE OF CALIFORNIA
BUSINESS, TRANSPORTATION AND HOUSING AGENCY
DEPARTMENT OF TRANSPORTATION**

MAP SHOWING SOVEREIGN LANDS OF THE STATE OF CALIFORNIA IN DEL NORTE COUNTY ALONG THE SMITH RIVER, NEEDED FOR THE PROTECTION OF A STATE HIGHWAY, ROAD 01-DN-101-P.M. 36.12/36.23 FAP 1.

SCALE: 1" = 100'

MINUTE PAGE
CALENDAR PAGE
001528

182

11 Y:\CNS\PROJECTS\A0011\0011\mmap\239542.mxd, 09/10/04 10:04:16 AM

CG 7/96