

CALENDAR ITEM NO. C05 (CONT'D)

**SIGNIFICANT LANDS
INVENTORY FINDING:**

FIND THAT THIS ACTIVITY IS CONSISTENT WITH THE USE CLASSIFICATION DESIGNATED FOR THE LAND PURSUANT TO PUBLIC RESOURCES CODE SECTIONS 6370, ET SEQ.

AUTHORIZATION:

AUTHORIZE ISSUANCE TO DAVID S. LAKE TRUST OF A TEN-YEAR GENERAL LEASE - PROTECTIVE STRUCTURE AND RECREATIONAL USE, BEGINNING JUNE 21, 1993.

CONSIDERATION:

FOR THE CONTINUED USE AND MAINTENANCE OF AN EXISTING 6 FT. X 32 FT. FLOATING DOCK, 4-FOOT WIDE GANGWAY AND BANK PROTECTION; ON THE LAND DESCRIBED ON EXHIBIT "A" ATTACHED AND BY REFERENCE MADE A PART HEREOF. BANK PROTECTION - PUBLIC USE AND BENEFIT, WITH THE STATE RESERVING THE RIGHT AT ANY TIME TO SET A MONETARY RENT IF THE COMMISSION FINDS SUCH ACTION TO BE IN THE STATE'S BEST INTEREST; RECREATIONAL PIER - NO MONETARY CONSIDERATION PURSUANT TO PUBLIC RESOURCES CODE SECTION 6503.5.

CALENDAR PAGE	74
MINUTE PAGE	001415

Area to be leased lies directly beneath docks, bank protection and walkway, plus a necessary use area 10 feet in width in front of proposed dock. EXCEPTING THEREFROM any portion lying above the ordinary high water mark.

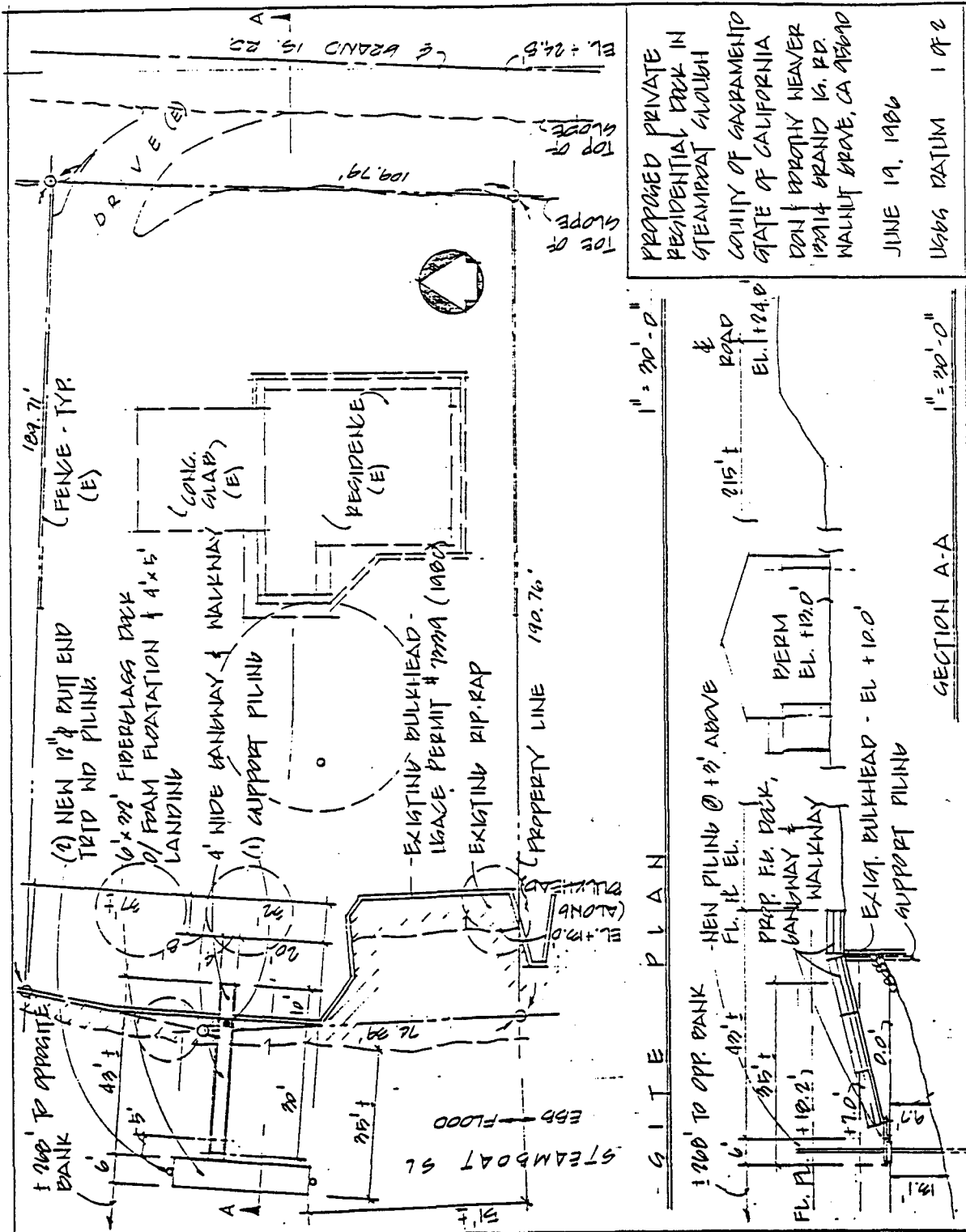

PROPOSED PRIVATE
RESIDENTIAL DOCK IN
STEAMBOAT GULCH
COUNTY OF SACRAMENTO
STATE OF CALIFORNIA
DON BROTHY NEAVER
13314 GRAND W. RD.
WALNUT GROVE, CA 95690
JUNE 19, 1986
US66 DATUM 1 OF 2

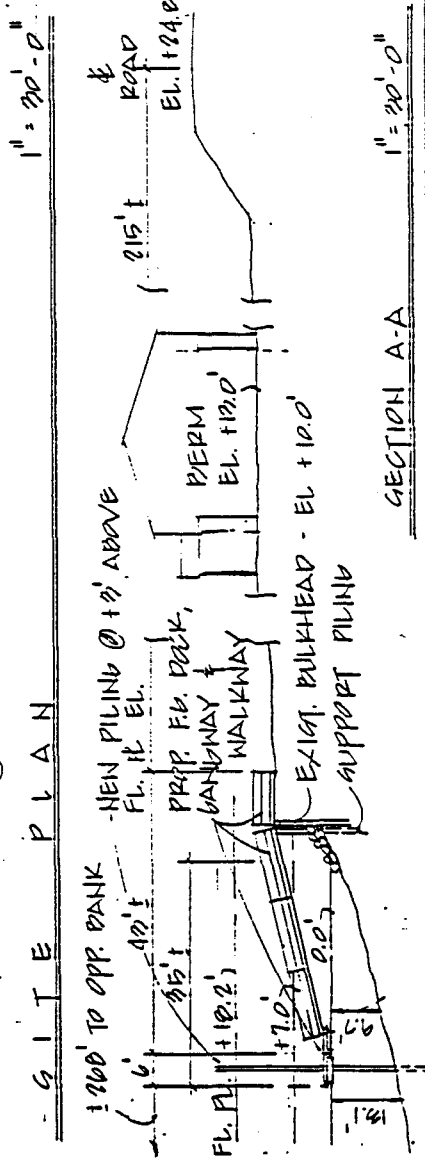

This exhibit is solely for purposes of generally defining the lease premises, and is not intended to be, nor shall it be construed as, a waiver or limitation of any State interest in the subject or other property.

CALIFORNIA EXHIBIT "A" '75
MINUTE MAP 7023 001416

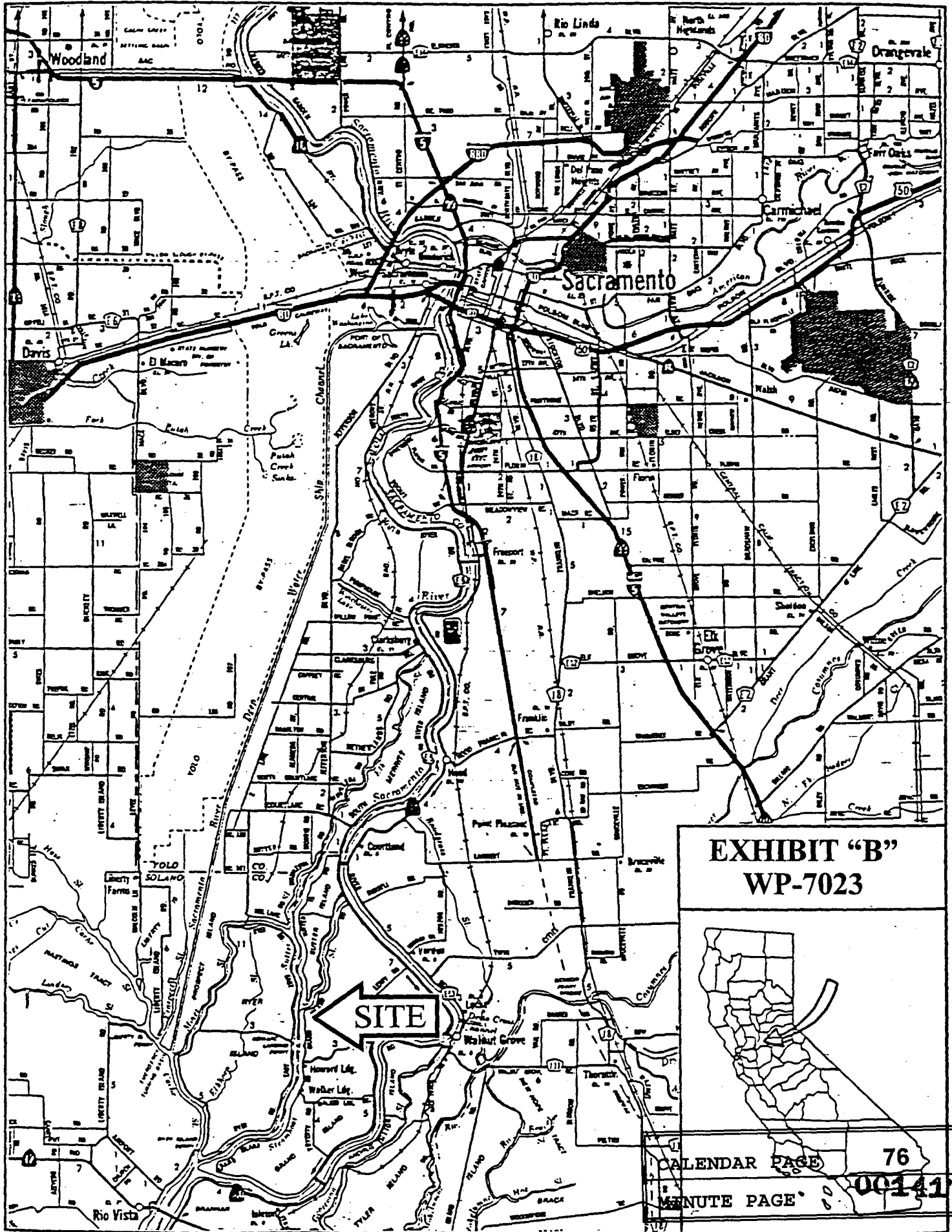

EXHIBIT "B"
WP-7023



SITE

CALENDAR PAGE 76
 MINUTE PAGE 001417