

MINUTE ITEM

This Calendar Item No. C33 was approved as Minute Item No. 33 by the California State Lands Commission by a vote of 2 to 0 at its 5-9-96 meeting.

CALENDAR ITEM

C33

A 7

05/09/96

PRC6687 WP 6687.1

S 2

J. Lam

**ASSIGNMENT OF
GENERAL LEASE - RECREATIONAL AND RESIDENTIAL USE**

ASSIGNOR:

Edward M. Esola
2490 31st Avenue
San Francisco, California 94116

ASSIGNEE:

Barry Kiser and Darrell Kiser
532 Bokman Place
Sonoma, California 95476

LOCATION:

A 0.016-acre parcel, more or less, of tide and submerged land in Sonoma Creek at Wingo, Sonoma County.

EXHIBITS:

A. Land Description

B. Location Map

AB 884:

N/A

RECOMMENDED ACTION:

IT IS RECOMMENDED THAT THE COMMISSION:

CEQA FINDING:

FIND THAT THE ACTIVITY IS EXEMPT FROM THE REQUIREMENTS OF THE CEQA PURSUANT TO 14 CAL. CODE REGS. 15061 BECAUSE THE ACTIVITY IS NOT A PROJECT AS DEFINED BY PUBLIC RESOURCES CODE SECTION 21065 AND 14 CAL. CODE REGS. 15378.

CALENDAR PAGE	267
MINUTE PAGE	000980

CALENDAR ITEM NO. **C33** (CONT'D)

AUTHORIZATION:

AUTHORIZE ASSIGNMENT OF GENERAL LEASE - RECREATIONAL AND RESIDENTIAL USE LEASE NO. PRC 6687, FROM EDWARD M. ESOLA TO BARRY KISER AND DARRELL KISER, EFFECTIVE JANUARY 25, 1996; ALL OTHER TERMS AND CONDITIONS OF THE LEASE SHALL REMAIN IN FULL FORCE AND EFFECT.

EXHIBIT "A"

LAND DESCRIPTION

WP 6687

SITE-2

State-owned tide and submerged lands beneath the existing summer cabin, existing walkways and other appurtenant recreation facilities located in the area locally known as Wingo, Sonoma County, according to lease application on file; said cabin listed by Sonoma County Assessor as Residence No. 2, an unsecured interest located within Sonoma County Assessor Parcel No. 128-491-49 as shown at Pg. 49 of Book No. 128 of Sonoma County Assessor Maps; said cabin being also designated as Site 2 on a revised copy of a portion of sheet No. 21 of 71 of United States Corps of Engineers Map No. 53-33-7 (San Francisco District), said portion of map being attached hereto and included herein as Exhibit "B".

END OF DESCRIPTION

REVISED JUNE 24, 1983 BY BOUNDARY AND TITLE UNIT, LEROY WEED, SUPERVISOR.

CALENDAR PAGE	269
MINUTE PAGE	000982

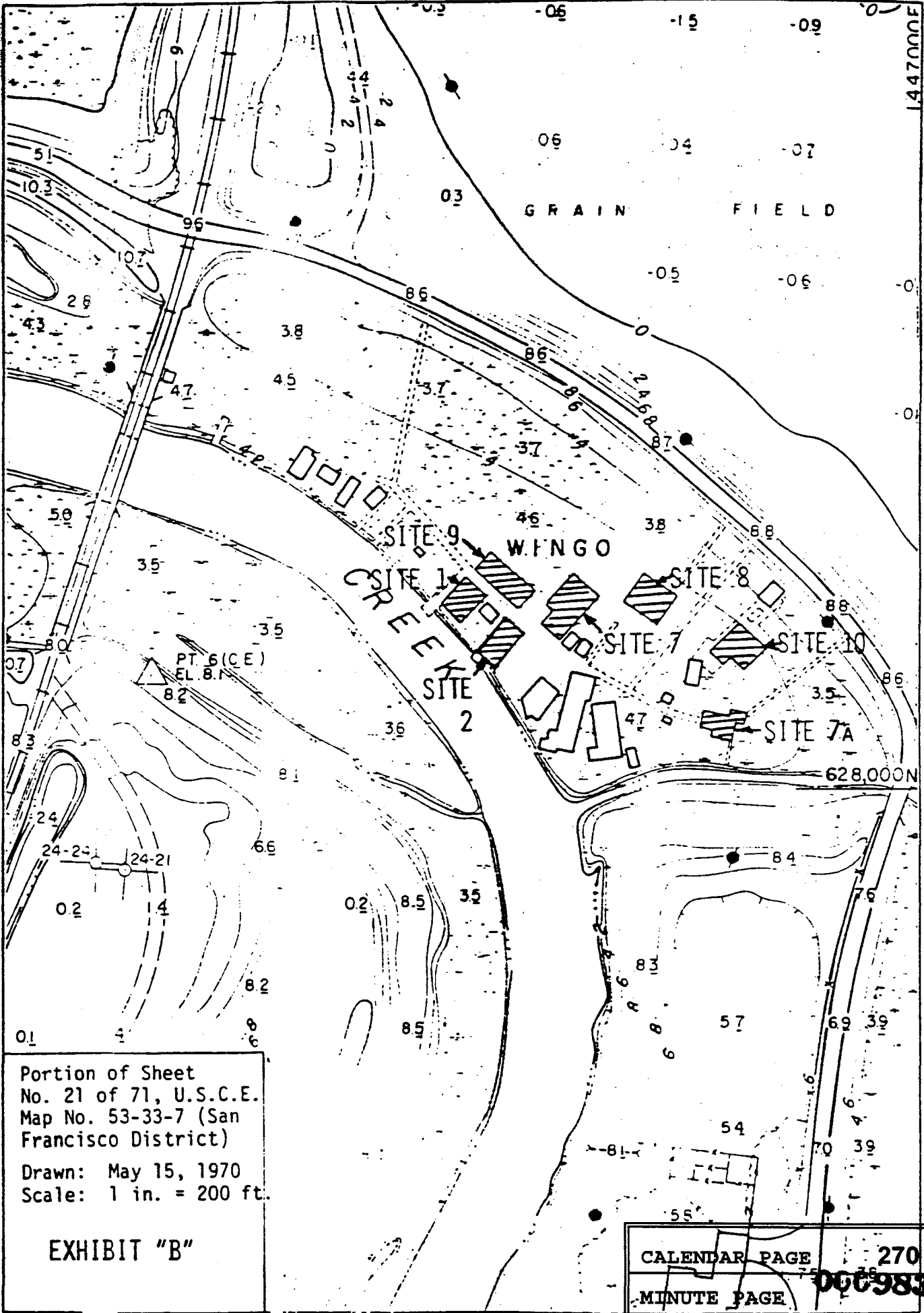

1447000F



Portion of Sheet
 No. 21 of 71, U.S.C.E.
 Map No. 53-33-7 (San
 Francisco District)
 Drawn: May 15, 1970
 Scale: 1 in. = 200 ft.

EXHIBIT "B"

CALENDAR PAGE	270
MINUTE PAGE	000983