

MINUTE ITEM  
This Calendar Item No. C62  
was approved as Minute Item  
No. 62 by the State Lands  
Commission by a vote of 2  
to 0 at its 2/27/96  
meeting.

CALENDAR ITEM  
**C62**

A 4  
S 1

02/27/96  
WP 3368.1  
B. Young  
PRC 3368.1

**GENERAL LEASE - RECREATIONAL USE**

**APPLICANT:**

Gary R. And Lindy L. Sitzman  
One Kaiser Plaza, Suite 1101  
Oakland, California 94612

**LOCATION:**

Submerged land in Lake Tahoe at Tahoma, Placer County

**CONSIDERATION:**

Pier and two buoys: No monetary consideration  
Two buoys: \$186 per annum

**BASIS FOR CONSIDERATION:**

Pier and two buoys: Pursuant to Public Resources Code Section 6503.5.

Two buoys: Pursuant to 2 Cal. Code. Regs. 2003.

**AB 884:**

06/11/96

**OTHER PERTINENT  
INFORMATION:**

This lease is conditioned on the Lessee's obtaining authorization from the Tahoe Regional Planning Agency for the existing four buoys within two years of the effective date of the lease.

**EXHIBITS:**

A. Site and Location Map

CALENDAR ITEM NO. **C62** (CONT'D)

**RECOMMENDED**

**ACTION:**

IT IS RECOMMENDED THAT THE COMMISSION:

**CEQA**

**FINDING: (Pier)**

FIND THAT THE ACTIVITY IS EXEMPT FROM THE REQUIREMENTS OF THE CEQA PURSUANT TO 14 CAL. CODE REGS. 15061 AS A CATEGORICALLY EXEMPT PROJECT, CLASS 1, EXISTING FACILITIES, 2 CAL. CODE REGS. 2905 (a) (2).

**CEQA**

**FINDING: (Buoys)**

FIND THAT THE ACTIVITY IS EXEMPT FROM THE REQUIREMENTS OF THE CEQA PURSUANT TO 14 CAL. CODE REGS. 15061 AS A CATEGORICALLY EXEMPT PROJECT, CLASS 3, NEW CONSTRUCTION OF SMALL STRUCTURE, 2 CAL. CODE REGS. 2905 (c) (3).

**SIGNIFICANT LANDS**

**INVENTORY FINDING:**

FIND THAT THIS ACTIVITY IS CONSISTENT WITH THE USE CLASSIFICATION DESIGNATED FOR THE LAND PURSUANT TO PUBLIC RESOURCES CODE SECTIONS 6370, ET SEQ.

**AUTHORIZATION:**

AUTHORIZE ISSUANCE TO GARY R. AND LINDY L. SITZMAN OF A TEN-YEAR GENERAL LEASE - RECREATIONAL USE, BEGINNING OCTOBER 29, 1995; PIER AND TWO BUOYS - NO MONETARY CONSIDERATION PURSUANT TO PUBLIC RESOURCES CODE SECTION 6503.5; TWO BUOYS - \$186 PER ANNUM; FOR A 0.6-ACRE PARCEL, MORE OR LESS, OF THE STATE'S SOVEREIGN LANDS BELOW THE ELEVATION OF 6223 LTD UNDER APPLICANT'S PIER AND FOUR BUOYS AS DEPICTED ON EXHIBIT "A" ATTACHED AND BY REFERENCE MADE A PART HEREOF.

# Lake Tahoe

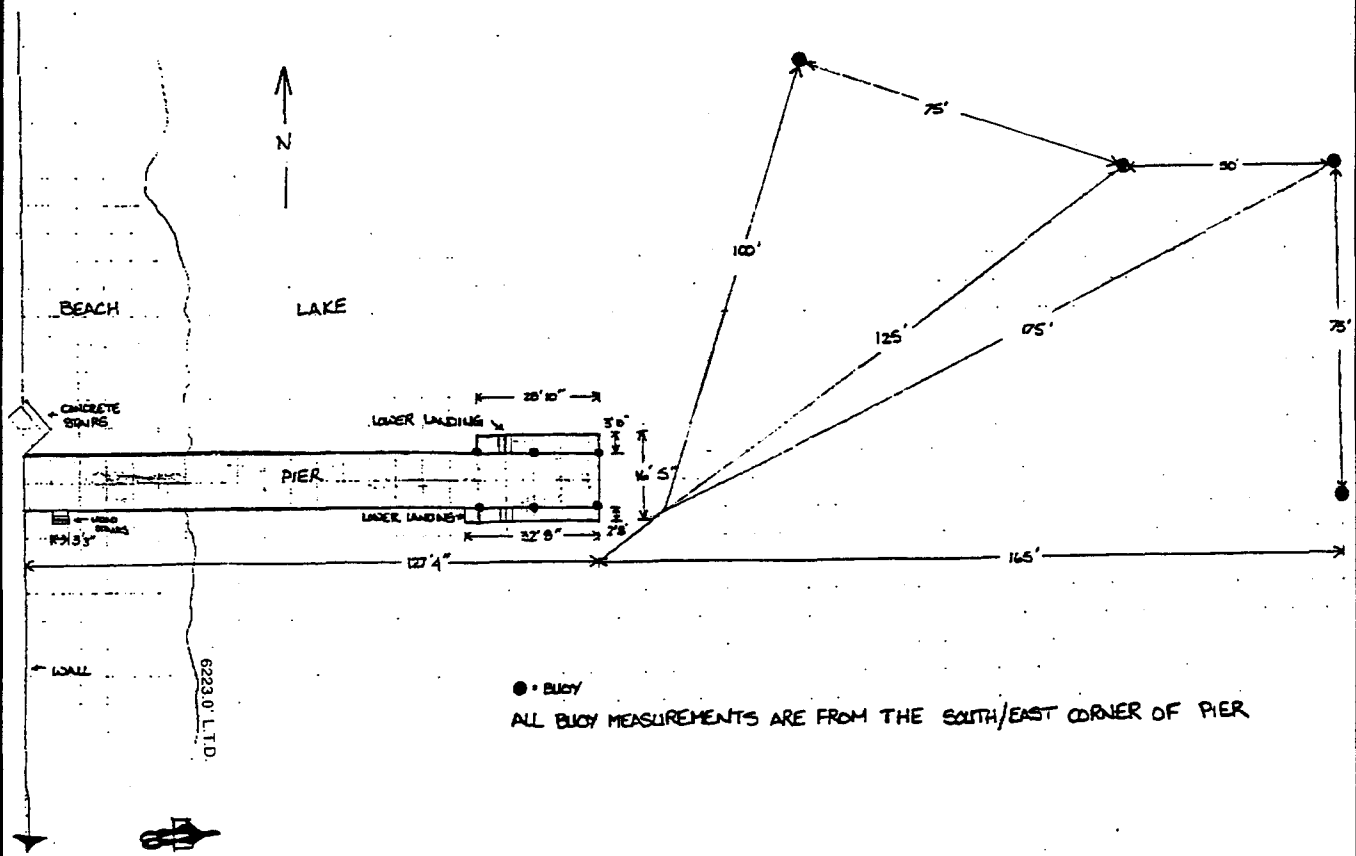

6960 West Lake Blvd.

NO SCALE

## LOCATION MAP

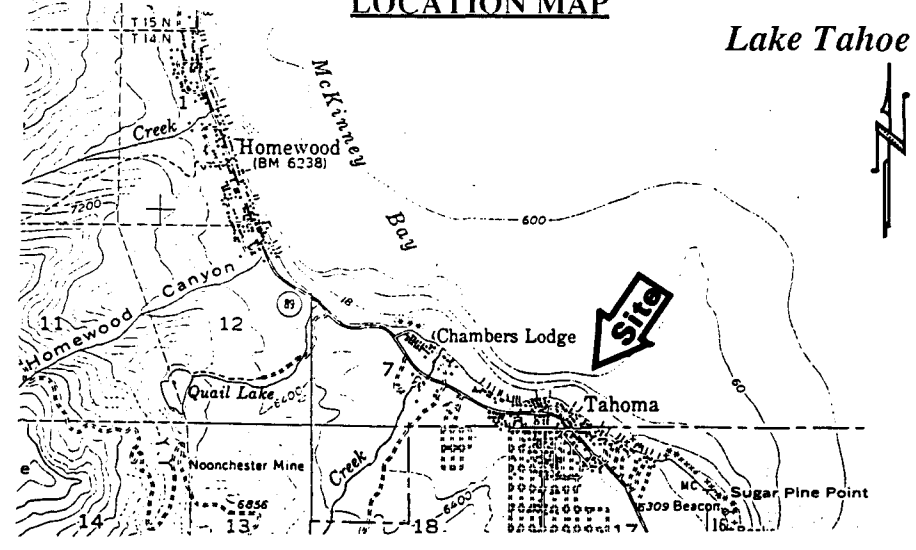

Lake Tahoe



NO SCALE

This Exhibit is solely for purposes of generally defining the lease premises, and is not intended to be, nor shall it be construed as, a waiver or limitation of any State interest in the subject or any other property.

### EXHIBIT "A"

PRC 3368.9

APNs 98 - 210 - 026, 027

Lake Tahoe

PLACER COUNTY

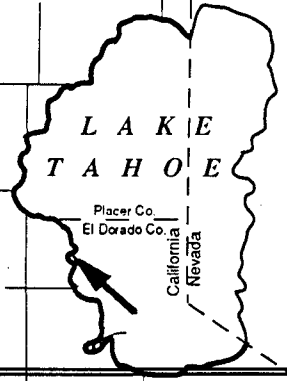

CALENDAR PAGE 232

MINUTE PAGE 000509

CG 1/96