

CALENDAR ITEM NO. **C53** (CONT'D)

**SIGNIFICANT LANDS
INVENTORY FINDING:**

FIND THAT THIS ACTIVITY IS CONSISTENT WITH THE USE CLASSIFICATION DESIGNATED FOR THE LAND PURSUANT TO PUBLIC RESOURCES CODE SECTIONS 6370, ET SEQ.

AUTHORIZATION:

1. AUTHORIZE ISSUANCE TO SOUTHERN PACIFIC TRANSPORTATION COMPANY OF A 49-YEAR GENERAL LEASE -RIGHT OF WAY USE BEGINNING DECEMBER 2, 1995; FOR THE CONTINUED USE AND MAINTENANCE OF AN EXISTING RAILROAD BRIDGE; IN CONSIDERATION OF THE PUBLIC USE AND BENEFIT; WITH THE STATE RESERVING THE RIGHT AT ANY TIME TO SET A MONETARY RENTAL IF THE COMMISSION FINDS SUCH ACTION TO BE IN THE STATE'S BEST INTEREST; PROVISION OF PUBLIC LIABILITY INSURANCE FOR COMBINED SINGLE LIMIT COVERAGE OF \$1,000,000.

2. APPROVE A SELF-RETENTION PROGRAM IN LIEU OF A CERTIFICATE OF INSURANCE BY SOUTHERN PACIFIC TRANSPORTATION COMPANY (SP), EFFECTIVE DECEMBER 2, 1995. SP AGREES TO SUBMIT AN ANNUAL CERTIFIED FINANCIAL REPORT AND OTHER FINANCIAL INFORMATION RELATING TO THE PROGRAM; AND IN THE EVENT THE STATE FEELS SP IS UNABLE TO MEET ITS DEDUCTIBLES, IT RESERVES THE RIGHT TO REQUIRE THAT SP PROVIDE EVIDENCE OF INSURANCE COVERAGE FROM A PROVIDER ACCEPTABLE TO THE STATE.

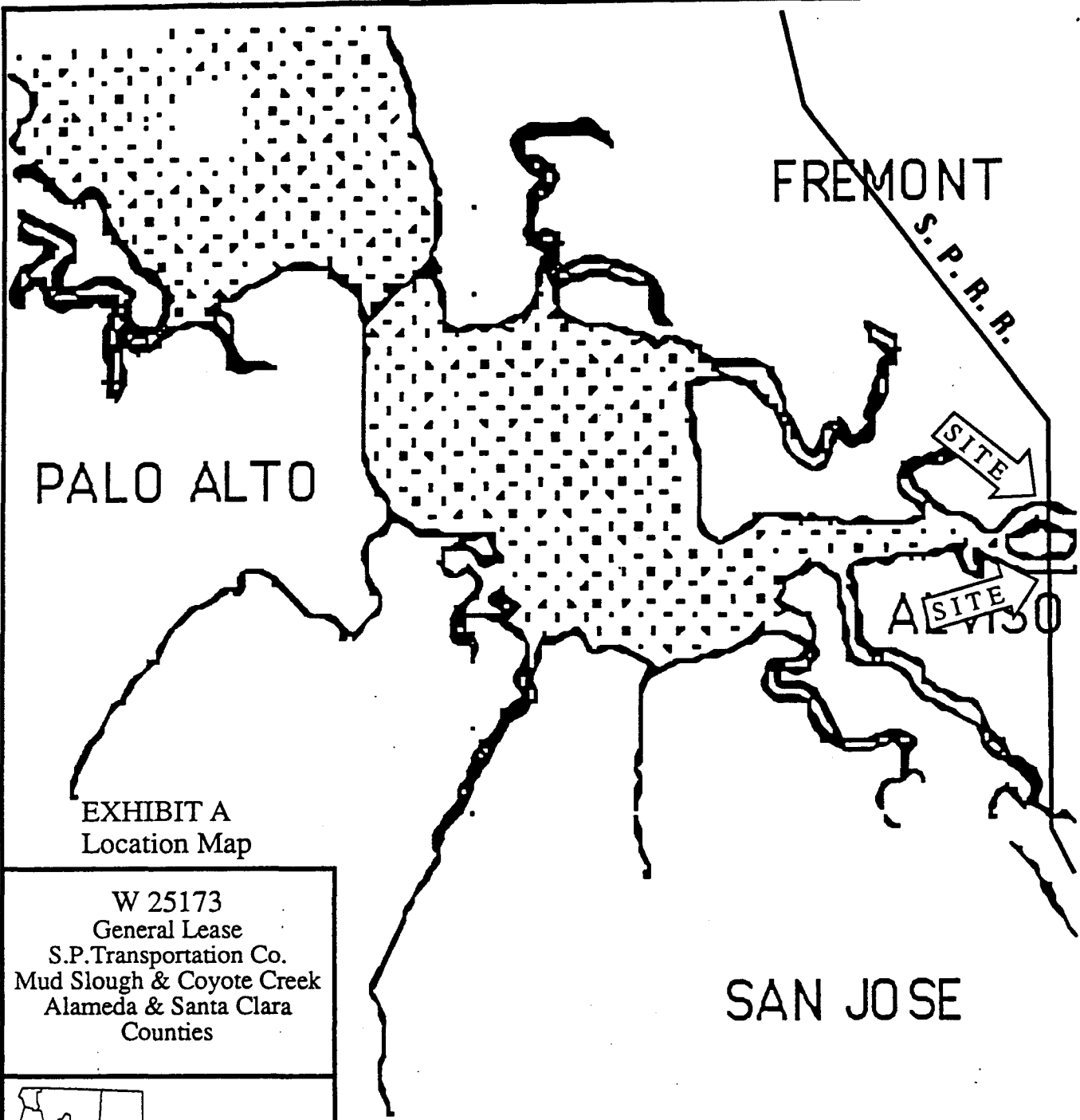

PALO ALTO

FREMONT

S. P. R. R.

SITE

A SITE

ALEYSO

SAN JOSE

EXHIBIT A
Location Map

W 25173
General Lease
S.P. Transportation Co.
Mud Slough & Coyote Creek
Alameda & Santa Clara
Counties



This Exhibit is solely for purpose of generally defining the lease premise, and is not intended to be, nor shall it be construed as, a waiver or limitation of any State interest in the subject or any other property.

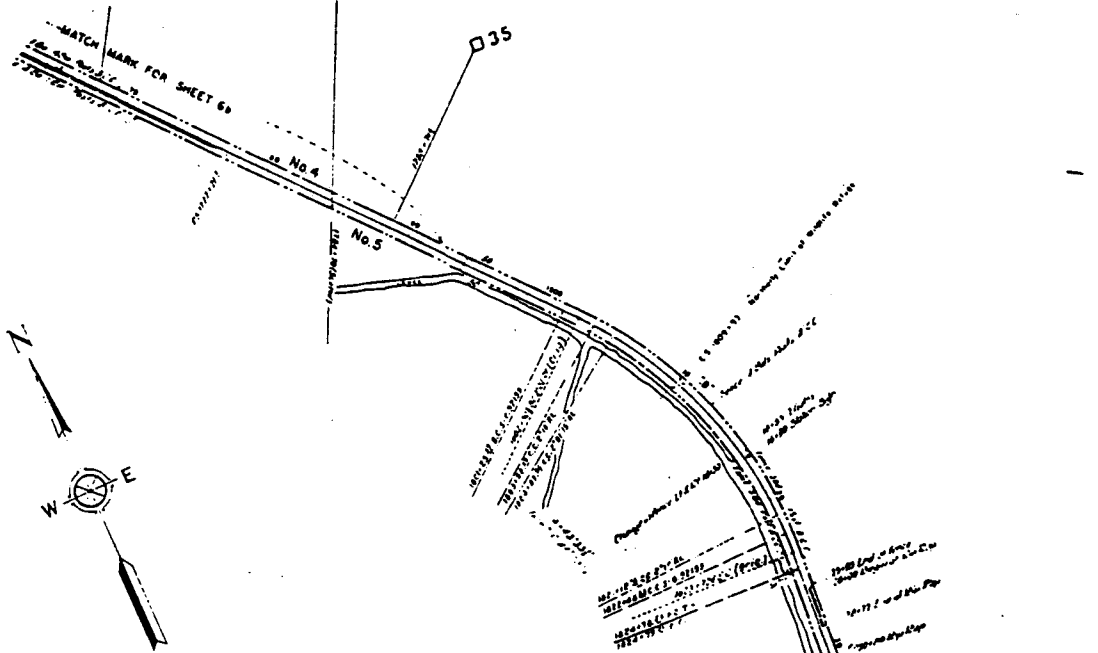
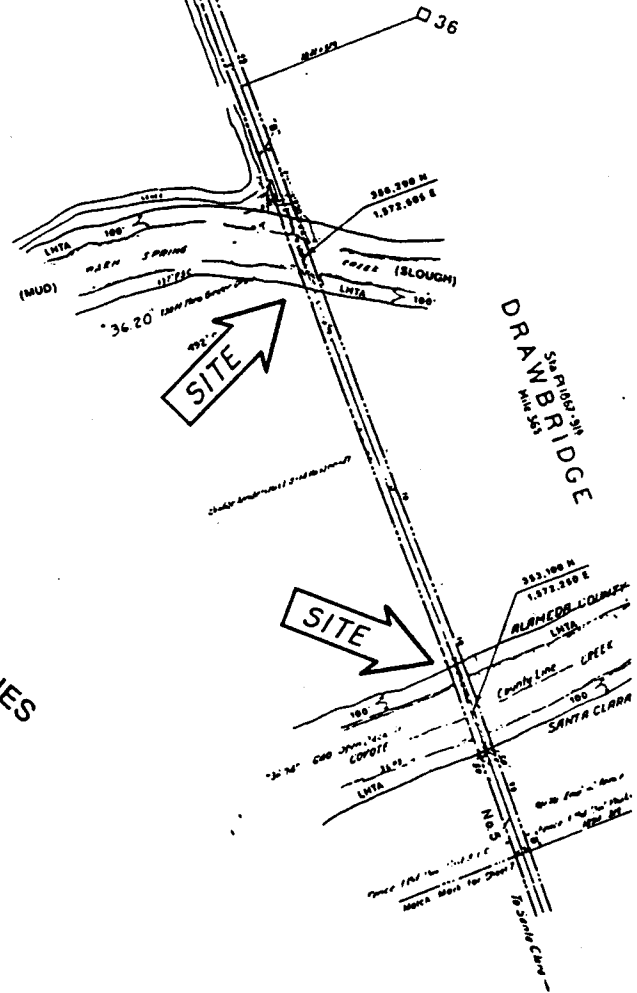

EXHIBIT B
Description

W 25173
General Lease
S.P. Transportation Co.
Mud Slough & Coyote Creek
Alameda & Santa Clara
Counties



SOUTHERN PACIFIC LINES
PROJECT SITE PLAN
SCALE 1"=400'



This Exhibit is solely for purpose of generally defining the lease premise, and is not intended to be, nor shall it be construed as, a waiver or limitation of any State interest in the subject or any other property.